

Hacker, Marsha

From: Nelson, Larry
Sent: Monday, July 06, 2009 11:06 AM
To: 'Jim Beyer'; Wiesner, Randy; Dave Janda
Cc: Hacker, Marsha; Phillips, Rob; Schmidt, Chris; Clear, Mark; Bruer, Tim; Davis, Dave
Subject: Replacement of Van Hise Middle School Emergency Siren
Follow Up Flag: Follow up
Flag Status: Blue

Please proceed to replace the emergency siren at the Van Hise Middle School. Prepare a change order to substitute the siren at Frazier Avenue, which will be done in 2010. (I understand that this will be without cost provided with can notify the Contractor in a timely fashion.

I have copied Marsha Hacker for inclusion of the change order on the BPW agenda. I have also copied the affected Alders, Schmidt & Clear regarding this issue. They may have questions.

Larry D. Nelson, P.E.
 City Engineer
 608.267.4227

From: Wiesner, Randy
Sent: Thursday, July 02, 2009 12:12 PM
To: Phillips, Rob; Dave Janda; 'Jim Beyer'
Cc: Nelson, Larry
Subject: Van Hise Middle School siren summary
Importance: High

The following is a summary of yesterdays siren test and site assessment for the relocation/replacement of siren 151.

Test Summary: The attached map (July01_overview.pdf) shows the surrounding sirens to the school site (151). If you zoom in on the 151 area you will see the 5 locations for the decibel meters. Sirens 151 and 176 were turned off for this test. Sites 1 & 5 had problems hearing any of the surrounding sirens. Back ground noise was in the 70+Db range and was doing a good job of drowning out the siren sound, there were no sound level spikes during the test time. As yet I have not received the reports for the other 3 sites but am confident the results will be similar.

Based on the siren test taking siren 151 off line until next year will actually be leaving noticeable holes in our existing coverage. Therefore I propose we relocate this siren under the 2009 contract and move the proposed siren for Frazier Ave to the 2010 contract.

Site analysis & discussion with Mr. Doug Pearson from the school district: The attached file (Site151.pdf) shows the following:

1. Mr. Pearson was very cooperative and will assist me in what ever way to get the siren relocated on the school grounds. His concerns were that it not be placed in an area where the kids would normally be and that it be somewhere along the property line, as close to the property line as possible.
2. Yellow lines indicate contour drop groups of approximately 8 feet. The school site in particular (neighborhood in general) is terraced in this manner.

7/13/2009

3. The green dots with small numbers is an MG&E power pole overlay. I have identified which poles appear to have a transformer on them with a light blue semi transparent box.

4. The best location with easiest maintenance access is indicated by the red arrow. This corner of the school property would require some tree trimming. The southern most 3 houses on Richland Ln are either all or partially in our normal 150' standoff circle. However, in this particular case all of the roofs for these homes are either near or below the ground level at this location. So the initial sound wave will actually be going over the top of them. The primary power for the new siren could be run from the nearest transformer down the service main to the last pole (20H12-E12) then over to the new siren.

Depending on the final location of the siren pole all of the trees that would need to be trimmed are on school property.

Dave/Jim, I would like to meet Barney out here some time next week to discuss the possibilities with him.

Rob, once I meet with Barney we can do a simple easement, have Real Estate prepare it and Mr. Pearson can take care of it with the school admin staff. He said it is pretty straight forward and he does it often so it should be no big deal. He is supportive about relocating it here on the school grounds for the benefit of the neighborhood as long as it is coming off of the roof. Once we decide we will also need to notify the alders involved. Do we need to do an amendment to BPW? We also need to decide quickly before Hill Electric receives the poles for this years contract.

Please let me know of your opinions and or other suggestions.

Randy

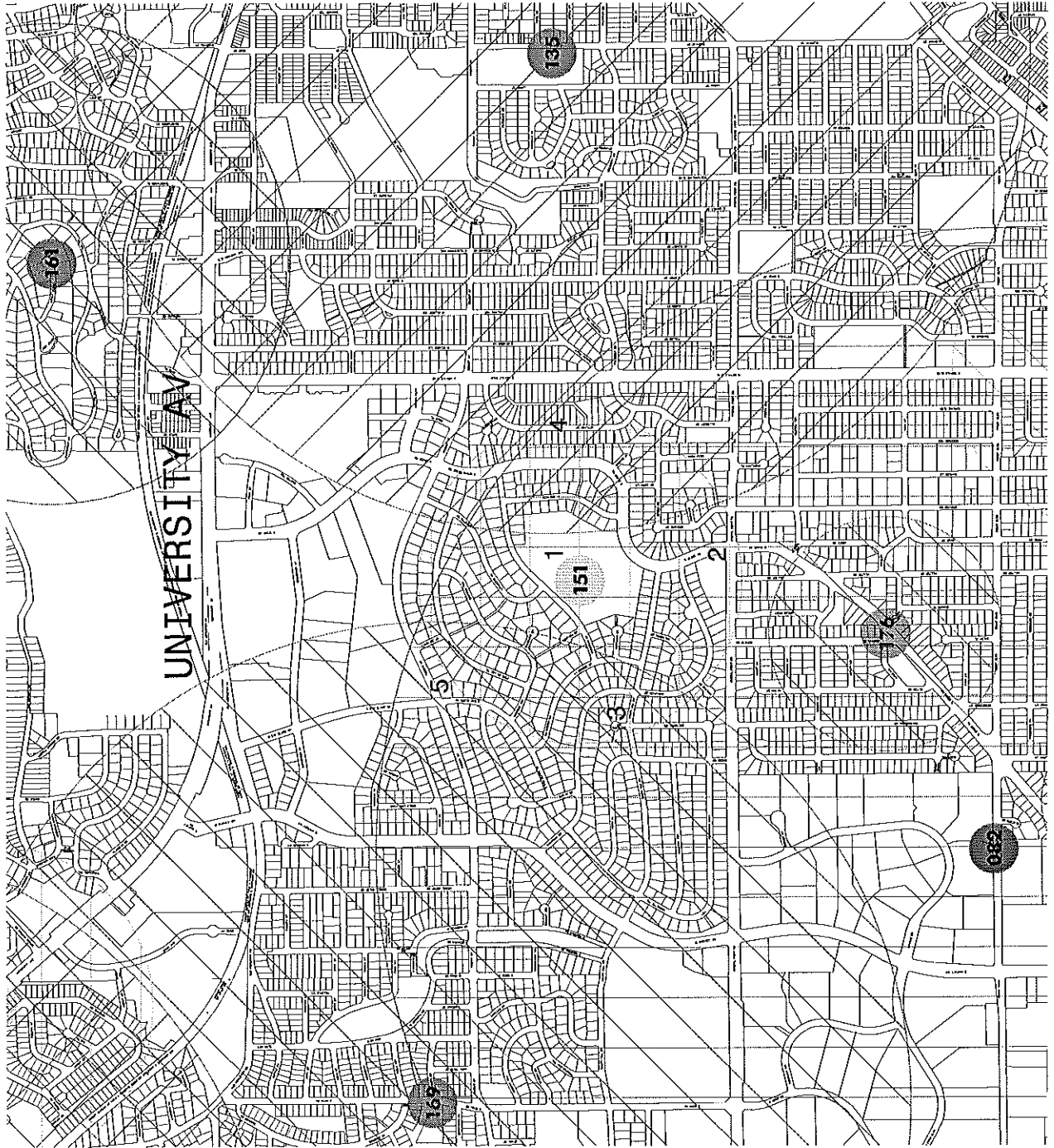



City of Madison, WI. - GIS/Mapping data

Printed By: enrsw

Disclaimer: The City makes no representation about the accuracy of these records and shall not be liable for any damages