

ORIGINAL ALCOHOL BEVERAGE LICENSE APPLICATION

Submit to municipal clerk.

For the license period beginning July 1 20 11 ;
ending June 30 20 12

TO THE GOVERNING BODY of the: Town of }
 Village of } Madison
 City of }

County of Dane Aldermanic Dist. No. 15 (if required by ordinance)

1. The named INDIVIDUAL PARTNERSHIP LIMITED LIABILITY COMPANY
 CORPORATION/NONPROFIT ORGANIZATION

hereby makes application for the alcohol beverage license(s) checked above.

2. Name (individual/partners give last name, first, middle; corporations/limited liability companies give registered name): Stop-N-Go of Madison, Inc.

An "Auxiliary Questionnaire," Form AT-103, must be completed and attached to this application by each individual applicant, by each member of a partnership, and by each officer, director and agent of a corporation or nonprofit organization, and by each member/manager and agent of a limited liability company. List the name, title, and place of residence of each person.

Title	Name	Home Address	Post Office & Zip Code
President/Member	<u>Andrew Bowman</u>	<u>4213 Somerset Lane</u>	<u>Madison, WI 53711</u>
Vice President/Member	<u>Kevin O'Brien</u>	<u>405 W Haven Dr</u>	<u>Arlington Hts, IL 60005</u>
Secretary/Member	<u>Andrew Bowman</u>	<u>4213 Somerset Lane</u>	<u>Madison, WI 53711</u>
Treasurer/Member	<u>Andrew Bowman</u>	<u>4213 Somerset Lane</u>	<u>Madison, WI 53711</u>
Agent	<u>Andrew Bowman</u>	<u>4213 Somerset Lane</u>	<u>Madison, WI 53711</u>
Directors/Managers	<u>Andrew Bowman</u>	<u>4213 Somerset Lane</u>	<u>Madison, WI 53711</u>

3. Trade Name Stop-N-Go #231 Business Phone Number _____
4. Address of Premises 4624 Monona Dr. Post Office & Zip Code Madison 53716

5. Is individual, partners or agent of corporation/limited liability company subject to completion of the responsible beverage server training course for this license period? Yes No
6. Is the applicant an employe or agent of, or acting on behalf of anyone except the named applicant? Yes No
7. Does any other alcohol beverage retail licensee or wholesale permittee have any interest in or control of this business? Yes No
8. (a) Corporate/limited liability company applicants only: Insert state WI and date 09/14/62 of registration.
(b) Is applicant corporation/limited liability company a subsidiary of any other corporation or limited liability company? Yes No
(c) Does the corporation, or any officer, director, stockholder or agent or limited liability company, or any member/manager or agent hold any interest in any other alcohol beverage license or permit in Wisconsin? Yes No
(NOTE: All applicants explain fully on reverse side of this form every YES answer in sections 5, 6, 7 and 8 above.)

9. Premises description: Describe building or buildings where alcohol beverages are to be sold and stored. The applicant must include all rooms including living quarters, if used, for the sales, service, and/or storage of alcohol beverages and records. (Alcohol beverages may be sold and stored only on the premises described.) _____
10. Legal description (omit if street address is given above): _____
11. (a) Was this premises licensed for the sale of liquor or beer during the past license year? Yes No
(b) If yes, under what name was license issued? _____
12. Does the applicant understand they must file a Special Occupational Tax return (TTB form 5630.5) before beginning business? [phone 1-800-937-8864] Yes No
13. Does the applicant understand a Wisconsin Seller's Permit must be applied for and issued in the same name as that shown in Section 2, above? [phone (608) 266-2776] Yes No
14. Is the applicant indebted to any wholesaler beyond 15 days for beer or 30 days for liquor? Yes No

READ CAREFULLY BEFORE SIGNING: Under penalty provided by law, the applicant states that each of the above questions has been truthfully answered to the best of the knowledge of the signers. Signers agree to operate this business according to law and that the rights and responsibilities conferred by the license(s), if granted, will not be assigned to another. (Individual applicants and each member of a partnership applicant must sign; corporate officer(s), members/managers of Limited Liability Companies must sign.) Any lack of access to any portion of a licensed premises during inspection will be deemed a refusal to permit inspection. Such refusal is a misdemeanor and grounds for revocation of this license.

SUBSCRIBED AND SWORN TO BEFORE ME
this 4th day of May, 20 11
Anita L. Kobak
(Notary Public)
My commission expires 2.2.14

Andrew Bowman
(Officer of Corporation/Member/Manager of Limited Liability Company/Partner/Individual)
Kevin O'Brien
(Officer of Corporation/Member/Manager of Limited Liability Company/Partner)
Andrew Bowman
(Additional Partner(s)/Member/Manager of Limited Liability Company if Any)

Applicant's Wisconsin Seller's Permit Number: <u>456-0000156861-03</u>	
Federal Employer Identification Number (FEIN): <u>39-1018040</u>	
LICENSE REQUESTED	
TYPE	FEE
<input checked="" type="checkbox"/> Class A beer	\$
<input type="checkbox"/> Class B beer	\$
<input type="checkbox"/> Wholesale beer	\$
<input type="checkbox"/> Class C wine	\$
<input checked="" type="checkbox"/> Class A liquor	\$
<input type="checkbox"/> Class B liquor	\$
<input type="checkbox"/> Reserve Class B liquor	\$
Publication fee	\$
TOTAL FEE	\$

TO BE COMPLETED BY CLERK			
Date received and filed with municipal clerk	Date reported to council/board	Date provisional license issued	Signature of Clerk
Date license granted	Date license issued	License number issued	

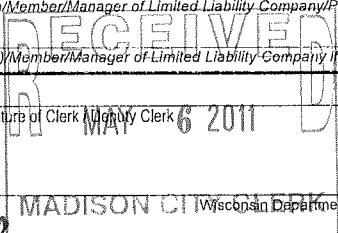

A-15-PA-07
P-613
22513
MADISON CITY CLERK Wisconsin Department of Revenue

City of Madison Supplemental Class A License Application

<input type="checkbox"/> Seller's Permit Number <input type="checkbox"/> Federal Employer Identification # <input type="checkbox"/> Notarized Original Application Form <input type="checkbox"/> Notarized Supplemental Form <input type="checkbox"/> Orange Sign (Clerk's Office provides at time of application)	<input type="checkbox"/> Description of Licensed Premise <input type="checkbox"/> *Notarized Appointment of Agent <input type="checkbox"/> Background Investigation Form(s) <input type="checkbox"/> Notarized Transfer of Ownership <input type="checkbox"/> *Articles of Incorporation	<input type="checkbox"/> Floor Plans <input type="checkbox"/> Lease <input type="checkbox"/> Sample Menu <input type="checkbox"/> Business Plan * Corporation/LLC only
--	--	--

1. Name of Applicant/Partner/Corporation/LLC Stop-N-Go of Madison, Inc

2. Address of Licensed Premise 4624 Monona Drive, Madison, WI 53716

3. Telephone Number: _____ 4. Anticipated opening date: _____

5. Mailing address if not opening immediately 2934 Fish Hatchery Road, Madison, WI 53713

6. Have you contacted the Alderperson, Police Department District Captain, Alcohol Policy Coordinator, and the neighborhood association representative for the area in which you intend to locate? Yes No

7. Are there any special conditions desired by the neighborhood? Yes No

Explain. None known

8. What type of establishment is contemplated? Liquor Store Grocery Store
 Convenience Store – Gas Pumps Yes No Other—Explain _____

9. Business Description: 3,500 sq ft convenience store with 3 dispenser gas island

10. Detailed written description of building, including overall dimensions, seating arrangements, capacity, bar size and all areas where alcohol beverages are to be sold and stored. **The licensed premise described below shall not be expanded or changed without the approval of the Common Council.**

88'-40' convenience store selling beer out of 4-5 cooler doors.

11. Are any living quarters directly or indirectly accessible and under control of the applicant? Yes No
 Please note that alcohol may be sold and stored only on the licensed premise, not in living quarters.

12. Describe existing parking and how parking lot is to be monitored. Existing parking will be changed. Parking will have video surveillance.

13. Describe your management experience, staffing levels, duties and employee training.
Stop-N-Go operates 33 convenience stores in Wisconsin and Illinois. Staffing levels vary based on volume. Extensive training is provided for all staff.

14. Identify the **registered agent** for your Corporation or LLC. This is your corporation's agent for service of process, notice or demand required or permitted by law to be served on the corporation.

Andrew J. Bowman 4213 Somerset Ln, Madison, WI 53711

Name

Address

15. Utilizing your market research, who would you project your target market to be?
Residents and those who frequent the area. People of legal drinking age

16. Describe how you plan to advertise/promote your business. What products will you be advertising?
In-store signage; limited radio advertising convenience foods

17. Are you operating under a lease or franchise agreement? Yes (attach a copy) No

18. Owner of building where establishment is located: Stop-N-Go of Madison, Inc.

Address of Owner: 2934 Fish Hatchery Rd. Madison, WI 53713 Phone Number (608) 271-4433

19. Private organizations (clubs): Do your membership policies contain any requirement of "Invidious" (likely to give offense) discrimination in regard to race, creed, color, or national origin? Yes No

20. List the Directors of your Corporation/LLC

Andrew J. Bowman 4213 Somerset Ln, Madison, WI 53711
Name Address

Kevin O'Brien 405 W Haven Dr, Arlington Hts, IL 60005
Name Address

Name Address

21. List the Stockholders of your Corporation/LLC

Bowman Farms 100%
Name Address % of Ownership

Name Address % of Ownership

Name Address % of Ownership

Read carefully before signing: Under penalty provided by law, the applicant states that the above information has been truthfully completed to the best of the knowledge of the signer. Signer agrees to operate this business according to law and that the rights and responsibilities conferred by the license(s), if granted will not be assigned to another. Any lack of access to any portion of a licensed premise during inspection will be deemed a refusal to permit inspection. Such refusal is a misdemeanor and grounds for revocation of this license.

Subscribed and Sworn to before me:

this 4th day of May, 2011

Anita Lobal
(Clerk/Notary Public)

K M
(Officer of Corporation/Member of LLC/Partner/Individual)

My commission expires 2.2.14

Appointment of New Liquor/Beer Agent

To be completed by Corporate Officer or Member of LLC

I, Kevin O'Brien, officer/member for Stop-N-Go of Madison, Inc
(Corporation/LLC), doing business as Stop-N-Go #231, authorize and appoint
Andrew J. Bowman (Name) as the liquor/beer agent for the premise
located at 4624 Monana Dr. Madison, WI 53716.

Subscribed and sworn to before me this

4th Day of May, 20 11

Anita J. Robak

Notary Public, Dane County, Wisconsin

My Commission Expires 2.2.14

K O'Brien

Signature of Officer/Member

To be completed by appointed Liquor/Beer Agent

I, Andrew J. Bowman, appointed liquor/beer agent for
Stop-N-Go of Madison, Inc (name of Corporation or LLC), being first duly sworn
say I have vested in me, by properly authorized and executed written delegation, full authority
and control of the premise described in the license of such corporation or limited liability
company, and I am involved in the actual conduct of the business as an employee, or have a
direct financial interest in the business of the licensee, therein relating to the intoxicating
liquor/fermented malt beverage. The interest I have in the business is 0 %.

Subscribed and sworn to before me this

4th Day of May, 20 11

Anita J. Robak

Notary Public, Dane County, Wisconsin

My Commission Expires 2.2.14

Andrew J. Bowman

Signature of Agent

The appointed Liquor/Beer Agent must complete the other side of this form.

SCHEDULE FOR APPOINTMENT OF AGENT BY CORPORATION/NONPROFIT ORGANIZATION OR LIMITED LIABILITY COMPANY

Submit to municipal clerk.

All corporations/organizations or limited liability companies applying for a license to sell fermented malt beverages and/or intoxicating liquor must appoint an agent. The following questions must be answered by the agent. The appointment must be signed by the officer(s) of the corporation/organization or members/managers of a limited liability company and the recommendation made by the proper local official.

To the governing body of: Town Village of Madison County of Dane
 City

The undersigned duly authorized officer(s)/members/managers of Stop-N-Go of Madison, Inc.
(registered name of corporation/organization or limited liability company)

a corporation/organization or limited liability company making application for an alcohol beverage license for a premises known as Stop-N-Go #231
(trade name)

located at 4626 Monona Dr, Madison, WI 53716

appoints Andrew J Bowman
(name of appointed agent)
4213 Somerset Lane, Madison, WI 53711
(home address of appointed agent)



to act for the corporation/organization/limited liability company with full authority and control of the premises and of all business relative to alcohol beverages conducted therein. Is applicant agent presently acting in that capacity or requesting approval for any corporation/organization/limited liability company having or applying for a beer and/or liquor license for any other location in Wisconsin?

Yes No If so, indicate the corporate name(s)/limited liability company(ies) and municipality(ies).
see attached

Is applicant agent subject to completion of the responsible beverage server training course? Yes No

How long immediately prior to making this application has the applicant agent resided continuously in Wisconsin? life

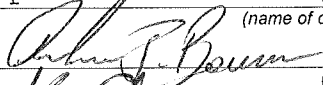
Place of residence last year 4213 Somerset Lane, Madison, WI 53711

For: Stop-N-Go of Madison, Inc
(name of corporation/organization/limited liability company)
By: 
(signature of Officer/Member/Manager)
And: 
(signature of Officer/Member/Manager)

ACCEPTANCE BY AGENT

I, Andrew J. Bowman, hereby accept this appointment as agent for the
(print/type agent's name)

corporation/organization/limited liability company and assume full responsibility for the conduct of all business relative to alcohol beverages conducted on the premises for the corporation/organization/limited liability company.

 5/4/11 Agent's age 35
(signature of agent) (date)
4213 Somerset Lane, Madison, WI 53711 Date of birth 8/19/1975
(home address of agent)

**APPROVAL OF AGENT BY MUNICIPAL AUTHORITY
(Clerk cannot sign on behalf of Municipal Official)**

I hereby certify that I have checked municipal and state criminal records. To the best of my knowledge, with the available information, the character, record and reputation are satisfactory and I have no objection to the agent appointed.

Approved on _____ by _____ Title _____
(date) (signature of proper local official) (town chair, village president, police chief)

Stop-N-Go
License Ownership

Store License Holder

200 Stop-N-Go of Madison, Inc. (Andrew J. Bowman, Agent) Oregon, WI
211 Stop-N-Go of Waukesha, Inc. (Andrew J. Bowman, Agent) Brodhead, WI
214 Stop-N-Go of Southern WI, Inc. (Andrew J. Bowman, Agent) Edgerton, WI
Stop-N-Go of Madison, Inc. (Andrew J. Bowman, Agent) Fort Atkinson, WI
Spirits of Delavan Stop-N-Go of Madison, Inc. (Andrew J. Bowman, Agent) Delavan, WI
221 Stop-N-Go of Madison, Inc. (Andrew J. Bowman, Agent) Fort Atkinson, WI
227 Stop-N-Go of Madison, Inc. (Andrew J. Bowman, Agent) Barneveld, WI
Stop-N-Go of Madison, Inc. (Michelle Lancaster, Agent) Platteville, WI
Stop-N-Go of Madison, Inc. (Andrew J. Bowman, Agent) Town of Burke, WI
253 Stop-N-Go of Madison, Inc. (Andrew J. Bowman, Agent) Madison, WI
255 Stop-N-Go of Madison, Inc. (Andrew J. Bowman, Agent) Madison, WI
256 Stop-N-Go of Madison, Inc. (Andrew J. Bowman, Agent) DeForest, WI
259 Stop-N-Go of Madison, Inc. (Andrew J. Bowman, Agent) Cottage Grove, WI
262 Stop-N-Go of Madison, Inc. (Andrew J. Bowman, Agent) Beloit
265 Stop-N-Go of Madison, Inc. (Crystal Dent, Agent) Lake Geneva, WI
271 Winnebago Foods, Inc. (Andrew J. Bowman, Agent) Pewaukee, WI
273 Stop-N-Go of Madison, Inc. (Andrew J. Bowman, Agent) Hartland WI
276 Stop-N-Go of Beloit, Inc (Andrew J. Bowman, Agent), Hartford, WI
278 Stop-N-Go of Madison, Inc. (Darlene McKerrow, Agent) Waukesha, WI
284 Stop-N-Go of Madison, Inc. (Andrew J. Bowman, Agent) Madison, WI
Stop-N-Go of Madison, Inc. (Andrew J. Bowman, Agent) Fitchburg, WI
287 Stop-N-Go of Madison, Inc. (Andrew J. Bowman, Agent) Madison, WI
299 Stop-N-Go of University Avenue, Inc. (Andrew J. Bowman, Agent) Monroe, WI
President – Vacant at this time for all stores,

Andrew J Bowman: V. President and Treasurer for all stores

Kevin O'Brien: Secretary for all stores

All stores hold a Class A Beer license. Stores: Spirits of Delavan, #227, #229, #230, #265, #276, #299 hold Class A Beer and Class A Liquor.

Stop-N-Go of Madison owned 100% by Bowman Farms

Stop-N-Go

License Ownership

Store License Holder

200 Stop-N-Go of Madison, Inc. (Andrew J. Bowman, Agent) Oregon, WI

211 Stop-N-Go of Waukesha, Inc. (Andrew J Bowman, Agent) Brodhead, WI

214 Stop-N-Go of Southern WI, Inc. (Andrew J. Bowman, Agent) Edgerton, WI

Stop-N-Go of Madison, Inc.(Andrew J. Bowman, Agent) Fort Atkinson, WI

Spirits of Delavan Stop-N-Go of Madison, Inc. (Andrew J. Bowman, Agent) Delavan, WI

221 Stop-N-Go of Madison, Inc. (Andrew J. Bowman, Agent) Fort Atkinson, WI

227 Stop-N-Go of Madison, Inc. (Andrew J. Bowman, Agent) Barneveld, WI

Stop-N-Go of Madison, Inc. (Michelle Lancaster, Agent) Platteville, WI

Stop-N-Go of Madison, Inc. (Andrew J. Bowman, Agent) Town of Burke, WI

253 Stop-N-Go of Madison, Inc. (Andrew J. Bowman, Agent) Madison, WI

255 Stop-N-Go of Madison, Inc. (Andrew J. Bowman, Agent) Madison, WI

256 Stop-N-Go of Madison, Inc. (Andrew J. Bowman, Agent) DeForest, WI

259 Stop-N-Go of Madison, Inc. (Andrew J. Bowman, Agent) Cottage Grove, WI

262 Stop-N-Go of Madison, Inc. (Andrew J. Bowman, Agent) Beloit

265 Stop-N-Go of Madison, Inc. (Crystal Dent, Agent) Lake Geneva, WI

271 Winnebago Foods, Inc. (Andrew J. Bowman, Agent) Pewaukee, WI

273 Stop-N-Go of Madison, Inc. (Andrew J. Bowman, Agent) Hartland WI

276 Stop-N-Go of Beloit, Inc (Andrew J. Bowman, Agent), Hartford, WI

278 Stop-N-Go of Madison, Inc. (Darlene McKerrow, Agent) Waukesha, WI

284 Stop-N-Go of Madison, Inc. (Andrew J. Bowman, Agent) Madison, WI

Stop-N-Go of Madison, Inc. (Andrew J. Bowman, Agent) Fitchburg, WI

287 Stop-N-Go of Madison, Inc. (Andrew J. Bowman, Agent) Madison, WI

299 Stop-N-Go of University Avenue, Inc. (Andrew J. Bowman, Agent) Monroe, WI

President – Vacant at this time for all stores,

Andrew J Bowman: V. President and Treasurer for all stores

Kevin O'Brien: Secretary for all stores

All stores hold a Class A Beer license. Stores: Spirits of Delavan, #227, #229, #230, #265, #276, #299 hold Class A Beer and Class A Liquor.

Stop-N-Go of Madison owned 100% by Bowman Farms

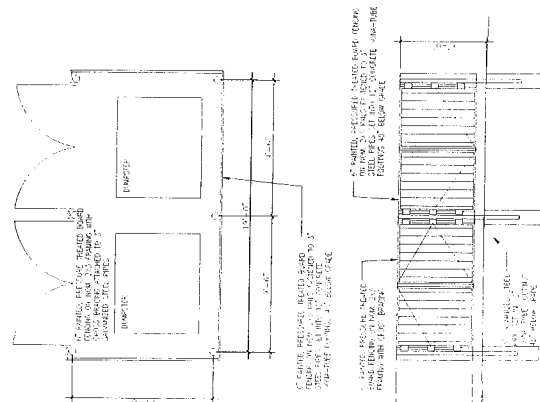

4 TRASH ENCLOSURE DETAIL

SCALE: 1/4" = 1'-0"

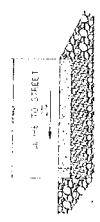

3 SIDEWALK DETAIL

SCALE: 1/4" = 1'-0"

NOTE:

1. ALL CURBS SHALL BE CONCRETE AND SHALL BE 4" HIGH AND 6" WIDE.
2. ALL CURBS SHALL BE CONCRETE AND SHALL BE 4" HIGH AND 6" WIDE.
3. ALL CURBS SHALL BE CONCRETE AND SHALL BE 4" HIGH AND 6" WIDE.
4. ALL CURBS SHALL BE CONCRETE AND SHALL BE 4" HIGH AND 6" WIDE.
5. ALL CURBS SHALL BE CONCRETE AND SHALL BE 4" HIGH AND 6" WIDE.
6. ALL CURBS SHALL BE CONCRETE AND SHALL BE 4" HIGH AND 6" WIDE.
7. ALL CURBS SHALL BE CONCRETE AND SHALL BE 4" HIGH AND 6" WIDE.
8. ALL CURBS SHALL BE CONCRETE AND SHALL BE 4" HIGH AND 6" WIDE.
9. ALL CURBS SHALL BE CONCRETE AND SHALL BE 4" HIGH AND 6" WIDE.
10. ALL CURBS SHALL BE CONCRETE AND SHALL BE 4" HIGH AND 6" WIDE.



2 BITUMINOUS PAVEMENT SECTION - CAR TRAFFIC

SCALE: 1/4" = 1'-0"

PARKING LOT PLAN SITE INFORMATION

Site address: 4624 Monona Drive
 Site acreage (total): 0.71 acres
 Number of building stories (above grade): 1 stories
 Building Height: 24 feet
 Type of construction (new structures or additions): Type V8
 Total square footage of building: 3,354 gsf

Use of Property: Commercial (Mercantile)
 Gross square feet of Office: 800 gsf
 Gross square feet of Mercantile: 1,554 gsf
 Gross square feet of Storage/Mech.: 1,200 gsf
 Number of employees in warehouse: NA
 Number of employees in production area: NA
 Capacity of restaurant / place of assembly: NA

Number of bicycle stalls shown: 2
 Number of bicycle stalls required: 2

Number of parking stalls:	Required	Provided
Small car	12	0
Large car	0	0
1/1 van	1	1
Accessible	1	1
Total	12	12

Number of Trees shown: See Landscape Plan

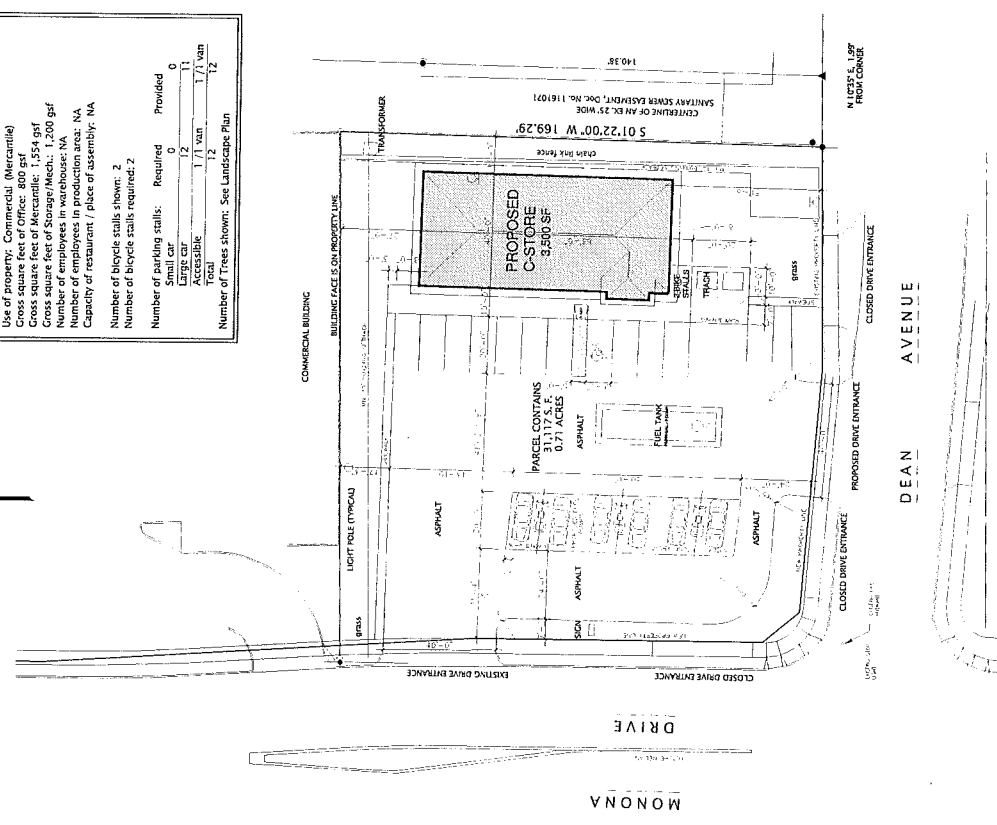
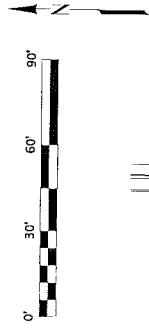

1 SITE PLAN (SHOWN WITH PHASE II PROPERTY LINES)

SCALE: 1/4" = 1'-0"



STOP-N-GO
 4624 MONONA DRIVE
 MADISON, WI 53716

ARCHITECTURAL SITE PLAN

01.14.11 REVIEW
 01.24.11 SITE REVIEW #2
 01.31.11 DATE REVIEW
 01.31.11 SITE REVIEW #3
 02.14.11 SITE REVIEW #4
 03.14.11 SITE REVIEW #5
 03.16.11 PLAN COMM.

A1.0



SERVERlicense.com

This certificate is awarded to

Andrew Bowman

on 11/28/2006

for successful completion of the
Wisconsin Alcohol Server Training Program.

*ServerLicense.com is approved by the Wisconsin Department of Revenue
and fully complies with statutes 125.04 and 125.17.*

*Present this certificate to your local Municipal Clerk's office to receive
your Operator's or Retail License.*

Certificate # SL6814

EXHIBIT A

Part of the Southwest 1/4 of the Northwest 1/4 of Section 16, Township 7 North, Range 10 East, in the City of Madison, Dane County, Wisconsin, more particularly described as follows: Commencing at the West 1/4 corner of said Section 16, thence N1°22'E, 25.0 feet to the point of beginning of this description; thence continuing N1°22'E, 169.5 feet; thence N89°28'E, 218.0 feet to an iron stake; thence S1°22'W, 169.50 feet to an iron stake on the North line of Dean Avenue; thence along said North line S89°28'W, 218.0 feet to the point of beginning.

EXCEPTING THEREFROM part of the Northwest 1/4 of Section 16, Township 7 North, Range 10 East, in the City of Madison, Dane County, Wisconsin, more fully described as follows: Beginning at a point 25 feet North of and 33 feet East of the Southwest corner of the Southwest 1/4 of the Northwest 1/4 of Section 16, Township 7 North, Range 10 East, in the City of Madison, Dane County, Wisconsin. Said point also being the Southwest corner of the property conveyed to the American Oil Company as described in Vol. 731 of Deeds, page 578; thence North 15.2 feet along the East line of Monona Drive to a point of curve; thence on a curve to the left convex to the Southwest having a radius of 15 feet and a long chord that bears S45°08'E, 21.4 feet to a point on the North line of Dean Avenue; thence West 15.2 feet along the North line of Dean Avenue to the point of beginning of this exception.



A. Settlement Statement (HUD-1)

B. Type of Loan

1. <input type="checkbox"/> FHA	2. <input type="checkbox"/> RHS	3. <input checked="" type="checkbox"/> Conv. Unins.	6. File Number: 110110129	7. Loan Number:	8. Mortgage Insurance Case Number:
4. <input type="checkbox"/> VA	5. <input type="checkbox"/> Conv. Ins.				

C. Note: This form is furnished to give you a statement of actual settlement costs. Amounts paid to and by the settlement agent are shown. Items marked "(p.o.c.)*" were paid outside the closing; they are shown here for informational purposes and are not included in the totals. (110110129/45)

D. Name and Address of Buyer: Stop N Go of Madison 2934 Fish Hatchery Road Madison, WI 53713	E. Name and Address of Seller: GHL II, LLC 568 Haugen Road Edgerton, WI 53534-9371	F. Name and Address of Lender:
G. Property Location: 4624 Monona Drive Madison, WI 53716 Dane County, Wisconsin SW/NW, 16-7-10	H. Settlement Agent: Preferred Title, LLC Place of Settlement: 2728 Coho Street Madison, WI 53713 (608)271-2020	I. Settlement Date: March 31, 2011

J. Summary of Buyer's Transaction

100. Gross Amount Due from Buyer	
101. Contract sales price	381,360.00
102. Personal property	
103. Settlement charges to buyer (line 1400)	11,720.80
104.	
105.	
Adjustments for items paid by seller in advance	
106. City/Town taxes	
107. County taxes	
108. Assessments	
109.	
110.	
111.	
112.	
120. Gross amount due from Buyer	393,080.80
200. Amounts Paid by or in Behalf of Buyer	
201. Deposit or earnest money	10,000.00
202. Principal amount of new loan(s)	
203. Existing loan(s) taken subject to	
204.	
205.	
206.	
207.	
208.	
209.	
Adjustments for items unpaid by seller	
210. City/Town taxes 01/01/11 to 03/31/11	2,671.87
211. County taxes	
212. Assessments	
213. 2011 Tax Proration Based on 2010 RE Bill	
214. \$10,957.68/365x89	
215.	
216.	
217.	
218.	
219.	
220. Total paid by/for Buyer	12,671.87
300. Cash at Settlement from/to Buyer	
301. Gross amount due from Buyer (Line 120)	393,080.80
302. Less amount paid by/for Buyer (Line 220)	(12,671.87)
303. CASH FROM BUYER	380,408.93

K. Summary of Seller's Transaction

400. Gross Amount Due to Seller	
401. Contract sales price	381,360.00
402. Personal property	
403.	
404.	
405.	
Adjustments for items paid by seller in advance	
406. City/Town taxes	
407. County taxes	
408. Assessments	
409.	
410.	
411.	
412.	
420. Gross amount due to Seller	381,360.00
500. Reductions in Amount Due to Seller	
501. Excess deposit (see instructions)	
502. Settlement charges to seller (line 1400)	27,762.60
503. Existing loan(s) taken subject to	
504. Payoff of first mortgage loan	
505. Payoff of second mortgage loan	
506. Payoff Release Price	3,000.00
507.	
508. Proceeds	345,227.00
509.	
Adjustments for items unpaid by seller	
510. City/Town taxes 01/01/11 to 03/31/11	2,671.87
511. County taxes	
512. Assessments	
513. 2011 Tax Proration Based on 2010 RE Bill	
514. \$10,957.68/365x89	
515.	
516.	
517.	
518. Final Water City Treasurer	2,698.40
519.	
520. Total reduction amount due Seller	381,360.00
600. Cash at Settlement from/to Seller	
601. Gross amount due to Seller (Line 420)	381,360.00
602. Less reductions due Seller (Line 520)	(381,360.00)
603. CASH TO/FROM SELLER	

The Public Reporting Burden for this collection of information is estimated at 35 minutes per response for collecting, reviewing, and reporting the data. This agency may not collect this information, and you are not required to complete this form, unless it displays a currently valid OMB control number. No confidentiality is assured; this disclosure is mandatory. This is designed to provide the parties to a RESPA covered transaction with information during the settlement process.

L. Settlement Charges				Paid From Buyer's Funds at Settlement	Paid From Seller's Funds at Settlement	
700. Total Real Estate Broker Fees		\$22,881.60				
<i>Division of commission (line 700) as follows:</i>						
701.	\$ 11,440.80	to Lee and Associates of Madison, LLC				
702.	\$ 11,440.80	to Lee and Associates of Madison, LLC		11,440.80	11,440.80	
703.	Commission paid at settlement					
704.						
800. Items Payable in Connection with Loan						
801.	Our origination charge		(from GFE #1)			
802.	Your credit or charge (points) for the specific interest rate chosen		(from GFE #2)			
803.	Your adjusted origination charges		(from GFE #A)			
804.	Appraisal fee		(from GFE #3)			
805.	Credit report		(from GFE #3)			
806.	Tax service		(from GFE #3)			
807.	Flood certification		(from GFE #3)			
808.						
900. Items Required by Lender to be Paid in Advance						
901.	Interest from 03/31/11 to 04/01/11 to @ \$ /day (1 days @ %)		(from GFE#10)			
902.	Mortgage insurance premium for month to		(from GFE #3)			
903.	Homeowner's insurance for year to		(from GFE #11)			
904.						
1000. Reserves Deposited with Lender						
1001.	Initial deposit for your escrow account		(from GFE #9)			
1002.	Homeowner's insurance months @ \$ per month					
1003.	Mortgage insurance months @ \$ per month					
1004.	Property taxes months @ \$ per month					
1005.						
1006.						
1007.						
1100. Title Charges						
1101.	Title services and lender's title insurance to Preferred Title, LLC		(from GFE #4)	250.00		
1102.	Settlement or closing fee to Preferred Title, LLC \$ 250.00				250.00	
1103.	Owner's Policy Premium to Preferred Title, LLC		(from GFE #5)		382.00	
1104.	Lender's title insurance					
1105.	Lender's title policy limit					
1106.	Owner's title policy limit \$381,360.00					
1107.	Agen's portion of the total title insurance premium to Preferred Title, LLC \$ 332.34					
1108.	Underwriter's portion of the total title insurance premium to First American Title Ir \$ 49.66					
1109.	Express Payoff to Preferred Title, LLC					
1110.	Special Assessment Search to Preferred Title, LLC					
1200. Government Recording and Transfer Charges						
1201.	Government recording charges to Register of Deeds		(from GFE #7)	30.00		
1202.	Deed \$ 30.00; Mortgage \$; Releases \$ 180.00				180.00	
1203.	Transfer taxes					
1204.	City/County tax/stamps Deed \$; Mortgage \$					
1205.	State tax/stamps Deed \$ 1,144.20; Mortgage \$				1,144.20	
1206.						
1300. Additional Settlement Charges						
1301.	Required services that you can shop for		(from GFE #6)			
1302.	2010 Delinquent RE Taxes to Dane County Treasurer				13,374.86	
1303.	Snow & Ice Removal Special Assessment to City Treasurer				144.25	
1304.	Snow & Ice Removal Special Assessment to City Treasurer				144.25	
1305.	Snow & Ice Removal Special Assessment to City Treasurer.				159.25	
1306.	Snow Removal Citations to City of Madison Municipal Courts				468.00	
1400.	Total Settlement Charges (enter on lines 103, Section J and 502, Section K)			11,720.80	27,762.60	

Certified to be a true copy.

TO THE BEST OF MY KNOWLEDGE, THE HUD-1 SETTLEMENT STATEMENT WHICH I HAVE PREPARED IS A TRUE AND ACCURATE ACCOUNT OF THE FUNDS WHICH WERE RECEIVED AND HAVE BEEN OR WILL BE DISBURSED BY THE UNDERSIGNED AS PART OF THE SETTLEMENT OF THE TRANSACTION.

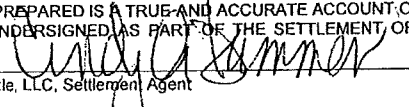
Preferred Title, LLC, Settlement Agent

WARNING: IT IS A CRIME TO KNOWINGLY MAKE FALSE STATEMENTS TO THE UNITED STATES ON THIS OR ANY SIMILAR FORM. PENALTIES UPON CONVICTION CAN INCLUDE A FINE AND IMPRISONMENT. FOR DETAILS SEE: TITLE 18 U.S. CODE SECTION 1001 & SECTION 1010.

United States of America
State of Wisconsin
OFFICE OF THE SECRETARY OF STATE

To All to Whom These Presents Shall Come:

I, DOUGLAS La FOLLETTE, Secretary of State of the State of Wisconsin, do hereby certify that articles of incorporation of

STOP-N-GO OF MADISON, INC.

were duly filed in this office on Sept. 14, 1962 and that thereafter a certificate of such filing and grant of corporate powers and privileges was duly issued to said organization under the hand and seal of the Secretary of State of the State of Wisconsin, as provided by law.

I further certify that it appears from the records of this office that said organization continued and now is a body corporate, duly and legally incorporated, organized and existing by and under the laws of this state, and is in good standing.

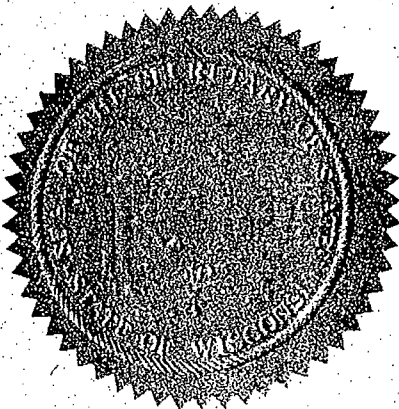

IN TESTIMONY WHEREOF, I have hereunto set my hand and affixed my official seal, at Madison, on JUN 10 1988

Douglas La Follette

DOUGLAS La FOLLETTE
Secretary of State

BY: *D Thompson*

United States of America

STATE OF WISCONSIN

OFFICE OF THE
SECRETARY OF STATE

} SS.

To All to Whom These Presents Shall Come, Greeting:

I, DOUGLAS La FOLLETTE, Secretary of State of the State of Wisconsin and Keeper of the Great Seal thereof, do hereby certify that the annexed copy has been compared by me with the record on file in this Office and that the same is a true copy thereof, and of the whole of such record; and that I am the legal custodian of such record, and that this certification is in due form.

IN TESTIMONY WHEREOF, I have
hereunto set my hand and affixed the Great
Seal of the State.

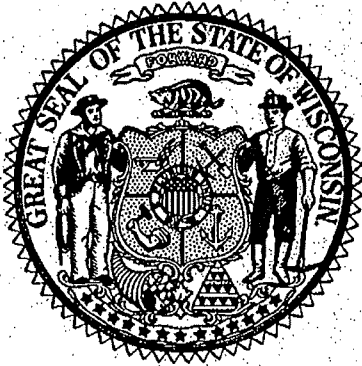

Douglas La Follette

DOUGLAS La FOLLETTE
Secretary of State

BY:

D. Thompson

DATE:

JUN 10 1988

Corporation Division



STOP-N-GO OF MADISON, INC. * ROCKFORD STOP-N-GO, INC.
2934 Fish Hatchery Road, Madison, WI 53713-3175
Phone: (608) 271-4433 * Fax: (608) 271-1222
www.stop-n-go.com

Stop-N-Go Overview and Business Plan for 4624 Monona Drive Site

Overview

Stop-N-Go is a Madison-based organization currently operating 33 convenience stores and employing over 300 people throughout Southeast Wisconsin and Northwest Illinois. The organization has been family-owned since its inception in 1962. The business philosophy and mission statement is "100% customer satisfaction, every store, every time." Stop-N-Go is committed to achieving this goal by providing friendly, timely service from well-trained employees. The organization offers a diverse product selection at fair, competitive prices, with a focus on well-known branded products being offered inside the store and at the gas island.

4624 Monona Drive Site

The site was a CITGO-branded convenience store and car wash that went into receivership in July 2010, and has been vacant since that time. Stop-N-Go currently has four stores located in Madison, and wished to expand its presence in the city. The site was purchased out of receivership on March 31, 2011. The site is run down and unsightly. Therefore, Stop-N-Go intends on demolishing the site and constructing a new 3,500 square foot convenience store with three fueling positions. As with its other locations, Stop-N-Go will offer fuel and an assortment of well-known branded products inside, including beer and wine. Accordingly, Stop-N-go is applying for a **Class A liquor license** for the 4624 Monona Drive site. The organization has strict policies on the sale of alcoholic beverages and all store staff are trained and are held accountable to the company's liquor policy.

It is important for Stop-N-Go to be a good neighbor and has already met with the local neighborhood association presenting its plan receiving a favorable endorsement.

OUR MISSION
100% CUSTOMER SATISFACTION...EVERY STORE...EVERY TIME



STOP-N-GO OF MADISON, INC. * ROCKFORD STOP-N-GO, INC.
2934 Fish Hatchery Road, Madison, WI 53713-3175
Phone: (608) 271-4433 * Fax: (608) 271-1222
www.stop-n-go.com

ALRC members,

We are requesting a Class A beer and Class A Liquor license. The Class A Liquor would be limited to wine sales only.

Thank you for your consideration and feel free to contact Stop-N-Go with any questions you have regarding our license application.

OUR MISSION
100% CUSTOMER SATISFACTION...EVERY STORE...EVERY TIME