

SURVEYOR'S CERTIFICATE
 I, Brett T. Stoffregen, Professional Land Surveyor S-2742, hereby certify that this preliminary plat is a true representation of all the adjacent existing land divisions and of the boundary of the preliminary plat and features and that I have fully complied with the City of Madison Subdivision Ordinance.
 Dated this 25th day of October, 2016.
 Brett T. Stoffregen, Professional Land Surveyor S-2742

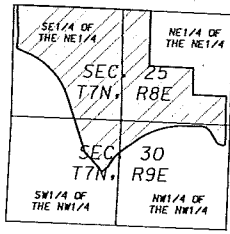

ZONING
 EXISTING - LOTS 1-4: MUC
 PROPOSED - LOT 1: SE



CURVE TABLE

| CURVE NUMBER | LOT | RADIUS (FEET) | CHORD (FEET) | ARC (FEET) | CHORD BEARING | CENTRAL ANGLE | TANGENT BEARING |
|--------------|-----|---------------|--------------|------------|---------------|---------------|-----------------|
| 1 | | 87.00 | 87.06 | 91.17 | S29°31'18"W | 60°02'36" | |
| 2 | | 153.00 | 153.85 | 161.20 | S29°21'36"W | 60°22'00" | |
| 3 | | 366.00 | 591.41 | 601.05 | S18°38'24"E | 35°39'00" | |
| 4 | | 483.00 | 204.25 | 205.80 | S48°40'48"E | 24°24'48" | |
| 5 | | 340.00 | 34.64 | 34.68 | S50°20'44"W | 05°46'16" | IN-S53°13'52"W |
| 6 | | 510.04 | 62.10 | 62.14 | S74°15'21"W | 06°58'50" | IN-S77°44'46"W |
| 7 | | 860.00 | 686.38 | 706.05 | S47°14'46"W | 47°02'20" | |
| 8 | | 860.00 | 313.35 | 315.11 | S60°16'07"W | 20°59'38" | |
| 9 | | 860.00 | 34.41 | 34.45 | S48°37'31"W | 06°17'34" | |
| 10 | | 860.00 | 235.01 | 236.48 | S33°36'10"W | 18°45'08" | |
| 11 | | 25.00 | 31.93 | 36.64 | S63°25'11"W | 79°23'10" | IN-S23°43'36"W |
| 12 | | 530.00 | 178.03 | 178.71 | N85°33'52.5"W | 17°21'17" | IN-N76°53'14"W |
| 13 | | 299.00 | 16.32 | 16.32 | N82°10'30"W | 03°07'40" | IN-N83°44'20"W |
| 14 | | 183.00 | 145.48 | 149.62 | S21°54'41"E | 46°50'38" | OUT-N80°36'40"W |
| 15 | | 15.00 | 20.59 | 23.25 | S00°55'38"E | 88°40'44" | OUT-S43°28'44"W |
| 16 | | 15.00 | 20.25 | 22.23 | N87°46'51"W | 84°53'42" | IN-S49°46'18"W |
| 17 | | 117.00 | 93.01 | 95.66 | N21°54'41"W | 46°50'38" | |

- LEGEND**
- PLACED 3/4" (18" FROM NEAR
 - (1" = 1.50 LBS/FT)
 - FOUND 3/4" (18" FROM NEAR
 - FOUND 1-1/4" (18" FROM NEAR
 - UNDERGROUND ELECTRIC
 - SANITARY SEWER
 - WATER MAIN
 - GAS MAIN
 - OVERHEAD ELECTRIC
 - UNDERGROUND TELEPHONE
 - STOP SIGN
 - ELECTRIC TRANSFORMER
 - MANHOLE
 - CATCH BASIN/INLET
 - POWER POLE W/OUT
 - LIGHT POLE
 - TELEPHONE PEDIESTAL
 - VALVE
 - HYDRANT
 - SIGN
 - CONCRETE CURB AND GUTTER
 - EXISTING CENTERLINE

D'ONOFRIO KOTKE AND ASSOCIATES, INC.
 7530 Wisconsin Way, Madison, WI 53717
 Phone: 608.833.7530 • Fax: 608.833.1089
 YOUR NATURAL RESOURCE FOR LAND DEVELOPMENT

PRELIMINARY PLAT
CUNA LANDS

LOT 2 AND PART OF LOT 3, CERTIFIED SURVEY MAP NO. 4896 AND PART OF VACATED/DISCONTINUED RESEARCH PARK BOULEVARD, LOCATED IN THE NE 1/4 AND THE SE 1/4 OF THE NE 1/4 OF SECTION 25, T7N, R8E AND IN THE NW 1/4 AND THE SW 1/4 OF THE NW 1/4 OF SECTION 30, T7N, R9E, CITY OF MADISON, DANE COUNTY, WISCONSIN



SCALE: 1" = 100'
 (PAGE SIZE: 24x36)
 0 100

DATE: 10-25-16
REVISED:

FN: 16-07-113
 Sheet Number:
 1 of 1