









Madison, Wisconsin

CITY OF MADISON
CITY ENGINEERING DIVISION
DEPARTMENT OF PUBLIC WORKS
PLAN OF PROPOSED IMPROVEMENT
5102 SPRING COURT
PRIVATE DRIVEWAY EASEMENT

PROJECT NO. 53W0470

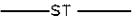
CONVENTIONAL SIGNS

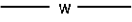
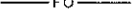
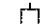
- COMBUSTIBLE FLUIDS**  CAUTION
- UNDERGROUND UTILITIES**
- GAS  G
 - ELECTRIC  E
 - TELEPHONE OR TELEGRAPH  T
 - STORM SEWER  ST
 - SANITARY SEWER  SAN
 - WATER  W
 - FIBER OPTICS TELEPHONE  FO
 - POWER POLE 

INDEX OF SHEETS

SHEET NO.	1	TITLE
SHEET NO.	P-1	PLAN - ASPHALT DRIVEWAY

PUBLIC IMPROVEMENT PROJECT APPROVED BY:

[Signature] 6/18/07
 City Engineer Date

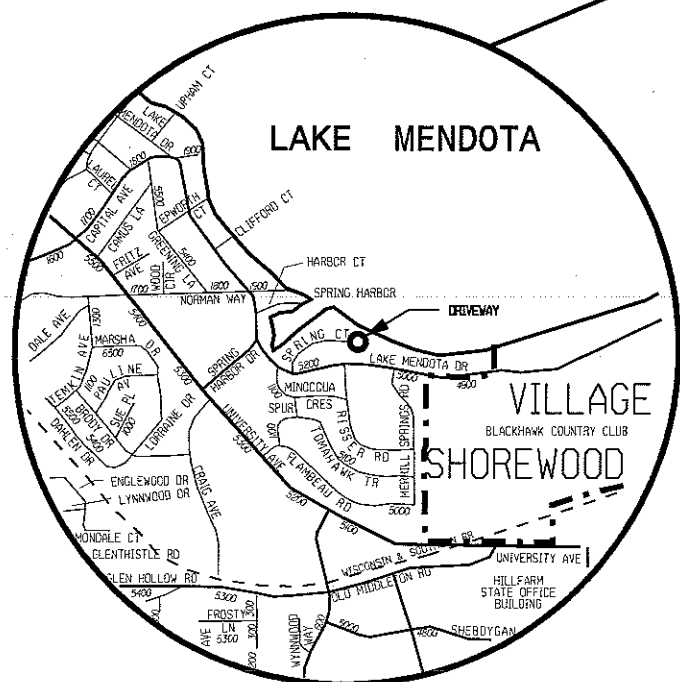
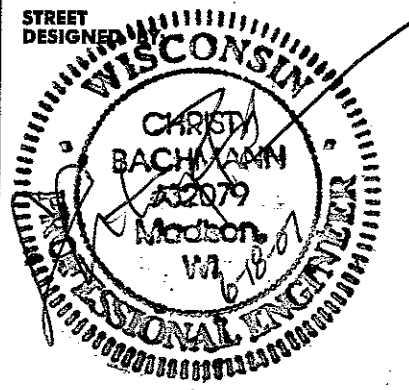

PROJECT LOCATION

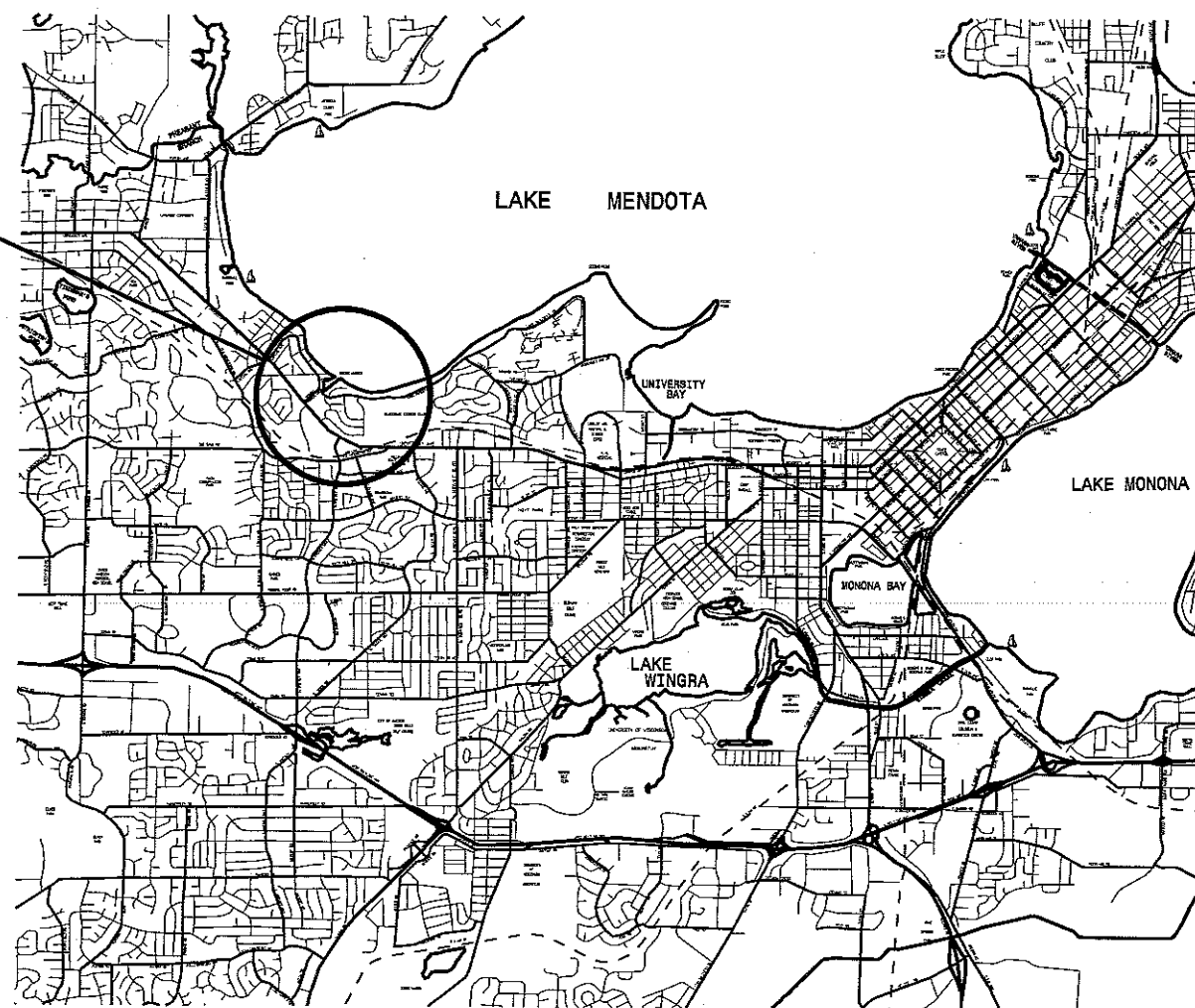
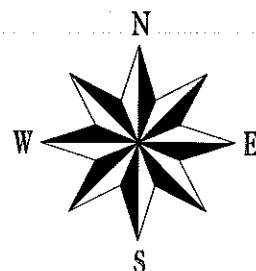



SCALE 1"=10'

INSTALL (2) 6" Dia BOLLARDS
 SCH 40 STEEL PIPE
 6"X78", WALL TH=0.280"
 MIN 42" CONCRETE EMBEDMENT
 PAINTED SAFTEY YELLOW

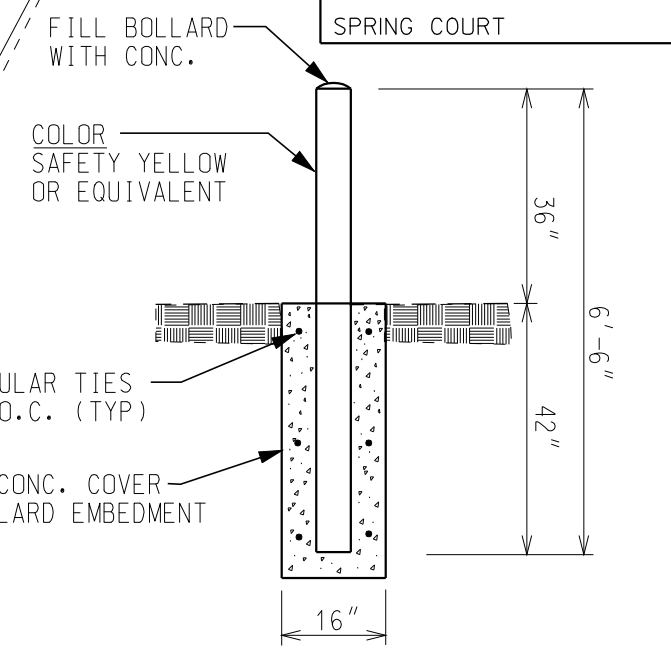
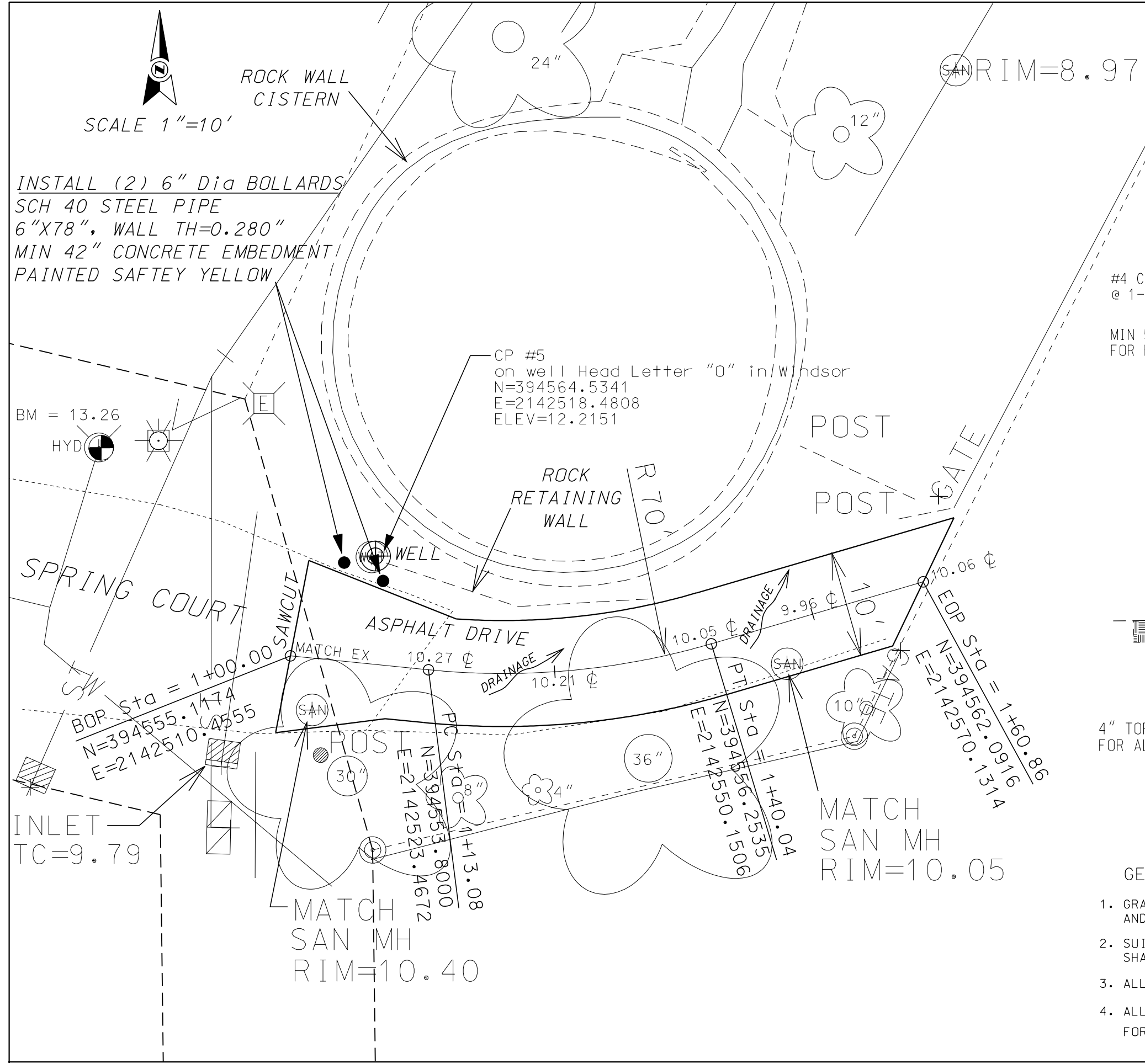

TYPICAL BOLLARD INSTALLATION

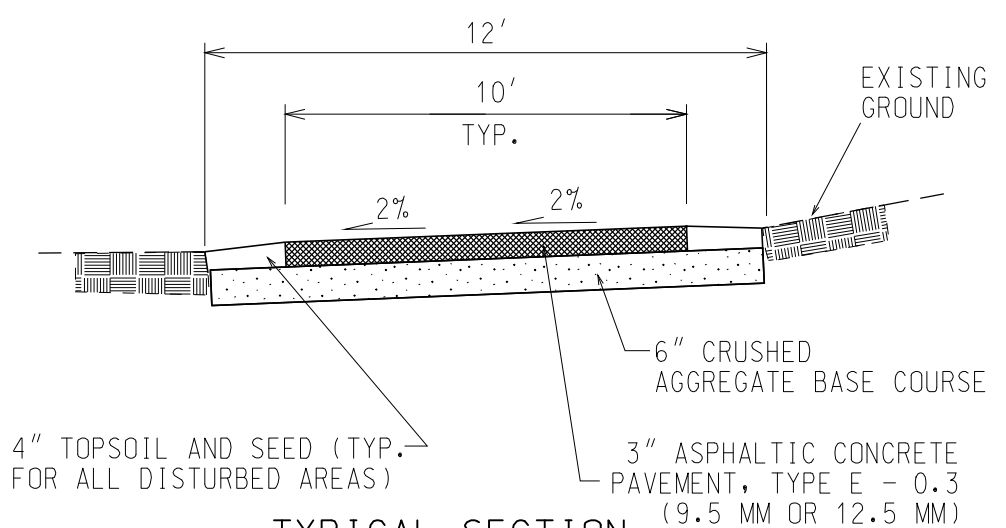

TYPICAL SECTION ASPHALT DRIVEWAY

CITY OF MADISON
 ENGINEERING DIVISION

GENERAL NOTES:

1. GRADING SHALL INCLUDE REMOVING VEGETATION AND TOPSOIL, SHAPING AND COMPACTING THE SUBBASE.
2. SUITABLE FILL AS REQUIRED TO OBTAIN A SUITABLE CROSS SECTION SHALL BE PLACED AND COMPACTED IN 6 INCH MAXIMUM LIFTS.
3. ALL DISTURBED AREAS SHALL BE TOPSOILED AND SEEDED.
4. ALL WORK SHALL COMPLY WITH CITY OF MADISON STANDARD SPECIFICATIONS FOR PUBLIC WORKS CONSTRUCTION, 2007 ED.

PLOT SCALE:

PLOT NAME:

REV. DATE:

ORIGINATOR: CITY OF MADISON, STREETS DIVISION