

NOTICE OF PUBLIC HEARING

mailed 3/24/06

The Common Council of the City of Madison having before it for consideration a proposed ordinance relating to zoning and city planning.

NOTICE IS HEREBY GIVEN, that a public hearing will be held in the Council Chambers, Room 201, in the City-County Building on Monday, April 3, 2006 at 6:00 p.m. before the Plan Commission, where opportunity will be afforded to all interested in being heard; and on Tuesday, April 18, 2006 at 6:45 p.m. before the regular meeting of the Common Council, at which time action on the ordinance will be considered.

Public Hearing items may be called at any time after the beginning of the Plan Commission public hearings – 6:00 pm. Anyone wishing to speak on an item must fill out a registration slip and give it to the person running the meeting. The registration slips are on a table near the front of the meeting room, just inside the doors to the room.

The Plan Commission uses a “consent agenda”, which means that the Commission can consider any item at 6:00 pm, if there are no registrants wishing to speak in opposition regardless of where the item is listed on the agenda”.

THE PROPERTY TO BE REZONED IS LOCATED AT 3540 Atwood Ave

Ordinance File # 03140

Sponsor: Common Council By Petition

Common Council of the City of Madison do hereby ordain as follows:

WHEREAS, a PUD(GDP) Planned Unit Development (General Development Plan) District has been duly filed for approval of the Madison Common Council and is hereby made an integral component of the zoning district regulations.

NOW, THEREFORE, the Common Council of the City of Madison do ordain as follows: Paragraph 3172. of Subdivision (a) of Subsection (2) of Section 28.06 of the Madison General Ordinances is hereby created to read as follows:

"28.06(2)(a) 3172. The following described property is hereby omitted from the C1 Limited Commercial District and R2 Single-Family Residence District and added to the PUD(GDP) Planned Unit Development (General Development Plan) District:

"Lots One (1), Two (2), and Three (3), Block One (1), Walterscheit Plat, in the City of Madison, Dane County Wisconsin, except that part of Lot Three (3) having been acquired by the City of Madison pursuant to an Award of Damages contained in instrument recorded on March 14, 1966 in Volume 441 of Misc., page 228 as Document No. 1155971. This parcel contains 14,553 square feet."

WHEREAS, a PUD(SIP) Planned Unit Development (Specific Implementation Plan) District has been duly filed for approval of the Madison Common Council and is hereby made an integral component of the zoning district regulations.

NOW, THEREFORE, the Common Council of the City of Madison do ordain as follows:

Paragraph 3173. of Subdivision (a) of Subsection (2) of Section 28.06 of the Madison General Ordinances is hereby created to read as follows:

"28.06(2)(a)3173. The following described property is hereby omitted from the PUD(GDP) Planned Unit Development (General Development Plan) District and added to the PUD(SIP) Planned Unit Development (Specific Implementation Plan) District:

"Lots One (1), Two (2), and Three (3), Block One (1), Walterscheit Plat, in the City of Madison, Dane County Wisconsin, except that part of Lot Three (3) having been acquired by the City of Madison pursuant to an Award of Damages contained in instrument recorded on March 14, 1966 in Volume 441 of Misc., page 228 as Document No. 1155971. This parcel contains 14,553 square feet."

TCT: March 20 & 27, 2006 SHARON CHRISTENSEN, DEPUTY CITY CLERK

CITY OF MADISON

Proposed Demolition & Rezoning

Location: 3540 Atwood Avenue
Applicant: John Sveum - Yahara Builders, Inc
From C1 & R2 District(s)
To PUD(GDP-SIP) District(s)
Existing Use: Vacant Service Station
Demolish Former Service Station and
Proposed Use: Convenience Store and Build 5-Story,
16-Unit Condominium Building
File No. _____
Public Hearing Dates: _____
Plan Commission 03 April 2006
Common Council 18 April 2006

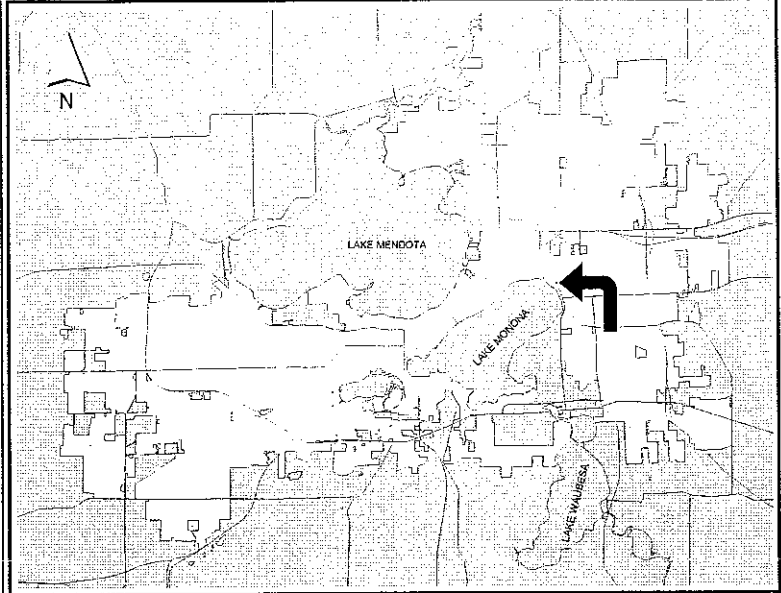

For Questions contact: Pete Olson at 267-1150 or polson@cityofmadison.com or City Planning at 266-4635

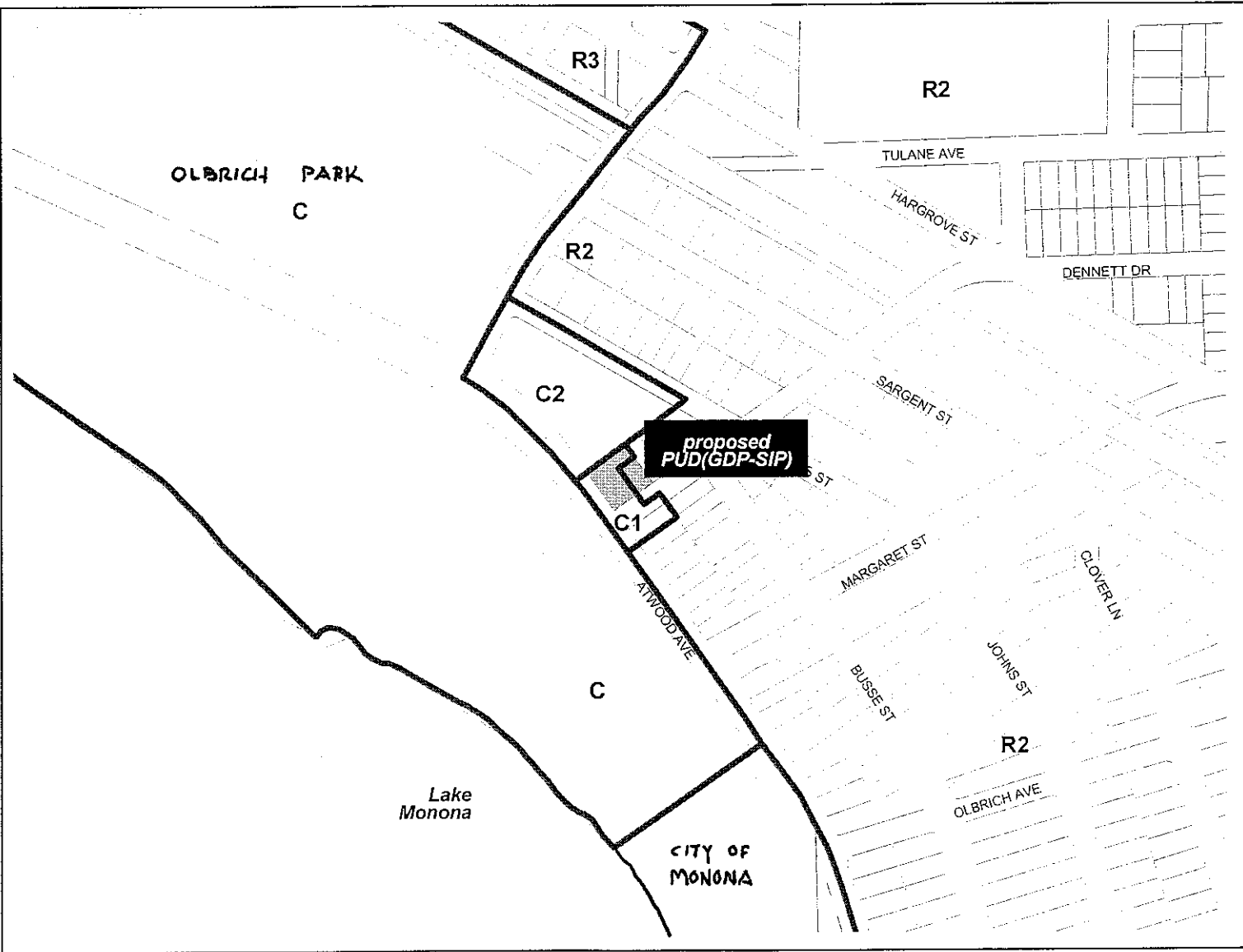

Scale: 1" = 400' Planning Unit, Department of Planning & Development: rpj Date: 21 March 2006

CITY OF MADISON

Proposed Demolition & Rezoning

Location: 3540 Atwood Avenue
Applicant: John Sveum - Yahara Builders, Inc
From C1 & R2 District(s)
To PUD(GDP-SIP) District(s)
Existing Use: Vacant Service Station
Demolish Former Service Station and
Proposed Use: Convenience Store and Build 5-Story,
16-Unit Condominium Building
File No. _____
Public Hearing Dates: _____
Plan Commission 03 April 2006
Common Council 18 April 2006

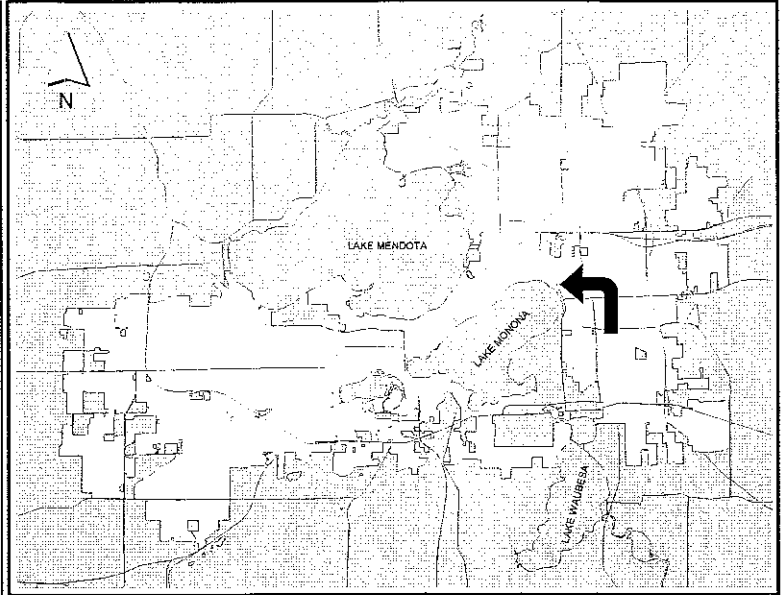

For Questions contact: Pete Olson at 267-1150 or polson@cityofmadison.com or City Planning at 266-4635

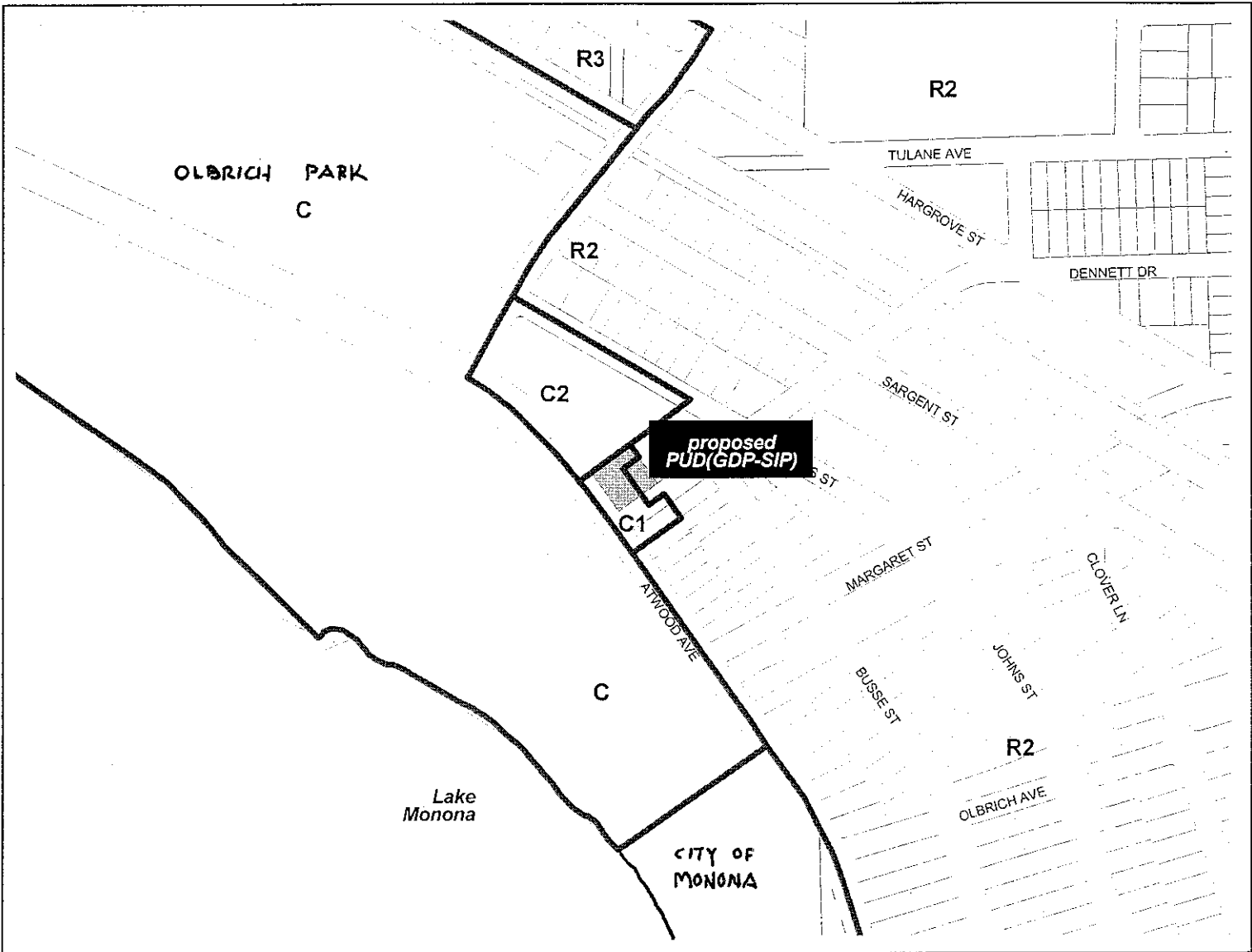

COMMON COUNCIL OFFICE
LISA VELDRAN
417 CCB

21 Copies

CITY TRAFFIC ENGINEER
DAN MCCORMICK
MMB

DANE COUNTY ZONING ADMIN
116 CCB

CITY PLANNING & DEVELOPMENT
MARK OLINGER
MMB

CITY ENGINEER
GARY DALLMANN
115 CCB

WATER UTILITY
AL LARSON
~~523 E MAIN ST~~

119 E Olson Ave

BOARD OF EDUCATION
545 W DAYTON ST
MADISON WI 53703

AIRPORT DIRECTOR
DANE COUNTY REGIONAL AIRPORT
4000 INTERNATIONAL LN
MADISON WI 53704



3540aa 0710-081-0306-3
Location: 3518 Dennett Dr
ANDERSON, PETER S
3518 DENNETT DR
MADISON WI 53714-2820

3540aa 0710-081-0305-5
Location: 3514 Dennett Dr
ANDRUSS, ALBERT & BRENDA
3514 DENNETT DR
MADISON WI 53714-2820

3540aa 0710-081-0510-0
Location: 3602 Atwood Ave
BLANEY, LLOYD J
605 OWEN RD
MONONA WI 53716-3441

3540aa 0710-081-0701-5
Location: 3527 Atwood Ave
CITY OF MADISON PARKS
OLBRICH BEACH HOUSE
215 MLK JR BLVD STE 120
MADISON WI 53703-3348

3540aa 0710-081-0505-1
Location: 3617 Busse St
CLAVEY, CAROL V
3617 BUSSE ST
MADISON WI 53714-2813

3540aa 0710-081-0308-9
Location: 3526 Dennett Dr
DREW, KATHLEEN A
3526 DENNETT DR
MADISON WI 53714-2820

3540aa 0710-081-0222-1
Location: 3538 Johns St
GOTTSCHALL, MARCELLA E
3538 JOHNS ST
MADISON WI 53714-2822

3540aa 0710-081-0509-3
Location: 3601 Busse St
KARAS, RAYMOND & JOYCE
3601 BUSSE ST
MADISON WI 53714-2813

3540aa 0710-081-0513-4
Location: 3614 Atwood Ave
LANDSVERK, SUSAN A &
CASEY LANDSVERK-MCCONNELL
3614 ATWOOD AVE
MADISON WI 53714-2808

3540aa 0710-081-0507-7
Location: 3609 Busse St
LYMAN, ALICE E
& TIMOTHY A POMEROY
3609 BUSSE ST
MADISON WI 53714-2813

3540aa 0710-081-0508-5
Location: 3605 Busse St
MOORE, CHRISTOPHER J
& JANINE N CHAMBERLAIN
3605 BUSSE ST
MADISON WI 53714

3540aa 0710-081-0221-3
Location: 3534 Johns St
NARF, DENNIS M
3534 JOHNS ST
MADISON WI 53714-2822

3540aa 0710-081-0302-1
Location: 3528 Atwood Ave # 100
OCCUPANT
3528 Atwood Ave # 100
Madison WI 53714

3540aa 0710-081-0302-1
Location: 3528 Atwood Ave # 101
OCCUPANT
3528 Atwood Ave # 101
Madison WI 53714

3540aa 0710-081-0302-1
Location: 3528 Atwood Ave # 102
OCCUPANT
3528 Atwood Ave # 102
Madison WI 53714

3540aa 0710-081-0302-1
Location: 3528 Atwood Ave # 103
OCCUPANT
3528 Atwood Ave # 103
Madison WI 53714

3540aa 0710-081-0302-1
Location: 3528 Atwood Ave # 105
OCCUPANT
3528 Atwood Ave # 105
Madison WI 53714

3540aa 0710-081-0302-1
Location: 3528 Atwood Ave # 106
OCCUPANT
3528 Atwood Ave # 106
Madison WI 53714

3540aa 0710-081-0302-1
Location: 3528 Atwood Ave # 107
OCCUPANT
3528 Atwood Ave # 107
Madison WI 53714

3540aa 0710-081-0302-1
Location: 3528 Atwood Ave # 108
OCCUPANT
3528 Atwood Ave # 108
Madison WI 53714

3540aa 0710-081-0302-1
Location: 3528 Atwood Ave # 109
OCCUPANT
3528 Atwood Ave # 109
Madison WI 53714

3540aa 0710-081-0302-1
Location: 3528 Atwood Ave # 110
OCCUPANT
3528 Atwood Ave # 110
Madison WI 53714

3540aa 0710-081-0302-1
Location: 3528 Atwood Ave # 111
OCCUPANT
3528 Atwood Ave # 111
Madison WI 53714

3540aa 0710-081-0302-1
Location: 3528 Atwood Ave # 112
OCCUPANT
3528 Atwood Ave # 112
Madison WI 53714

3540aa 0710-081-0302-1
Location: 3528 Atwood Ave # 113
OCCUPANT
3528 Atwood Ave # 113
Madison WI 53714

3540aa 0710-081-0302-1
Location: 3528 Atwood Ave # 114
OCCUPANT
3528 Atwood Ave # 114
Madison WI 53714

3540aa 0710-081-0302-1
Location: 3528 Atwood Ave # 115
OCCUPANT
3528 Atwood Ave # 115
Madison WI 53714

3540aa 0710-081-0302-1
Location: 3528 Atwood Ave # 117
OCCUPANT
3528 Atwood Ave # 117
Madison WI 53714

3540aa 0710-081-0302-1
Location: 3528 Atwood Ave # 118
OCCUPANT
3528 Atwood Ave # 118
Madison WI 53714

3540aa 0710-081-0302-1
Location: 3528 Atwood Ave # 119
OCCUPANT
3528 Atwood Ave # 119
Madison WI 53714

3540aa 0710-081-0302-1
Location: 3528 Atwood Ave # 200
OCCUPANT
3528 Atwood Ave # 200
Madison WI 53714

3540aa 0710-081-0302-1
Location: 3528 Atwood Ave # 201
OCCUPANT
3528 Atwood Ave # 201
Madison WI 53714

3540aa 0710-081-0302-1
Location: 3528 Atwood Ave # 203
OCCUPANT
3528 Atwood Ave # 203
Madison WI 53714

3540aa 0710-081-0302-1
Location: 3528 Atwood Ave # 204
OCCUPANT
3528 Atwood Ave # 204
Madison WI 53714

3540aa 0710-081-0302-1
Location: 3528 Atwood Ave # 205
OCCUPANT
3528 Atwood Ave # 205
Madison WI 53714

3540aa 0710-081-0302-1
Location: 3528 Atwood Ave # 206
OCCUPANT
3528 Atwood Ave # 206
Madison WI 53714

3540aa 0710-081-0302-1
Location: 3528 Atwood Ave # 208
OCCUPANT
3528 Atwood Ave # 208
Madison WI 53714

3540aa 0710-081-0302-1
Location: 3528 Atwood Ave # 209
OCCUPANT
3528 Atwood Ave # 209
Madison WI 53714

3540aa 0710-081-0302-1
Location: 3528 Atwood Ave # 210
OCCUPANT
3528 Atwood Ave # 210
Madison WI 53714

3540aa 0710-081-0302-1
Location: 3528 Atwood Ave # 211
OCCUPANT
3528 Atwood Ave # 211
Madison WI 53714

3540aa 0710-081-0302-1
Location: 3528 Atwood Ave # 212
OCCUPANT
3528 Atwood Ave # 212
Madison WI 53714

3540aa 0710-081-0302-1
Location: 3528 Atwood Ave # 213
OCCUPANT
3528 Atwood Ave # 213
Madison WI 53714

3540aa 0710-081-0302-1
Location: 3528 Atwood Ave # 214
OCCUPANT
3528 Atwood Ave # 214
Madison WI 53714

3540aa 0710-081-0302-1
Location: 3528 Atwood Ave # 215
OCCUPANT
3528 Atwood Ave # 215
Madison WI 53714

3540aa 0710-081-0302-1
Location: 3528 Atwood Ave # 216
OCCUPANT
3528 Atwood Ave # 216
Madison WI 53714

3540aa 0710-081-0302-1
Location: 3528 Atwood Ave # 217
OCCUPANT
3528 Atwood Ave # 217
Madison WI 53714

3540aa 0710-081-0302-1
Location: 3528 Atwood Ave # 218
OCCUPANT
3528 Atwood Ave # 218
Madison WI 53714

3540aa 0710-081-0302-1
Location: 3528 Atwood Ave # 219
OCCUPANT
3528 Atwood Ave # 219
Madison WI 53714

3540aa 0710-081-0302-1
Location: 3528 Atwood Ave # 300
OCCUPANT
3528 Atwood Ave # 300
Madison WI 53714

3540aa 0710-081-0302-1
Location: 3528 Atwood Ave # 301
OCCUPANT
3528 Atwood Ave # 301
Madison WI 53714

3540aa 0710-081-0302-1
Location: 3528 Atwood Ave # 302
OCCUPANT
3528 Atwood Ave # 302
Madison WI 53714

3540aa 0710-081-0302-1
Location: 3528 Atwood Ave # 303
OCCUPANT
3528 Atwood Ave # 303
Madison WI 53714

3540aa 0710-081-0302-1
Location: 3528 Atwood Ave # 305
OCCUPANT
3528 Atwood Ave # 305
Madison WI 53714

3540aa 0710-081-0302-1
Location: 3528 Atwood Ave # 306
OCCUPANT
3528 Atwood Ave # 306
Madison WI 53714

3540aa 0710-081-0302-1
Location: 3528 Atwood Ave # 307
OCCUPANT
3528 Atwood Ave # 307
Madison WI 53714

3540aa 0710-081-0302-1
Location: 3528 Atwood Ave # 308
OCCUPANT
3528 Atwood Ave # 308
Madison WI 53714

3540aa 0710-081-0302-1
Location: 3528 Atwood Ave # 309
OCCUPANT
3528 Atwood Ave # 309
Madison WI 53714

3540aa 0710-081-0302-1
Location: 3528 Atwood Ave # 310
OCCUPANT
3528 Atwood Ave # 310
Madison WI 53714

3540aa 0710-081-0302-1
Location: 3528 Atwood Ave # 311
OCCUPANT
3528 Atwood Ave # 311
Madison WI 53714

3540aa 0710-081-0302-1
Location: 3528 Atwood Ave # 312
OCCUPANT
3528 Atwood Ave # 312
Madison WI 53714

3540aa 0710-081-0302-1
Location: 3528 Atwood Ave # 313
OCCUPANT
3528 Atwood Ave # 313
Madison WI 53714

3540aa 0710-081-0302-1
Location: 3528 Atwood Ave # 314
OCCUPANT
3528 Atwood Ave # 314
Madison WI 53714

3540aa 0710-081-0302-1
Location: 3528 Atwood Ave # 315
OCCUPANT
3528 Atwood Ave # 315
Madison WI 53714

3540aa 0710-081-0302-1
Location: 3528 Atwood Ave # 316
OCCUPANT
3528 Atwood Ave # 316
Madison WI 53714

3540aa 0710-081-0302-1
Location: 3528 Atwood Ave # 317
OCCUPANT
3528 Atwood Ave # 317
Madison WI 53714

3540aa 0710-081-0302-1
Location: 3528 Atwood Ave # 318
OCCUPANT
3528 Atwood Ave # 318
Madison WI 53714

3540aa 0710-081-0302-1
Location: 3528 Atwood Ave # 319
OCCUPANT
3528 Atwood Ave # 319
Madison WI 53714

3540aa 0710-081-0302-1
Location: 3528 Atwood Ave # 320
OCCUPANT
3528 Atwood Ave # 320
Madison WI 53714

3540aa 0710-081-0302-1
Location: 3528 Atwood Ave # 321
OCCUPANT
3528 Atwood Ave # 321
Madison WI 53714

3540aa 0710-081-0302-1
Location: 3528 Atwood Ave # 322
OCCUPANT
3528 Atwood Ave # 322
Madison WI 53714

3540aa 0710-081-0302-1
Location: 3528 Atwood Ave # 323
OCCUPANT
3528 Atwood Ave # 323
Madison WI 53714

3540aa 0710-081-0302-1
Location: 3528 Atwood Ave # 324
OCCUPANT
3528 Atwood Ave # 324
Madison WI 53714

3540aa 0710-081-0302-1
Location: 3528 Atwood Ave # 325
OCCUPANT
3528 Atwood Ave # 325
Madison WI 53714

3540aa 0710-081-0302-1
Location: 3534 Atwood Ave
OCCUPANT
3534 Atwood Ave
Madison WI 53714

3540aa 0710-081-0304-7
Location: 3540 Atwood Ave
OCCUPANT
3540 Atwood Ave
Madison WI 53714

3540aa 0710-081-0510-0
Location: 3602 Atwood Ave
OCCUPANT
3602 Atwood Ave
Madison WI 53714

3540aa 0710-081-0302-1
Location: 3528 Atwood Ave
OLBRICH BY THE LAKE ASSOC
LLC
2428 PERRY ST
MADISON WI 53713

3540aa 0710-081-0304-7
Location: 3502 Dennett Dr
PARK EAST LLC
3650 LAKEVIEW DR
STOUGHTON WI 53589

3540aa 0710-081-0403-7
Location: 3601 Johns St
PATERSON, DAVID P & NANCY
3601 JOHNS ST
MADISON WI 53714-2823

3540aa 0710-081-0223-9
Location: 3540 Johns St
PRIHODA, GEORGE W
3540 JOHNS ST
MADISON WI 53714-2822

3540aa 0710-081-0511-8
Location: 3606 Atwood Ave
PROBST, A J
3610 ATWOOD AVE
MADISON WI 53714-2808

3540aa 0710-081-0512-6
Location: 3610 Atwood Ave
PROBST, VIRGINIA
3610 ATWOOD AVE
MADISON WI 53714-2808

3540aa 0710-081-0224-7
Location: 3542 Johns St
RAIHALA, FRANK W
& JOAN A RAIHALA
3542 JOHNS ST
MADISON WI 53714-2822

3540aa 0710-081-0307-1
Location: 3522 Dennett Dr
SKAIFE, JEFFERY L
3522 DENNETT DR
MADISON WI 53714-2820

3540aa 0710-081-0404-5
Location: 3606 Busse St
SPANN, SANDRA H
3606 BUSSE ST
MADISON WI 53714-2814

r3540aa 4-3
Larry Palm
Alder District 15
City of Madison Common Council
Room 417 CCB

r3540aa 4-3
Eastmorland Community Assn.
Kathy Soukup
PO Box 14584
Madison WI 53714-0584