

AFFIDAVIT OF MAILING

STATE OF WISCONSIN)
) ss.
COUNTY OF DANE)

 JOHANNA JOHNSON, being first duly sworn on oath, deposes and says that:

1. She is a Program Assistant 3 with the Office of the City Engineer, City of Madison, Dane County, Wisconsin, and did on the 8 day of SEPTEMBER, 2016 placed in envelopes addressed to each interested owner of respective addresses as indicated by attached assessment list, a true and correct copy of the notice of assessments for the project titled WOODROW STREET RECONSTRUCTION ASSESSMENT DISTRICT - 2016 attached hereto.
2. She did and delivered the envelopes to the Mail Room of the Dane County Printing and Services Division, 210 Martin Luther King, Jr. Blvd., in the city of Madison, Dane County Wisconsin, for postage and depositing in the United States Mail.

Johanna L. Johnson

Johanna L. Johnson

Subscribed and sworn to before me
this 8 day of SEPTEMBER, 2016

Eric A. Christianson

Notary Public, State of Wisconsin
My Commission expires:





Department of Public Works
Engineering Division
Robert F. Phillips, P.E., City Engineer

Parcel Number: 0709-281-1704-7
Situs Address: 890 Woodrow St
**TURNER, MATTHEW D
& REBECCA J MAY**
890 WOODROW ST
MADISON, WI 53711-0000

Assistant City Engineer
Michael R. Dailey, P.E.
Principal Engineer2
Gregory T. Fries, P.E.
Christopher J. Petykowski, P.E.
Principal Engineer1
Christina M. Bachmann, P.E.
Eric L. Dundee, P.E.
John S. Fahmey, P.E.
Facilities & Sustainability
Jeanne E. Hoffman, Manager
Operations Manager
Kathleen M. Cryan
Mapping Section Manager
Eric T. Pederson P.S.
Financial Manager
Steven B. Danner-Rivers

September 8, 2016

To: Property Owners along Woodrow Street

Re: Project 10906 Proposed Street Reconstruction Project & Public Hearing

The City of Madison is proposing reconstruct the above referenced street in 2017. Enclosed with this letter is a fact sheet with some details on the proposed project along with a notification for the Public Hearing before the Board of Public Works. The date, time and location of the public hearing can be found on the notification.

This project will involve special assessments to the owners of property adjacent to the project. The property owners will be assessed for various items included with this proposed project. The costs of some items are shared between the property owner and the City, while other costs are assessed entirely to the property owner. A table detailing the City's standard assessment policy for these items is included in the fact sheet.

Also enclosed is a Schedule of Assessments, which shows the property owner's share of estimated costs for each property adjacent to the project. After the work is complete, a final assessment will be calculated based on bid prices and work actually performed. The final assessment, which will be billed after the completion of the project, is payable in one lump sum or over a period of 8 years, with 3.0% interest charged on the unpaid balance.

To request accommodations for special needs or disabilities, or if you have any other questions regarding this project, please contact the Project Engineer. This includes requests relating to the Public Hearing and also requests relating to the actual operations of construction. A list of contacts for this project can be found on the enclosed fact sheet.

Sincerely,

Robert F. Phillips, P.E.
City Engineer

RFP:lrc
Cc by email:

Alder Sara Eskrich
Daniel Olivares, City Engineering
Mark Moder, City Engineering
Chris Kelley, Streets Division
Dane County 911
Tim Sobota, Madison Metro Transit
Marla Eddy, City Forestry
Ed Ruckriegel, Fire Department
Cindy Mierow, Police Department

Yang Tao, Traffic Engineering
Chris Petykowski, City Engineering
Kelly Miess, Water Utility
Christy Bachmann, City Engineering

(over)

Michael LaCount, MMSD mlacount@madison.k12.wi.us
Mick Howan, Madison School District Transportation, mjhowan@madison.k12.wi.us
Debra Kendrea Stamps, Madison School District Transportation, dbstamps@madison.k12.wi.us
Jeff Fedler, Madison School District Transportation Coordinator, jfedler@madison.k12.wi.us
Bob Byington, Madison School District Transportation, rlbyington@madison.k12.wi.us
Sandra Mell, Madison School District Transportation, smell@madison.k12.wi.us
Jason Fenske, Badger Bus Lines, jasonf@badgerbus.com
Susan VanderSanden, Edgewood College, SVanderSanden@edgewood.edu
Bob Growney, Edgewood High School, robert.growney@edgewoodhs.org
Anne Palzkill, Edgewood Elementary, apalzkill@edgewood.edu

**NOTICE OF PUBLIC HEARING
BEFORE THE BOARD OF PUBLIC WORKS
FOR
PLANS, SPECIFICATIONS, AND SPECIAL ASSESSMENTS
FOR
PUBLIC WORKS IMPROVEMENTS
MADISON, WISCONSIN**

PART I

The Common Council of the City of Madison, Wisconsin, having heretofore decided that it is expedient and necessary that the improvements as listed in Part II hereof be improved at the expense of the property thereby on which would be conferred some special benefit.

NOW, THEREFORE, NOTICE IS HEREBY GIVEN:

That the City Engineer has prepared plans, specifications, a proposed schedule of assessments, and an estimate of the entire costs of the improvement for each of the districts listed in Part II hereof, and;

That the plans, specifications, a proposed schedule of assessments, and an estimate of the entire cost of the improvements listed hereto are available and open to inspection by all interested persons in the office of the City Engineer, Room 115, City-County Building, 210 Martin Luther King Jr. Blvd., between the hours of 7:30 a.m. and 4:00 p.m., Monday through Friday, and will so continue to be for ten (10) working days from the first published date of this notice, and;

That on WEDNESDAY, SEPTEMBER 21, 2016 AT 5:30 P.M., the Board of Public Works will hold a public hearing in ROOM 108 (PARKS CONFERENCE ROOM) OF THE CITY COUNTY BUILDING and will consider any objections that may be filed in writing or in person and hear all persons desiring to be heard, and;

That special assessments may be paid over an eight (8) year period, with the owner paying 1/8 of the principal each year plus three (3%) percent interest on the unpaid balance, as determined by the Board of Public Works.

That if the total assessment is paid in full before October 31st in the year that the billing is made, irrespective of project completion, then no interest shall be charged.

If you require an interpreter, materials in alternate formats, or other accommodations to access this public hearing, please contact the Engineering Division at phone (608) 266-4751 or email us at engineering@cityofmadison.com. Please make contact at least 24 hours prior to the date of this public hearing so that we can make proper accommodations.

PART II

WOODROW STREET RECONSTRUCTION ASSESSMENT DISTRICT - 2016

By Order of the Board of Public Works
Madison, Wisconsin

PUB: WSJ SEPTEMBER 9, 2016

Fact and Details Sheet

Proposed Woodrow Street Reconstruction – Project 10906

Project Details – Proposed Work

Sanitary Sewer: The City will replace existing mains (installed in 1925 and 1957), and in most cases replace laterals from the main to the property line. In limited cases where the existing lateral is cast iron, appears to be in good condition upon inspection, and runs under a tree, the lateral will only be replaced to the back of curb. In those cases, the owner will not be assessed for the additional footage of replacement that is not completed. If you would like a full lateral replacement to the property line in cases such as this please contact the Sanitary Sewer Contact listed at right. (*laterals assessable*).

The existing sanitary sewer is currently routed toward Terry Place, though the side yard between 852 and 856 Woodrow Street, which presents maintenance and operational difficulties. During the project, the sanitary sewer will be re-routed to connect into an existing sanitary manhole south of Edgewood Drive.

Water Main: Replace the existing water mains (installed in 1919, 1938), and reconnect services to the new main.

Storm Sewer: Replace and extend storm sewer installed in 1950, connect to private storm (typically from sump pumps or downspouts). If you are aware of any existing private storm sewer or private connections (either to the curb or to a structure) from your property please contact Daniel Olivares (*private connections assessable*).

Rain Gardens: Rain gardens may be installed at the request of property owners, if terrace is deemed by the City to be suitable for rain gardens. The following addresses may have suitable terraces: 820, 826, 830, 840, 866, 878, 890, 2329 Monroe. If you live at any of these addresses and are interested in having a rain garden, please contact Daniel Olivares by **10/1/2016** (*assessable*). The cost assessed to homeowners for rain gardens is \$100. More info on the terrace rain garden program is available here: <http://www.cityofmadison.com/engineering/stormwater/raingardens/terraceraingardens.cfm>

Street: Replace the pavement, the existing curb, the driveway aprons, and spot repairs of the existing sidewalk (*assessable*). Most of the newer curb on the east side of the street, south of Edgewood College Drive will remain. Overall street width will remain the same as exists today.

Because of the required sanitary sewer work, the area south of the Woodrow Street cul-du sac will be disturbed by the sanitary excavation. The existing bike path and turn-around at the west end of Edgewood Drive will be removed and replaced during the project.

Terrace Areas: Existing concrete terrace walkways will be replaced with the project, unless the property owner requests that they are removed. The entire terrace area and public right-of-way will likely be disturbed during the project, so owners should remove any plantings or special landscaping features from the terrace area and right-of-way, prior to the start of construction. Raised planting beds, railings, pavers, and the like, must be removed by the owner prior to the project.

Trees: The majority of the existing trees will remain, but tree removals are planned at the following addresses on Woodrow Street- 830, 840, 878, 938 (2 smaller trees in clearing near bike path), 863/901 (Edgewood College- 4 trees), 1000 Edgewood College Drive (Edgewood College-4 trees on Woodrow side of building). Tree removals are generally due to poor condition or are pre-emptive ash removals. The trees within the project limits that remain may be pruned, and/or the roots may be trimmed. Some of the trimming may occur in advance of the project, in Fall 2016. Terrace areas will be evaluated by Forestry for new trees or replacements following the project. For additional information from Forestry, see the back of this sheet.

In order to re-route the sanitary sewer, trees and brush will also need to be removed in an approximate 30' wide zone, extending about 100' south of the existing turn-around at the west end of Edgewood Drive.

Project Website: Updates will be posted here:
<http://www.cityofmadison.com/engineering/projects/>

Construction Schedule & Impacts

Tentative Schedule: April-July 2017

Traffic Impacts: The streets will be closed to through traffic within the project limits. The street will be open to local traffic (residents). Parking will be removed for the project duration. Residential driveways may be closed for up to 2 weeks. Bikes will be detoured off of Edgewood Drive.

Water Shut-offs: An average of two water shut-offs are expected for each property within the project limits. A minimum of 48 hours of notice will be provided prior to the shut-offs. Each shut-off may last up to 8 hours, but typically last about 4 hours. At the start of construction, the existing main will remain in service until the new main is installed and connected to; emergency shut-offs may occur if the old, brittle main is damaged during construction.

Refuse Collection: It will be the contractor's responsibility to allow for refuse collection to continue during construction. Please mark your address on your cart to make sure it is returned if moved.

Project Location Map

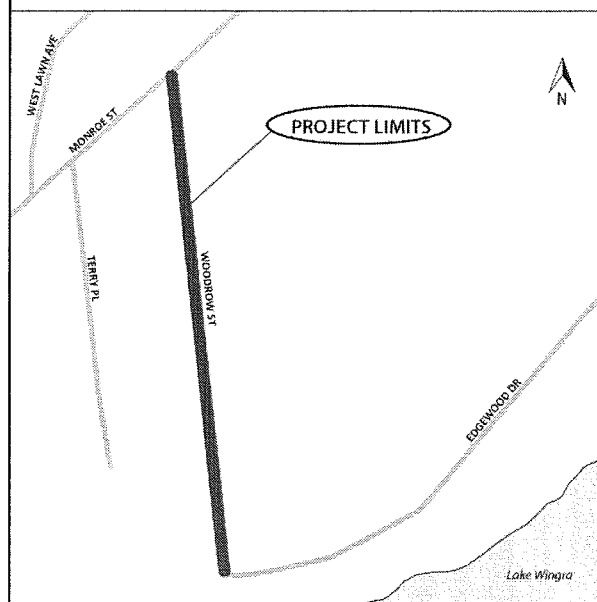

Project Contacts

Project Manager: Lisa Coleman – 266-4093,
lc Coleman@cityofmadison.com

Storm Sewer, Sanitary Sewer, Rain Gardens:
Daniel Olivares–261-9285
dolivares@cityofmadison.com

Water: Kelly Miess – 261-9640,
kmiess@madisonwater.org

Construction: John Fahrney – 266-9091,
jfahrney@cityofmadison.com

Forestry: Dean Kahl – 266-4891,
dkahl@cityofmadison.com

Assessment Policy Breakdown

Item	City Share	Owner Share
Curb, sidewalk, drive aprons	50%	50%
Sanitary Laterals	75%	25%
Private Storm Connection	0%	100%
Asphalt Pavement	100%	0%
Sanitary & Storm Mains	100%	0%
Water Main	100%	0%
Sidewalk Ramps	100%	0%
Rain Gardens	balance	\$100

Assessments are payable as a lump sum or over 8 years with 3% interest.

Supplemental Forestry Info

Tree pruning in advance of the project is required to reduce the risk of damage to the trees during construction. The City of Madison Forestry Section will perform the necessary work. For certain species, especially oak and elm trees, the pruning must be completed by April 1st to reduce the chance of disease. If additional trees need to be removed, City Forestry or City Engineering will notify the adjacent property owner prior to removal.

All ash street trees within the project limits have been or will be evaluated for potential chemical treatment for Emerald Ash Borer (EAB). Ash trees with trunks measuring less than 10" in diameter at 4.5 ft (DBH) from the ground, ash located under high voltage electric distribution lines, and ash that are structurally compromised or in poor condition will not be treated as outlined the City's EAB Plan. Ash trees that do not meet the treatment criteria will be removed prior to construction, and will be removed regardless of the construction project schedule. Including ash removals as part of the project will allow for a faster replacement timeframe. For more information about EAB and the City of Madison EAB response plan please see: <http://www.cityofmadison.com/parks/services/forestry/pests/EAB/index.cfm>.

Street trees provide many benefits to our city and are considered an important part of the city's infrastructure. Forestry Section staff will evaluate the terrace for new planting sites and potential replacement sites when the project is complete. There is no additional cost to the adjacent property owner for a tree planting. Street trees are typically planted in the spring of the year following the completion of the construction project. Per Madison General Ordinance 10.10, City Forestry determines tree species and planting locations. Residents cannot choose or plant their own tree in the terrace.

For any questions regarding street tree maintenance or planting, please contact Dean Kahl at 266-4891.

NOTE: A factor has been applied for sidewalk and curb and gutter work adjacent to lots that abut more than one street and are single-family or two-family residential dwellings.

Parcel No./ Zoning	Owner's Name/ Mailing Address	Site Address	Frontage (Assessor's) Measure ¹	Remove		Replace Drive		Street Reconstruction Items		Replace		Remove & Replace		Sanitary Sewer		Remove & Replace		Storm Sewer Items		Total Assmt					
				Drive Apron @ \$1.50 per SF	Cost	Apron @ \$4.00 per SF	Cost	Subwidth @ \$1.50 per Square Ft (SF)	Factor	Subwidth @ \$3.00 per Square Ft (SF)	Factor	Subwidth @ \$1.00 per Linear Foot (LF)	LF	Cost	Each	Cost	LF	Cost	Each		Cost	Each	Cost	Each	
0709-272-0099-2 C1, HSL	EDGEWOOD COND ASSN INC 1600 Edgewood College Dr MADISON WI	1600 Edgewood College Dr	1,498.74 L.F.	130,000	\$195,000	0.00	\$0.00	1.0	350.00	\$325.00	1.0	350.00	\$1,050.00	1.0	695.00	\$12,510.00	4.00	\$1,800.00	114.00	\$2,406.54	0.00	\$0.00	0.00	\$0.00	\$18,486.54
0709-231-1725-5 TR-C3	EDGEWOOD COLLEGE INC 1000 EDGEWOOD COLLEGE DR MADISON WI	2329 Monroe St	120.00 L.F.	0.00	\$0.00	0.00	\$0.00	0.5	0.00	\$0.00	0.5	0.00	\$0.00	1.0	40.00	\$720.00	1.00	\$450.00	32.00	\$675.52	0.00	\$0.00	0.00	\$0.00	\$1,135.00
0709-231-1728-7 TR-C3	DAVIS REV TRUST, RUTH M & C NEWVILLE GARTER 5740 MONTICELLO WAY MADISON WI	806 Woodrow St	40.00 L.F.	120.00	\$180.00	133.00	\$532.00	1.0	100.00	\$150.00	1.0	100.00	\$300.00	1.0	40.00	\$720.00	1.00	\$450.00	35.00	\$788.85	0.00	\$0.00	0.00	\$0.00	\$3,607.52
0709-231-1727-5 TR-C2	SOE A STATZ 810 WOODROW ST MADISON WI	810 Woodrow St	40.00 L.F.	106.00	\$159.00	106.00	\$424.00	1.0	100.00	\$150.00	1.0	100.00	\$300.00	1.0	40.00	\$720.00	1.00	\$450.00	34.00	\$771.74	0.00	\$0.00	0.00	\$0.00	\$2,092.74
0709-231-1726-1 TR-C2	ROBERT L HERBER 812 WOODROW ST MADISON WI	812 Woodrow St	40.00 L.F.	148.00	\$222.00	109.00	\$676.00	1.0	125.00	\$187.50	1.0	125.00	\$375.00	1.0	40.00	\$720.00	1.00	\$450.00	35.00	\$788.85	0.00	\$0.00	0.00	\$0.00	\$3,360.35
0709-231-1725-3 TR-C2	GARTER, MARK S & C NEWVILLE GARTER 820 WOODROW ST MADISON WI	820 Woodrow St	40.00 L.F.	130.00	\$195.00	133.00	\$532.00	1.0	125.00	\$187.50	1.0	125.00	\$375.00	1.0	40.00	\$720.00	1.00	\$450.00	35.00	\$788.85	0.00	\$0.00	0.00	\$0.00	\$3,198.35
0709-231-1724-5 TR-C2	SMITH, DONALD W 824 WOODROW ST MADISON WI	824 Woodrow St	40.00 L.F.	137.00	\$205.50	136.00	\$544.00	1.0	125.00	\$187.50	1.0	125.00	\$375.00	1.0	40.00	\$720.00	1.00	\$450.00	34.00	\$771.74	0.00	\$0.00	0.00	\$0.00	\$3,190.74
0709-231-1724-7 TR-C2	GAHRHEL, MCTAVISH TRUST 826 WOODROW ST MADISON WI	826 Woodrow St	40.00 L.F.	118.00	\$177.00	121.00	\$484.00	1.0	100.00	\$150.00	1.0	100.00	\$300.00	1.0	40.00	\$720.00	1.00	\$450.00	34.00	\$771.74	0.00	\$0.00	0.00	\$0.00	\$2,998.74
0709-231-1723-9 TR-C2	GILLES, LYNN TRUST 830 WOODROW ST MADISON WI	830 Woodrow St	40.00 L.F.	130.00	\$195.00	123.00	\$492.00	1.0	175.00	\$262.50	1.0	175.00	\$525.00	1.0	40.00	\$720.00	1.00	\$450.00	37.00	\$811.07	0.00	\$0.00	0.00	\$0.00	\$3,425.57
0709-231-1721-1 TR-C2	CLISICK, ANDREW P NICOLE M. LEVAKOV 836 WOODROW ST MADISON WI	836 Woodrow St	40.00 L.F.	139.00	\$208.50	139.00	\$556.00	1.0	125.00	\$187.50	1.0	125.00	\$375.00	1.0	40.00	\$720.00	1.00	\$450.00	39.00	\$823.29	0.00	\$0.00	0.00	\$0.00	\$3,320.29
0709-231-1720-3 TR-C2	BATTINDE, WILLIAM C & MARLA A L BATTINDE 838 WOODROW ST MADISON WI	838 Woodrow St	40.00 L.F.	96.00	\$144.00	115.00	\$460.00	1.0	150.00	\$225.00	1.0	150.00	\$450.00	1.0	40.00	\$720.00	1.00	\$450.00	39.00	\$823.29	0.00	\$0.00	0.00	\$0.00	\$3,272.29
0709-231-1719-6 TR-C2	GRAHAM, MICHAEL E ELIZABETH D GIBBS 840 WOODROW ST MADISON WI	840 Woodrow St	40.00 L.F.	119.00	\$178.50	131.00	\$524.00	1.0	125.00	\$187.50	1.0	125.00	\$375.00	1.0	40.00	\$720.00	1.00	\$450.00	34.00	\$771.74	0.00	\$0.00	0.00	\$0.00	\$3,151.74
0709-231-1718-8 TR-C2	KYANIKSI, THOMAS & ANDELA 842 WOODROW ST MADISON WI	842 Woodrow St	40.00 L.F.	95.00	\$144.00	101.00	\$404.00	1.0	100.00	\$150.00	1.0	100.00	\$300.00	1.0	40.00	\$720.00	1.00	\$450.00	34.00	\$771.74	0.00	\$0.00	0.00	\$0.00	\$2,885.74
0709-231-1717-0 TR-C2	PANICO, MATTHEW 844 WOODROW ST MADISON WI	844 Woodrow St	40.00 L.F.	122.00	\$183.00	117.00	\$468.00	1.0	100.00	\$150.00	1.0	100.00	\$300.00	1.0	40.00	\$720.00	1.00	\$450.00	34.00	\$771.74	0.00	\$0.00	0.00	\$0.00	\$2,986.74

City of Madison Engineering Division - Schedule of Assessments
9/8/2016

Project Name: Woodrow Street Reconstruction Assessment District - 2016
Project ID: 10906
Project Limits: Woodrow Street from Monroe Street to South end
Properties listed are for Woodrow

NOTE: A factor has been applied for sidewalk and curb and gutter work adjacent to lots that abut more than one street and are single-family or two-family residential dwellings.

Parcel No/ Zoning	Owner Name/ Mailing Address	Site Address	Frontage (Assessor's Mileage)	Remove		Replace		Remove & Replace		Sanitary Sewer		Storm Sewer		Total Assmt
				Depth (\$/SF)	Area (\$)	Depth (\$/SF)	Area (\$)	Depth (\$/SF)	Area (\$)	Depth (\$/LF)	Area (\$)	Depth (\$/LF)	Area (\$)	
0709-281-1716-2 TR-C2	CHASE, BYRON J 846 WOODROW ST MADISON WI	846 Woodrow St	40.00 L.F.	113.00	\$4,620.00	121.00	\$4,840.00	1.0	200.00	\$300.00	1.0	200.00	\$600.00	33,491.24
0709-281-1715-4 TR-C2	DOERFFLE, RACHEL E & PETER BUCHANAN TAN 848 WOODROW ST MADISON WI	848 Woodrow St	40.00 L.F.	127.00	\$1,905.50	152.00	\$6,084.00	1.0	150.00	\$232.00	1.0	150.00	\$450.00	\$3,403.46
0709-281-1714-6 TR-C2	VAHDEW, STEVEN P & KAREN F VADREW 850 WOODROW ST MADISON WI	850 Woodrow St	40.00 L.F.	129.00	\$1,935.50	148.00	\$5,924.00	1.0	125.00	\$187.50	1.0	125.00	\$375.00	\$3,277.96
0709-281-1713-8 TR-C2	ORA, CK, BERNER 852 WOODROW ST MADISON WI	852 Woodrow St	40.00 L.F.	128.00	\$1,920.00	131.00	\$5,294.00	1.0	175.00	\$262.50	1.0	175.00	\$525.00	\$3,191.24
0709-281-1712-0 TR-C2	SAVEED, ABEER 856 WOODROW ST MADISON WI	856 Woodrow St	40.00 L.F.	0.00	\$0.00	168.00	\$6,720.00	1.0	100.00	\$150.00	1.0	100.00	\$300.00	\$3,009.74
0709-281-1711-2 TR-C2	BERRED, JEFFREY C & YVEL GEN 860 WOODROW ST MADISON WI	860 Woodrow St	40.00 L.F.	93.00	\$1,395.00	100.00	\$4,000.00	1.0	100.00	\$150.00	1.0	100.00	\$300.00	\$3,061.68
0709-281-1710-4 TR-C2	OPFANAQAN, PAUL LAURA OPFANAQAN 862 WOODROW ST MADISON WI	862 Woodrow St	40.00 L.F.	105.00	\$1,575.00	116.00	\$4,640.00	1.0	125.00	\$187.50	1.0	125.00	\$375.00	\$3,113.96
0709-281-1709-7 TR-C2	BRODSKY, ETHAN K 866 WOODROW ST MADISON WI	866 Woodrow St	47.40 L.F.	140.00	\$2,100.00	141.00	\$5,640.00	1.0	100.00	\$150.00	1.0	100.00	\$300.00	\$3,281.16
0709-281-1708-9 TR-C2	HITING, ELISABETH 870 WOODROW ST MADISON WI	870 Woodrow St	43.00 L.F.	137.00	\$2,055.00	154.00	\$6,160.00	1.0	100.00	\$150.00	1.0	100.00	\$300.00	\$3,255.46
0709-281-1707-1 TR-C2	EDGEWOOD COLLEGE INC 1000 EDGEWOOD COLLEGE DR MADISON WI	874 Woodrow St	55.00 L.F.	72.00	\$1,080.00	71.50	\$2,865.00	1.0	125.00	\$187.50	1.0	125.00	\$375.00	\$3,114.24
0709-281-1706-3 TR-C2	SCHNEY, JAMES & SHOSHANNAH 878 WOODROW ST MADISON WI	878 Woodrow St	77.00 L.F.	72.00	\$1,080.00	71.50	\$2,865.00	1.0	100.00	\$150.00	1.0	100.00	\$300.00	\$3,418.85
0709-281-1705-5 TR-C2	ASPERNALL, LYNN C 886 WOODROW ST MADISON WI	886 Woodrow St	50.00 L.F.	158.00	\$2,370.00	177.00	\$7,080.00	1.0	250.00	\$375.00	1.0	250.00	\$750.00	\$4,131.74
0709-281-1704-7 TR-C2	TURNER, MATTHEW D & REBECCA J MAY 890 WOODROW ST MADISON WI	890 Woodrow St	70.30 L.F.	0.00	\$0.00	0.00	\$0.00	1.0	200.00	\$300.00	1.0	200.00	\$600.00	\$3,923.74
0709-281-1703-9 TR-C2	TRIDAY INVESTMENTS LLC 938 WOODROW ST MADISON WI	938 Woodrow St	40.50 L.F.	0.00	\$0.00	0.00	\$0.00	1.0	0.00	\$0.00	1.0	0.00	\$0.00	\$0.00
0709-281-1702-9 TR-C2	TRIDAY REV TRUST OF 2007 R.O & P TRIDAY 1050 WOODROW ST MADISON WI	1050 Woodrow St	0.00 L.F.	0.00	\$0.00	0.00	\$0.00	1.0	0.00	\$0.00	1.0	0.00	\$0.00	\$0.00
0709-281-1701-3 TR-C2	SPENSON TRUST, SAMUEL B 1054 WOODROW ST MADISON WI	1054 Woodrow St	0.00 L.F.	0.00	\$0.00	0.00	\$0.00	1.0	0.00	\$0.00	1.0	0.00	\$0.00	\$0.00