

CITY OF MADISON, WISCONSIN

AN ORDINANCE \_\_\_\_\_

PRESENTED January 22, 2008  
REFERRED Plan Commission

Amending Section 28.06(1)(h) and creating Sections 28.107(17) through (29) of the Madison General Ordinances to establish Wellhead Protection Districts Nos. 7, 8, 10, 11, 13, 16, 17, 19, 20, 23, 25, 27 and 28.

RULES SUSPENSION  
PUBLIC HEARING PC 2-11-08  
CC 2-26-08

Drafted by: Katherine Noonan

Date: January 8, 2008

SPONSORS: Mayor Cieslewicz; Aids. Cnare and Webber

DRAFTER’S ANALYSIS: Wellhead Protection Zones are created for thirteen (13) additional City wells. These protection zones restrict certain uses that may introduce contaminants into the City water system.

\*\*\*\*\*

The Common Council of the City of Madison do hereby ordain as follows:

1. Subdivision (h) of Subsection (1) entitled “Establishment of Zoning Districts” of Section 28.06 entitled “Zoning Districts And Zoning District Maps” of the Madison General Ordinances is amended to read as follows:

“(h) Wellhead Protection Districts.

- 1. WP-28 Wellhead Protection District No. 28. See 28.107(6).
- 2. WP-26 Wellhead Protection District No. 26. See 28.107(7).
- 3. WP-15 Wellhead Protection District No. 15. See 28.107(8).
- 4. WP-29 Wellhead Protection District No. 29. See 28.107(9).
- 5. WP-9 Wellhead Protection District No. 9. See 28.107(10).
- 6. WP-14 Wellhead Protection District No. 14. See 28.107(11).
- 7. WP-30 Wellhead Protection District No. 30. See 28.107(12).
- 8. WP-6 Wellhead Protection District No. 6. See 28.107(13).
- 9. WP-~~6~~12 Wellhead Protection District No. 12. See 28.107(14).
- 10. WP-~~6~~18 Wellhead Protection District No. 18. See 28.107(15).
- 11. WP-~~6~~24 Wellhead Protection District No. 24. See 28.107(16).
- 12. WP-7 Wellhead Protection District No. 7. See 28.107(17).
- 13. WP-8 Wellhead Protection District No. 8. See 28.107(18).
- 14. WP-10 Wellhead Protection District No. 10. See 28.107(19).
- 15. WP-11 Wellhead Protection District No. 11. See 28.107(20).
- 16. WP-13 Wellhead Protection District No. 13. See 28.107(21).
- 17. WP-16 Wellhead Protection District No. 16. See 28.107(22).
- 18. WP-17 Wellhead Protection District No. 17. See 28.107(23).
- 19. WP-19 Wellhead Protection District No. 19. See 28.107(24).
- 20. WP-20 Wellhead Protection District No. 20. See 28.107(25).
- 21. WP-23 Wellhead Protection District No. 23. See 28.107(26).
- 22. WP-25 Wellhead Protection District No. 25. See 28.107(27).
- 23. WP-27 Wellhead Protection District No. 27. See 28.107(28).
- 24. WP-28 Wellhead Protection District No. 28. See 28.107(29).”

2. Subsection (17) of Section 28.107 entitled “Wellhead Protection Districts” of the Madison General Ordinances is created to read as follows:

Approved as to form:





4. Subsection (19) of Section 28.107 entitled "Wellhead Protection Districts" of the Madison General Ordinances is created to read as follows:

"(19) Wellhead Protection District No. 10. The location of Well No. 10 and the surrounding Zone A and Zone B are shown in Sec. 28.107(19)(a).

(a) Map of Wellhead Protection District No. 10.



5. Subsection (20) of Section 28.107 entitled "Wellhead Protection Districts" of the Madison General Ordinances is created to read as follows:

"(20) Wellhead Protection District No. 11. The location of Well No. 10 and the surrounding Zone A and Zone B are shown in Sec. 28.107(19)(a).

(a) Map of Wellhead Protection District No. 11.



6. Subsection (20) of Section 28.107 entitled "Wellhead Protection Districts" of the Madison General Ordinances is created to read as follows:

"(20) Wellhead Protection District No. 13. The location of Well No. 13 and the surrounding Zone A and Zone B are shown in Sec. 28.107(20)(a).

(a) Map of Wellhead Protection District No. 13.



7. Subsection (21) of Section 28.107 entitled "Wellhead Protection Districts" of the Madison General Ordinances is created to read as follows:

"(21) Wellhead Protection District No. 16. The location of Well No. 16 and the surrounding Zone A and Zone B are shown in Sec. 28.107(21)(a).

(a) Map of Wellhead Protection District No. 16.

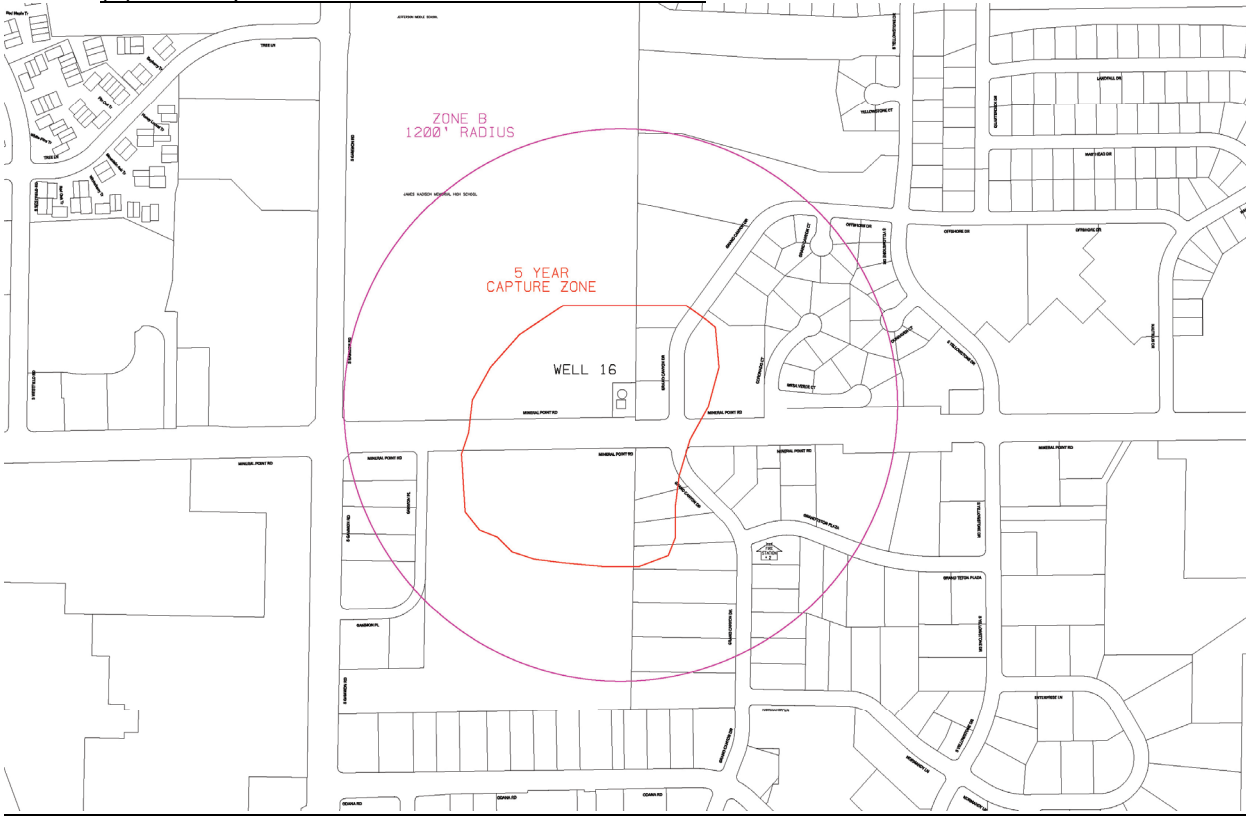

8. Subsection (22) of Section 28.107 entitled "Wellhead Protection Districts" of the Madison General Ordinances is created to read as follows:

"(22) Wellhead Protection District No. 17. The location of Well No. 17 and the surrounding Zone A and Zone B are shown in Sec. 28.107(22)(a).

(a) Map of Wellhead Protection District No. 17.



9. Subsection (23) of Section 28.107 entitled "Wellhead Protection Districts" of the Madison General Ordinances is created to read as follows:

"(23) Wellhead Protection District No. 19. The location of Well No. 19 and the surrounding Zone A and Zone B are shown in Sec. 28.107(23)(a).

(a) Map of Wellhead Protection District No. 19.

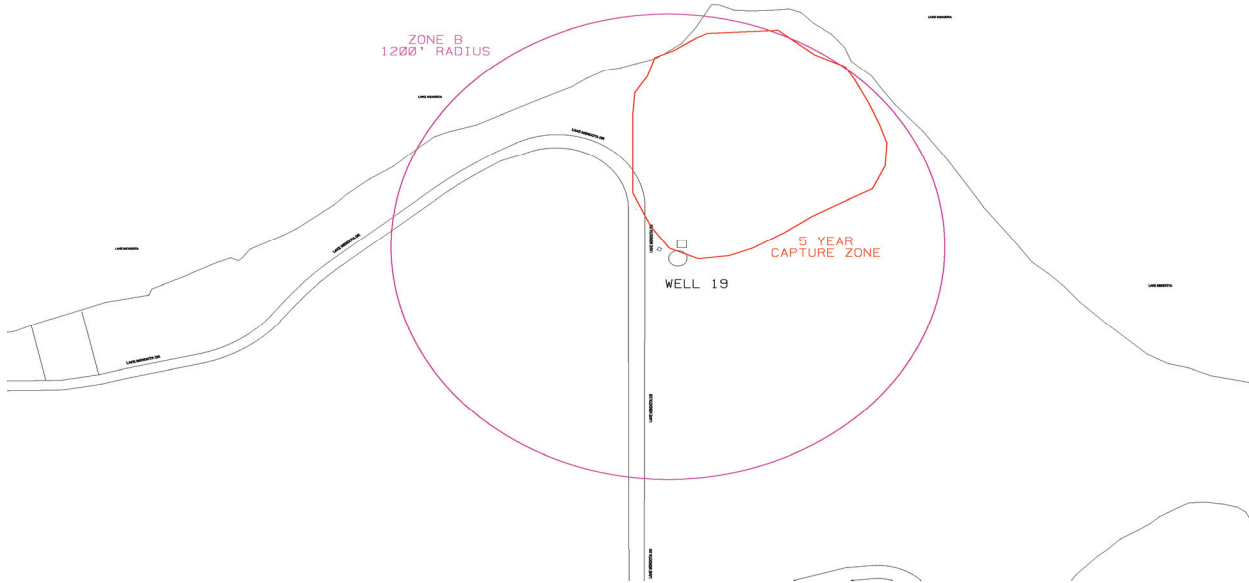

10. Subsection (24) of Section 28.107 entitled "Wellhead Protection Districts" of the Madison General Ordinances is created to read as follows:

"(24) Wellhead Protection District No. 20. The location of Well No. 20 and the surrounding Zone A and Zone B are shown in Sec. 28.107(24)(a).

(a) Map of Wellhead Protection District No. 20.



11. Subsection (25) of Section 28.107 entitled "Wellhead Protection Districts" of the Madison General Ordinances is created to read as follows:

"(25) Wellhead Protection District No. 23. The location of Well No. 23 and the surrounding Zone A and Zone B are shown in Sec. 28.107(25)(a).

(a) Map of Wellhead Protection District No. 23.

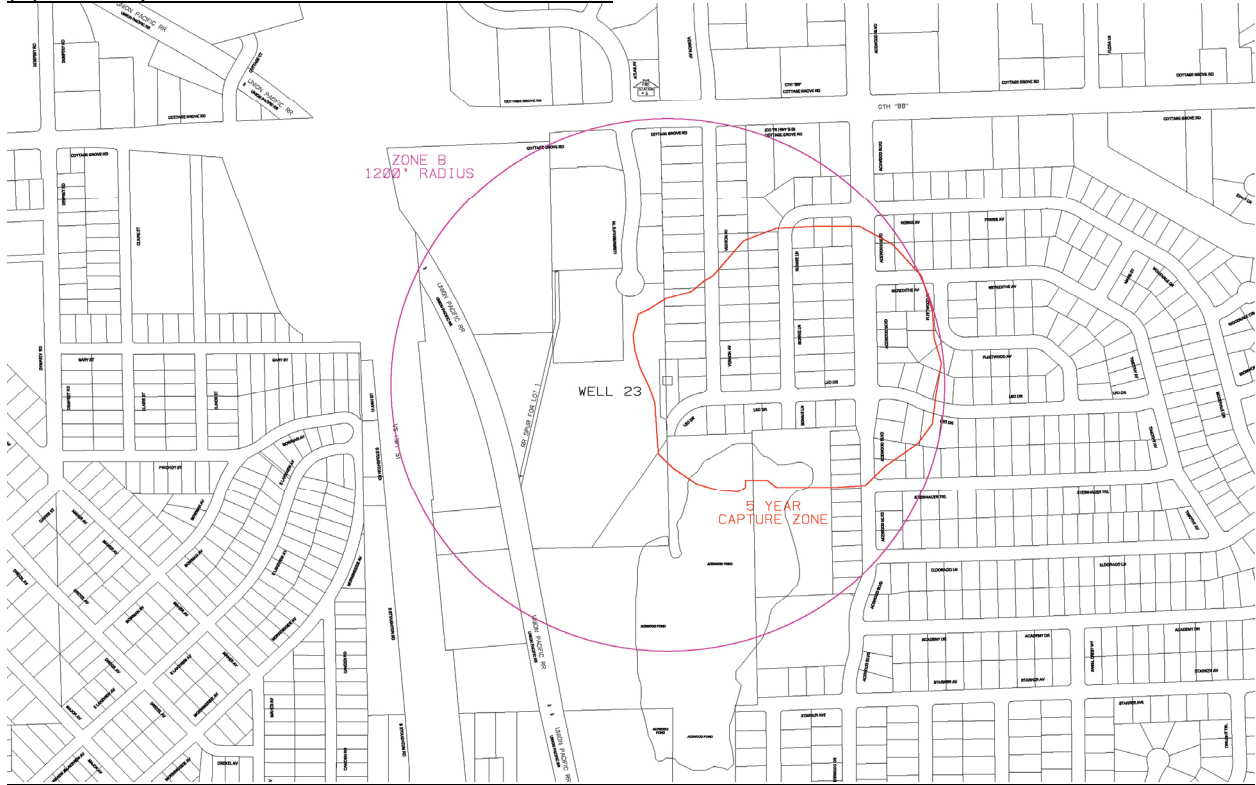

12. Subsection (27) of Section 28.107 entitled "Wellhead Protection Districts" of the Madison General Ordinances is created to read as follows:

"(27) Wellhead Protection District No. 25. The location of Well No. 25 and the surrounding Zone A and Zone B are shown in Sec. 28.107(27)(a).

(a) Map of Wellhead Protection District No. 25.

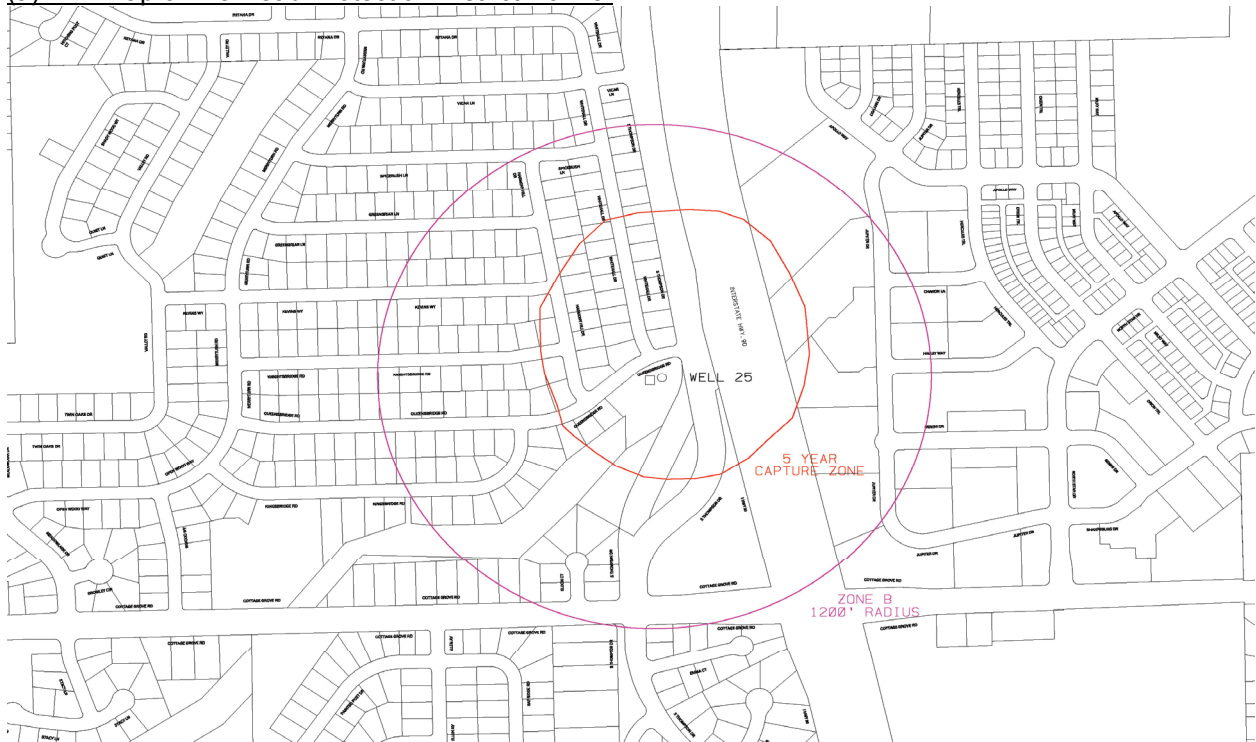

13. Subsection (28) of Section 28.107 entitled "Wellhead Protection Districts" of the Madison General Ordinances is created to read as follows:

"(28) Wellhead Protection District No. 27. The location of Well No. 27 and the surrounding Zone A and Zone B are shown in Sec. 28.107(28)(a).

(a) Map of Wellhead Protection District No. 27.



14. Subsection (29) of Section 28.107 entitled "Wellhead Protection Districts" of the Madison General Ordinances is created to read as follows:

"(29) Wellhead Protection District No. 28. The location of Well No. 28 and the surrounding Zone A and Zone B are shown in Sec. 28.107(29)(a).

(a) Map of Wellhead Protection District No. 28.

