

R1 Single Family Residential Zoning

28 foot street width

Front loaded two car garages with minimum lot width of 65 feet.

Density: 5.44 units per acre = 17 total dwelling units

On-street parking spaces:

Double sided parking: 20 north-south / 15 east-west

Single sided parking: 10 north-south / 7 east-west

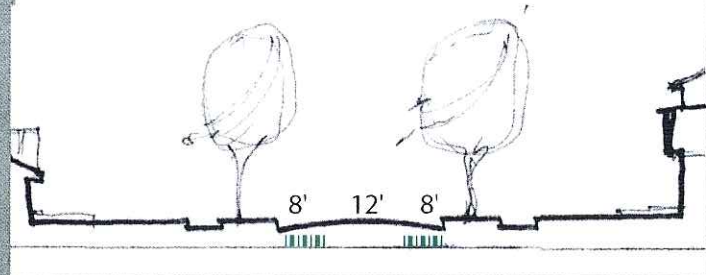

Street Section: Scale 1" = 10'0"

Available Parking: No Parking Allowed:

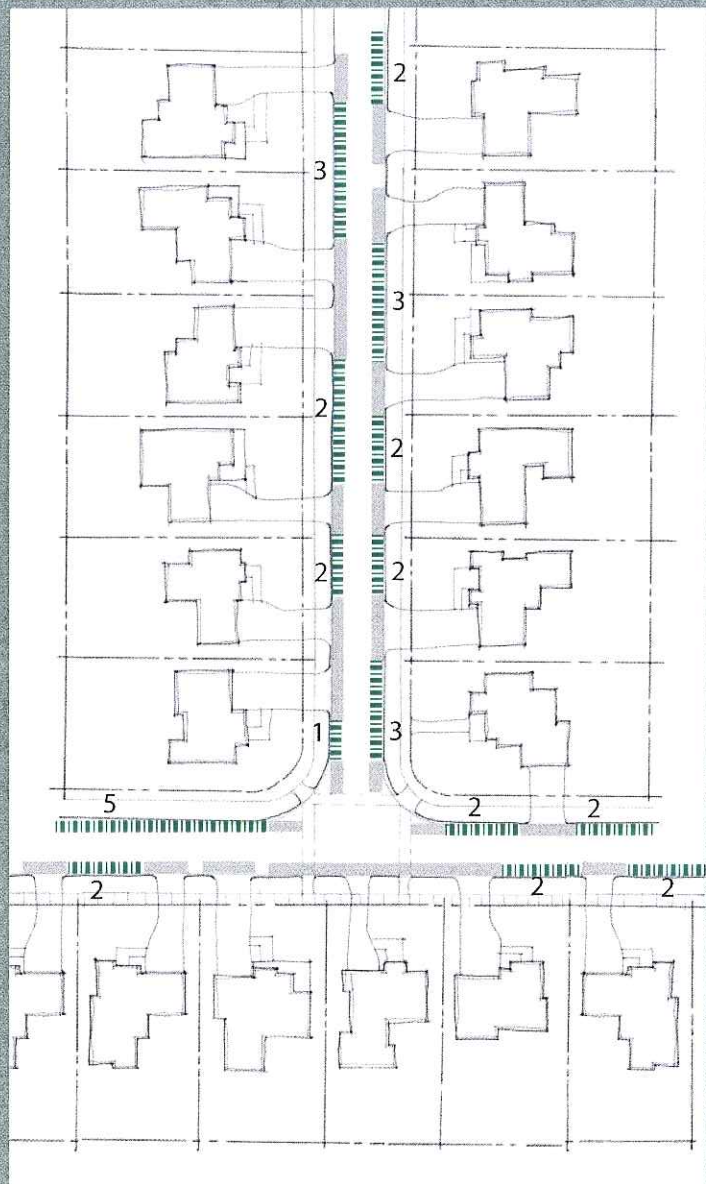

Block Plan: 1" = 30'0"

R2 Single Family Residential Zoning

28 foot street width

Front loaded two car garages with minimum lot width of 50 ft

Density: 7.26 units per acre = 23 total dwelling units

On-street parking spaces:

Double sided parking: 18 north-south / 12 east-west

Single sided parking: 9 north-south / 6 east-west

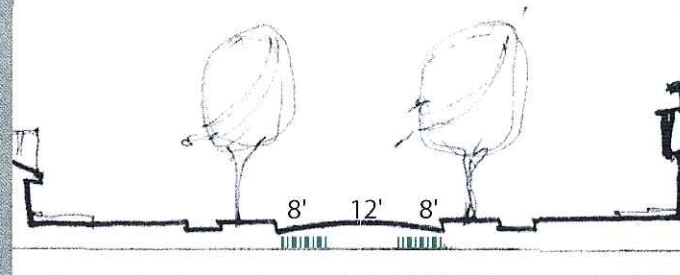

Street Section: Scale 1" = 10'0"

Available Parking: No Parking Allowed:

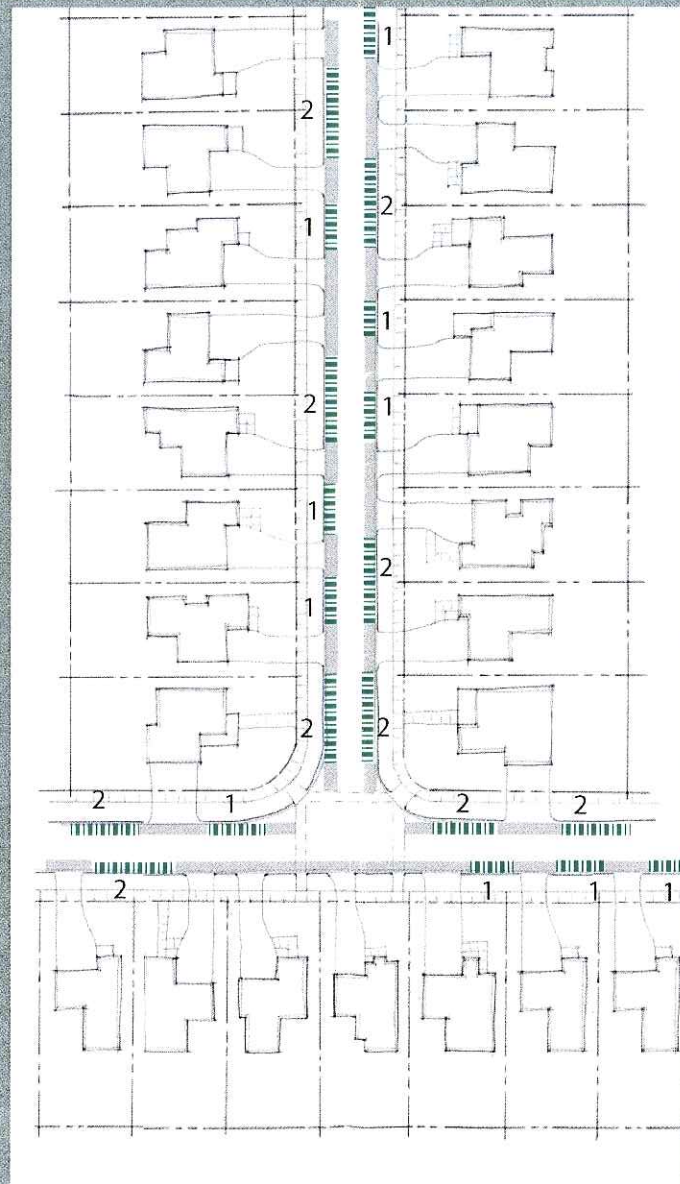

Block Plan: 1" = 30'0"

R2-T Single Family Residential Zoning

28 foot street width

Front loaded two car garages with minimum lot width of 58 ft to accomadate facade requiremenst of R2T zoning.

Density: 8.71 units per acre = 22 total dwelling units

On-street parking spaces:

Double sided parking: 21 north-south / 8 east-west

Single sided parking: 11 north-south / 4 east-west

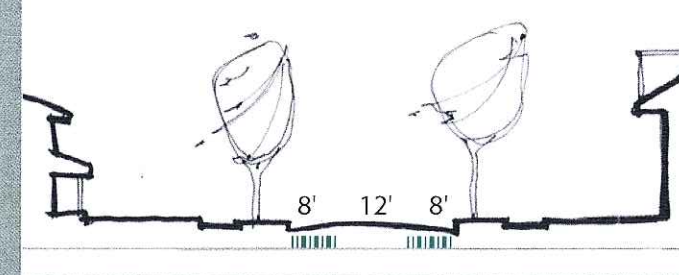

Street Section: Scale 1" = 10'0"

Available Parking: No Parking Allowed:

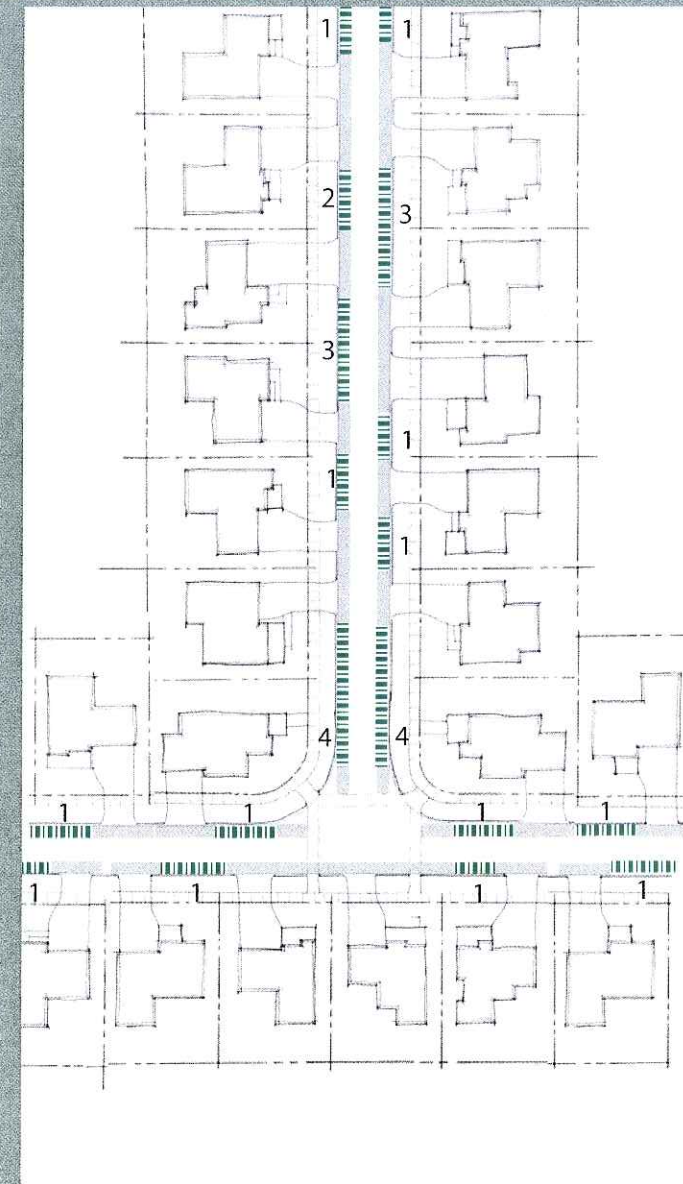

Block Plan: 1" = 30'0"

R2-S Single Family Residential Zoning

28 foot street width

Alley loaded two car garages with minimum lot width of 40 feet.

Density: 10.89 units per acre = 29 total dwelling units

On-street parking spaces:

Double sided parking: 32 north-south / 28 east-west

Single sided parking: 16 north-south / 14 east-west

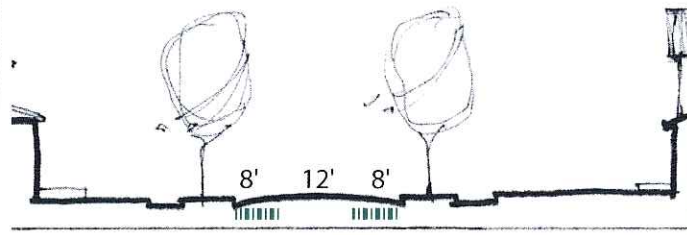

Street Section: Scale 1" = 10'0"

Available Parking: No Parking Allowed:

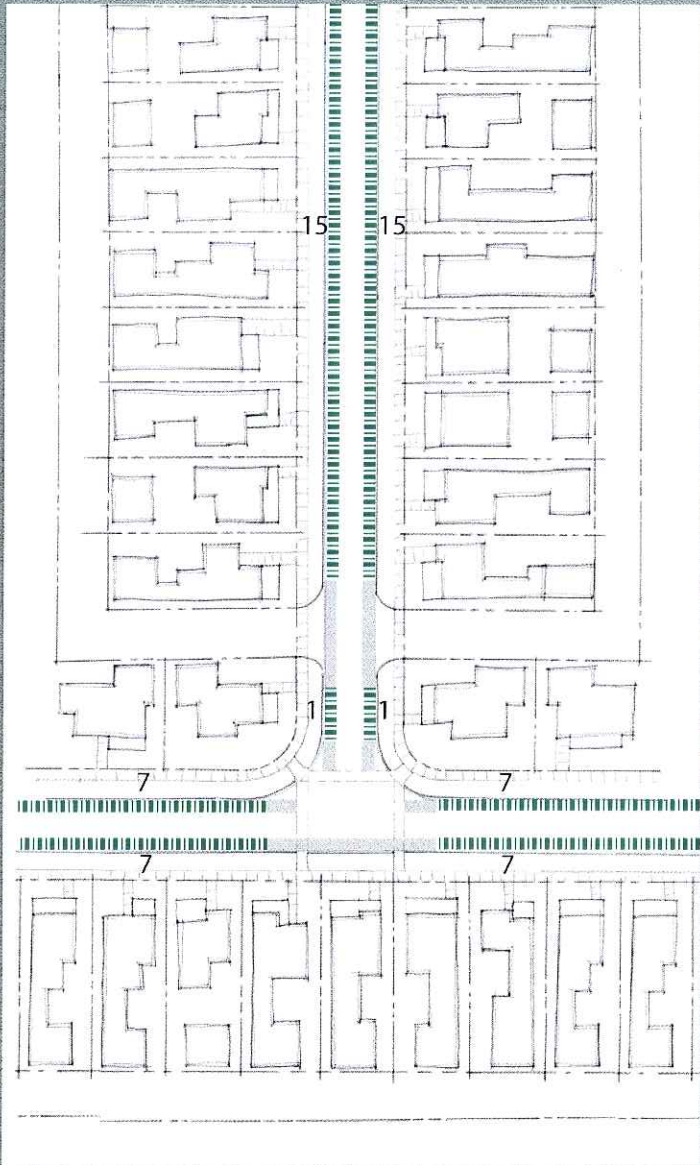

Block Plan: 1" = 30'0"

R2-Y Single Family Residential Zoning

28 foot street width

Alley loaded two car garages with minimum lot width of 40 ft

Density: 10.89 units per acre = 28 total dwelling units

On-street parking spaces:

Double sided parking: 32 north-south / 28 east-west

Single sided parking: 16 north-south / 14 east-west

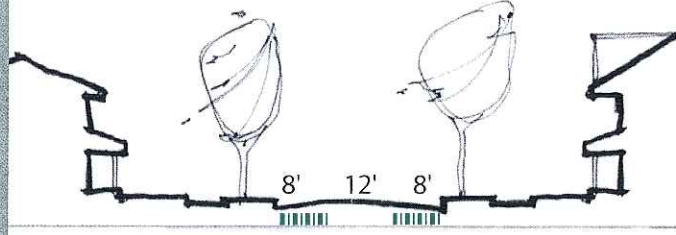

Street Section: Scale 1" = 10'0"

Available Parking: No Parking Allowed:

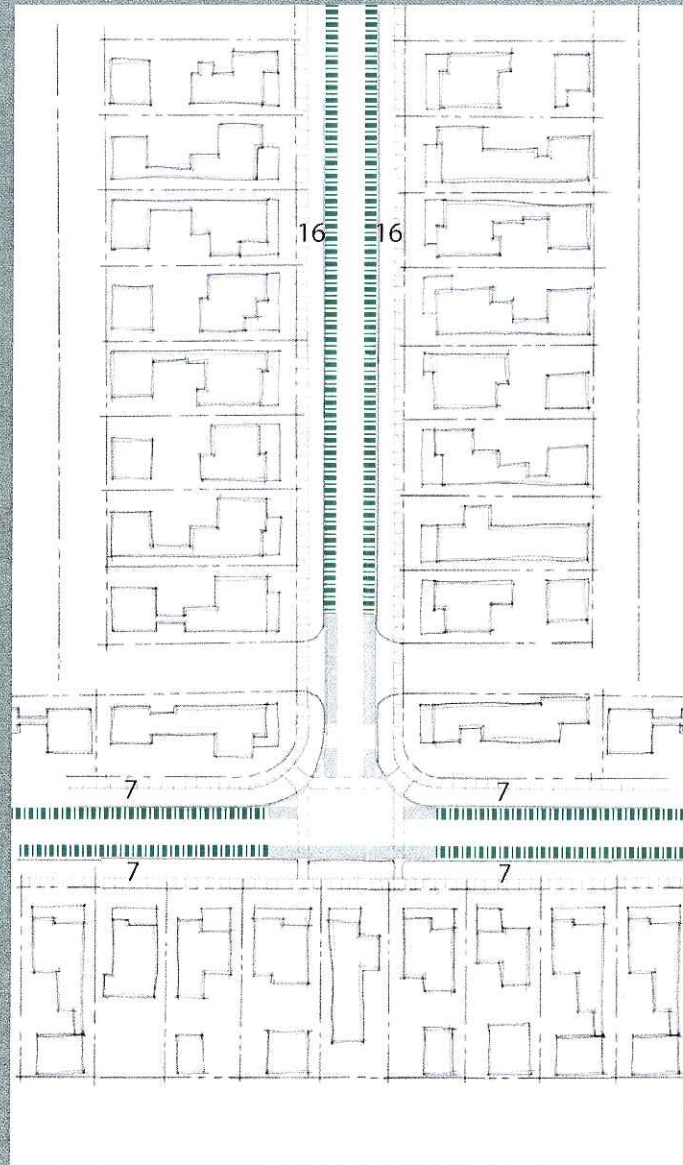

Block Plan: 1" = 30'0"

R2-Z Single Family Residential Zoning

28 foot street width

Alley loaded two car garages with minimum lot width of 37 ft

Density: 12.44 units per acre = 31 total dwelling units

On-street parking spaces:

Double sided parking: 32 north-south / 28 east-west

Single sided parking: 16 north-south / 14 east-west

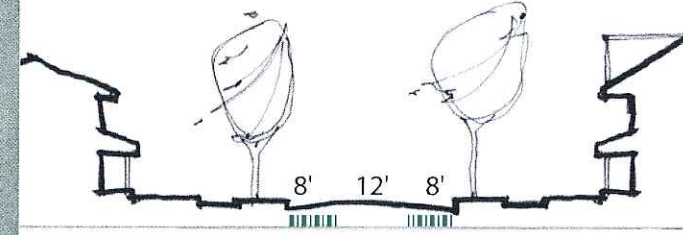

Street Section: Scale 1" = 10'0"

Available Parking: No Parking Allowed:

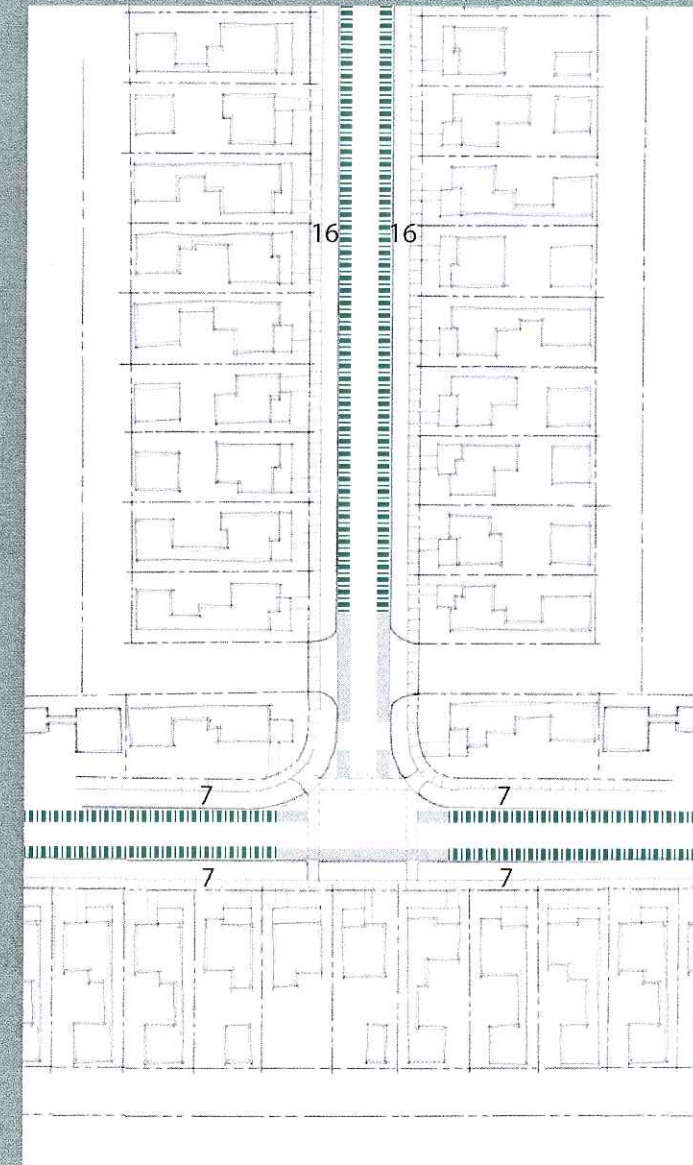

Block Plan: 1" = 30'0"



- R1 - 8000 S.F. Min. Lot
Max Density: 5.44
- R2 - 6000 S.F. Min. Lot
Max Density: 7.44
- R2-T - 5000 S.F. Min. Lot
Max Density: 8.71
- R2S/Y - 4000 S.F. Min. Lot
Max Density: 10.89
- R2-Z - 3500 S.F. Min. Lot
Max Density: 12.44
- Townhouse / Duplex / 4-units
Max Density: 11
- Multi-Family Apartments
Average Density: 15



SCALE: 1" = 200'

Autumn Lake: Density by Lot

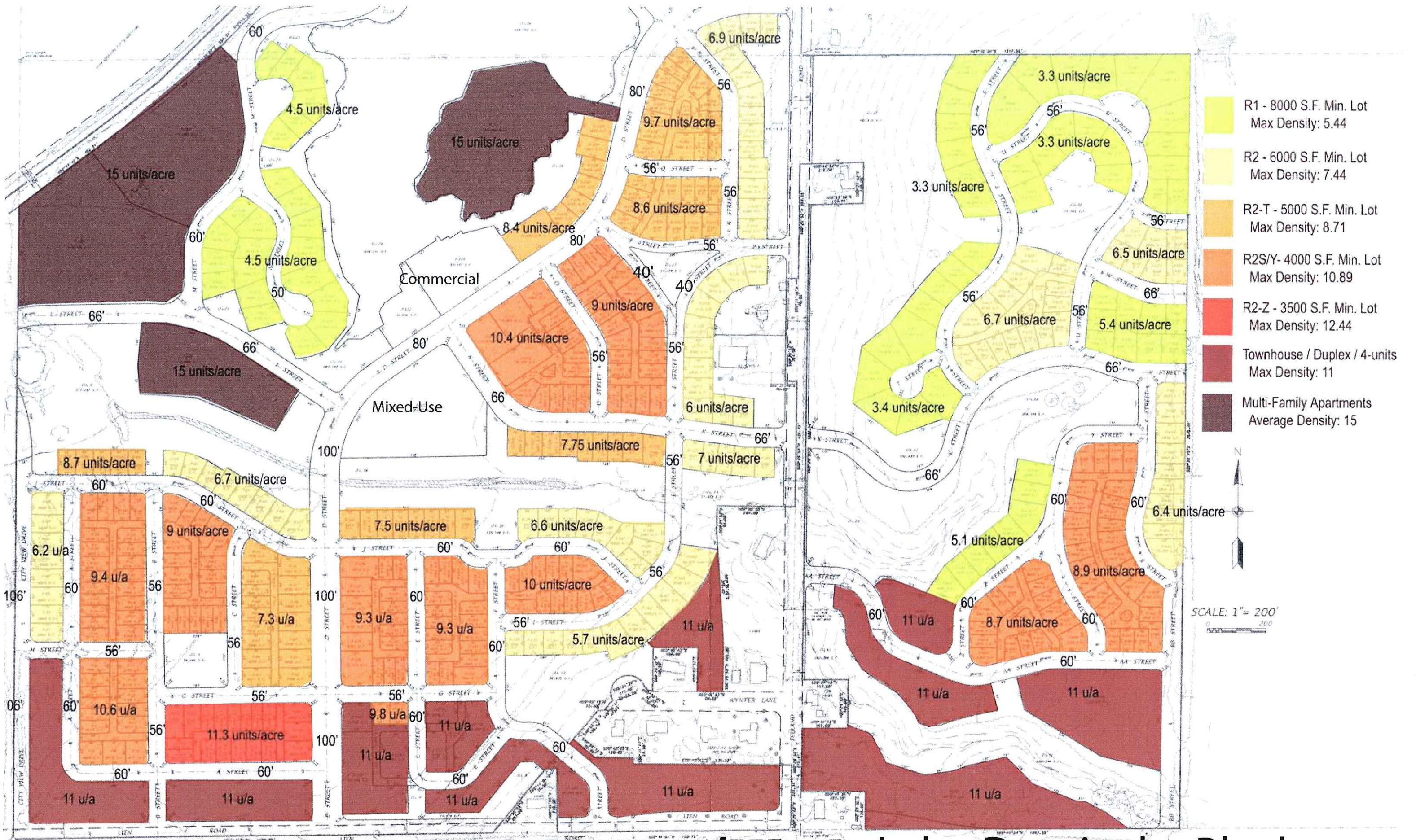

Autumn Lake: Density by Block

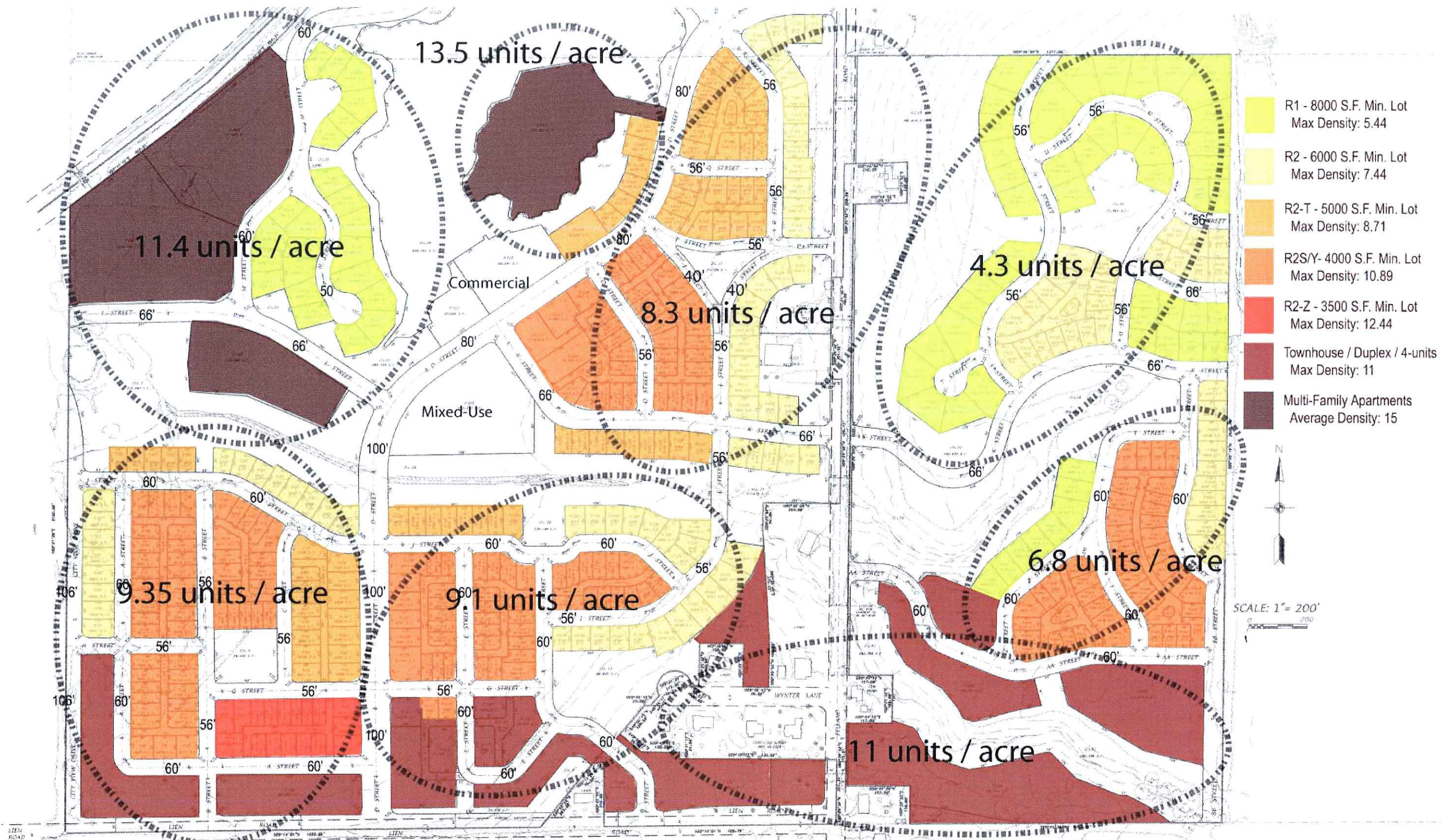

- R1 - 8000 S.F. Min. Lot
Max Density: 5.44
- R2 - 6000 S.F. Min. Lot
Max Density: 7.44
- R2-T - 5000 S.F. Min. Lot
Max Density: 8.71
- R2S/Y- 4000 S.F. Min. Lot
Max Density: 10.89
- R2-Z - 3500 S.F. Min. Lot
Max Density: 12.44
- Townhouse / Duplex / 4-units
Max Density: 11
- Multi-Family Apartments
Average Density: 15

N

SCALE: 1" = 200'

Autumn Lake: Density by Sub-area