

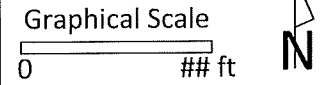

City of Madison
 Department of Public Works
PARKS DIVISION
 City-County Building, Suite 104
 210 Martin Luther King, Jr. Blvd.
 PO Box 2987
 Madison, WI 53701-2987

play
**MADISON
 PARKS**



PROJECT:
**WPCRC
 CARPET
 REPLACEMENT**

**LOCATION MAP
 WARNER PARK
 COMMUNITY
 RECREATION CENTER**

Although every effort has been made in preparing these plans and checking them for accuracy, the contractor and subcontractors must check all details and dimensions of their trade and be responsible for the same.

ITEM	DATE
Drawn by:	XX-XX-XXXX
Approved by:	XX-XX-XXXX

PUBLIC WORKS PROJECT #:
7492

SHEET TITLE:
LOCATION MAP

SHEET NUMBER:

WPCRC Carpet Project - 2015

	Space	S.F. (approximate)
A	Community Rooms 2 & 3	1,580/9=176 SY
B	WPCRC Offices	800/9=89 SY
C	Lounge & Main Hallway	3,500/9=389 SY
D	NESCO Offices	1,400/9=156 SY
E	Gym Hallway	640/9=72 SY
F	Walk Off Entrance	70/9=8 SY
Total		7,990/9=889 SY

Room letters correspond with WPCRC Schematic Floor Plan

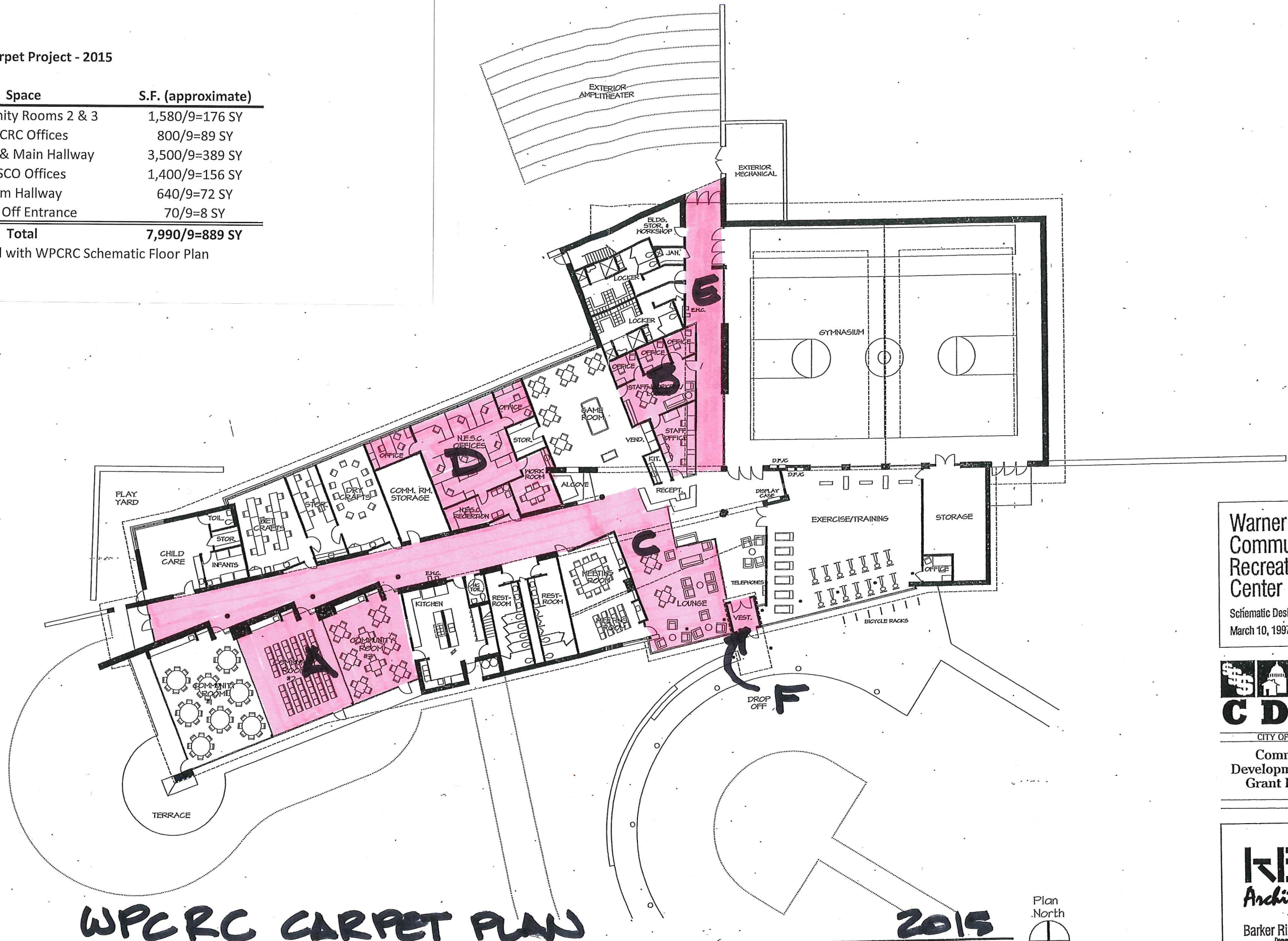

WPCRC CARPET PLAN

FLOOR PLAN

Warner Park Community Recreation Center



Warner Park
Community
Recreation
Center

Schematic Design
March 10, 1997



CITY OF MADISON

Community
Development Block
Grant Program

KEE
Architecture
with
Barker Rinker Seacat
Denver, Colorado