

No.	Date	Description
1	06/20/15	ISSUED FOR PERMIT

Graphic Scale	0' 5' 10' 20' 30'
PDF Number	09K1K-01
Set Type	RD
Date Issued	01/08/2015
Sheet Number	C127

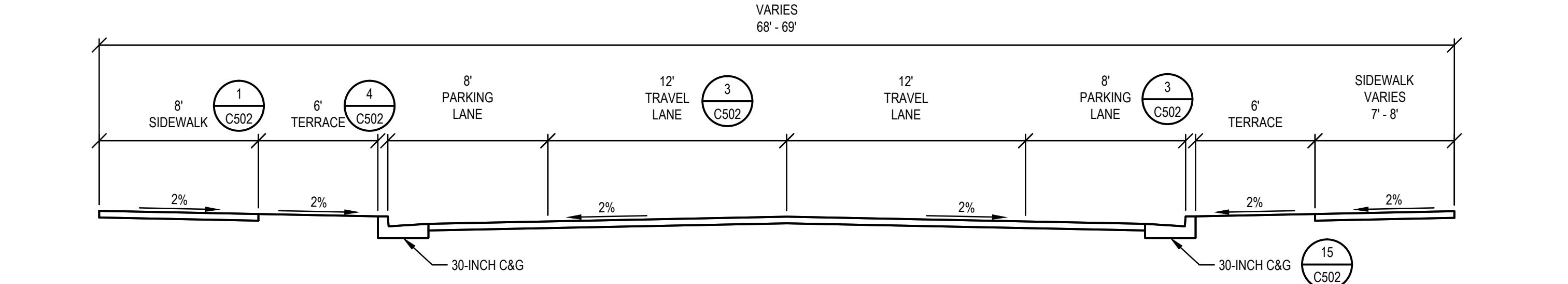

1 LANGDON SECTION - FULL

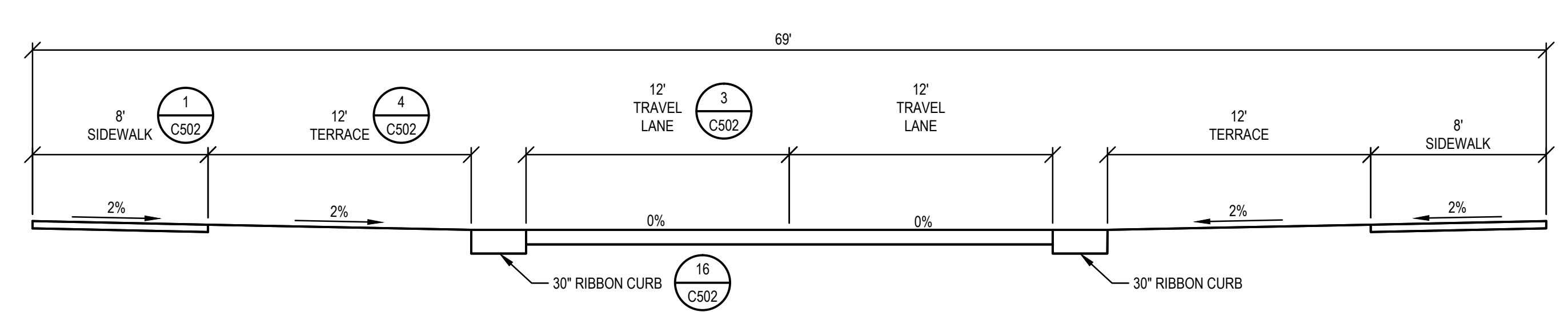

2 LANGDON SECTION - TABLE TOP

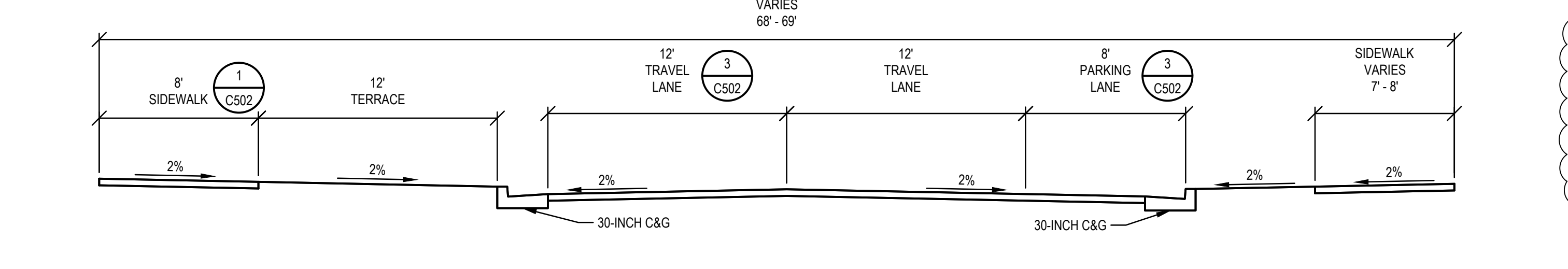

3 LANGDON SECTION - PARTIAL

DEMOLITION LEGEND AND KEYNOTES:

- PROJECT BOUNDARY
- RIGHT OF WAY
- REMOVE CURB AND GUTTER
- UTILITY AND STRUCTURE DEMOLITION
- ASPHALT PAVEMENT REMOVAL
- CONCRETE PAVEMENT REMOVAL
- PAVER REMOVAL
- STRUCTURE TO BE PROTECTED - RIM ADJUSTED TO MEET PROPOSED PROFILE
- TREE GRATES TO BE SALVAGED AND RETURNED TO OWNER
- ALL PARKING SIGNS, METERS AND EXISTING BIKE RACKS TO BE SALVAGED AND RETURNED TO OWNER
- TREE PROTECTION: SEE DETAIL B/C300 AND SPECIFICATION SECTION 31 13 16. SEE NOTE 10
- TREE TO BE REMOVED
- LIGHT POLE TO BE REMOVED. SEE ELECTRICAL DEMO PLANS FOR LIGHTS TO BE SALVAGED FOR REUSE
- LIGHT POLE TO BE REMOVED AND SALVAGED FOR REUSE
- SIGNS TO BE REMOVED AND RETURNED TO OWNER
- SIGNS IN LANGDON RIGHT OF WAY TO BE SALVAGED FOR REUSE
- COORDINATE NEW LOCATION WITH CITY OF MADISON TRAFFIC ENGINEERING

DEMOLITION NOTES:

- CONTRACTOR SHALL CONTACT #11, APPROPRIATE UTILITY COMPANIES AND UW-MADISON TO FIELD VERIFY UTILITIES PRIOR TO ANY CONSTRUCTION
- SEE EXISTING CONDITIONS PLAN C001 FOR LEGEND OF EXISTING FEATURES AND PROJECT CONTROL BENCHMARKS AND CONTROL MONUMENTS. CONTRACTOR SHALL BE RESPONSIBLE FOR RELOCATING OR ESTABLISHING TEMPORARY BENCHMARKS AND CONTROL POINTS AS NEEDED FOR CONSTRUCTION AND LAYOUT
- CONTRACTOR SHALL PROTECT ALL UTILITIES AND SITE FEATURES UNLESS OTHERWISE SHOWN TO BE REMOVED OR ABANDONED
- SUBMIT DOCUMENTATION SHOWING MEANS AND METHODS OF DUST CONTROL AS PERFORMED THROUGHOUT THE JOB. DOCUMENTATION SHOULD INCLUDE SITE REPORTS (WEEKLY) DESCRIBING WORK PERFORMED AND MEANS IMPLEMENTED AND SHALL BE ACCOMPANIED BY SUPPORTING PHOTOS. (REQUIRED FOR LEED DOCUMENTATION)
- CONTRACTOR IS RESPONSIBLE FOR REMOVAL OF ALL CONSTRUCTION AND EROSION CONTROL FENCING AT PROJECT COMPLETION
- CONTRACTOR SHALL CLEAN ROAD SURFACES THROUGHOUT THE DAY TO PREVENT TRACKING OF MATERIALS OFF SITE
- WHERE PORTIONS OF PAVEMENT TO BE REMOVED ARE PART OF CONTINUOUS PAVEMENT (I.E. SIDEWALKS, STREET, ETC.), CONTRACTOR SHALL SAWCUT COMPLETELY THROUGH PAVEMENTS. SAWCUTS SHALL BE TO NEAREST CONTROL JOINT AND SHALL BE FULL DEPTH CUTS
- ALL PARKING SIGNS, METERS AND OTHER TRAFFIC AND PARKING CONTROL FEATURES ON-SITE SHALL BE SALVAGED AND RETURNED TO THE RESPECTIVE OWNER. (CITY OF MADISON OR UW TRANSPORTATION SERVICES)

STREET RESTORATION AND ELECTRICAL NOTES:

- ALL WORK IN THE LANGDON STREET RIGHT-OF-WAY SHALL BE CONSTRUCTED IN ACCORDANCE WITH THE CITY OF MADISON STANDARD SPECIFICATIONS FOR PUBLIC WORKS CONSTRUCTION
- CONTRACTOR TO NOTIFY PARKING UTILITY (DAN VALENZA AT 266-4744) AT LEAST 2 BUSINESS DAYS PRIOR CONTRACTOR POURING TERRACE CONCRETE BASE
- PARKING UTILITY WILL PROVIDE MULTI-SPACE METER BASE TO CONTRACTOR FOR CONTRACTOR INSTALLATION (POURED-IN-PLACE). CONTRACTOR TO CONTACT DAN VALENZA TO COORDINATE PICK-UP OF BASE
- PARKING UTILITY TO LOCATE MULTI-METER ON SITE. CONTRACTOR MAY NEED TO FORM CONCRETE LEVELING PAD AROUND MULTI-METER BASE. LEVEL WITH ADJACENT SIDEWALK
- PARKING UTILITY TO MARK METER POST LOCATIONS AND PERFORM ONE CALL ON DAY FOLLOWING POUR
- PARKING UTILITY TO INSTALL METER MOUNTING SLEEVES (CORE) PRIOR TO CONTRACTOR APPLYING ASPHALTIC TACK SETTING AND PAVERS, BUT AFTER CONCRETE BASE HAS BEEN INSTALLED
- CONTRACTOR RESPONSIBLE FOR MAINTAINING SLEEVES PLUMB DURING PAVER INSTALLATION. SLEEVES WILL BE INSTALLED SO TOP OF SLEEVE IS FLUSH WITH FINISH GRADE
- CONTRACTOR TO PROVIDE TEMPORARY PAVEMENT MARKING FOR LANGDON STREET FROM N. PARK STREET TO N. LAKE STREET FOR DURATION OF PROJECT
- APPROXIMATE PAVEMENT MARKING ESTIMATES:
 - PAVEMENT MARKING EPOXY, LINE 6-INCH - 200 L.F.
 - PAVEMENT MARKING EPOXY, CROSSWALK, 12-INCH - 48 L.F.
 - PAVEMENT MARKING EPOXY, SYMBOL, BIKE SHARROW - 10 EACH
- ASPHALT BINDER TO LIMITS OF REMOVAL. DEPTH IS FULL 5 1/2" INCHES TO FINISH GRADE
- NEW CITY ELECTRICAL HAND HOLES SHALL BE CITY TRAFFIC ENGINEERING (TE) STANDARD TYPE-1.
- CONTRACTOR TO PROVIDE NEW LIGHT POLE BASES AS IDENTIFIED ON PLAN. USE CITY TE STANDARD BASES LB-1, LB-3, LB-8. TE WILL REINSTALL POLES, FIXTURES AND NEW WIRE
- TE TO REMOVE, STORE AND REPLACE EXISTING LIGHT POLES
- CONTRACTOR SHALL PICK UP AND RETURN TEMPORARY WOOD POLE. TE TO INSTALL FIXTURE AND WIRING. LOCATION IS SAYS STREET, MADISON, WI
- CONTRACTOR TO PROVIDE \$10,000 DEPOSIT SIGNED "RESPONSIBLE PARTY FORM" TO TE PRIOR TO PERMITS ISSUED AND TE REMOVAL BEGINS. OTHER CITY SERVICE PERMITS MAY BE REQUIRED
- LANGDON STREET TREES, 2" CALIPER 8&B. PROVIDE:
 - NHE - New Horizon Elm (Ultra New Horizon)
 - SHL - Silver Honeylocust (Gleditsia tricanthos f. nermis 'Skycol')
 - AGG - Autumn Gold Ginkgo (Ginkgo biloba 'Autumn Gold')
 CONTRACTOR TO REUSE 7 EXISTING TREE GRATES BUT MAY NEED NEW FRAMES. CONTRACTOR TO PROVIDE 4 NEW TREE GRATES AND ONE REPLACEMENT GRATE FOR BROKEN GRATE
- CONTRACTOR SHALL CONTACT CITY FORESTRY AT LEAST ONE WEEK PRIOR TO FORMING CONCRETE AND CONSTRUCTING TREE GRATES TO DETERMINE TREE LOCATIONS
- CONTRACTOR SHALL CONTACT CITY FORESTRY AT LEAST ONE WEEK PRIOR TO PLANTING TO SCHEDULE INSPECTING THE NURSERY STOCK AND REVIEW PLANTING SPECIFICATIONS WITH LANDSCAPE CONTRACTOR

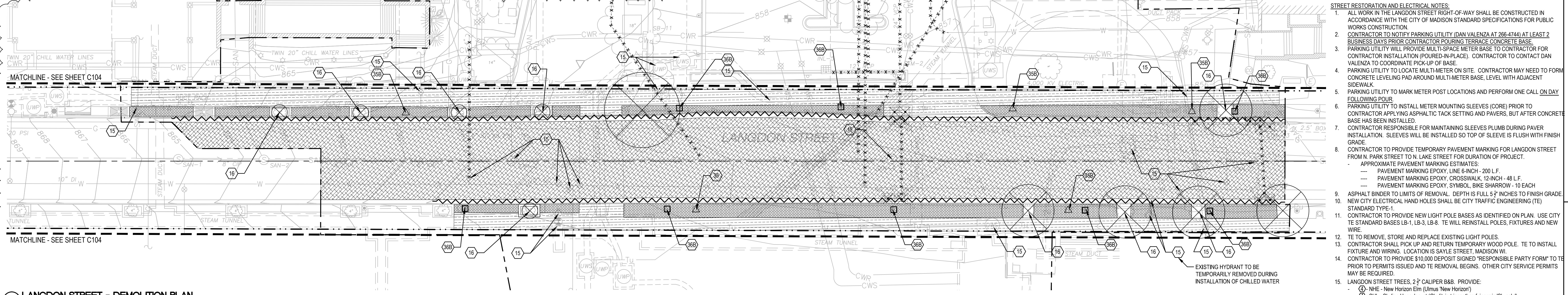

4 LANGDON STREET - DEMOLITION PLAN

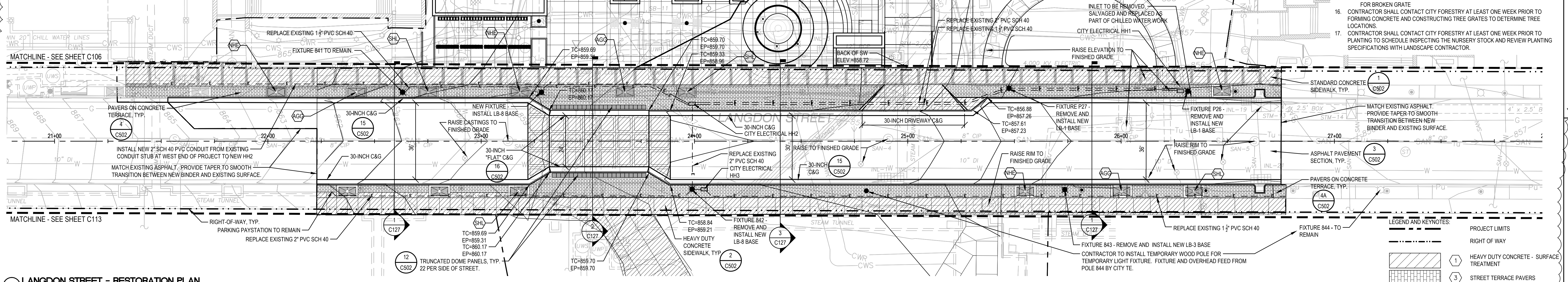

5 LANGDON STREET - RESTORATION PLAN

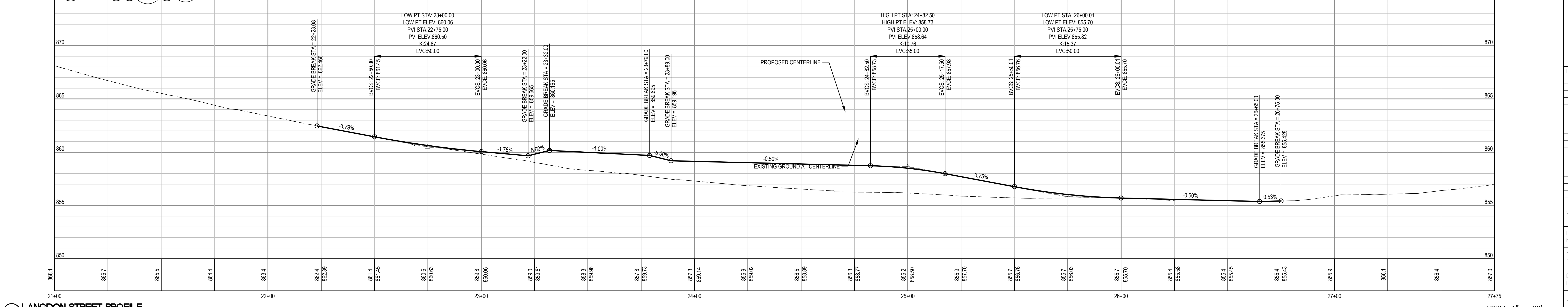

6 LANGDON STREET PROFILE

FILE: P:\50662.000\CAD\VC\Sheet\09K1K-01-PR-1-LANG.dwg USER: mnovak DATE: Feb. 18. 2015 TIME: 03:07 pm