

- EROSION CONTROL NOTES:**
1. ALL DISTURBED AREAS SHALL BE RESTORED WITH TOPSOIL, SEED, AND ECRM.
 2. RIPRAP TO BE INSTALLED AT THE LOCATIONS SHOWN ON THE PLAN.
 3. TURF REINFORCEMENT MAT (CLASS III TYPE C) TO BE INSTALLED IN THE LOCATIONS SHOWN. TRM SHALL BE FILLED WITH TOPSOIL AND COVERED WITH CLASS I TYPE B ECRM.
 4. TEMPORARY POLYMER STABILIZATION SHALL BE INCLUDED AS DIRECTED BY THE CONSTRUCTION ENGINEER.
 5. THE PROJECT SITE SHALL BE INSPECTED FOR EROSION CONTROL WEEKLY AND WITHIN 24 HOURS OF A RAINFALL GREATER THAN 0.5 INCHES.

4113 MONONA DR.
STELLHORN & MILLER



CP COORDINATES (CUT X)
837063.18, 484335.16, 853.97

CHTSELED X
837063.05, 484334.75

BERM REPAIR SECTION A-A'

NOT TO SCALE

LEGEND

-  RIPRAP
-  TURF REINFORCEMENT MAT (ECRM CLASS III TYPE C) COVERED WITH CLASS I TYPE B ECRM AND SEEDED WITH DETENTION BASIN MIX
-  APPROX ZONE FOR REMOVAL OF ARTICULATED CONCRETE

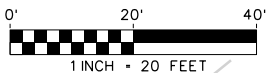

Edge of Water
Water Elev. = 845.63
Oct. 14, 2010

LAKE MONONA

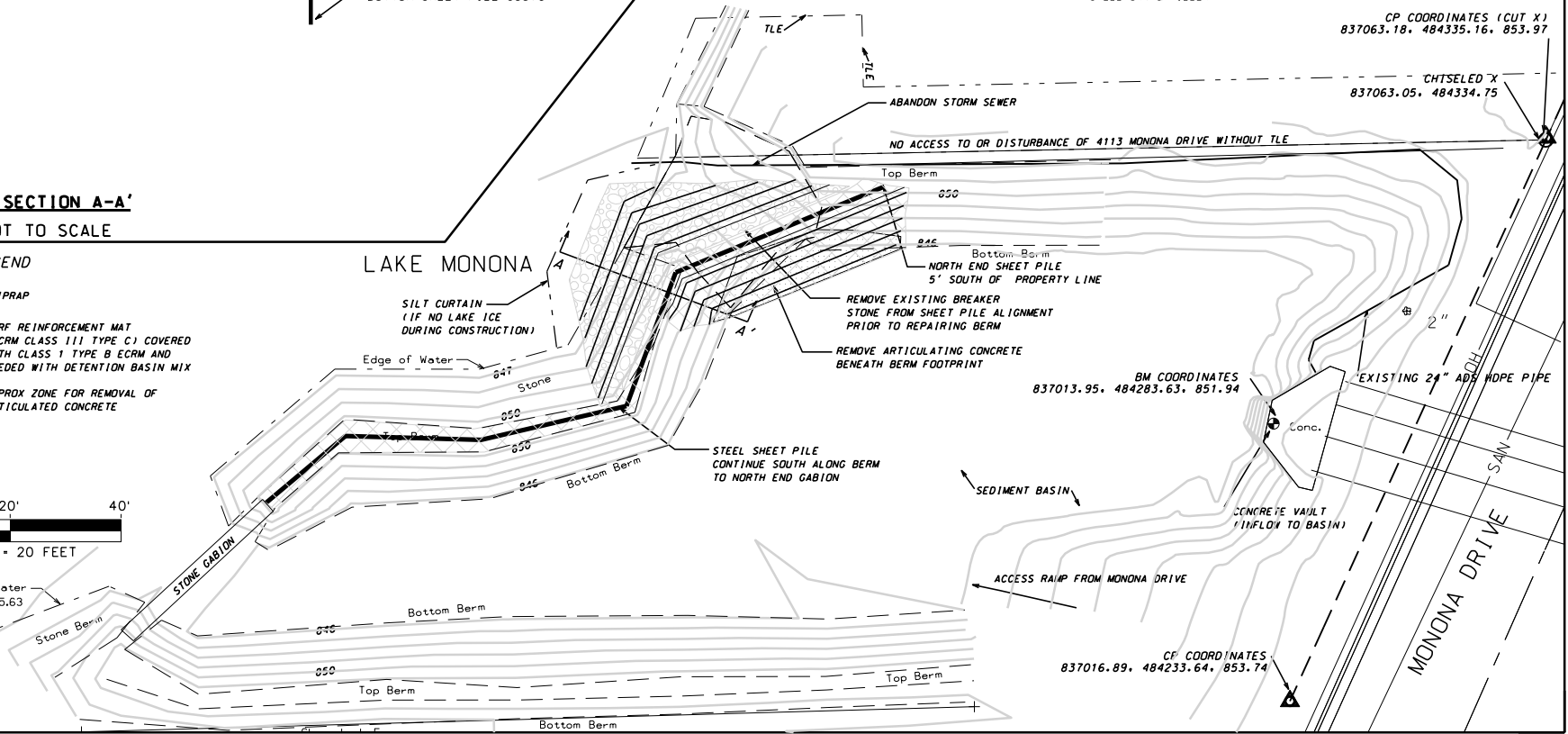

BM COORDINATES
837013.95, 484283.63, 851.94

CP COORDINATES
837016.89, 484233.64, 853.74

PLOT SCALE: _____

PLOT NAME: _____

REV. DATE: _____

ORIGINATOR: CITY OF MADISON, STREETS DIVISION

