

JD# 04113

PETITION FOR DIRECT ANNEXATION
UNDER *Wis. Stat.* § 66.0217(2)

RECEIVED-CITY OF MADISON
CLERKS OFFICE

06 JUN 30 PM 2:49

STATE OF WISCONSIN)
)
COUNTY OF DANE) SS.

To: CITY CLERK
 CITY OF MADISON, WISCONSIN
 210 MARTIN LUTHER KING BLVD., ROOM 103
 MADISON, WI 53703

The undersigned, being all of the owners of the real property in the following territory of the Town of Burke, Wisconsin, hereby petition the City of Madison, Wisconsin to annex within its corporate limits the territory described in the attached Exhibit "A" (the legal description of the territory proposed for annexation) containing approximately 16.23 acres of land more or less.

A copy of the Annexation Scale Map is attached hereto as Exhibit "B", showing the boundaries of the territory proposed for annexation, lying contiguous to the City of Madison, and the relationship of said territory to the City of Madison.

Petitioners further request under *Wis. Stat.* § 66.0217(8)(a) that the described property be temporarily zoned in accordance with the City of Madison zoning code to the Agriculture District (A-1).

The population of and the number of electors residing within the described property is zero (0).

This is a petition for direct annexation by all of the owners of the real property in area within the territory.

Dated this 28 day of June, 2006

OWNERS:

ADDRESS

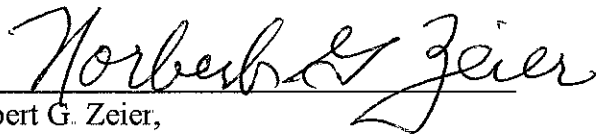

Norbert G. Zeier,
as to an undivided 30%
tenant in common interest

3486 Cynthia Lane
Madison, WI 53704

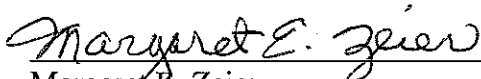

Margaret E. Zeier,
as to an undivided 20%
tenant in common interest

3486 Cynthia Lane
Madison, WI 53704

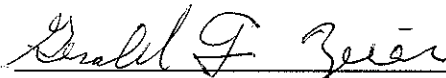

Gerald F. Zeier
as to an undivided 30%
tenant in common interest

305 N. Frances Street
Madison, WI 53703

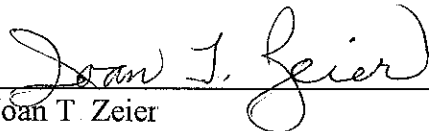

Joan T. Zeier
as to an undivided 20%
tenant in common interest

305 N. Frances Street
Madison, WI 53703

cc: Amy Volkmann
Clerk, Town of Burke
5365 Reiner Road
Madison, WI 53718

Dr. Art Rainwater
c/o Madison Metropolitan School District
545 West Dayton Street
Madison, WI 53703-1995

Municipal Boundaries
Department of Administration
Attn: George Hall
P.O. Box 952
Madison, WI 53701

Exhibit A

Legal Description

Part of West Half of the Northeast Quarter of the Northwest Quarter of Section 15, Township 08 North, Range 10 East, Town of Burke, Dane County, Wisconsin, more fully described as follows:

Commencing at the north quarter corner of said Section 15; thence south along the north-south quarter line of said Section 15, 33.0 feet, more or less, to the southerly right-of-way line of Hoepker Road; thence South 88 degrees 19 minutes 38 seconds West along said southerly right-of-way line, 658 feet, more or less, to the east line of the West Half of said Northeast Quarter of the Northwest Quarter; thence South 00 degrees 55 minutes 27 seconds West along said east line of the West Half, 759.2 feet, more or less, to the point of beginning, also being the southeast corner of Document Number 1281579, Dane County Registry; thence westerly parallel with the east-west quarter line of said Section 15, 165 feet, more or less to the southwest corner of said Document Number 1281579; thence North 00 degrees 55 minutes 27 seconds East parallel with the east line of the aforementioned West Half, 759 feet, more or less, to the southerly right-of-way line of Hoepker Road; thence South 88 degrees 19 minutes 38 seconds West along said southerly right-of-way line, 393.3 feet to the easterly line of Document Number 1097480, Dane County Registry; thence southerly parallel with said west line of the West Half, 187 feet, more or less, to the southeast corner of said Document Number 1097480; thence westerly parallel with the east-west quarter line of said Section 15, 100 feet, more or less, to said west line of the West Half; thence southerly along said west line of the West Half, 1106 feet, more or less, to the south line of the Northeast Quarter of the Northwest Quarter; thence easterly along said south line, 658.7 feet, more or less, to the east line of said West Half; thence North 00 degrees 55 minutes 27 seconds East along said east line of the West Half, 534.7 feet, more or less, to the point of beginning. This description contains approximately 16.23 acres.

Exhibit B

Scale Map

ANNEXATION TO THE CITY OF MADISON

ORDINANCE No. _____
 I.D. No. _____
 DATE ADOPTED _____
 DATE PUBLISHED _____

ALD. DISTRICT ANNEXED TO _____
 AREA 16.23 ACRES

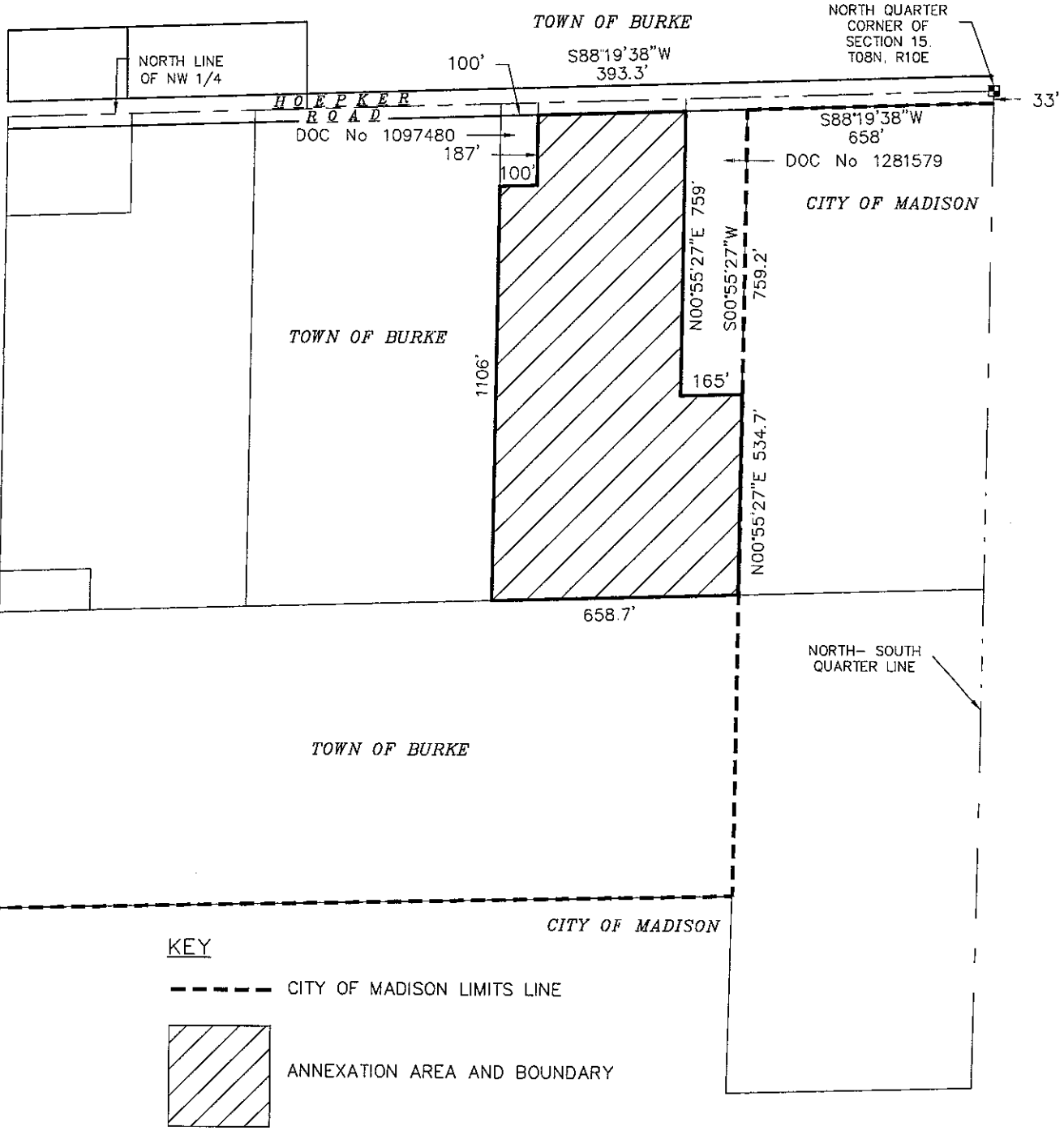
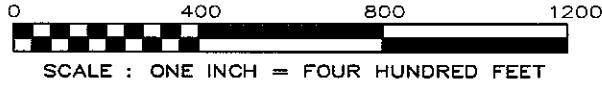

June 30, 2006

ATTORNEYS AT LAW
VEREX PLAZA
150 EAST GILMAN STREET
MADISON WI 53703-1481
POST OFFICE BOX 1497
MADISON, WI 53701-1497
608 257 5035 TEL
608 258 4258 FAX
www.foley.com

WRITER'S DIRECT LINE
608 258 4317
krist@foley.com EMAIL

CLIENT/MATTER NUMBER
037249-0103

VIA HAND DELIVERY

City of Madison, Wisconsin
City Clerk
210 Martin Luther King Blvd., Room 103
Madison, Wisconsin 53703

Re: Petition for Annexation

Dear City Clerk:

Enclosed please find a petition for direct annexation to the City of Madison by Norbert G. Zeier, Margaret E. Zeier, Gerald F. Zeier and Joan T. Zeier for your consideration.

Please feel free to contact me if you have any questions.

Very truly yours,



Katherine R. Rist

Enclosures

cc: Amy Volkmann
George Hall
Dr. Art Rainwater