

1222 S Park Street

Contract No. 9010

MUNIS No. 13415

Developer: Threshold Development Group



### Summary of Improvements:

- Sanitary & Water service laterals – connect to public mains in Park Street
- Storm sewer service lateral – connect to public storm sewer in High Street
- Park Street adjacent to project - construct 5' wide sidewalk, 8' wide terrace, and 1' wide maintenance buffer
- High Street adjacent to project – construct concrete curb & gutter and 5' sidewalk
- Undergrounding of overhead electric on Park Street to be coordinated with MG&E by the developer
- Signing, marking, lighting, and electrical improvements as required by the City Traffic Engineer

**Note:** The improvements on the High Street side of this project are to be coordinated with and constructed by the City's South Street, W. Wingra Drive & High Street(recon) Resurfacing w/Utilities project (project no. 12956). Costs of these improvements will be assessed to the Developer as part of the City's project.

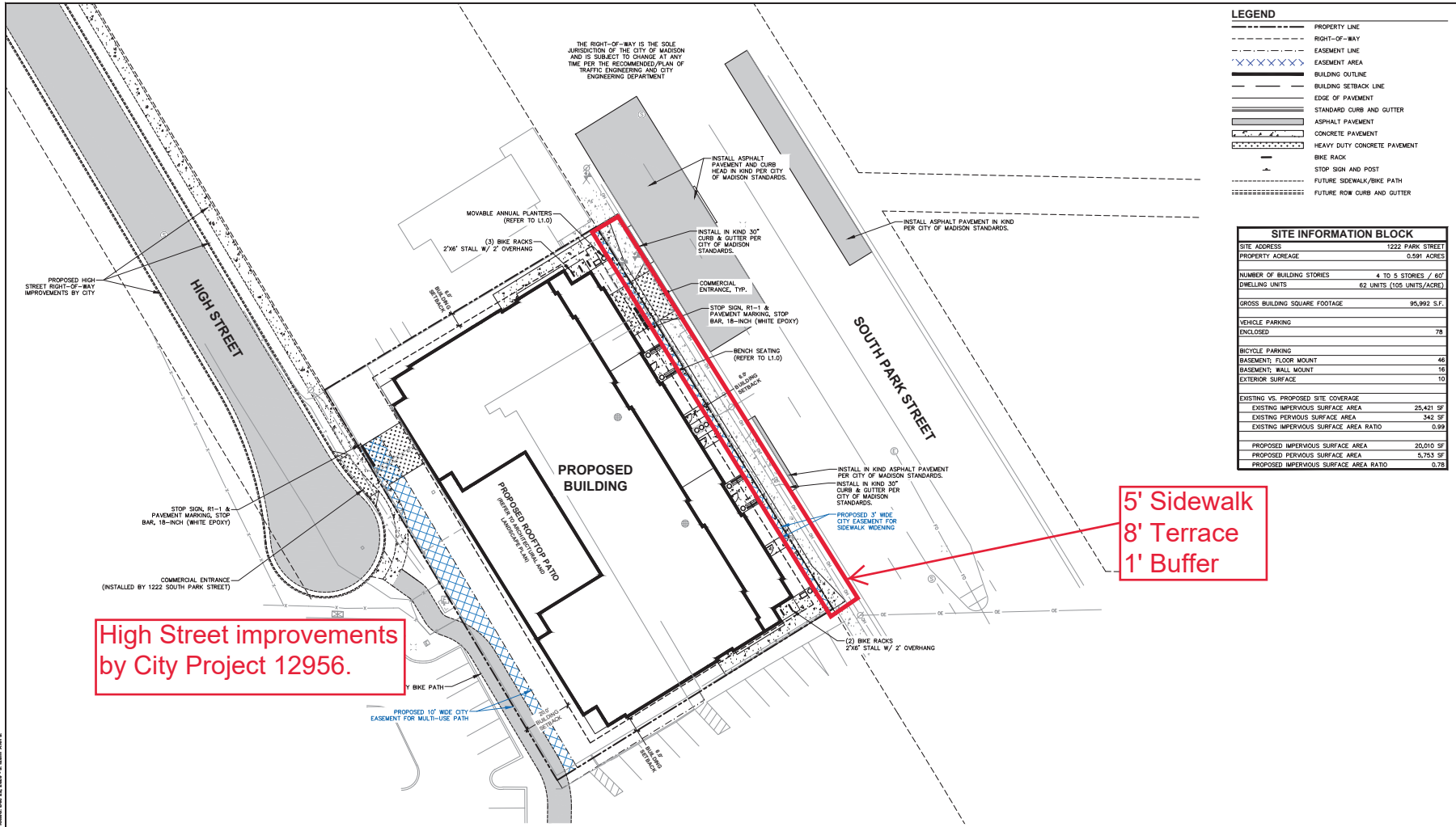

**LEGEND**

- PROPERTY LINE
- - - RIGHT-OF-WAY
- - - EASEMENT LINE
- XXXXXX EASEMENT AREA
- BUILDING OUTLINE
- BUILDING SETBACK LINE
- EDGE OF PAVEMENT
- STANDARD CURB AND GUTTER
- ASPHALT PAVEMENT
- CONCRETE PAVEMENT
- HEAVY DUTY CONCRETE PAVEMENT
- BIKE RACK
- STOP SIGN AND POST
- FUTURE SIDEWALK/BIKE PATH
- FUTURE ROW CURB AND GUTTER

**SITE INFORMATION BLOCK**

SITE ADDRESS	1222 PARK STREET
PROPERTY ACREAGE	0.591 ACRES
NUMBER OF BUILDING STORIES	4 TO 5 STORIES / 60'
DWELLING UNITS	62 UNITS (105 UNITS/ACRE)
GROSS BUILDING SQUARE FOOTAGE	95,992 S.F.
VEHICLE PARKING ENCLOSED	78
VEHICLE PARKING	
BICYCLE PARKING	
BASEMENT: FLOOR MOUNT	46
BASEMENT: WALL MOUNT	16
EXTERIOR SURFACE	10
EXISTING VS. PROPOSED SITE COVERAGE	
EXISTING IMPERVIOUS SURFACE AREA	25,421 SF
EXISTING PERVIOUS SURFACE AREA	342 SF
EXISTING IMPERVIOUS SURFACE AREA RATIO	0.99
PROPOSED IMPERVIOUS SURFACE AREA	20,010 SF
PROPOSED PERVIOUS SURFACE AREA	5,753 SF
PROPOSED IMPERVIOUS SURFACE AREA RATIO	0.78

**CREATE THE VISION TELL THE STORY**

MADISON | MILWAUKEE | WAUSAU  
APPLETON | KENOSHA | CHICAGO  
CRUSH + PALE

**MADISON REGIONAL OFFICE**  
161 HOSKOLD DRIVE, SUITE 301  
VERONA, WISCONSIN 53593  
P. 608.848.0960

**CLIENT:**  
**PRIME URBAN PROPERTIES, LLC**

**CLIENT ADDRESS:**  
1982 ATWOOD AVENUE  
MADISON, WI 53704

**PROJECT:**  
1222 SOUTH PARK STREET

**PROJECT LOCATION:**  
MADISON, WI  
DANE COUNTY

**PLAN MODIFICATIONS:**

#	Date	Description
1	07.23.20	DAT PRESENTATION
2	08.19.20	UDC INFORMATIONAL
3	09.16.20	LAND USE / UDC SUBMITTAL
4	12.21.20	SPV SUBMITTAL
5		
6		
7		
8		
9		
10		
11		
12		
13		
14		
15		

Design/Drawn: **MSB**  
Approved:

**SHEET TITLE:**  
**SITE PLAN**

**SHEET NUMBER:**  
**C2.0**

JSD PROJECT NO: 20-0723

**High Street improvements by City Project 12956.**

**5' Sidewalk  
8' Terrace  
1' Buffer**

- PAVING NOTES**
- GENERAL**
    - ALL PAVING SHALL CONFORM TO "STATE OF WISCONSIN STANDARD SPECIFICATIONS FOR HIGHWAY & STRUCTURE CONSTRUCTION, LATEST EDITION, APPLICABLE CITY OF MADISON ORDINANCES AND THE GEOTECHNICAL REPORT PREPARED BY FIRM DATED DATE.
    - SURFACE PREPARATION - NOTIFY ENGINEER/OWNER OF UNSATISFACTORY CONDITIONS. DO NOT BEGIN PAVING WORK UNTIL DEFICIENT SUBBASE AREAS HAVE BEEN CORRECTED AND ARE READY TO RECEIVE PAVING.
    - ANY REQUIRED REPLACEMENT OF PUBLIC CURB AND GUTTER SHALL MATCH EXISTING AND MEET MUNICIPALITY REQUIREMENTS.
  - ASPHALTIC CONCRETE PAVING SPECIFICATIONS**
    - CODES AND STANDARDS - THE PLACING, CONSTRUCTION AND COMPOSITION OF THE ASPHALTIC BASE COURSE AND ASPHALTIC CONCRETE SURFACE COURSE SHALL BE IN ACCORDANCE WITH THE REQUIREMENTS OF SECTIONS 450, 455, 460 AND 465 OF THE STATE OF WISCONSIN STANDARD SPECIFICATIONS FOR HIGHWAY AND STRUCTURE CONSTRUCTION, CURRENT EDITION. HEREAFTER, THIS PUBLICATION WILL BE REFERRED TO AS STATE HIGHWAY SPECIFICATIONS.
    - WEATHER LIMITATIONS - APPLY TACK COATS WHEN AMBIENT TEMPERATURE IS ABOVE 50° F (10° C) AND WHEN TEMPERATURE HAS NOT BEEN BELOW 30° F (1° C) FOR 12 HOURS IMMEDIATELY PRIOR TO APPLICATION. DO NOT APPLY WHEN BASE IS WET OR CONTAINS EXCESS OF MOISTURE. CONSTRUCT ASPHALTIC CONCRETE SURFACE COURSE WHEN ATMOSPHERIC TEMPERATURE IS ABOVE 40° F (4° C) AND WHEN BASE IS DRY AND WHEN WEATHER IS NOT RAINY. BASE COURSE MAY BE PLACED WHEN AIR TEMPERATURE IS ABOVE 30° F (1° C).
    - GRADE CONTROL - ESTABLISH AND MAINTAIN REQUIRED LINES AND ELEVATIONS FOR EACH COURSE DURING CONSTRUCTION.
    - CRUSHED AGGREGATE BASE COURSE - THE TOP LAYER OF BASE COURSE SHALL CONFORM TO SECTIONS 301 AND 305, STATE HIGHWAY SPECIFICATIONS.
    - BINDER COURSE AGGREGATE - THE AGGREGATE FOR THE BINDER COURSE SHALL CONFORM TO SECTIONS 460 AND 315, STATE HIGHWAY SPECIFICATIONS.
    - SURFACE COURSE AGGREGATE - THE AGGREGATE FOR THE SURFACE COURSE SHALL CONFORM TO SECTIONS 460 AND 465, STATE HIGHWAY SPECIFICATIONS.
    - ASPHALTIC MATERIALS - THE ASPHALTIC MATERIALS SHALL CONFORM TO SECTION 455 AND 460, STATE HIGHWAY SPECIFICATIONS.
  - CONCRETE PAVING SPECIFICATIONS**
    - CONCRETE PAVING SHALL BE IN ACCORDANCE WITH THE REQUIREMENTS OF SECTIONS 415 AND 416 OF THE STATE HIGHWAY SPECIFICATIONS.
    - CONCRETE PAVEMENT SHALL BE REINFORCED WITH NOVEMESH 950 (OR EQUAL) FIBER REINFORCEMENT AT A RATE OF 5 LBS./CUBIC YARD.
    - CURING COMPOUNDS SHALL CONFORM TO SECTION 415 OF THE STATE HIGHWAY SPECIFICATIONS.
    - CONTRACTOR SHALL PROVIDE CONTROL JOINTS AND CONSTRUCTION JOINTS OF ONE-QUARTER CONCRETE THICKNESS AT AN EQUAL RATIO OF LENGTH TO WIDTH WHEREVER POSSIBLE WITH A MAXIMUM LENGTH BETWEEN JOINTS OF 8' ON CENTER.
    - CONTRACTOR SHALL PROVIDE EXPANSION JOINTS IN SIDEWALKS AT A MAXIMUM 24' ON CENTER.
    - EXTERIOR CONCRETE SURFACES SHALL BE BROOM FINISHED.
    - ALL CONCRETE SURFACES TO BE SEALED WITH TYPE 1K-260V CONCRETE SEALANT.
    - PAVEMENT MARKING SPECIFICATIONS**
      - ALL PAVEMENT MARKINGS INCLUDING: STOP BARS, CROSSWALKS, DIRECTIONAL ARROWS, PARKING STALL LINES, ADA STALL MARKINGS, NO PARKING ZONES, DROP-OFF/PICK-UP ZONES SHALL BE PAINTED WITH LATEX PAINT PER SPECIFICATIONS.

FILE: I:\2020\1982 ATWOOD AVENUE\DWG\1982 ATWOOD AVENUE SITE PLAN.dwg User: jcs Date: 07/23/20 10:58:11 AM

# Sanitary & Water Services

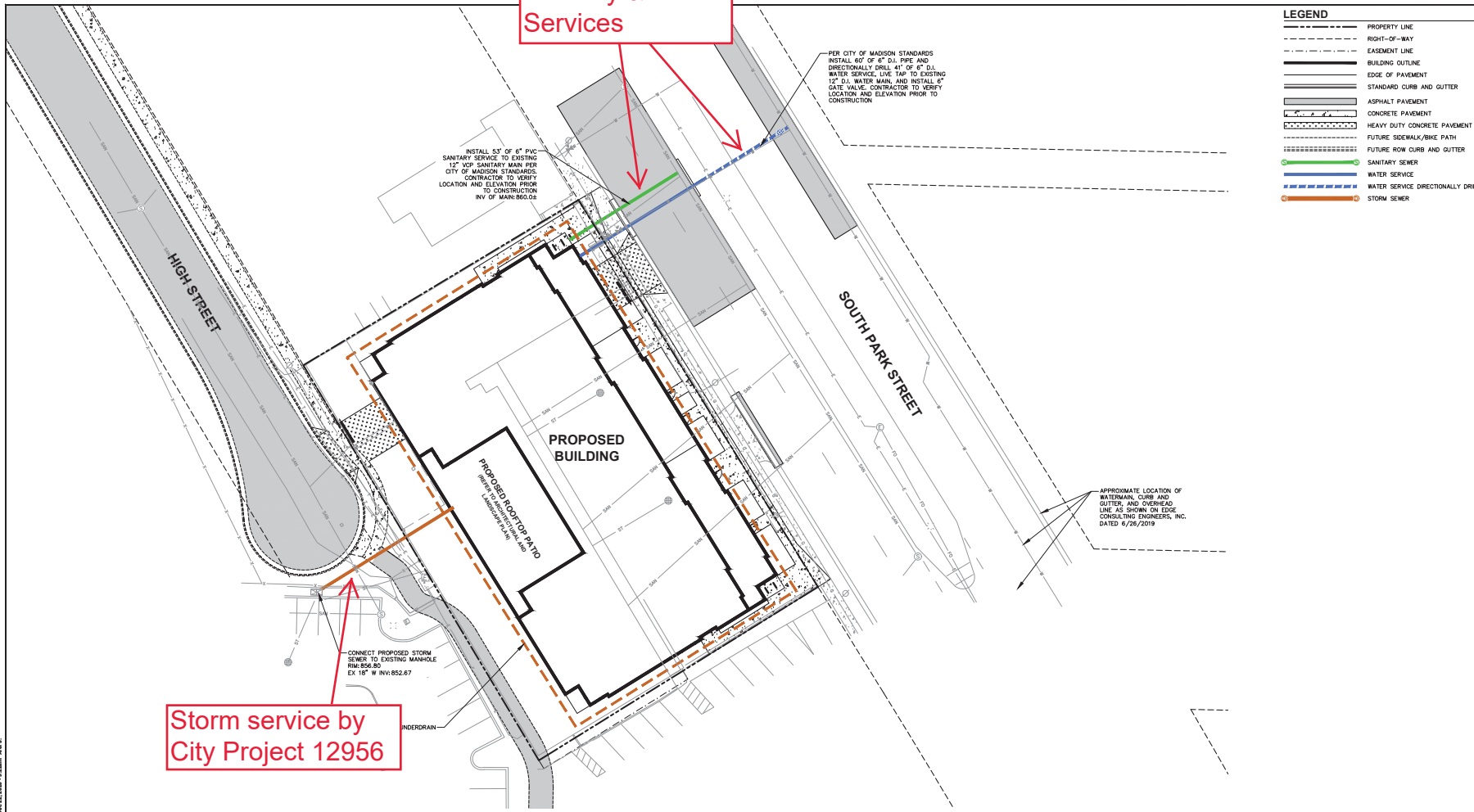

LEGEND	
	PROPERTY LINE
	RIGHT-OF-WAY
	EASEMENT LINE
	BUILDING OUTLINE
	EDGE OF PAVEMENT
	STANDARD CURB AND GUTTER
	ASPHALT PAVEMENT
	CONCRETE PAVEMENT
	HEAVY DUTY CONCRETE PAVEMENT
	FUTURE SIDEWALK/BIKE PATH
	FUTURE ROW CURB AND GUTTER
	SANITARY SEWER
	WATER SERVICE
	WATER SERVICE DIRECTIONALLY DRILL
	STORM SEWER

# Storm service by City Project 12956

### UTILITY NOTES

- ALL EXISTING UTILITIES ARE SHOWN FOR INFORMATIONAL PURPOSES ONLY AND ARE NOT GUARANTEED TO BE ACCURATE OR ALL INCLUSIVE. THE CONTRACTOR IS RESPONSIBLE FOR MAKING HIS OWN DETERMINATION AS TO THE TYPE AND LOCATIONS OF UNDERGROUND UTILITIES AS MAY BE NECESSARY TO AVOID DAMAGE THERETO. CONTRACTOR/OWNER SHALL CALL "DOGGER'S HOTLINE" PRIOR TO ANY CONSTRUCTION.
- PRIOR TO CONSTRUCTION THE PRIME CONTRACTOR IS RESPONSIBLE FOR:
  - EXAMINING ALL SITE CONDITIONS RELATIVE TO THE CONDITIONS INDICATED ON THE ENGINEERING DRAWINGS. ANY DISCREPANCIES ARE TO BE REPORTED TO THE ENGINEER AND RESOLVED PRIOR TO THE START OF CONSTRUCTION.
  - OBTAINING ALL PERMITS INCLUDING PERMIT COSTS, TAP FEES, METER DEPOSITS, BONDS, AND ALL OTHER FEES REQUIRED FOR PROPOSED WORK TO OBTAIN OCCUPANCY.
  - VERIFYING ALL ELEVATIONS, LOCATIONS AND SIZES OF SANITARY, WATER AND STORM LATERALS AND CHECK ALL UTILITY CROSSINGS FOR CONFLICTS. NOTIFY ENGINEER OF ANY DISCREPANCY. NO WORK SHALL BE PERFORMED UNTIL THE DISCREPANCY IS RESOLVED.
  - NOTIFYING ALL UTILITIES PRIOR TO INSTALLATION OF ANY UNDERGROUND IMPROVEMENTS.
  - ARRANGING FOR APPROPRIATE CONSTRUCTION OBSERVATION.
  - COORDINATING ALL CONSTRUCTION WITH OTHER CONTRACTORS INVOLVED WITH CONSTRUCTION OF THE PROPOSED DEVELOPMENT AND FOR REPORTING ANY ERRORS OR DISCREPANCIES BETWEEN THESE PLANS AND PLANS PREPARED BY OTHERS.
- ALL UTILITY WORK SHALL BE DONE IN ACCORDANCE WITH THE STANDARD SPECIFICATIONS FOR SEWER AND WATER CONSTRUCTION IN WISCONSIN -- AND ALL STATE AND LOCAL CODES AND SPECIFICATIONS. IT IS THE CONTRACTOR'S RESPONSIBILITY TO DETERMINE WHICH SPECIFICATIONS AND CODES APPLY, AND TO COORDINATE ALL CONSTRUCTION ACTIVITIES WITH THE APPROPRIATE LOCAL AND STATE AUTHORITIES.
- SPECIFICATIONS SHALL COMPLY WITH THE CITY OF MADISON STANDARD PROVISIONS.
- LENGTHS OF ALL UTILITIES ARE TO CENTER OF STRUCTURES OR FITTINGS AND MAY VARY SLIGHTLY FROM PLAN. LENGTHS SHALL BE VERIFIED IN THE FIELD DURING CONSTRUCTION.
- CONTRACTOR IS RESPONSIBLE FOR SITE SAFETY DURING THE CONSTRUCTION OF IMPROVEMENTS.
- CONTRACTOR SHALL INSTALL A PEDESTRIAN FENCE AROUND ALL EXCAVATIONS TO BE LEFT OPEN OVER NIGHT AS REQUIRED IN CONSTRUCTION SITES WHERE THE POTENTIAL FOR PEDESTRIAN HAZARD EXISTS.
- CONTRACTOR SHALL ADJUST AND/OR RECONSTRUCT ALL UTILITIES (SUCH AS MANHOLE COVERS, VALVE BOX COVERS, ETC.) TO MATCH THE FINISHED GRADES OF THE AREAS EFFECTED BY THE CONSTRUCTION.
- THE PRIME CONTRACTOR IS RESPONSIBLE FOR COORDINATING ALL CONSTRUCTION WITH OTHER CONTRACTORS INVOLVED WITH CONSTRUCTION OF THE PROPOSED DEVELOPMENT AND FOR REPORTING ANY ERRORS OR DISCREPANCIES BETWEEN THESE PLANS AND PLANS PREPARED BY OTHERS.
- ANY SANITARY SEWER, SANITARY SEWER SERVICES, WATER MAIN, WATER SERVICES, STORM SEWER, OR OTHER UTILITIES, WHICH ARE DAMAGED BY THE CONTRACTORS, SHALL BE REPAIRED TO THE OWNER'S SATISFACTION AT THE CONTRACTOR'S EXPENSE.
- THE CONTRACTOR IS RESPONSIBLE FOR PROVIDING THE ENGINEER WITH AS-BUILT CONDITIONS OF THE DESIGNATED IMPROVEMENTS IN ORDER THAT THE APPROPRIATE DRAWINGS CAN BE PREPARED, IF REQUIRED. ANY CHANGES TO THE DRAWINGS OR ADDITIONAL ITEMS MUST BE REPORTED TO THE ENGINEER AS WORK PROGRESSES.
- STORM SEWER SPECIFICATIONS --
  - PIPE -- REINFORCED CONCRETE PIPE (RCP) SHALL MEET THE REQUIREMENTS OF ASTM CLASS II (MINIMUM) C-76 WITH RUBBER GASKET JOINTS CONFORMING TO ASTM C-443. HIGH DENSITY DUAL-WALL POLYETHYLENE COMPOUNDED PIPE SHALL BE AS MANUFACTURED BY ADS OR EQUAL WITH WATER TIGHT JOINTS, AND SHALL MEET THE REQUIREMENTS OF AASHTO DESIGNATION M-294 TYPE "S".
  - INLETS -- INLETS SHALL BE CONSTRUCTED IN ACCORDANCE WITH FILE NO. 28 OF THE "STANDARD SPECIFICATIONS", OR APPROVED EQUAL, WITH A 1'-6" X 2'-6" MAXIMUM OPENING. CURB FRAME & GRATE SHALL BE KEENANI R-3087 WITH TYPE R GRATE, OR EQUAL.
  - BACKFILL AND BEDDING -- STORM SEWER SHALL BE CONSTRUCTED WITH GRAVEL BACKFILL AND CLASS "D" BEDDING IN ALL PAVED AREAS AND TO A POINT 5 FEET BEYOND THE EDGE OF PAVEMENT. TRENCHES RUNNING PARALLEL TO AND LESS THAN 5 FEET FROM THE EDGE OF PAVEMENT SHALL ALSO REQUIRE GRAVEL BACKFILL. LANDSCAPED AREAS MAY BE BACKFILLED WITH EXCAVATED MATERIAL IN CONFORMANCE WITH SECTION 8.4.3.5 OF THE "STANDARD SPECIFICATIONS".
  - FIELD TILE CONNECTION -- ALL FIELD TILE ENCOUNTERED DURING CONSTRUCTION SHALL BE INCLUDED IN THE UNIT PRICE(S) FOR STORM SEWER. TILE LINES CROSSED BY THE TRENCH SHALL BE REPLACED WITH THE SAME MATERIAL AS THE STORM SEWER.
  - WATER MAIN SPECIFICATIONS --
    - PIPE -- DUCTILE IRON PIPE SHALL BE CLASS 52 CONFORMING TO ANMA C151 AND CHAPTER 8.18.0 OF THE "STANDARD SPECIFICATIONS". POLYVINYL CHLORIDE (PVC) PIPE SHALL MEET THE REQUIREMENTS OF ANMA STANDARD C-290, CLASS 150, DR-18, WITH CAST IRON O.D. AND INTEGRAL ELASTOMERIC BELL AND SPIGOT JOINTS. NON-METALLIC WATER MAINS SHALL BE INSTALLED WITH BLUE INSULATION TRACER WIRE AND CONFORM WITH SP5 382-30(1)(5).
    - VALVES AND VALVE BOXES -- GATE VALVES SHALL BE ANMA GATE VALVES MEETING THE REQUIREMENTS OF ANMA C-500 AND CHAPTER 8.27.0 OF THE "STANDARD SPECIFICATIONS". GATE VALVES AND VALVE BOXES SHALL CONFORM TO LOCAL PUMPING ORDINANCES.
- HYDRANTS -- HYDRANTS SHALL CONFORM TO THE SPECIFICATIONS OF THE CITY OF MADISON. THE DISTANCE FROM THE GROUND LINE TO THE CENTERLINE OF THE LOWEST NOZZLE AND THE LOWEST CONNECTION OF THE FIRE DEPARTMENT SHALL BE NO LESS THAN 18-INCHES AND NO GREATER THAN 23-INCHES (SEE DETAIL).
- BEDDING AND COVER MATERIAL -- PIPE BEDDING AND COVER MATERIAL SHALL BE SAND, CRUSHED STONE CHPS OR CRUSHED STONE SCREENINGS CONFORMING TO CHAPTER 8.4.3.2 OF THE "STANDARD SPECIFICATIONS".
- BACKFILL -- BACKFILL MATERIAL AND INSTALLATION SHALL BE IN ACCORDANCE WITH CHAPTER 2.6.0 OF THE "STANDARD SPECIFICATIONS". GRAVEL BACKFILL IS REQUIRED IN ALL PAVED AREAS AND TO A POINT 5 FEET BEYOND THE EDGE OF PAVEMENT. TRENCHES RUNNING PARALLEL TO AND LESS THAN 5 FEET FROM THE EDGE OF PAVEMENT SHALL ALSO REQUIRE GRAVEL BACKFILL. LANDSCAPED AREAS MAY BE BACKFILLED WITH EXCAVATED MATERIAL IN CONFORMANCE WITH SECTION 8.4.3.5 OF THE "STANDARD SPECIFICATIONS".
- SANITARY SEWER SPECIFICATIONS --
  - PIPE -- SANITARY SEWER PIPE MATERIAL SHALL BE POLYVINYL CHLORIDE (PVC) MEETING REQUIREMENTS OF ASTM D 3034, SDR-35, WITH INTEGRAL BELL TYPE FLEXIBLE ELASTOMERIC JOINTS, MEETING THE REQUIREMENTS OF ASTM D-3212.
  - BEDDING AND COVER MATERIAL -- BEDDING AND COVER MATERIAL SHALL CONFORM TO THE APPROPRIATE SECTIONS OF THE "STANDARD SPECIFICATION" WITH THE FOLLOWING MODIFICATION: "COVER MATERIAL SHALL BE THE SAME AS USED FOR BEDDING AND SHALL CONFORM TO SECTION 8.4.3.2 (A). BEDDING AND COVER MATERIAL SHALL BE PLACED IN A MINIMUM OF THREE SEPARATE LIFTS, OR AS REQUIRED TO INSURE ADEQUATE COMPACTING OF THESE MATERIALS, WITH ONE LIFT OF BEDDING MATERIAL ENDING AT OR NEAR THE SPRINGLINE OF THE PIPE. THE CONTRACTOR SHALL TAKE CARE TO COMPLETELY WORK BEDDING MATERIAL UNDER THE HAUNCH OF THE PIPE TO PROVIDE ADEQUATE SIDE SUPPORT."
  - BACKFILL -- BACKFILL MATERIAL AND INSTALLATION SHALL BE IN ACCORDANCE CHAPTER 2.6.0 OF THE "STANDARD SPECIFICATIONS". GRAVEL BACKFILL IS REQUIRED IN ALL PAVED AREAS AND TO A POINT 5 FEET BEYOND THE EDGE OF PAVEMENT. TRENCHES RUNNING PARALLEL TO AND LESS THAN 5 FEET FROM THE EDGE OF PAVEMENT SHALL ALSO REQUIRE GRAVEL BACKFILL. LANDSCAPED AREAS MAY BE BACKFILLED WITH EXCAVATED MATERIAL IN CONFORMANCE WITH SECTION 8.4.3.5 OF THE "STANDARD SPECIFICATIONS".
  - MANHOLES -- MANHOLES SHALL BE CONSTRUCTED IN ACCORDANCE WITH FILE NOS. 12, 13 AND 15 OF THE "STANDARD SPECIFICATIONS" AND ALL SPECIAL PROVISIONS OF THE CITY OF MADISON.
- WATERMAIN AND SANITARY SEWER SHALL BE INSULATED WHEREVER THE DEPTH OF COVER IS LESS THAN 6 FEET. INSULATION AND INSTALLATION OF INSULATION SHALL BE CONFORMING WITH CHAPTER 4.17.0 "INSULATION" OF THE "STANDARD SPECIFICATIONS" FOR SEWER AND WATER CONSTRUCTION IN WISCONSIN 6TH EDITION UPDATED WITH ITS LATEST ADDENDUM (TYP.).



CREATE THE VISION TELL THE STORY

MADISON | MILWAUKEE | WAUSAU  
APPLETON | KENOSHA | CHICAGO  
CROSSVILLE

MADISON REGIONAL OFFICE  
161 HOSKOPF DRIVE, SUITE 101  
VERONA, WISCONSIN 53593  
P. 608.848.0900

CLIENT:  
**PRIME URBAN PROPERTIES, LLC**

CLIENT ADDRESS:  
1952 ATWOOD AVENUE  
MADISON, WI 53704

PROJECT:  
1222 SOUTH PARK STREET

PROJECT LOCATION:  
MADISON, WI  
DANE COUNTY

PLAN MODIFICATIONS	
#	Description
1	07.23.20 DAT PRESENTATION
2	08.19.20 UDC INFORMATIONAL
3	09.16.20 LAND USE UDC SUBMITTAL
4	12.21.20 SPV SUBMITTAL
5	
6	
7	
8	
9	
10	
11	
12	
13	
14	
15	

Design/Drawn: MSB  
Approved:

SHEET TITLE:  
**UTILITY PLAN**

SHEET NUMBER:

# C4.0

JSD PROJECT NO.: 20-0723

Plan: 13/08/2019 10:27:00 AM C:\Users\jps\OneDrive\Documents\1222 South Park Street\1222 South Park Street.dwg User: jps Date: 12/23/20 10:27:00 AM