



# City of Madison Water Utility

## 115 S Paterson Street, Stormwater Vault

Madison, Wisconsin  
Contract No. \_\_, Project No. \_\_

**Mead & Hunt**  
Mead & Hunt, Inc.  
2440 Deming Way  
Middleton, WI 53562  
phone: 608-273-6380  
meadhunt.com

© Copyright 2015  
This document, or any portion thereof, shall not be duplicated, disclosed, or used on any other project or extension of this project except by written agreement with Mead & Hunt, Inc. Mead & Hunt shall not be responsible for any unauthorized use of, or alteration to these documents.



City of Madison Water Utility  
115 S. Paterson Street, Stormwater Vault  
Contract No. \_\_, Project No. \_\_  
Madison, Wisconsin

STATE MAP:

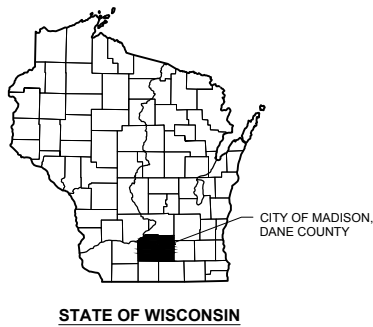

VICINITY MAP:

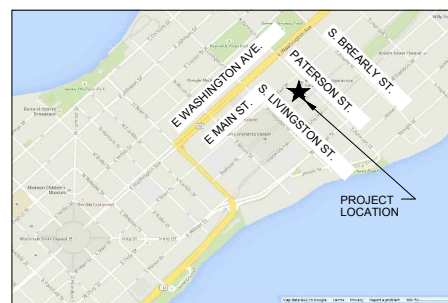

SITE MAP

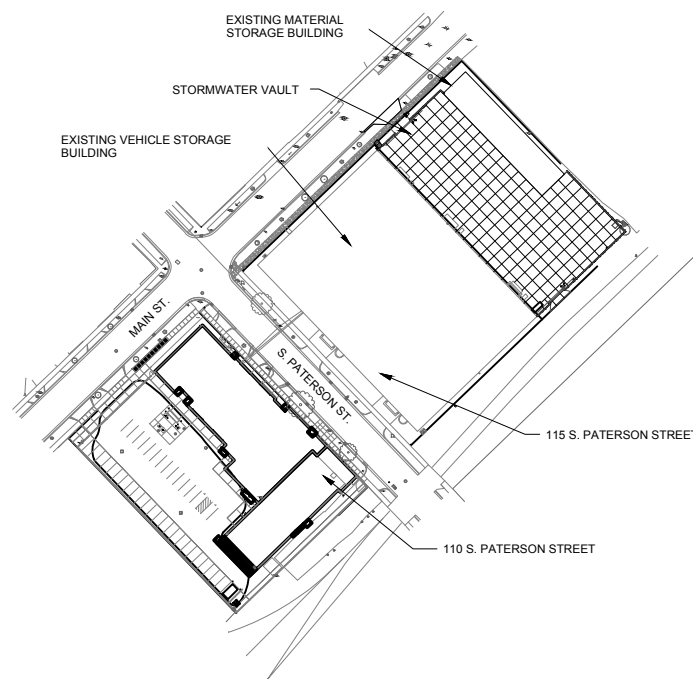

SHEET INDEX

Sheet Number	Sheet Title
G-001	COVER SHEET
C-141	SITE UTILITY PLAN
C-501	DETAILS

ISSUED  
2/24/17 CITY REVIEW

MBH NO.: 3235300-131021.02  
DATE: March 21, 2017  
DESIGNED BY: ACA  
DRAWN BY: CAJ  
CHECKED BY: RCL

DO NOT SCALE DRAWINGS

SHEET CONTENTS  
COVER SHEET

SHEET NO.:

G-001

These documents shall not be used for any purpose or project for which it is not intended. Mead & Hunt shall be indemnified by the client and held harmless from all claims, damages, liabilities, losses, and expenses, including attorneys' fees and costs, arising out of such misuse or reuse of the documents. In addition, unauthorized reproduction of these documents, in part or as a whole, is prohibited.



City of Madison Water Utility  
 115 S Paterson Street, Stormwater Vault  
 Contract No. \_\_\_\_\_, Project No. XXXXX  
 Madison, Wisconsin

ISSUED  
 02/28/17 CITY REVIEW

MH NO: 3235300-131021.02  
 DATE: March 8, 2017  
 DESIGNED BY: XXX  
 DRAWN BY: XXX  
 CHECKED BY: XXX  
 DO NOT SCALE DRAWINGS

SHEET CONTENTS  
 SITE UTILITY PLAN

SHEET NO.

C-141

**SITE UTILITY PLAN NOTES:**

1. MATERIAL STORAGE BUILDING, SITE PAVING, FENCE, STORM SEWER, ROOF WATER RECOVERY TANK, SIDEWALK, CONCRETE PAVEMENT IS UNDER SEPARATE CONTRACT.
2. EXISTING SURFACE IS GRAVEL. CONCRETE PAVING TO OCCUR UNDER SEPARATE CONTRACT ONCE UNDERGROUND CONCRETE VAULT IS INSTALLED, BACKFILLED AND COMPACTED.
3. NO CONSTRUCTION TRAFFIC PERMITTED OVER ROOF WATER RECOVERY TANK OR UNDERGROUND STORAGE VAULT. PROTECT THE AREA AROUND TANKS.
4. NO CONSTRUCTION VEHICLE TRACKING OVER STORM SEWER PIPE UNTIL A MINIMUM OF 2.5 FEET OF COVER IS INSTALLED.
5. EXISTING STORM SEWER PIPES ARE POLYPROPYLENE UNLESS LABELED OTHERWISE.

**LEGEND:**

- STORM INLET, CURB
- STORM INLET, ROUND
- STORM INLET, SQUARE
- STORM SEWER MANHOLE
- SD STORM SEWER

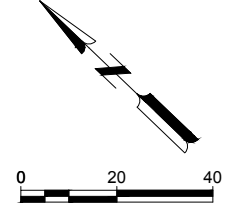
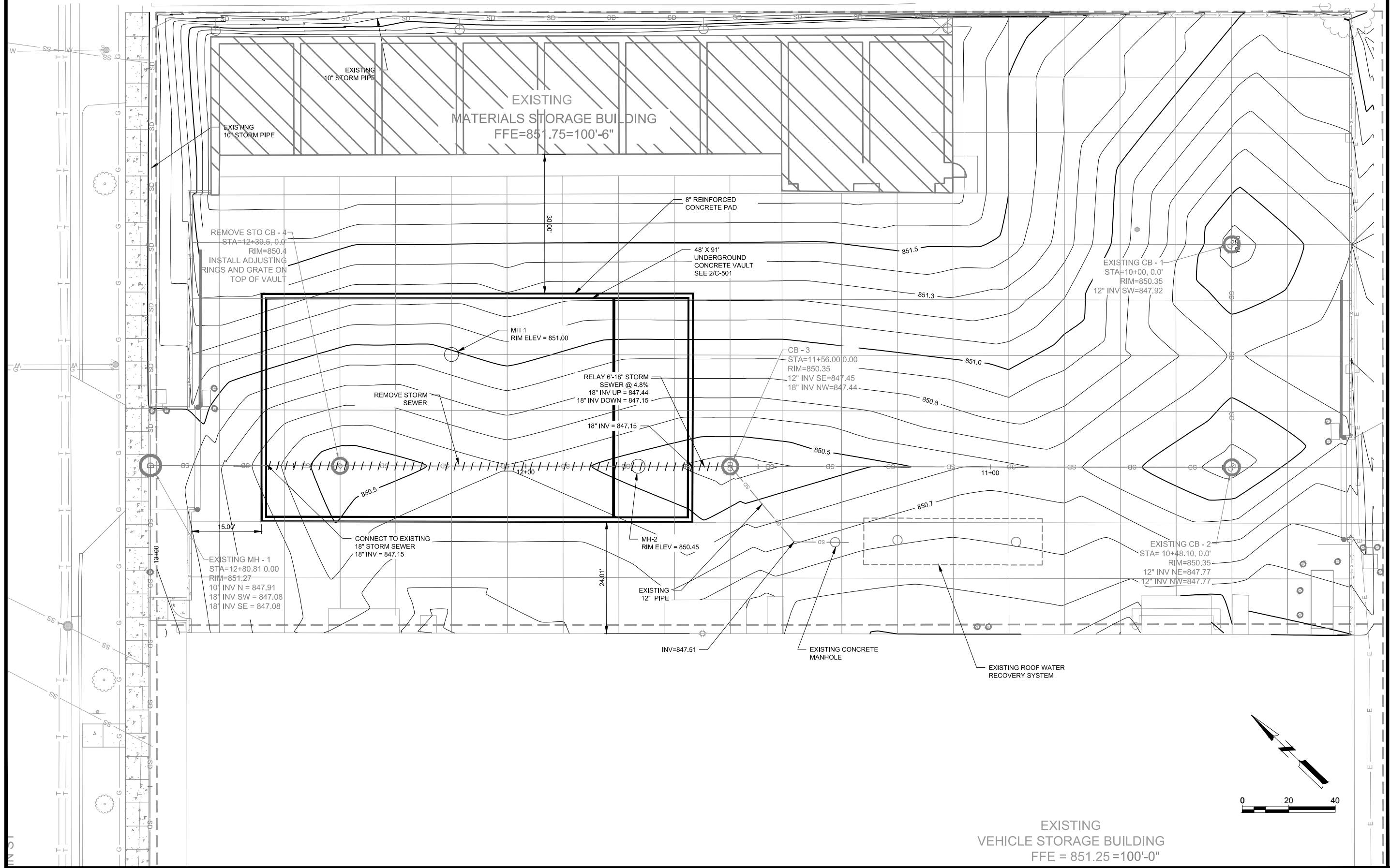

EXISTING  
 VEHICLE STORAGE BUILDING  
 FFE = 851.25=100'-0"

X:\3235300\131021.02\TECH\CAD\STORMWATER PLANS\C-141 SITE UTILITY PLAN.DWG  
 2/28/2017 3:21:01 PM

These documents shall not be used for any purpose or project for which it is not intended. Mead & Hunt shall be indemnified by the client and held harmless from all claims, damages, liabilities, losses, and expenses, including attorneys' fees and costs, arising out of such issue or reuse of the documents. In addition, unauthorized reproduction of these documents, in part or as a whole, is prohibited.



City of Madison Water Utility  
115 S Paterson Street, Stormwater Vault  
Contract No. \_\_\_\_\_, Project No. XXXXX  
Madison, Wisconsin

ISSUED  
02/28/17 CITY REVIEW

MSH NO.: 3235300-131021.02  
DATE: March 8, 2017  
DESIGNED BY: XXX  
DRAWN BY: XXX  
CHECKED BY: XXX  
DO NOT SCALE DRAWINGS

SHEET CONTENTS  
DETAILS

SHEET NO.

**C-501**

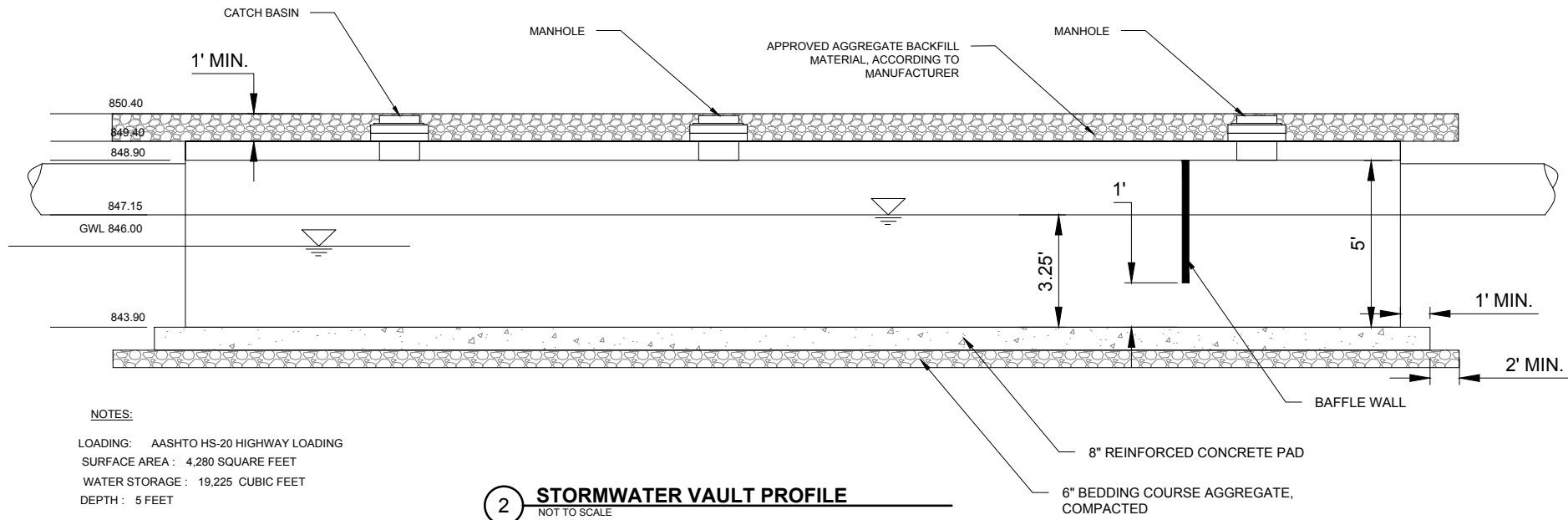

**NOTES:**  
LOADING: AASHTO HS-20 HIGHWAY LOADING  
SURFACE AREA: 4,280 SQUARE FEET  
WATER STORAGE: 19,225 CUBIC FEET  
DEPTH: 5 FEET

**2 STORMWATER VAULT PROFILE**  
NOT TO SCALE

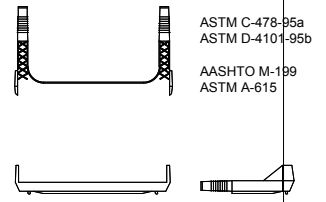

**4 STAIR DETAIL**  
NOT TO SCALE

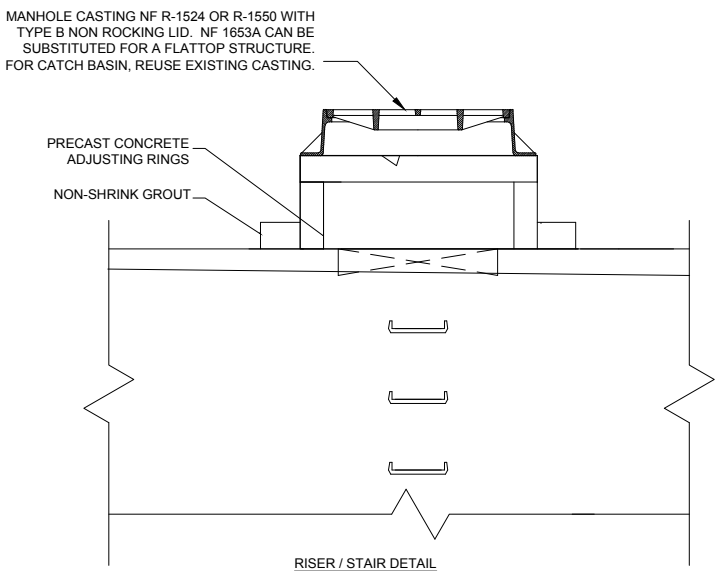

**3 RISER/STAIR DETAIL**  
NOT TO SCALE

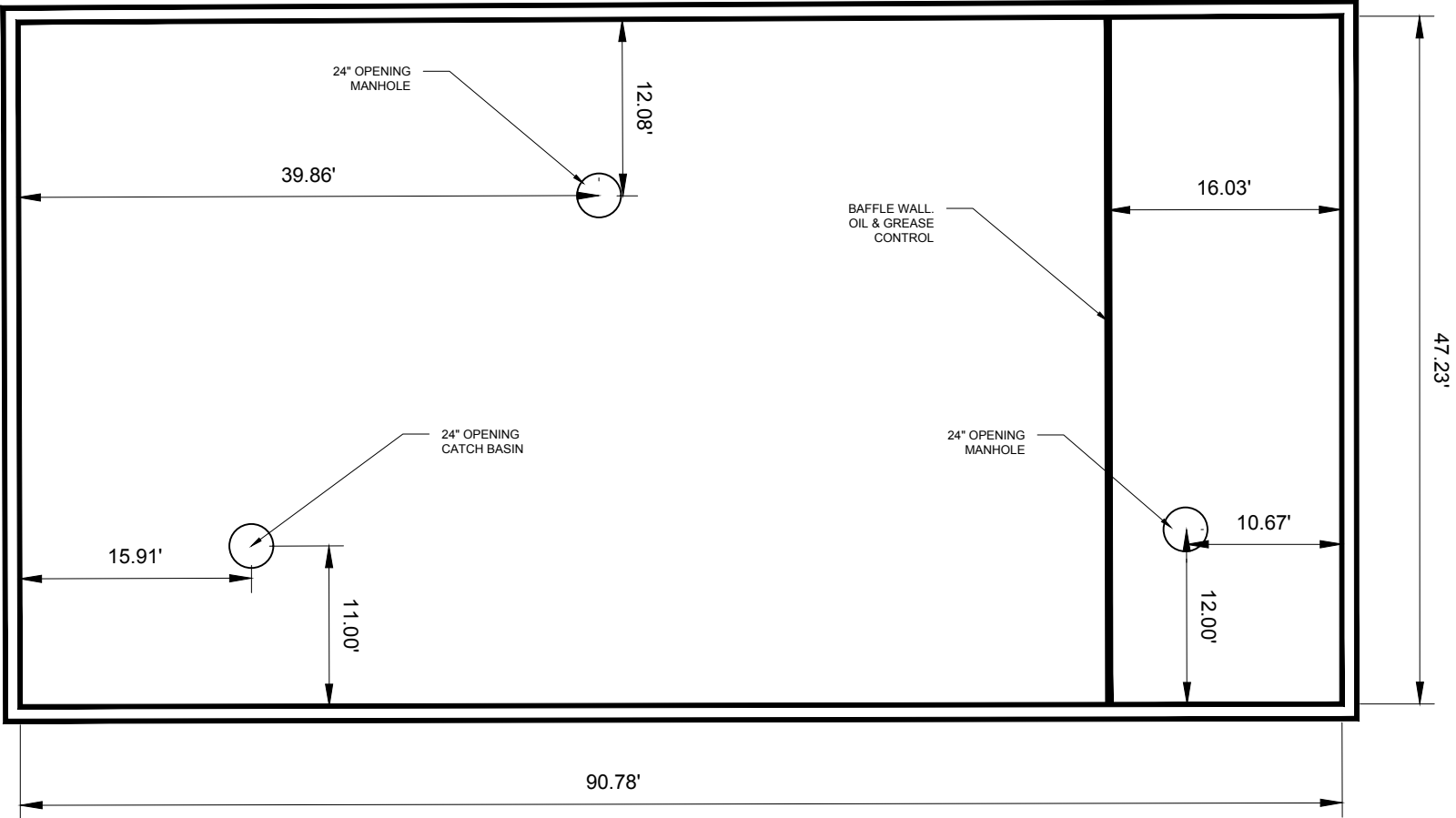

**1 STORMWATER VAULT LAYOUT DETAIL**  
NOT TO SCALE

X:\3235300\131021.02\TECH\CAD\STORMWATER PLANS\C-501.DWG  
2/28/2017 3:11:40 PM