

Most of the land in the planning area is either being farmed or is vacant land. The vacant lands are primarily areas with steeper topography or unproductive soils that are less desirable for farming.

## 2. Residential

There are approximately 291 acres of residential land use within the planning area containing 158 homes. The majority of the residences are distributed along the existing primary roadways within the planning area. Cul-de-sac streets have been developed in several locations that provide access to homes. There are 18 homes residences located within Bridle Downs, the only platted subdivision within the planning area.

## 3. Commercial

There are approximately eight commercial uses located in the planning area. These include Proscapes LLC, Apex—Warehouses for Rent, Affordable Self Storage and Capitol Decorating located on CTH T, Camp K-9

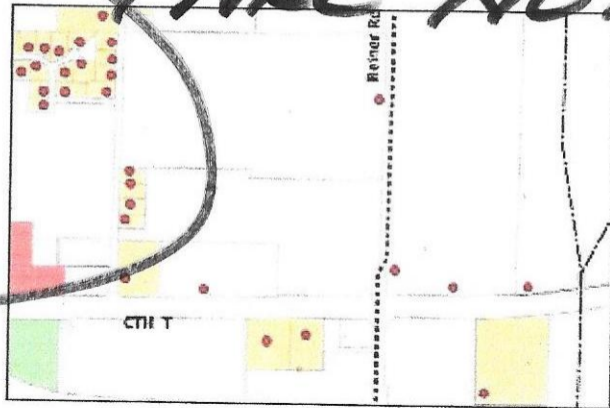

Map 4: Existing Land Use (excerpt)