

**City of Madison**  
**State Street Confluence Public Art Installation**  
**Working Title: *Both / And – Tolerance / Innovation***

Artist Team: David Dahlquist and Matt Niebuhr  
November 9, 2016



## Preliminary Concept Narrative

---

“A type of logic used in decision making that allows for a greater variety and scope of outcomes than a rigid either/or decision making process. This approach is useful when comparing two or more possible tracks or outcomes in a real world setting.”



## Preliminary Concept Narrative

---

The word “Confluence” has been used to identify this special place on the State Street pedestrian mall on the University of Wisconsin – Madison campus. The meaning of confluence is based on the junction of two rivers of approximately equal width, merging into one steady stream. But the concept of confluence goes much deeper, especially in this specific location. Confluence represents the merging of the City of Madison with the University. Confluence is the “town and gown” relationship embodied in a real place. Confluence is the form that knowledge takes, a way of “knowing” that merges the world of research and discovery (the University Library on one side), with the world of belief, (symbolized by three different religious denominations on the other).





## Preliminary Concept Narrative

---

Matt and I have spent a lot of time walking this site, photographing it from every perspective. We climbed to the top of the Humanities Building to see, in a bird's eye view, the steady stream of students coming and going from classes, meeting people on their way up and down State Street. It is an unending “flow” that rises and falls, people meeting people each day, a new beginning each year. This “current” is a tangible energy that fills this special place. For me, personally, I have moved through this corridor for over 40 years. I have felt this energy in many ways and carry it with me still.

The title, “Both/And—Tolerance/Innovation” speaks to the confluence of ideas and cultural diversity coming together in a dynamic cause and effect relationship; that a new consciousness arises from this river of people.





## Preliminary Concept Narrative

---

Our installation represents a causality, a space and time where reality merges with abstraction, and from this moment of brief turbulence, almost like a river's eddy, a transformation occurs. The flow continues, up and down stream.

Both/And is an acceptance of seemingly disparate thoughts, coming together in a way that fosters the tolerance that leads to innovation. The space or resonance between the stone (reality) and the stainless-steel vertical sculpture (abstraction), embodies Aristotle's philosophy of knowledge, "*being qua being*," the metaphysical reasoning at the heart of learning. It is the mysterious "essence of nature," and the relationship between the natural and the built environment.



# Flow Diagram

---

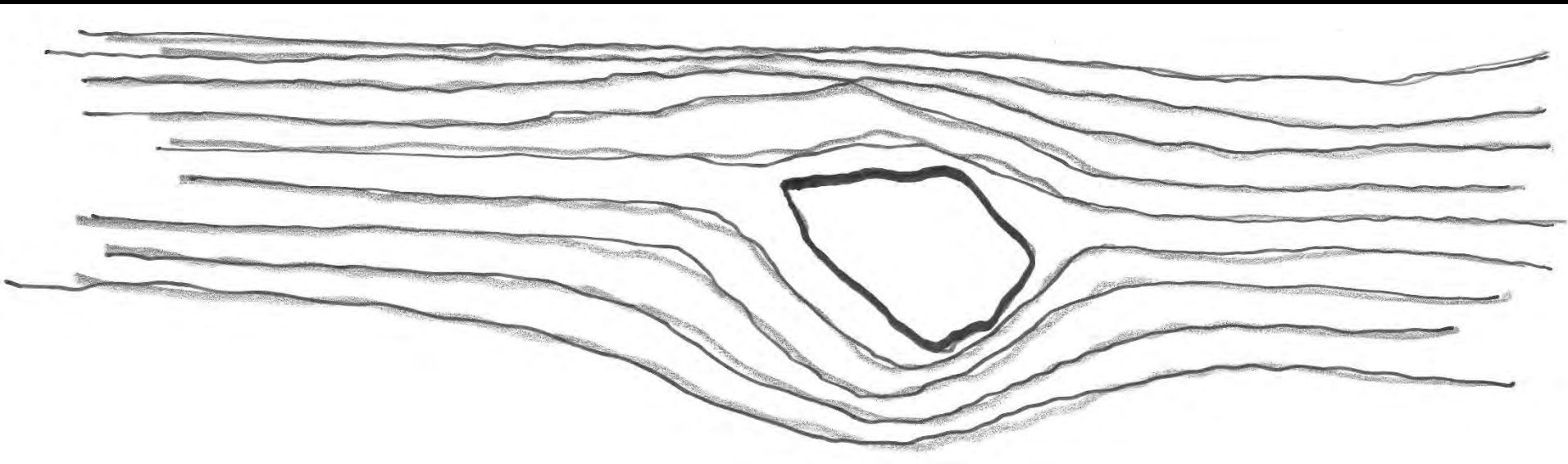



## Preliminary Concept Narrative

---

The monumental metal sculpture will be fabricated of angel-hair stainless-steel plates. The individual plates will be laser-cut with patterns that allow light to move between the plates to create a transparent moray effect. A cylinder, cut through the plates, is based on the solar equinox and the relative position of the sun. The viewer will orient themselves to this position in the spring and fall, to be bathed in sunlight. At night, this circular path between the plates will glow with interior LED illumination as a bright accent in the sky.



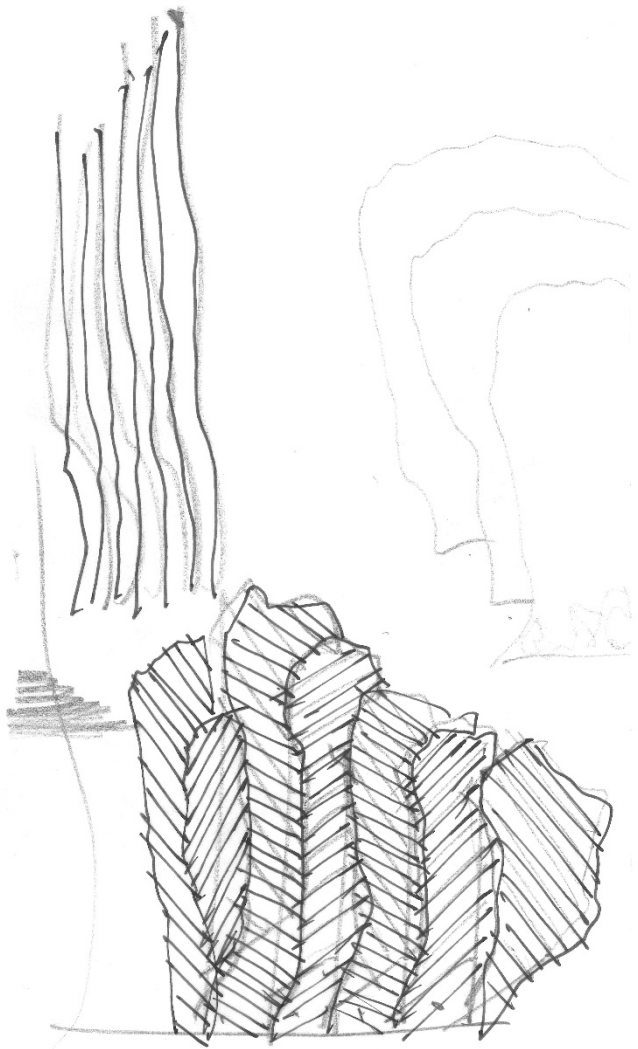

## Preliminary Concept Narrative

---

Our concept proposal specifically uses the existing, previously constructed footing, with minor modification. The installation incorporates LED lighting to create a dramatic, glowing ambiance, thoughtful of the site as it changes from day to night. The stone, either selectively quarried native Wisconsin granite or glacial erratic, lit from below, will appear to “float” at night. The monumental stone, like ancient dolmen or cairn, will become a “touchstone.” The companion sculpture will be internally illuminated, an iconic beacon seen from a distance in both directions. The installation will mark a new destination where people will gather and where new traditions will begin.





**Confluence Site**

---



700

University Book Store

PREIS HOUSE  
STUDENT HOURS  
BRING ALL OF WHO YOU ARE  
WORLDWIDE TRAVELERS 4:30 PM  
ALL ARE WELCOME  
WWW.PREISHOUSE.ORG



**PRES HOUSE**  
STUDENT MINISTRY  
BRING ALL OF WHO YOU ARE  
WORSHIP SUNDAYS 4:30 PM  
ALL ARE WELCOME  
WWW.PRESHOUSE.ORG

**ABJ**  
STUDENT MINISTRY  
**HOW LEASING**  
STUDENT MINISTRY



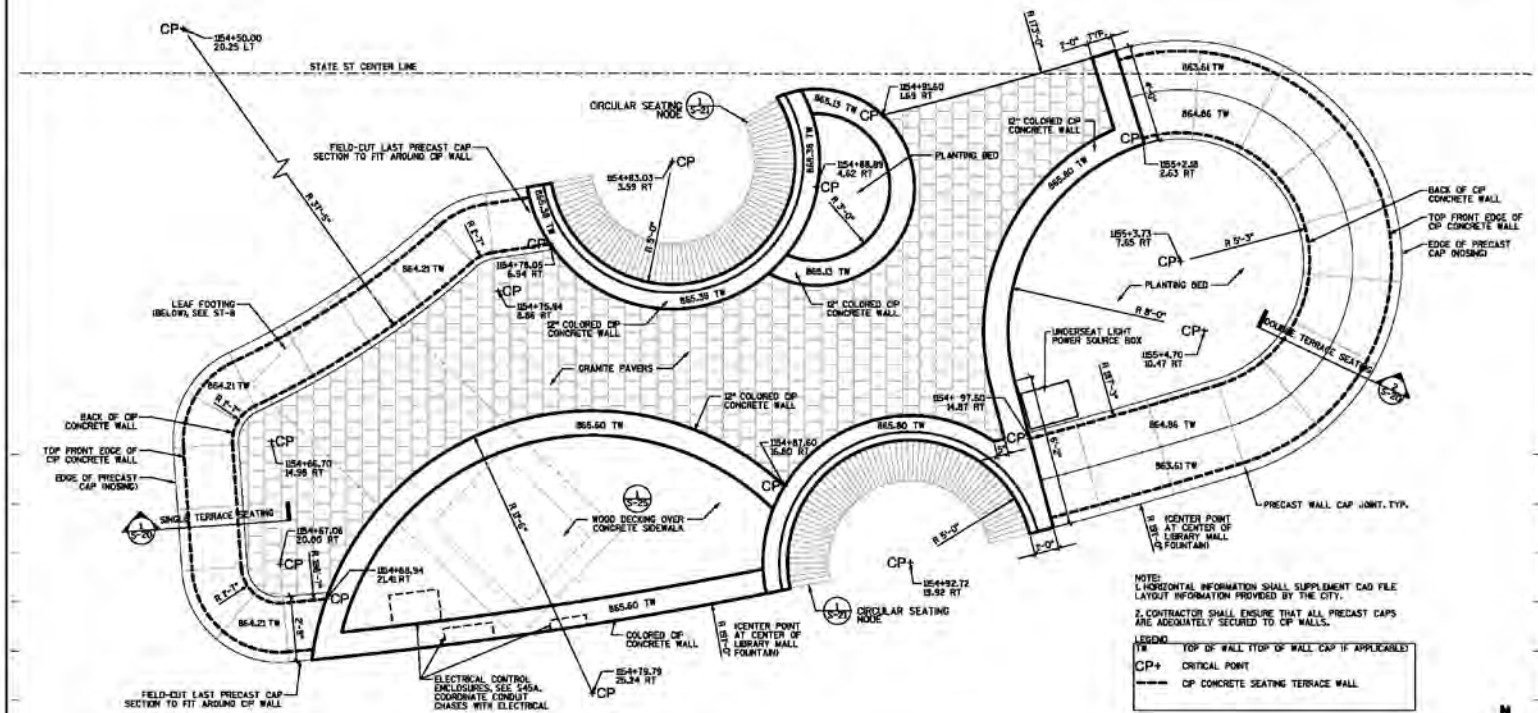

THIS SHEET IN ITS ENTIRETY WAS REVISED 07/11/2014

**13-38** CONFLUENCE EAST ISLAND SITE PLAN ENLARGEMENT  
1/4"=1'-0"



PLOT NAME: \_\_\_\_\_  
 PLOT NAME: \_\_\_\_\_  
 REVISION DATE: \_\_\_\_\_  
 CITY OF MADISON, UTHERS & ASSOCIATES

















MATERIAL DESIGN PROPERTIES

<b>GENERAL INFORMATION</b>	
LOGICNO	0 - 1000 ps
PLATE	2 - 4000 ps
<b>REINFORCING STEEL PROPERTIES</b>	
BAR DESIGN # (A, #4, #5, #6)	( $f_y = 60,000$ )
<b>STEEL PLATE DESIGN PROPERTIES</b>	
STEEL SPECIFICATION (A36, A572)	A36
DESIGN STRESS (TENSILE) (TYPICAL) (ksi)	( $f_t = 36,000$ )
DESIGN STRESS (COMPRESSION) (TYPICAL) (ksi)	( $f_c = 36,000$ )
<b>WELDING</b>	
WELDING CODE (AWS)	E70XX
WELDING PROCEDURE (FOR ALL TYPES OF WELDING) (AWS)	
DESIGN STRESS (TENSILE) (TYPICAL) (ksi)	
DESIGN STRESS (COMPRESSION) (TYPICAL) (ksi)	
CONSTRUCTION (WELDING) (AWS)	

DESIGN DATA

<b>REBAR CODE</b>		<b>DESIGN STRESS (TENSILE)</b>	36 ksi
REBAR SPECIFICATION (A36, A572)	A36	DESIGN STRESS (COMPRESSION)	36 ksi
DESIGN STRESS (TENSILE) (TYPICAL) (ksi)		DESIGN STRESS (COMPRESSION) (TYPICAL) (ksi)	
<b>WELDING INFORMATION</b>		<b>DESIGN STRESS (TENSILE)</b>	36 ksi
WELDING CODE (AWS)	E70XX	DESIGN STRESS (COMPRESSION)	36 ksi
WELDING PROCEDURE (FOR ALL TYPES OF WELDING) (AWS)		DESIGN STRESS (TENSILE) (TYPICAL) (ksi)	
DESIGN STRESS (TENSILE) (TYPICAL) (ksi)		DESIGN STRESS (COMPRESSION) (TYPICAL) (ksi)	

STATE STREET 700 / 800 BLOCKS PROJECT NO. 53W1193	SHEET NO. ST-8
SCULPTURE FOUNDATION	
STATE STREET	CITY OF MADISON

PLOT SCALE: \_\_\_\_\_  
 PLOT NAME: \_\_\_\_\_  
 REV. DATE: \_\_\_\_\_  
 OPERATOR: CITY OF MADISON, STREET DESIGN

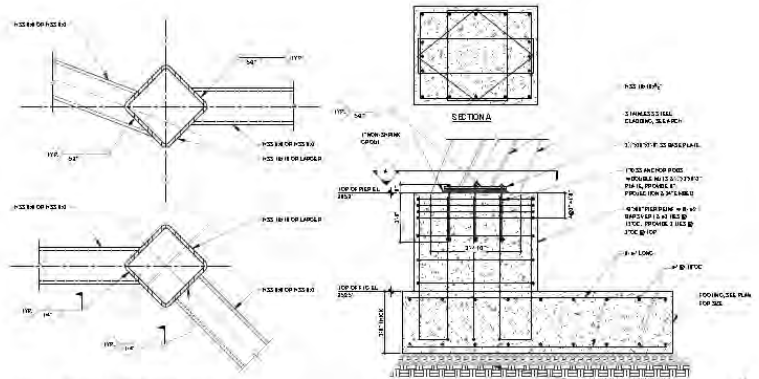

3 RECOMMENDED TYPICAL DETAILS  
SCALE: NTS

2 SCULPTURE FOUNDATION DETAIL  
SCALE: 1/4" = 1'-0"  
1. SCULPTURE FOUNDATION DETAIL (FOR REINFORCING)  
2. SCULPTURE FOUNDATION DETAIL (FOR CONCRETE)

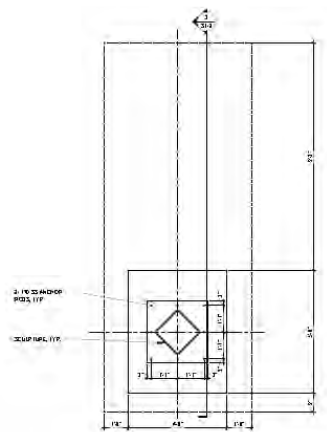

1 SCULPTURE FOUNDATION PLAN  
SCALE: 1/4" = 1'-0"



CONSTRUCTION OF CONCRETE FOUNDATION (DETAILS 1 AND 2) BY OTHERS UNDER CITY CONTRACT 728K.





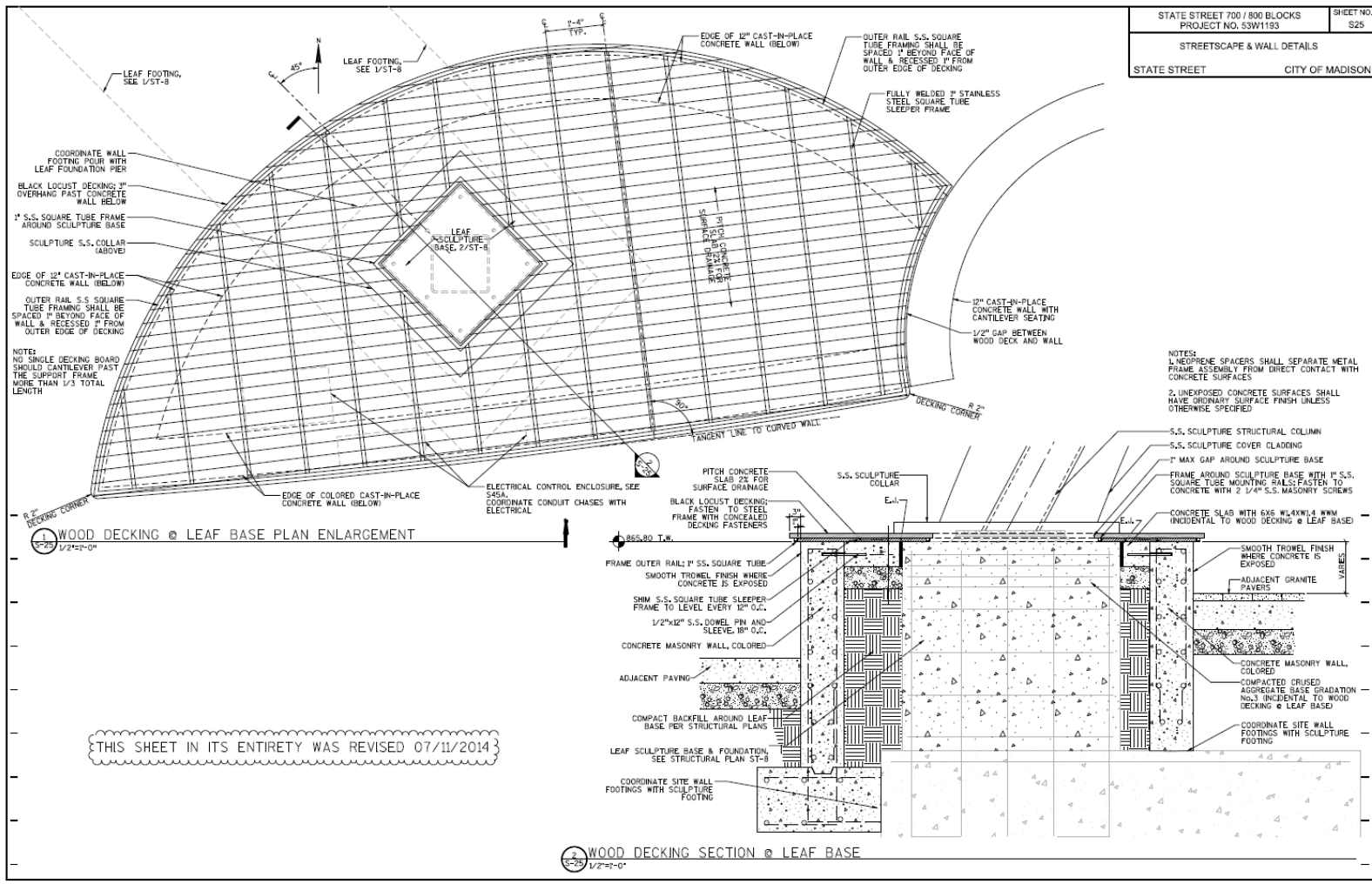

LEAF FOOTING, SEE 1/ST-8

LEAF FOOTING, SEE 1/ST-8

LEAF SCULPTURE BASE, 2/ST-8

COORDINATE WALL FOOTING POUR WITH LEAF FOUNDATION PIER

BLACK LOCUST DECKING: 3" OVERHANG FAST CONCRETE WALL BELOW

1" S.S. SQUARE TUBE FRAME AROUND SCULPTURE BASE

SCULPTURE S.S. COLLAR (ABOVE)

EDGE OF 12" CAST-IN-PLACE CONCRETE WALL (BELOW)

OUTER RAIL S.S. SQUARE TUBE FRAMING SHALL BE SPACED 1" BEYOND FACE OF WALL & RECESSED 1" FROM OUTER EDGE OF DECKING

NOTE:  
NO SINGLE DECKING BOARD SHOULD CANTILEVER PAST THE SUPPORT FRAME MORE THAN 1/3 TOTAL LENGTH

WOOD DECKING @ LEAF BASE PLAN ENLARGEMENT

THIS SHEET IN ITS ENTIRETY WAS REVISED 07/11/2014

ELECTRICAL CONTROL ENCLOSURE, SEE SAGA, COORDINATE CONDUIT CHASES WITH ELECTRICAL

PITCH CONCRETE SLAB 2% FOR SURFACE DRAINAGE

BLACK LOCUST DECKING: FASTEN TO STEEL FRAME WITH CONCEALED DECKING FASTENERS

EDGE OF COLORED CAST-IN-PLACE CONCRETE WALL (BELOW)

30°

TANGENT LINE TO CURVED WALL

DECKING CORNER

8 2"

1/2" GAP BETWEEN WOOD DECK AND WALL

FULLY WELDED 3" STAINLESS STEEL SQUARE TUBE SLEEPER FRAME

OUTER RAIL S.S. SQUARE TUBE FRAMING SHALL BE SPACED 1" BEYOND FACE OF WALL & RECESSED 1" FROM OUTER EDGE OF DECKING

EDGE OF 12" CAST-IN-PLACE CONCRETE WALL (BELOW)

1"-6" TYP.

LEAF SCULPTURE BASE, 2/ST-8

1" S.S. SQUARE TUBE FRAME AROUND SCULPTURE BASE

SCULPTURE S.S. COLLAR (ABOVE)

COORDINATE WALL FOOTING POUR WITH LEAF FOUNDATION PIER

BLACK LOCUST DECKING: 3" OVERHANG FAST CONCRETE WALL BELOW

LEAF SCULPTURE BASE, 2/ST-8

1" S.S. SQUARE TUBE FRAME AROUND SCULPTURE BASE

SCULPTURE S.S. COLLAR (ABOVE)

EDGE OF 12" CAST-IN-PLACE CONCRETE WALL (BELOW)

OUTER RAIL S.S. SQUARE TUBE FRAMING SHALL BE SPACED 1" BEYOND FACE OF WALL & RECESSED 1" FROM OUTER EDGE OF DECKING

NOTE:  
NO SINGLE DECKING BOARD SHOULD CANTILEVER PAST THE SUPPORT FRAME MORE THAN 1/3 TOTAL LENGTH

1/2" CAST-IN-PLACE CONCRETE WALL WITH CANTILEVER SEATING

1/2" GAP BETWEEN WOOD DECK AND WALL

NOTE:  
1. NEOPRENE SPACERS SHALL SEPARATE METAL FRAME ASSEMBLY FROM DIRECT CONTACT WITH CONCRETE SURFACES  
2. UNEXPOSED CONCRETE SURFACES SHALL HAVE ORDINARY SURFACE FINISH UNLESS OTHERWISE SPECIFIED

S.S. SCULPTURE STRUCTURAL COLUMN  
S.S. SCULPTURE COVER CLADDING  
7" MAX GAP AROUND SCULPTURE BASE  
FRAME AROUND SCULPTURE BASE WITH 1" S.S. SQUARE TUBE MOUNTING RAILS; FASTEN TO CONCRETE WITH 2 1/4" S.S. MASONRY SCREWS  
CONCRETE SLAB WITH 6X6 #4X11.4 W/M INCIDENTAL TO WOOD DECKING @ LEAF BASE

SMOOTH TROWEL FINISH WHERE CONCRETE IS EXPOSED  
ADJACENT GRANITE PAVERS  
CONCRETE MASONRY WALL, COLORED  
COMPACTED CRUSHED AGGREGATE BASE GRADATION #3 INCIDENTAL TO WOOD DECKING @ LEAF BASE  
COORDINATE SITE WALL FOOTINGS WITH SCULPTURE FOOTING

WOOD DECKING SECTION @ LEAF BASE

WOOD DECKING SECTION @ LEAF BASE

PLOT BEARING: \_\_\_\_\_  
 REVISION NAME: \_\_\_\_\_  
 REVISION DATE: \_\_\_\_\_  
 CHECKED BY: \_\_\_\_\_  
 DATE: \_\_\_\_\_



**Process**

---

# Flow Diagram

---

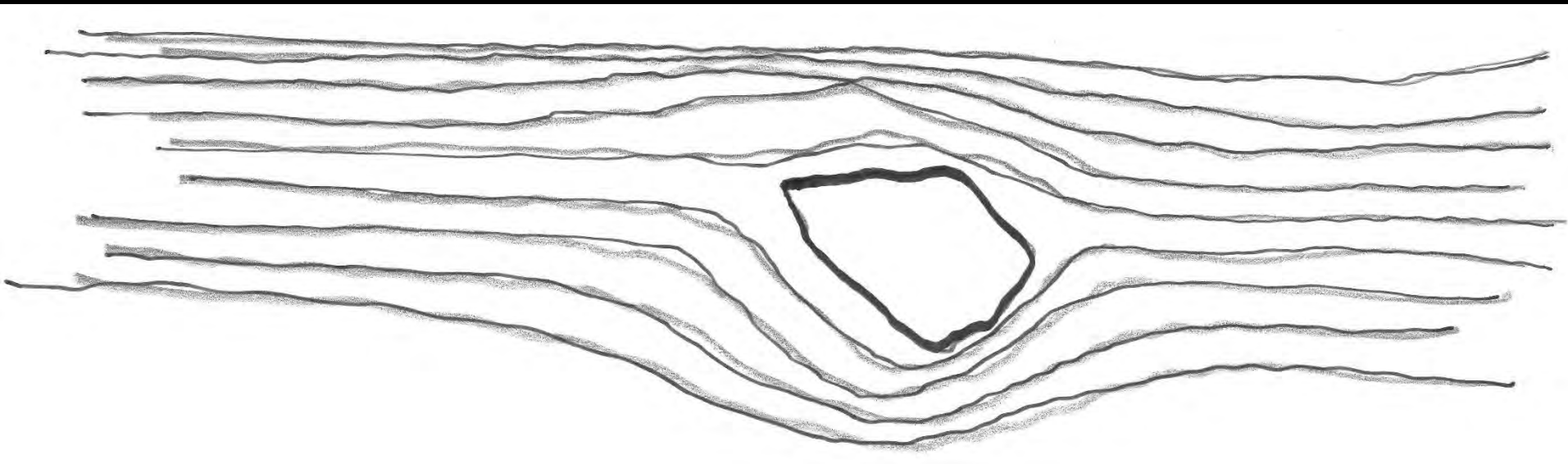



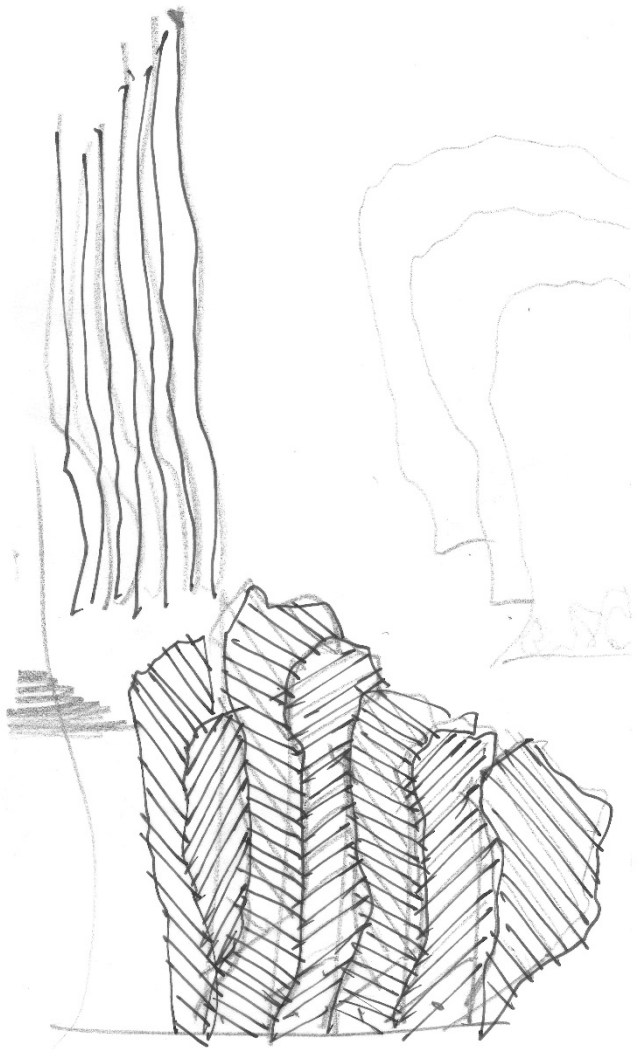



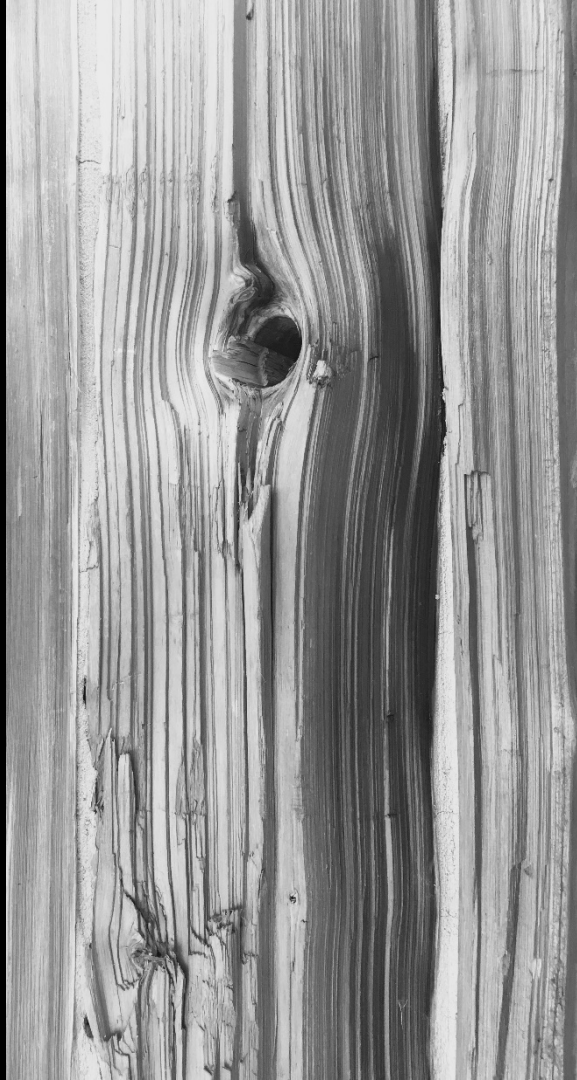

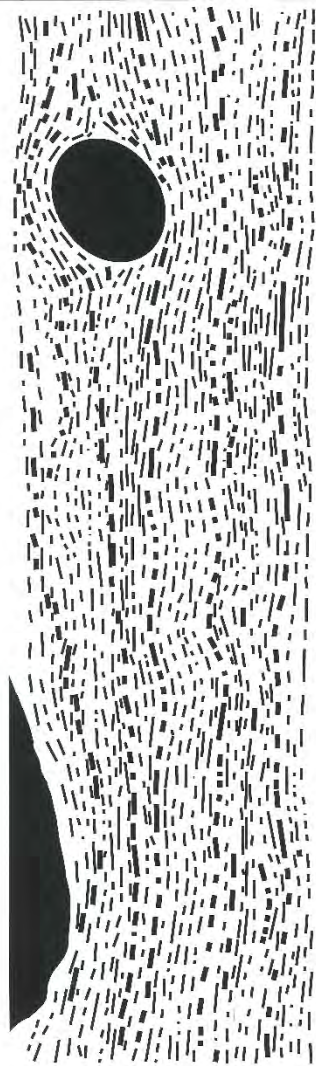
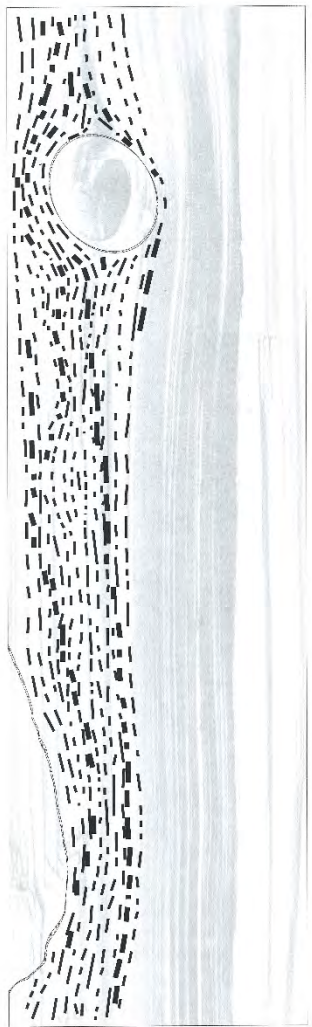



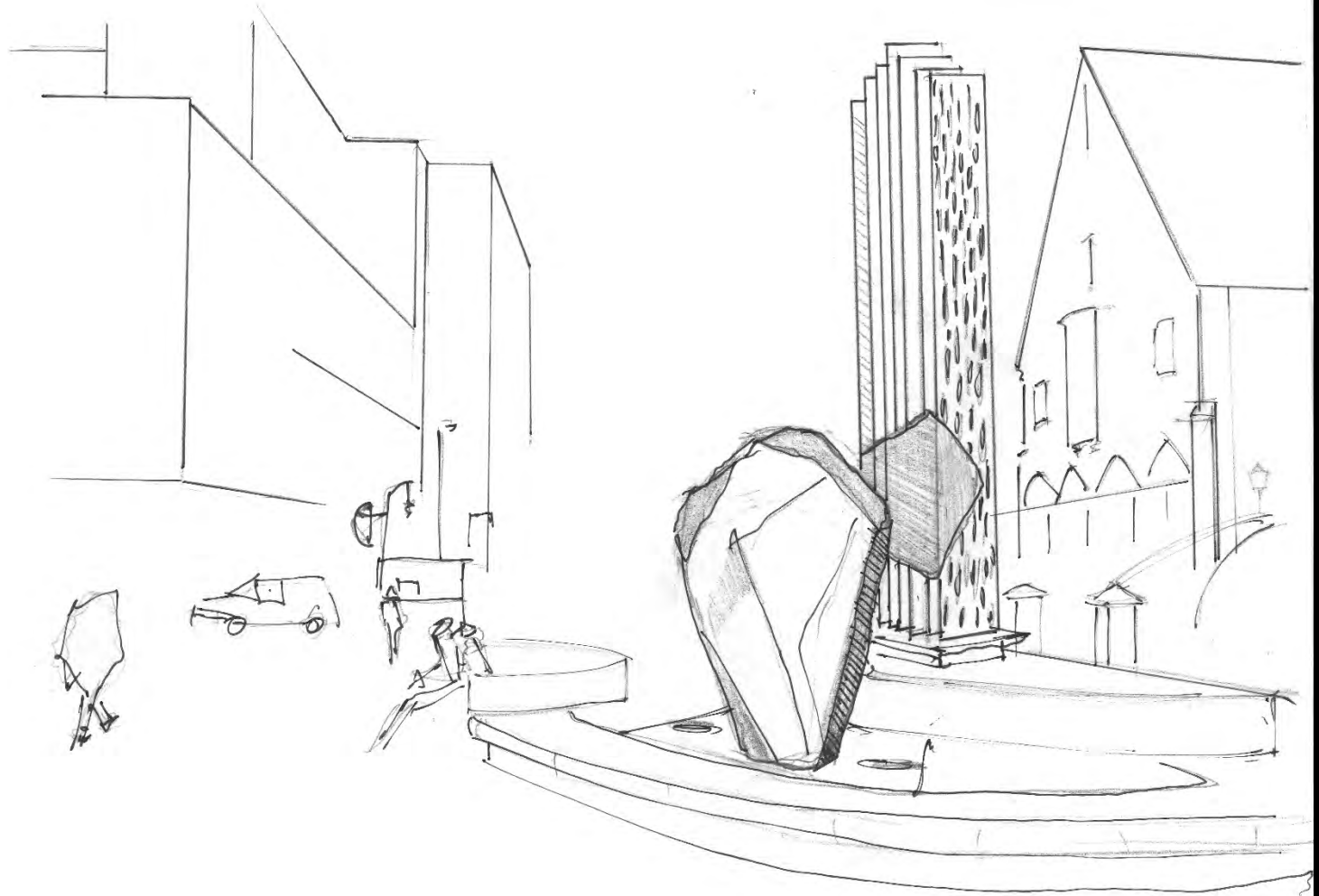



*The Odd Couple*

*Matt Mathews, 2012*

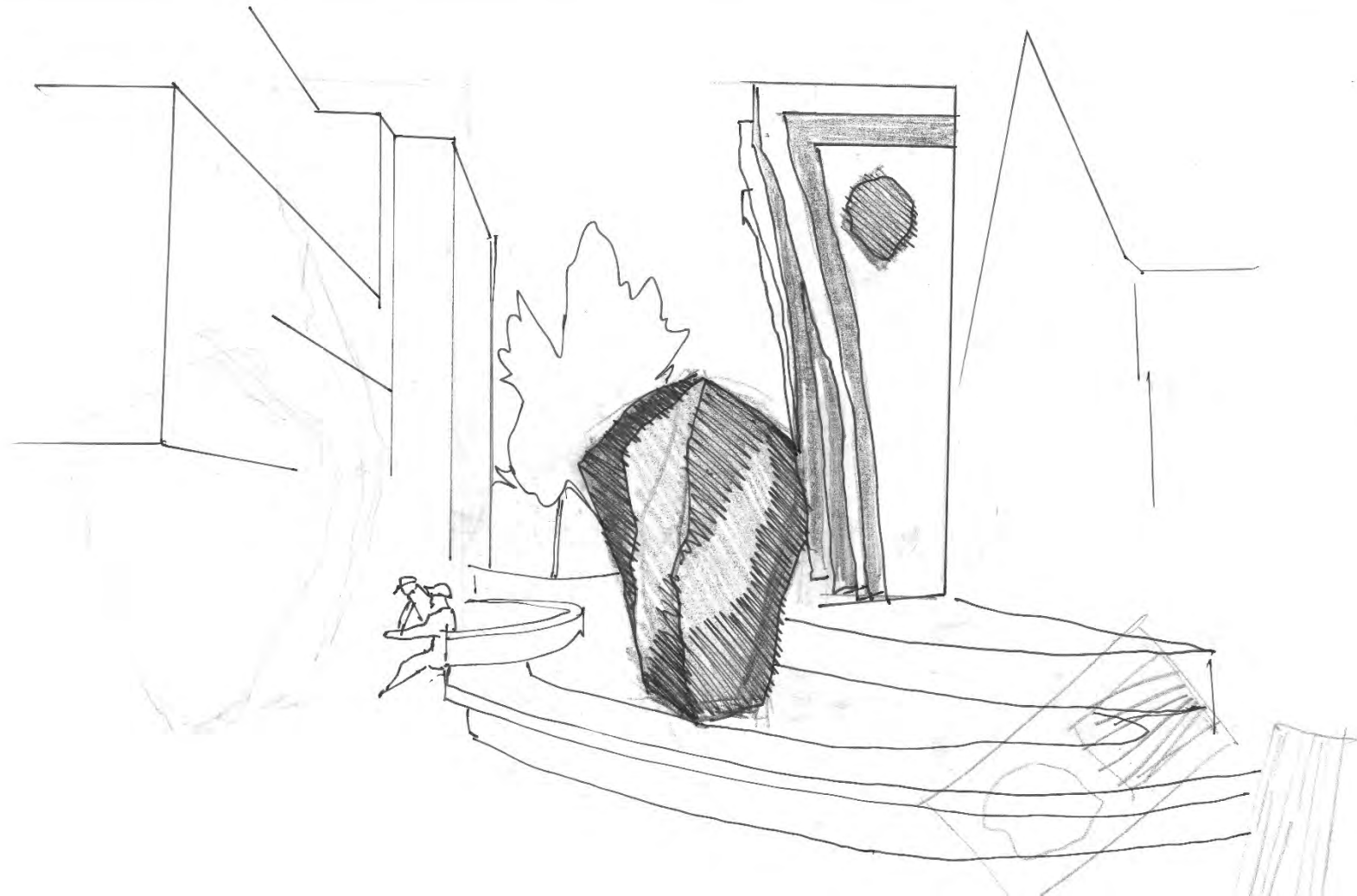

# Native Wisconsin Stone



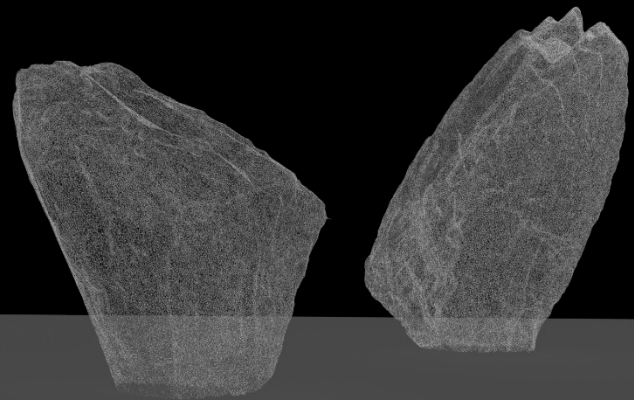
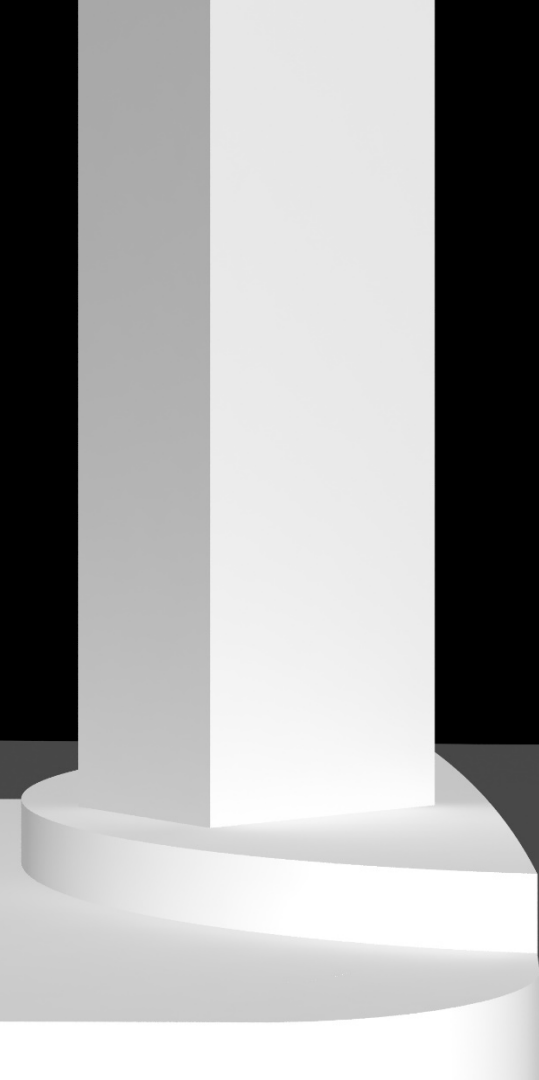
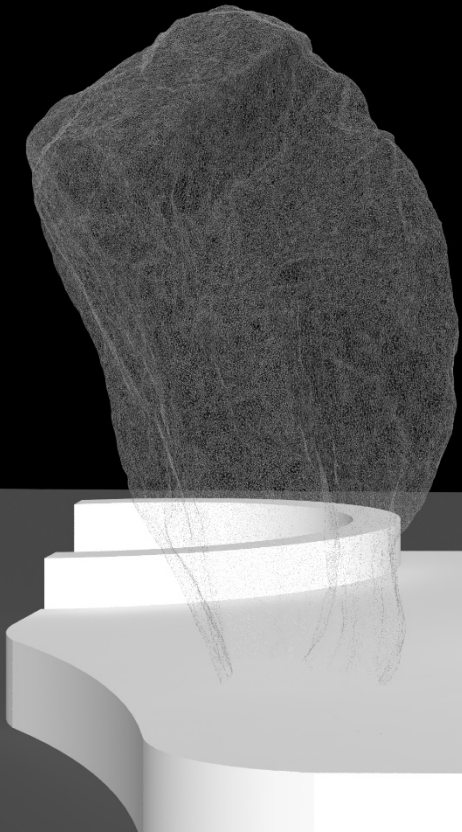



## Concept Illustrations

---











PINES HOUSE  
STUDENT HUNTERY  
BRING ALL OF WHO YOU ARE  
WOMEN TENDERS A STIP  
ALL ARE WELCOME  
WWW.PINESHOUSE.ORG











# Concept Plan overlay on existing

STATE STREET 700 / 800 BLOCKS PROJECT NO. 53W1183	SHEET NO. 818
STREETSCAPE & WALL DETAILS	
STATE STREET	CITY OF MADISON

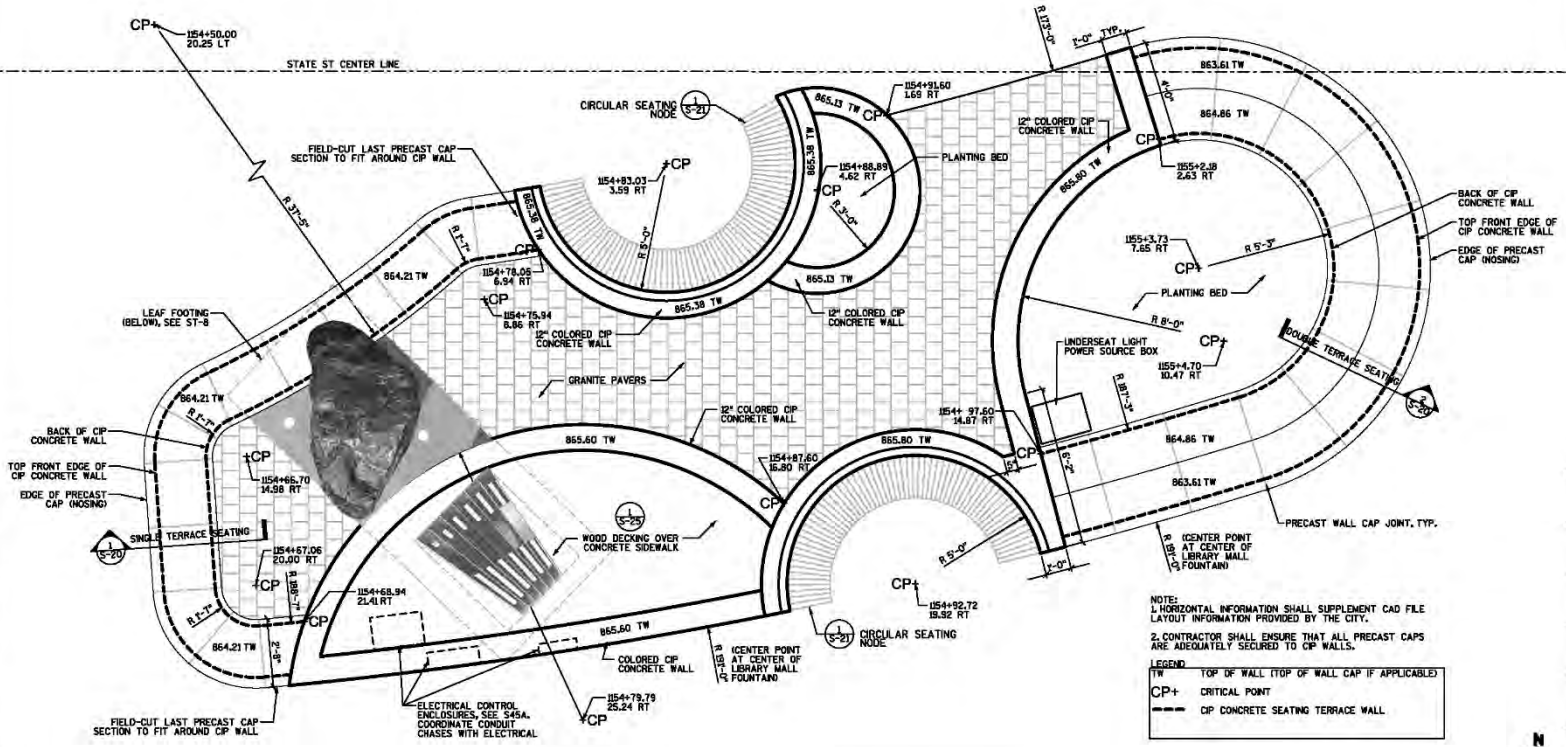

NOTES:  
 1. HORIZONTAL INFORMATION SHALL SUPPLEMENT CAD FILE LAYOUT INFORMATION PROVIDED BY THE CITY.  
 2. CONTRACTOR SHALL ENSURE THAT ALL PRECAST CAPS ARE ADEQUATELY SECURED TO CP WALLS.

LEGEND

TW	TOP OF WALL (TOP OF WALL CAP IF APPLICABLE)
CP+	CRITICAL POINT
---	CP CONCRETE SEATING TERRACE WALL

THIS SHEET IN ITS ENTIRETY WAS REVISED 07/11/2014

1 S-18 CONFLUENCE EAST ISLAND SITE PLAN ENLARGEMENT  
1/4"=1'-0"



ORIGINAL: CITY OF MADISON, STREETS&LANDSCAPE  
 REV. DATE: \_\_\_\_\_  
 PLOT NAME: \_\_\_\_\_  
 FILE NAME: 53...designfile\_53 DATE: 53...projectdate\_53

# Concept Plan

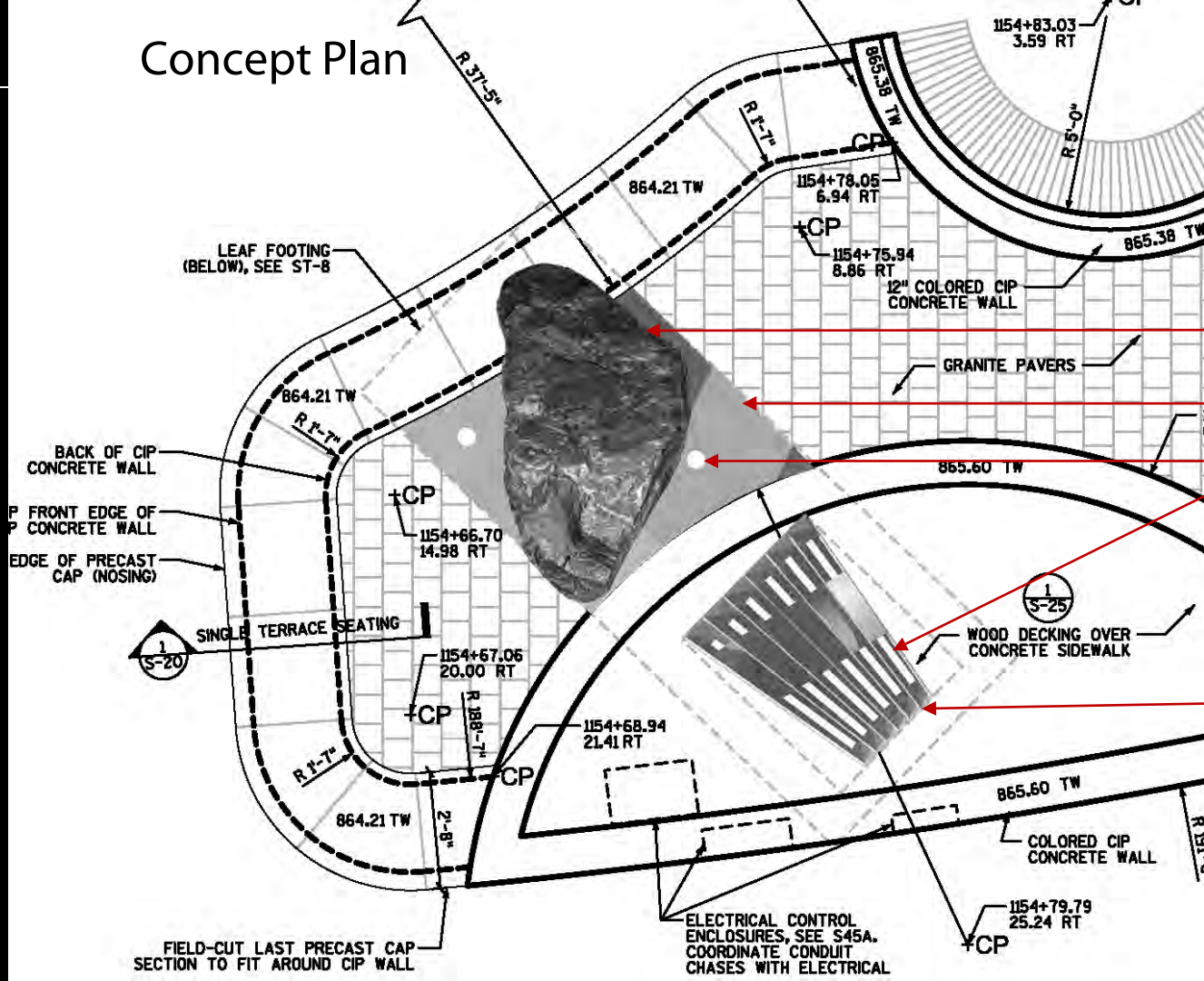

Stone (mounted)

Stainless steel base

LED lighting

Stainless steel  
Sculpture





# North East Elevation

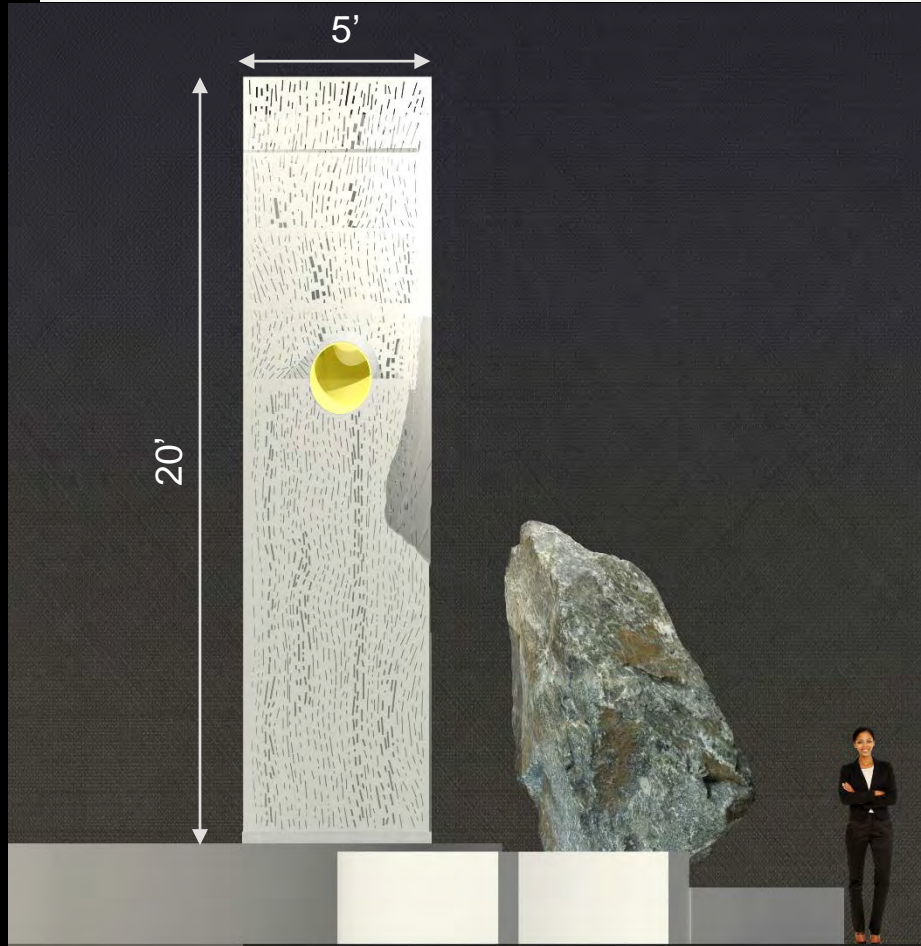

# North West Elevation

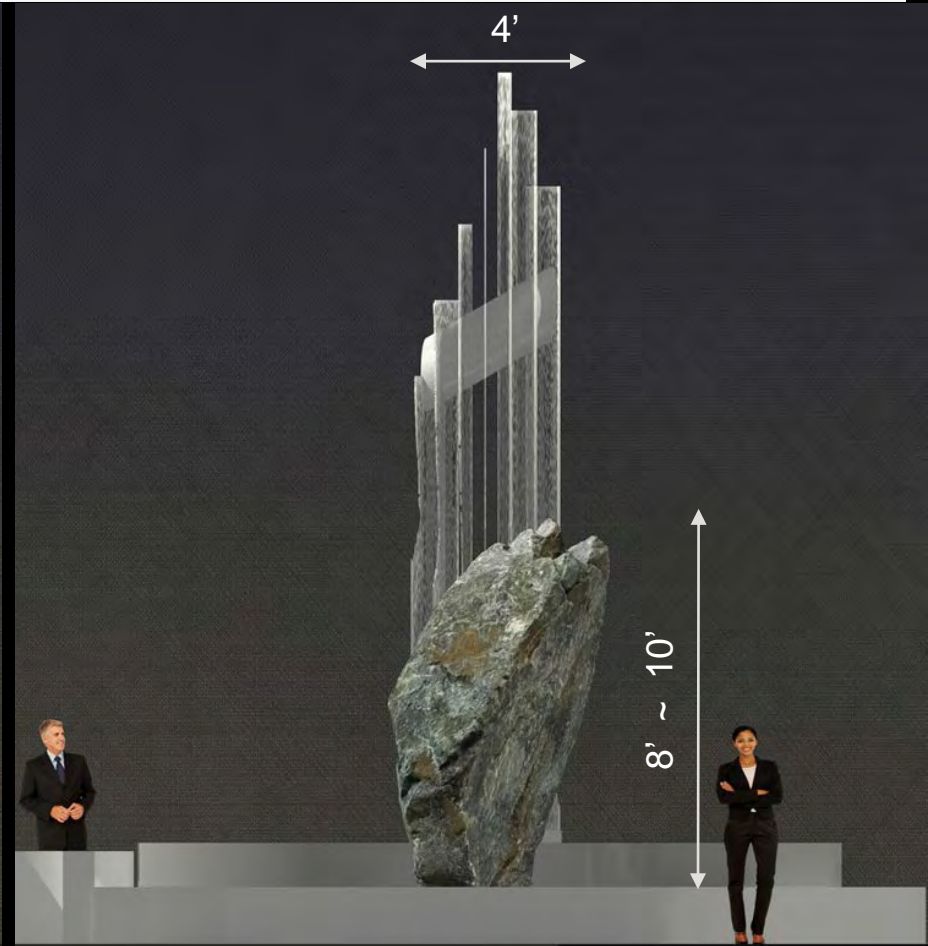

# South East Elevation

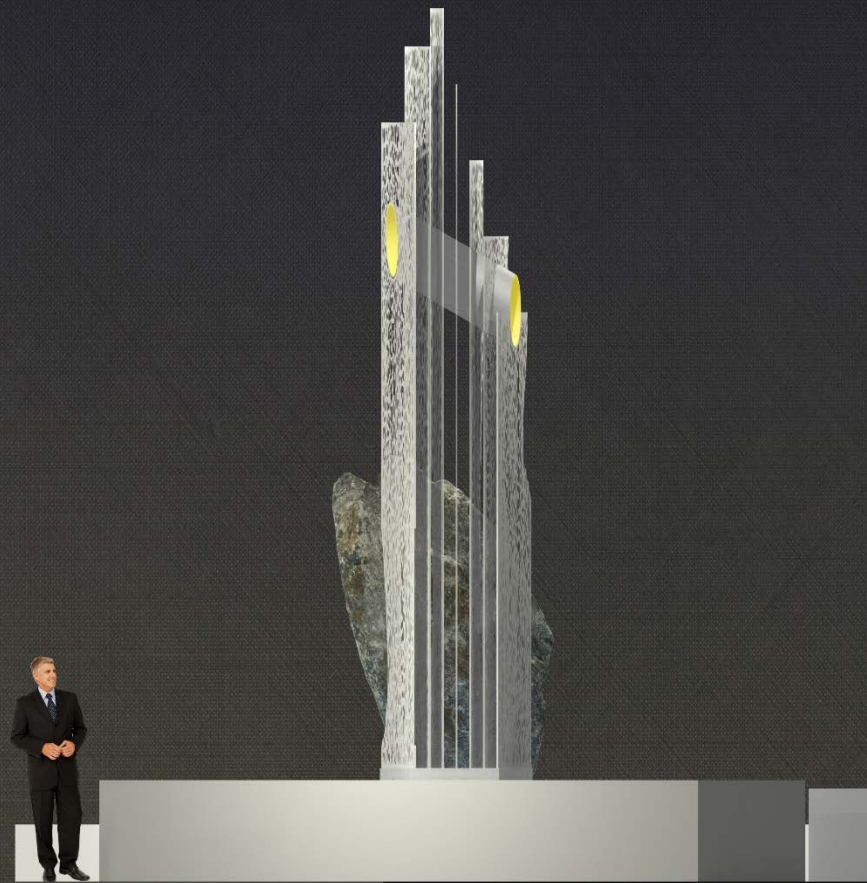

# South West Elevation



















**Create. Meaning. Together.**

