

STREET USE PERMIT APPLICATION

FOR OFFICE USE ONLY: Permit # _____ Date Submitted _____

EVENT INFORMATION

Name of Event 16th Annual WORT Block Party

Event Organizer/Sponsor WORT-FM

Is Organizer/Sponsor a 501(c)3 non-profit agency? Yes No

If Yes, provide State of Wisconsin Tax Exempt Number ES14039

Address 118 S. Bedford St.

City/State/Zip Madison, WI 53703

Primary Contact Raechel Pundsack

FAX 608-256-3704

Work Phone 608-256-2001

Phone During Event 608-772-6134

E-mail busdev@wort-fm.org

Website www.wortfm.org

Secondary Contact Norm Stockwell

Work Phone 608-256-2001

Phone During Event 608-279-1607

E-mail normstock@wortfm.org

Annual Event? Yes No

Charitable Event? Yes No

If Yes, name of charity to receive donations: WORT-FM

Estimated Attendance 500 (CERTIFICATE OF INSURANCE MAY BE REQUIRED)

Public Amplification (not allowed after 11 p.m.) Hours 11am to 7pm Yes No

EVENT CATEGORY

- Run/Walk
- Music/Concert
- Festival
- Rally
- Parking (i.e., bagging meters)
- Other _____

LOCATION REQUESTED

- Capitol Square (note specific blocks below)
 - Podium/700-800 State Street
 - 30 on the Square (a.k.a. top of 100 block of State Street)
 - Other (specific blocks/streets requested below)
- Street Names and Block Numbers: 600 Block West Doty St.

EVENT DATE(S)/SCHEDULE

Date(s) of Event (including set-up and take-down) _____ Rain Date(s) N/A

Event Start Date(s)/Time(s) 5/19/13 7AM (set up) Set-Up Date(s)/Time for Event N/A

Event End Date(s)/Time(s) 5/19/13 8pm (tear down) Take-Down Time N/A

Take-Down Time: start to streets reopened

APPLICATION SIGNATURE

_____ I/We waive the 21-day decision requirement. _____ (PLEASE INITIAL)

Your signature below indicates that you have read and understand the instructions and guidelines for a community event. Further, the person/group named in this application will be responsible for the conduct of the group and for the condition of the reserved area. Falsification of information on the application will result in forfeiture of up to \$200 per falsified item.

In addition to the rules and regulations detailed in the permit application instructions and guidelines, Street Use Permits are subject to all applicable ordinances, statutes and laws.

Signature [Handwritten Signature] Date 3/18/13

EVENT SCHEDULE
15th ANNUAL WORT BLOCK PARTY

7:00am to 11:00am

SET UP

- Stage/sound equipment
- vendor load-in

11:00am to 7:00pm

LIVE MUSIC

- one stage
- between five and seven performance groups - TBA

VENDORS OPEN

KIDS' ACTIVITIES

BEER SALES

8:00pm

Re-open 600 Block of Doty Street

7:00pm to 9:00pm (or later)

TEAR DOWN/CLEAN UP

Nature Conservancy
Parking Lot

Band
Parking/
Load-in
Area

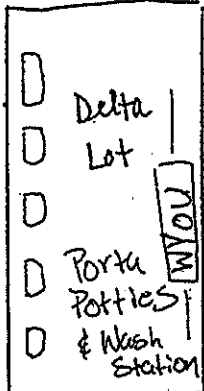
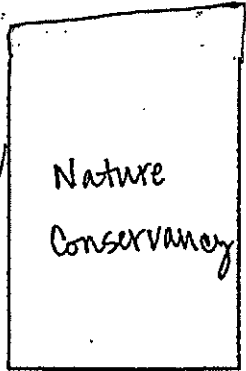

Garage
Driveway

4th Ward Lofts

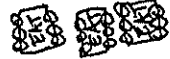
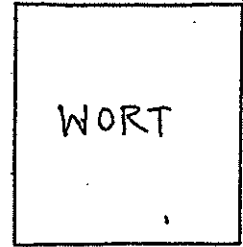

craft vendors

WORT BOUTIQUE

STAGE



(FIRE LANE)



craft vendors

KIDS
AREA



Findorff
Lawn

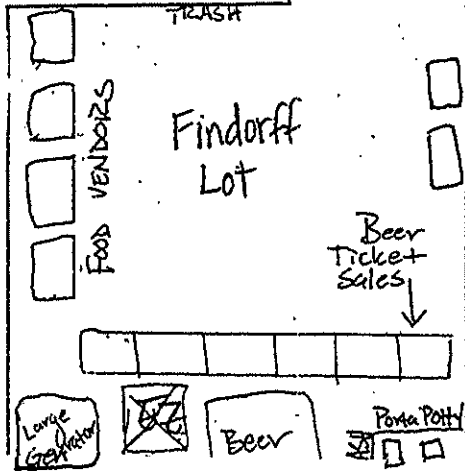

Findorff
Lot

Beer
Ticket
Sales

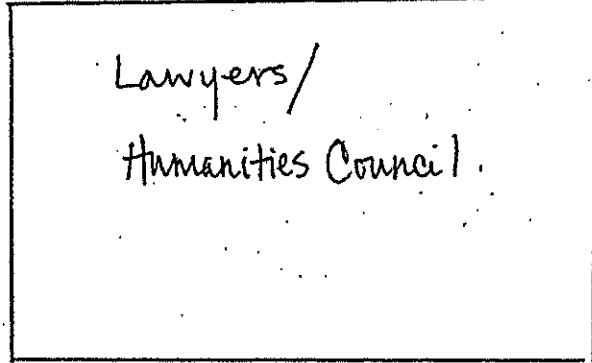

Lawyers/
Humanities Council

Tour
de Timor
WORT
DONATION
STATION

Raffle

S. Bedford St.

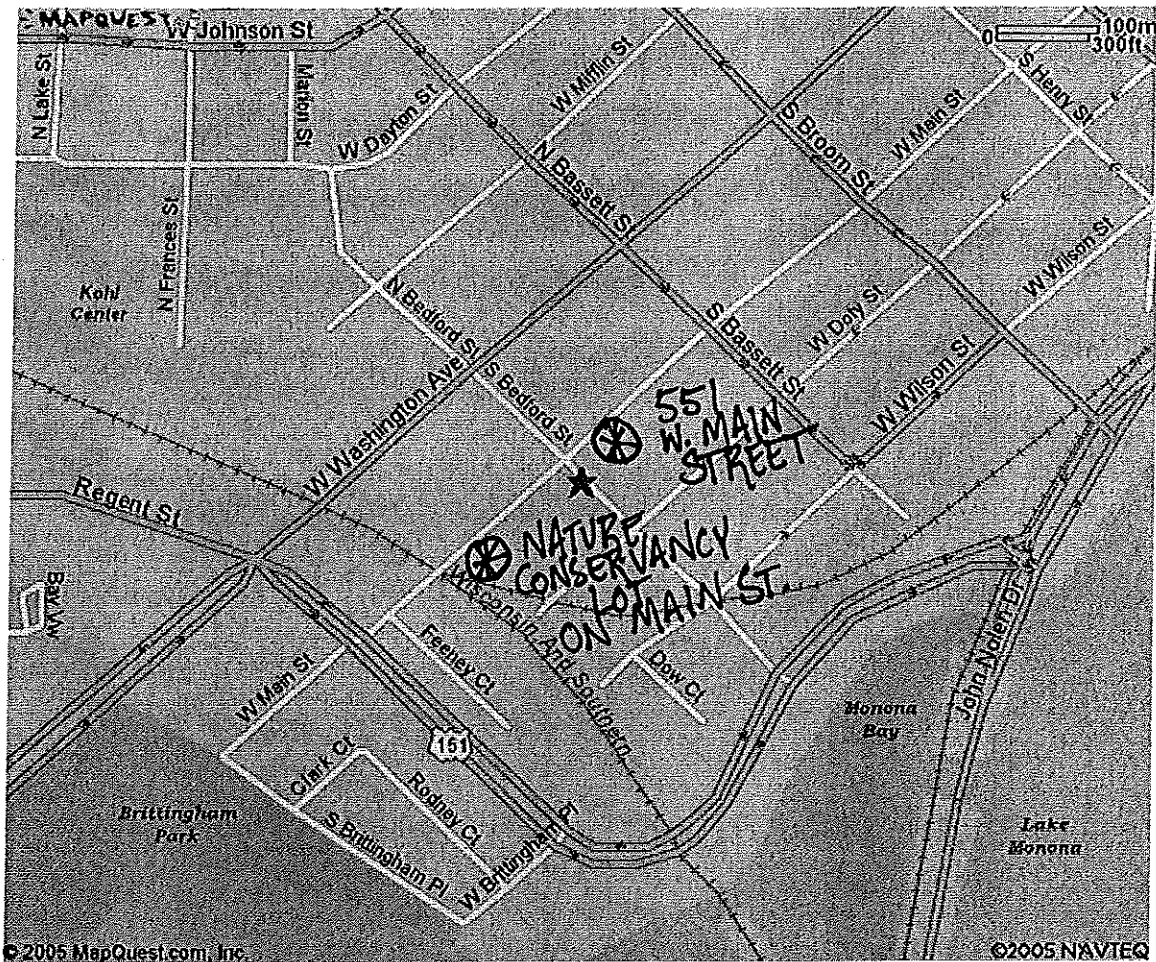

- The 600 block of West Doty St. will be closed to all incoming and outgoing traffic on Sunday, May 20th between the hours of 7 AM and 8 PM. If you will be using your vehicle during those hours we ask you to please utilize the alternate parking areas that we have arranged for residents of 4th Ward Lofts.
- Parking will be available in the Nature Conservancy lot, next to the Main St. Depot and in the Delta Properties lot at 551 W. Main St. after 6 PM on Saturday, May 19th. Please make arrangements to move your vehicle to one of these locations prior to 7 AM on Sunday, May 20th, as street access will be limited to emergency vehicles only.
- Thank you for your cooperation – we look forward to seeing you at the WORT Block Party!

Recycling Plan:

We will have recycling bins throughout the event site.

Safety Plan:

“Lost Child” area shall be the WORT information area/boutique, where WORT staff members and volunteers will be stationed at all times.

WORT Staff members, as well as stage Managers and other volunteers will have cell phones, and alert emergency professionals (911) if there is anyone requiring medical attention.

Security Plan:

2 private, professional security officers shall be on duty during public attendance hours (11am-7pm).

Valuables: cash will frequently be pulled from cashboxes at beer and raffle stations. We will take it to a locked area inside WORT studios.