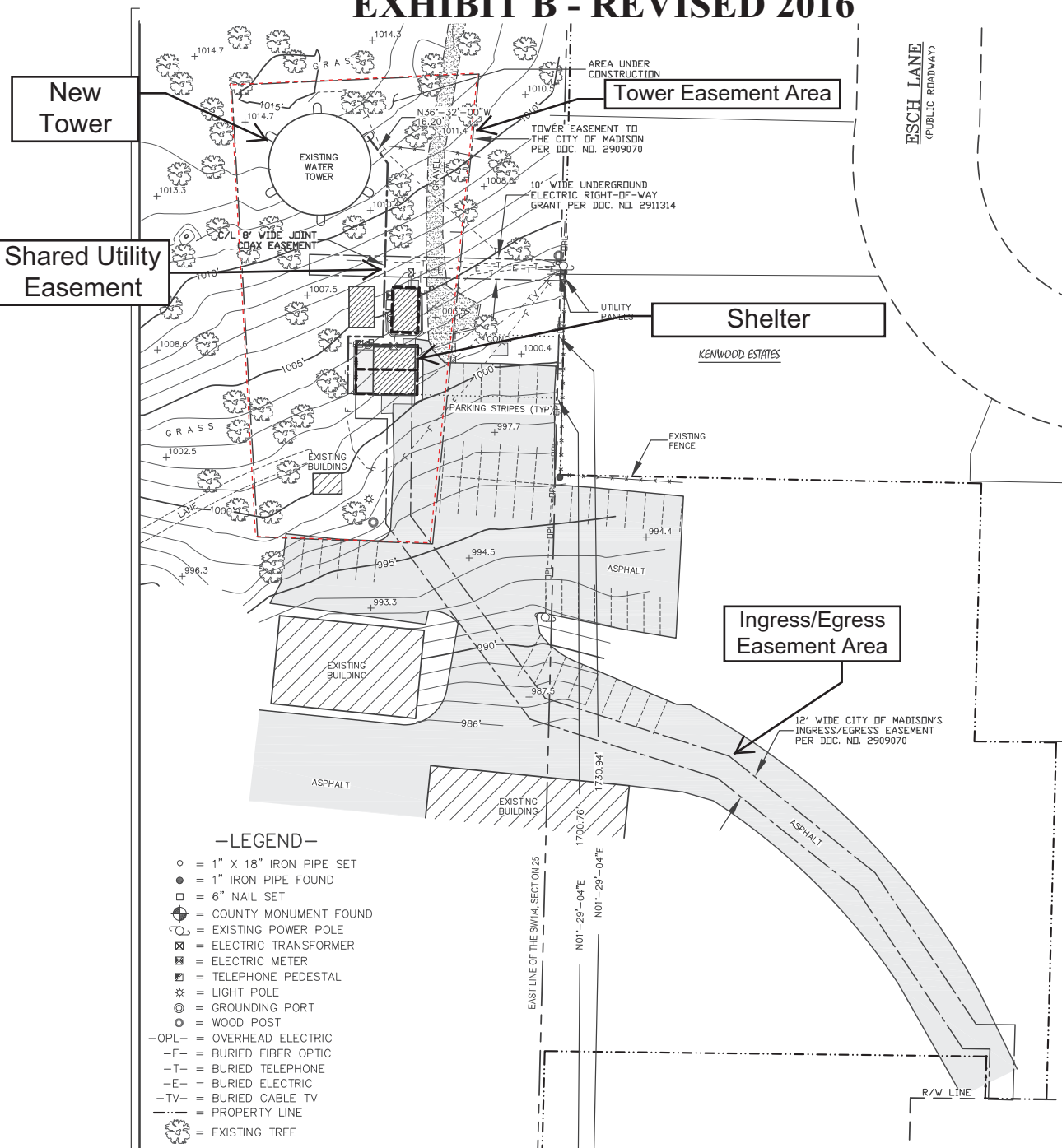

EXHIBIT B - REVISED 2016



BEARINGS REFERENCED TO THE DANE COUNTY COORDINATE SYSTEM AND THE EAST LINE OF THE SW1/4 SECTION 25, T8N, R9E, WHICH BEARS N01°29'04"E

- LEGEND-**
- = 1" X 18" IRON PIPE SET
 - = 1" IRON PIPE FOUND
 - = 6" NAIL SET
 - ⊙ = COUNTY MONUMENT FOUND
 - ⊕ = EXISTING POWER POLE
 - ⊞ = ELECTRIC TRANSFORMER
 - ⊚ = ELECTRIC METER
 - ⊛ = TELEPHONE PEDESTAL
 - ⊜ = LIGHT POLE
 - ⊝ = GROUNDING PORT
 - ⊞ = WOOD POST
 - OPL- = OVERHEAD ELECTRIC
 - F- = BURIED FIBER OPTIC
 - T- = BURIED TELEPHONE
 - E- = BURIED ELECTRIC
 - TV- = BURIED CABLE TV
 - - - = PROPERTY LINE
 - 🌳 = EXISTING TREE

SURVEYOR'S CERTIFICATE
 I, Craig A. Keach, Professional Land Surveyor of Meridian Surveying, LLC, certify that I have surveyed the described property and that the map shown is a true and accurate representation thereof to the best of my knowledge and belief.

Dated this _____ day of _____, 2016.

WISCONSIN PROFESSIONAL LAND SURVEYOR
 Craig A. Keach, S-2333

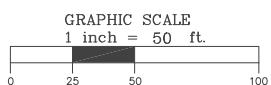

NO.	DATE	DESCRIPTION	J.B. BY
1	3/9/16	Preliminary Survey	J.B.

CHECKED BY: C.A.K. FIELD BOOK: N/A
 JOB NO.: 8792 SHEET 2 OF 4

LEASE EXHIBIT
 FOR
TERRA CONSULTING GROUP LTD.
 LOT 1 OF C.S.M. NO. 12189; BEING A PART OF THE S1/2 SECTION 25, T8N, R9E, CITY OF MADISON, DANE COUNTY, WISCONSIN

PARCEL NO.: 251/0809-253-0099-1
 DEED: X

PROPERTY OWNER: TOWER OWNER: DANF COUNTY HUMAN SERVICE LAKEVIEW OFFICE 210 MARTIN LUTHER KING JR. BLVD. MADISON, WI 53703

SITE NAME: MADISON LAKEVIEW WT
 SITE NUMBER: N/A
 SITE ADDRESS: 1202 NORTHPORT DR. MADISON, WI 53704

MERIDIAN SURVEYING, LLC
 18274 Fielene 1
 Menasha, WI 54952
 Office: 920-993-0881
 Fax: 920-273-6037



TERRA CONSULTING GROUP LTD.
 600 Busse Highway
 Park Ridge, IL 60068
 Office: (847) 698-6400
 Fax: (878) 444-4772