



Change of Premises

LICPCH-2017-00648
(Number)

(scanned)

47850

(Leg file number)

City of Madison Clerk
210 MLK Jr Blvd, Room 103
Madison, WI 53703

licensing@cityofmadison.com
608-266-4601

(Processing step)

(initials)

This application modifies existing alcohol license number: LICLIB-2013-00282

- Class A Beer
- Class B Beer
- Class A Liquor
- Class B Liquor
- Class C Wine

Aldermanic District: 19 Alder Name: Mark Clear Police Sector: West

Corporate Information

Licensed Premise Information

Business Legal Name: Apple Hospitality Group, LLC

Business dba Name: Applebee's

Business Address: 2120 Pewaukee Rd, #200
~~Waukesha, WI 53188~~

Licensed Address: 660 S. Whitney Way
~~Madison, WI 53711~~

Corporate Contact Name & Position: _____
Marjorie Wachs, Legal Assistant

Business Contact Name & Position: _____
Edward Volkema, GM

414-259-8466

608-271-5450

marjorie.wachs@whgroup.com

App150@whgroup.com

Phone & Email: _____

Phone & Email: _____

Liquor Beer Agent Name: Edward Volkema % Alcohol: 15 % Food: 85
177 500-750

Current Capacity (indoor): 177 (no change) Current Capacity (outdoor): 500-750

Proposed Capacity (indoor): _____ Proposed Capacity (outdoor): _____

Description of Proposed Changes: The existing Premises shall be expanded to include the parking lot areas of the Applebee's property (the "Expansion Area") as both are shown on Exhibit A attached hereto. Use of the Expansion Area would be limited to special events for which all other necessary permits have been obtained.

Detailed Floor Plans included (required)

Orange sign and "License Renewals & Changes" brochure issued
Apple Hospitality Group, LLC

X _____ Date: 5/18/17
Applicant signature By: Mark Dillon, President & CEO

APPLEBEE'S STORE No. 150, 660 South Whitney Way
Madison, WI

Premises description.

LEGAL DESCRIPTION

PARCEL I:

Lot Four (4) and the South 15.77 feet of Lot Five (5) of Tokay Place, in the City of Madison, Dane County, Wisconsin, together with the non-exclusive easements for ingress and egress granted in the Reciprocal Access Agreement recorded in Volume 19258 of Records, Page 57, as Document No. 2365505 and in the Reciprocal Easement Agreement recorded in Volume 19265 of Records, Page 1, as Document No. 2365730.

Tax Parcel No. 60-0709-303-0524-2

BUILDING DESCRIPTION

Building:

(Sales) Single story freestanding 5,259 square foot Masonry Building, with alcohol served and consumed in dining room and bar area. There are no carry out sales.

(Storage) Alcohol stored in locked liquor cabinets located behind the bar and storage closet off the dining area away from public, and locked office

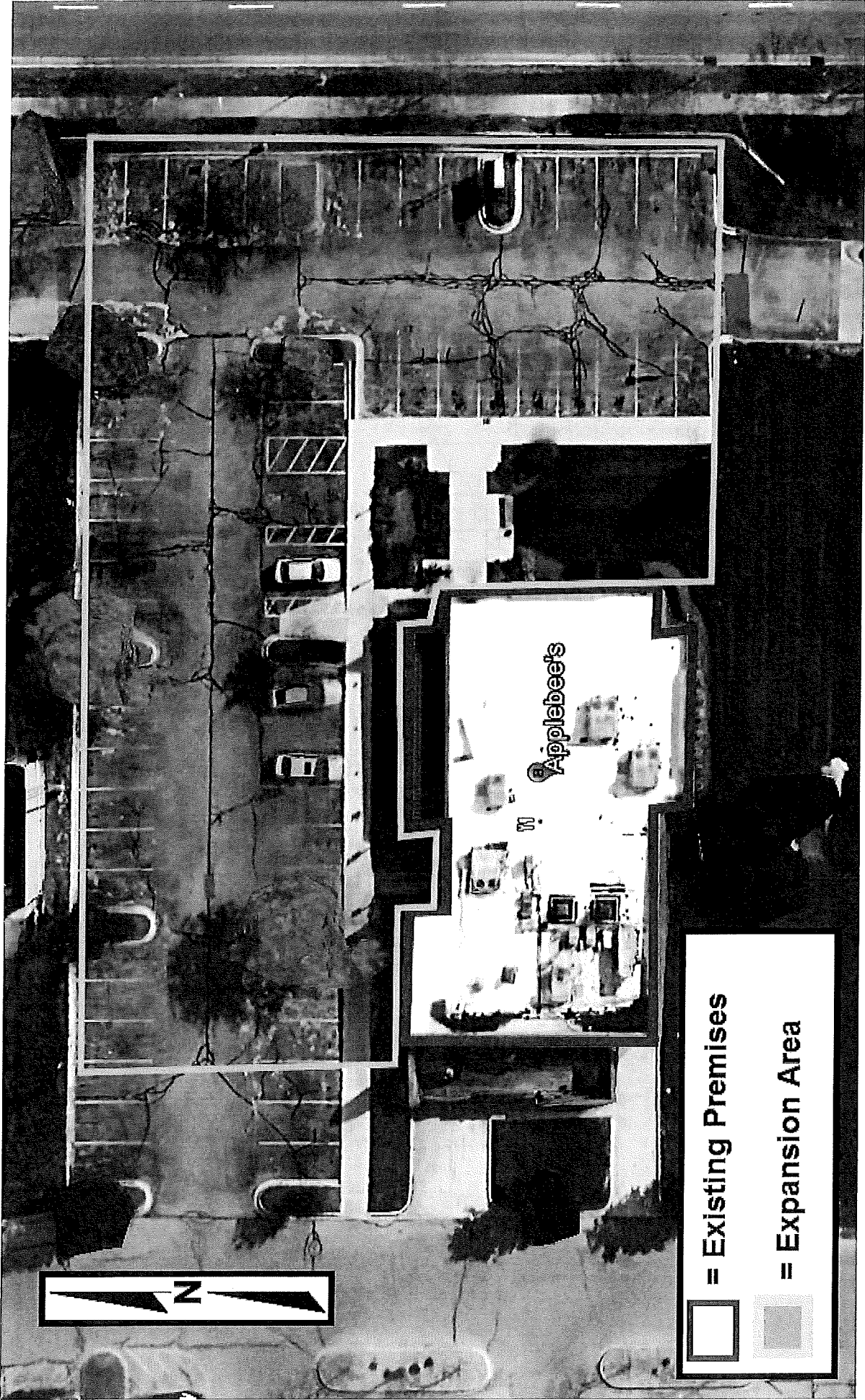

□ = Existing Premises

■ = Expansion Area



2120 Pewaukee Road, Suite 200
Waukesha, WI 53188
Telephone / Fax: 414.259.8466
E-mail: Marjorie.wachs@whgroup.com

May 26, 2017

City of Madison Clerk
210 MLK Jr Boulevard
Room 103
Madison, WI 53703

RE: Change of Premises
Applebee's #150, 660 South Whitney Way

Dear City Clerk:

Enclosed, for your consideration, is the Change of Premises form, description of premises and an aerial view of the description of the proposed premise changes in which to serve alcohol.

Please contact me if you have any questions. Thank you.

Very truly yours,

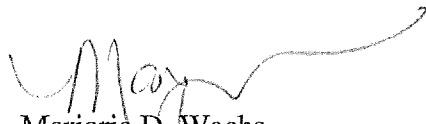

Marjorie D. Wachs
Assistant to Timothy J. Randall, Chief Legal Counsel

Enclosures

cc: Rick Johnson via email only