

MARK	REVISION	DATE	BY
###	###	###	###
###	###	###	###
###	###	###	###
###	###	###	###

14774  
 MADISON, WI  
 CONTRACT NO: 9231

BPW EXHIBIT  
 4649 VERONA ROAD  
 M:\DESIGN\Projects\14774\CAD\Streets\14774EN-StreetLinework.dwg



# DEVELOPER REIMBURSED

## SEWER DISTRICT AND EROSION CONTROL PLAN

### GENERAL EROSION CONTROL FOR SANITARY SEWER CONSTRUCTION

1. Erosion control measures shall be constructed prior to any other construction activity.
2. The Developer is responsible for the construction and maintenance of all erosion control measures until final acceptance by the City of Madison.
3. The Developer shall install and maintain erosion control measures in accordance with the "Wisconsin Construction Site Best Management Handbook" and Chapter 37 of the Madison General Ordinances.
4. The Developer shall provide street cleaning as needed on a daily basis to keep tracking to a minimum.
5. Erosion control for sanitary sewer construction shall be modified as needed to function in coordination with the approved plat erosion plan.

### LEGEND

NOTE: All pipes are 8" diameter unless otherwise noted



Construction entrance/tracking pad 40 ft long, 6in deep, width as needed (crushed stone or breaker run)

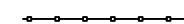

Silt Fence

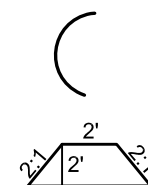

3 in clear stone velocity check dam

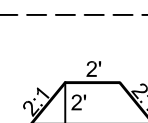

Earth berm/diversion

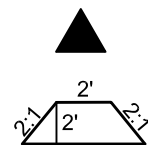

3 in clear stone weeper



TOTAL UNITS: 70  
 ONE BEDROOM: 16  
 TWO BEDROOM: 32  
 TWO BEDROOM + DEN: 4  
 THREE BEDROOM: 18

ULTIMATE AREA = 4.09 ACRES  
 IMMEDIATE AREA = 2.63 ACRES  
 DENSITY = 58.4 PEOPLE/ACRE  
 PEAKING FACTOR = 4  
 PEAK FLOW = 0.147 CFS  
 8" @ 0.8% = 1.09 CFS

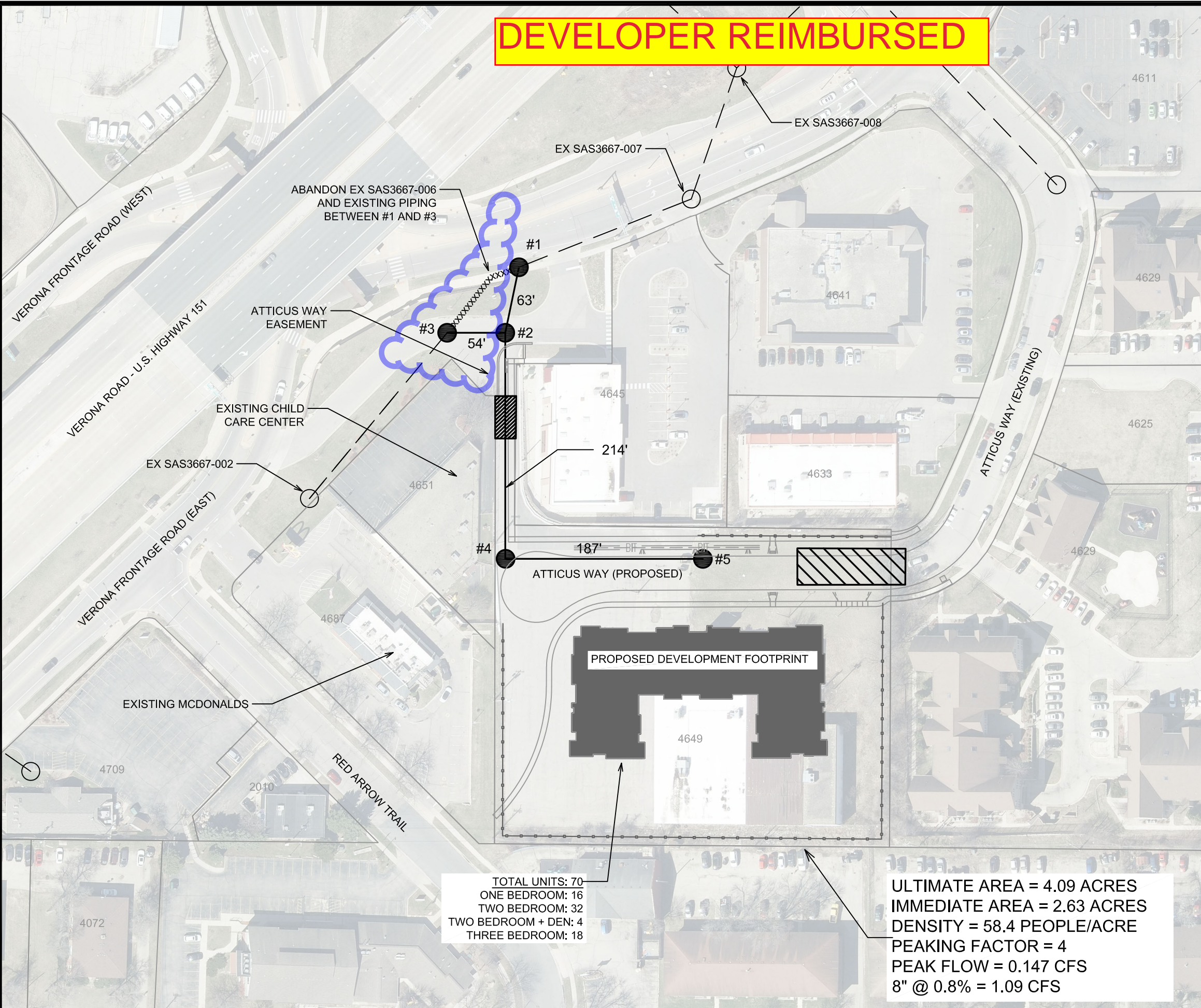

14774	MADISON, WI	9231	EC-1
EROSION CONTROL PLAN & SERVICE AREA			
4649 VERONA ROAD			
M:\DESIGN\Projects\14774\Project Documents\Permits\Sewers\Sanitary Extension\Plans\14774_EC&SA.dwg CONTRACT NO.:			
14774		EC-1	



# DEVELOPER PAYS

## SEWER DISTRICT AND EROSION CONTROL PLAN

### GENERAL EROSION CONTROL FOR SANITARY SEWER CONSTRUCTION

1. Erosion control measures shall be constructed prior to any other construction activity.
2. The Developer is responsible for the construction and maintenance of all erosion control measures until final acceptance by the City of Madison.
3. The Developer shall install and maintain erosion control measures in accordance with the "Wisconsin Construction Site Best Management Handbook" and Chapter 37 of the Madison General Ordinances.
4. The Developer shall provide street cleaning as needed on a daily basis to keep tracking to a minimum.
5. Erosion control for sanitary sewer construction shall be modified as needed to function in coordination with the approved plat erosion plan.

### LEGEND

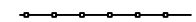
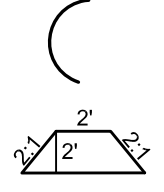
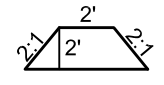
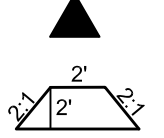
- NOTE: All pipes are 8" diameter unless otherwise noted
-  Construction entrance/tracking pad 40 ft long, 6in deep, width as needed (crushed stone or breaker run)
  -  Silt Fence
  -  3 in clear stone velocity check dam
  -  Earth berm/diversion
  -  3 in clear stone weaver

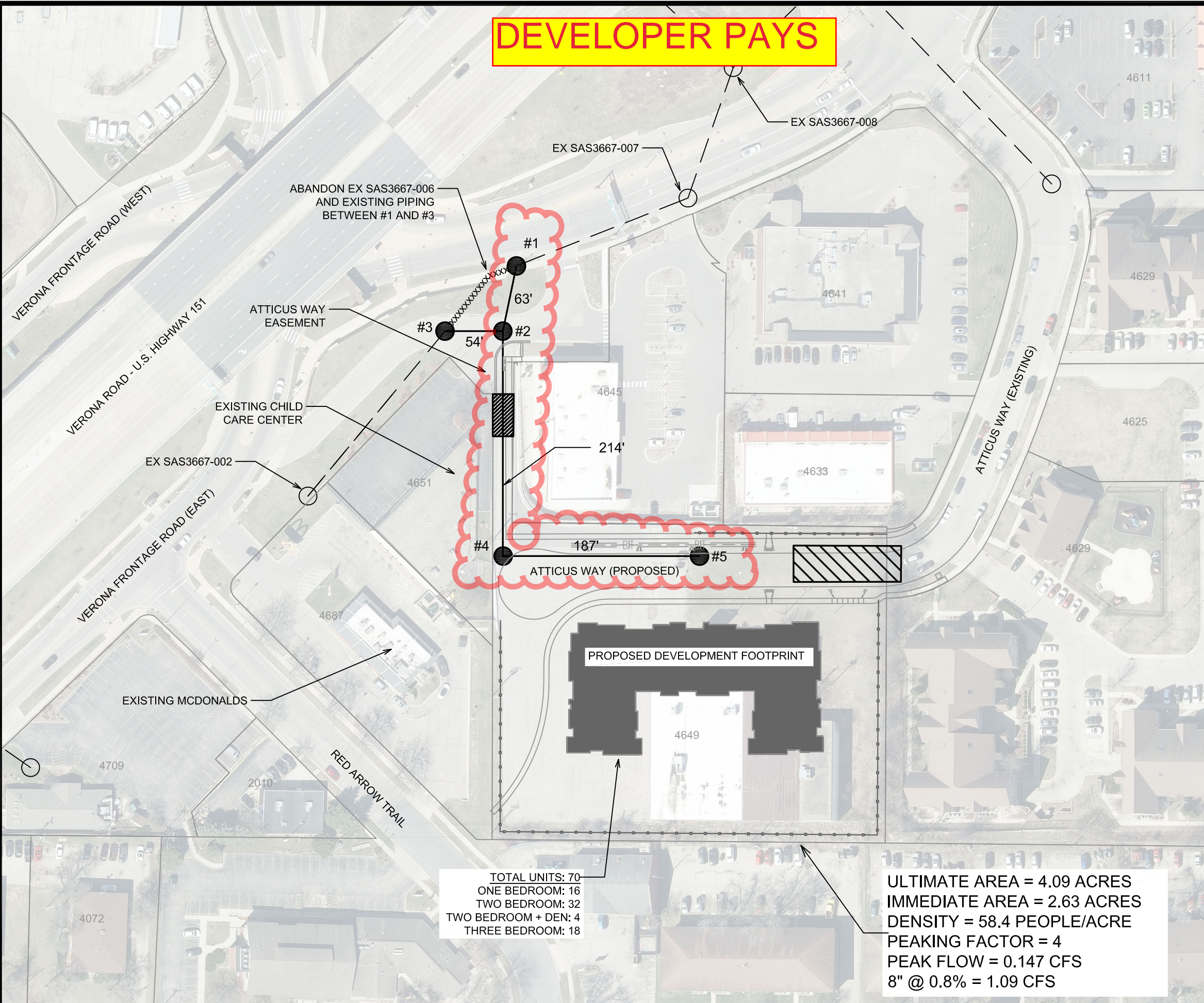

TOTAL UNITS: 70  
 ONE BEDROOM: 16  
 TWO BEDROOM: 32  
 TWO BEDROOM + DEN: 4  
 THREE BEDROOM: 18

ULTIMATE AREA = 4.09 ACRES  
 IMMEDIATE AREA = 2.63 ACRES  
 DENSITY = 58.4 PEOPLE/ACRE  
 PEAKING FACTOR = 4  
 PEAK FLOW = 0.147 CFS  
 8" @ 0.8% = 1.09 CFS

REVISION	DATE	BY	Scale: NTS 14774	EC-1
MARK	DATE	BY		
Designed By: EAC Date: 4/24/2023 2:53 PM				14774
EROSION CONTROL PLAN & SERVICE AREA		14774		
4649 VERONA ROAD		MADISON, WI		
M:\DESIGN\Projects\14774\Project Documents\Permits\Sewers\Sanitary Extension\Plans\14774_EC&SA.dwg CONTRACT NO: 9231				
		14774		
		EC-1		