

TOWN OF VERONA PARCELS SUBJECT TO INTERGOVERNMENTAL AGREEMENT

DEPARTMENT OF PUBLIC WORKS
CITY ENGINEERING DIVISION
MADISON, WISCONSIN

AFFECTED TOWN OF VERONA PARCELS PER THE TERMS OF A BOUNDARY ADJUSTMENT AGREEMENT WITH THE CITY OF MADISON

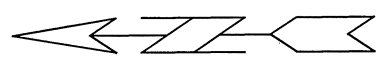
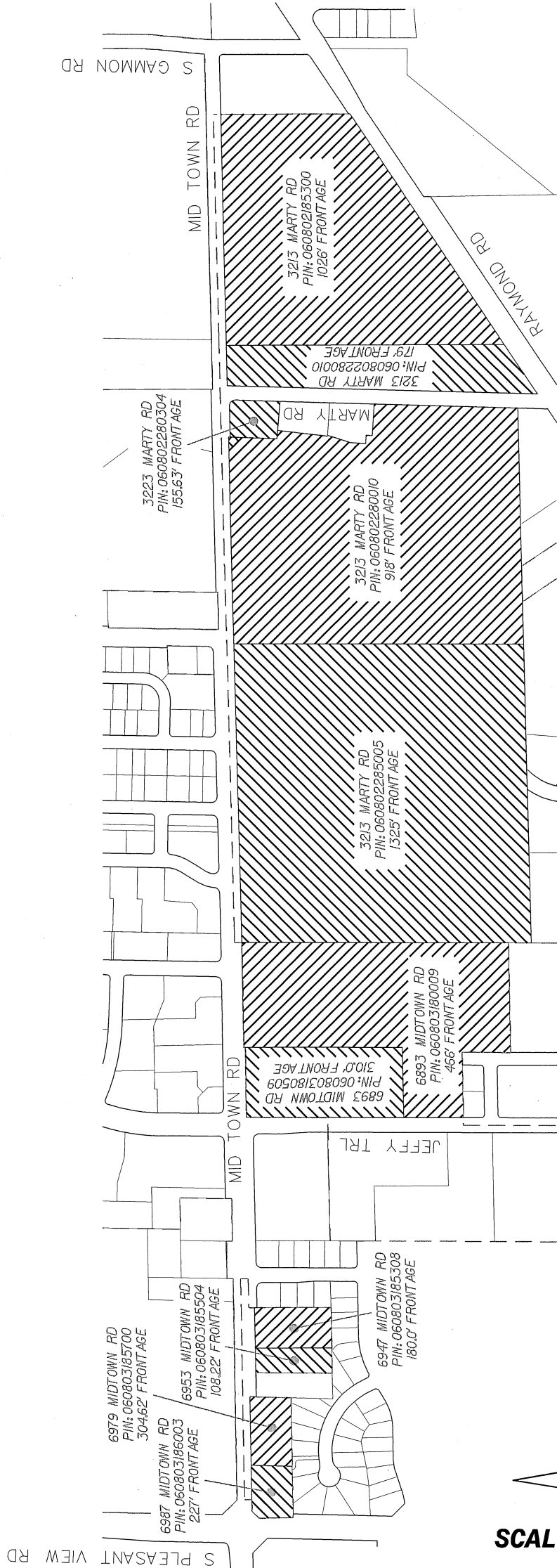

SCALE: 1"=600 FEET

FILENAME:
M:\Mapping\Annexations\ 53W1275\
Bound_Adj-Agmt_MidTownRd.dgn
DATE: 05/20/2011
ENGR. PROJ. NO. 53W1275