

NOTE: RAILING SHALL BE INSTALLED AT THE WEST EDGE OF THE SIDEWALK, FROM STA. 7+15 TO 8+25. SEE SHEET R-1 FOR RAILING DETAILS.

NOTE: FOR PUBLIC UTILITY CONNECTIONS, REFER TO UTILITY-ONLY PLANS (ISSUED 7/26/12).

**CONSTRUCT SIDEWALK FROM STATION 6+00 TO 8+39 - THIS SEGMENT WAS NOT COMPLETED DURING PREVIOUS PRIVATE DEVELOPMENT PROJECT AT THIS LOCATION**

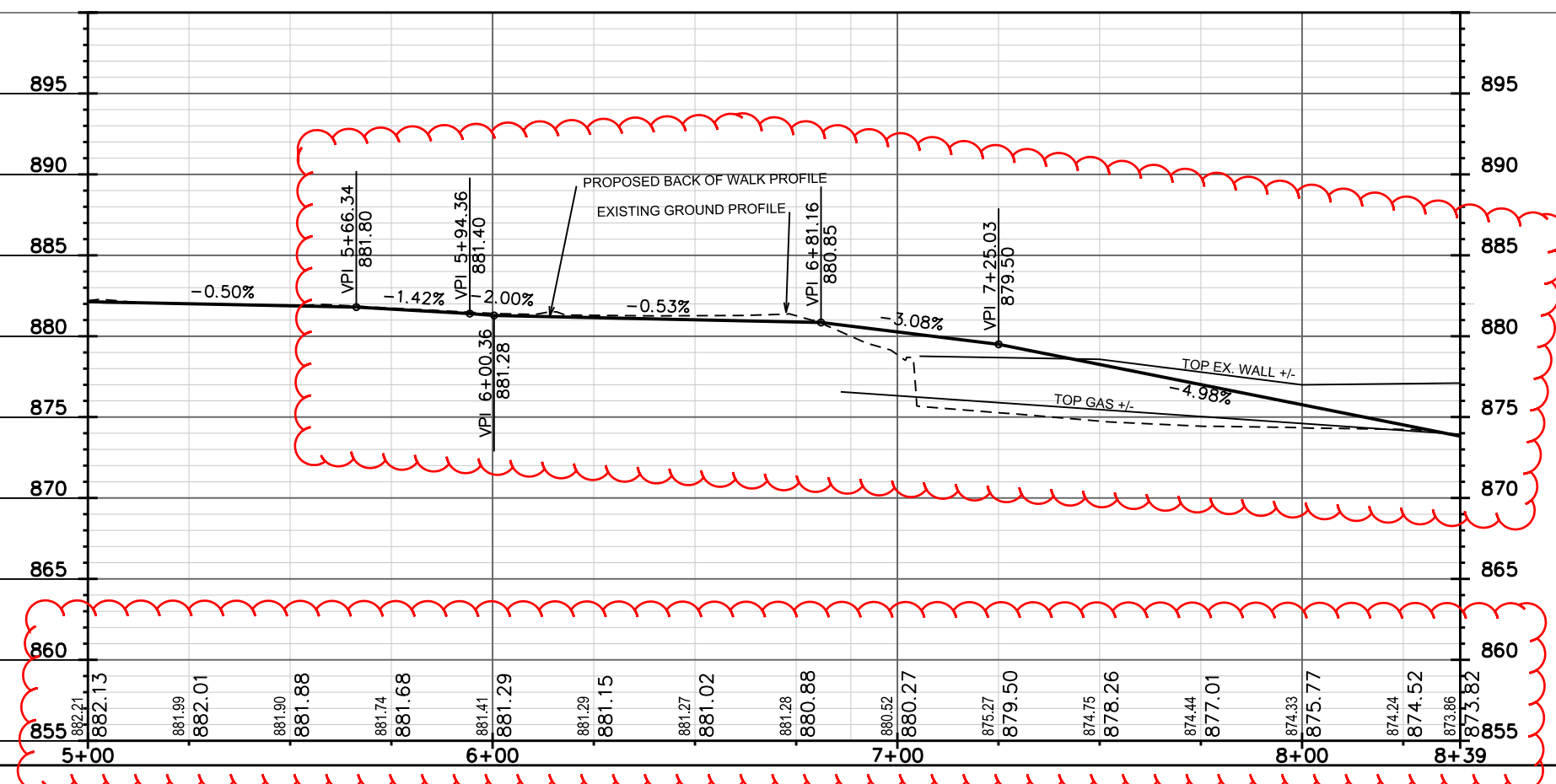

PLOT SCALE: \_\_\_\_\_  
 PLOT NAME: \_\_\_\_\_  
 REV. DATE: \_\_\_\_\_  
 ORIGINATOR: CITY OF MADISON, STREETS DIVISION