

WINNEBAGO TWO-WAY

S. FIRST STREET ONE-WAY

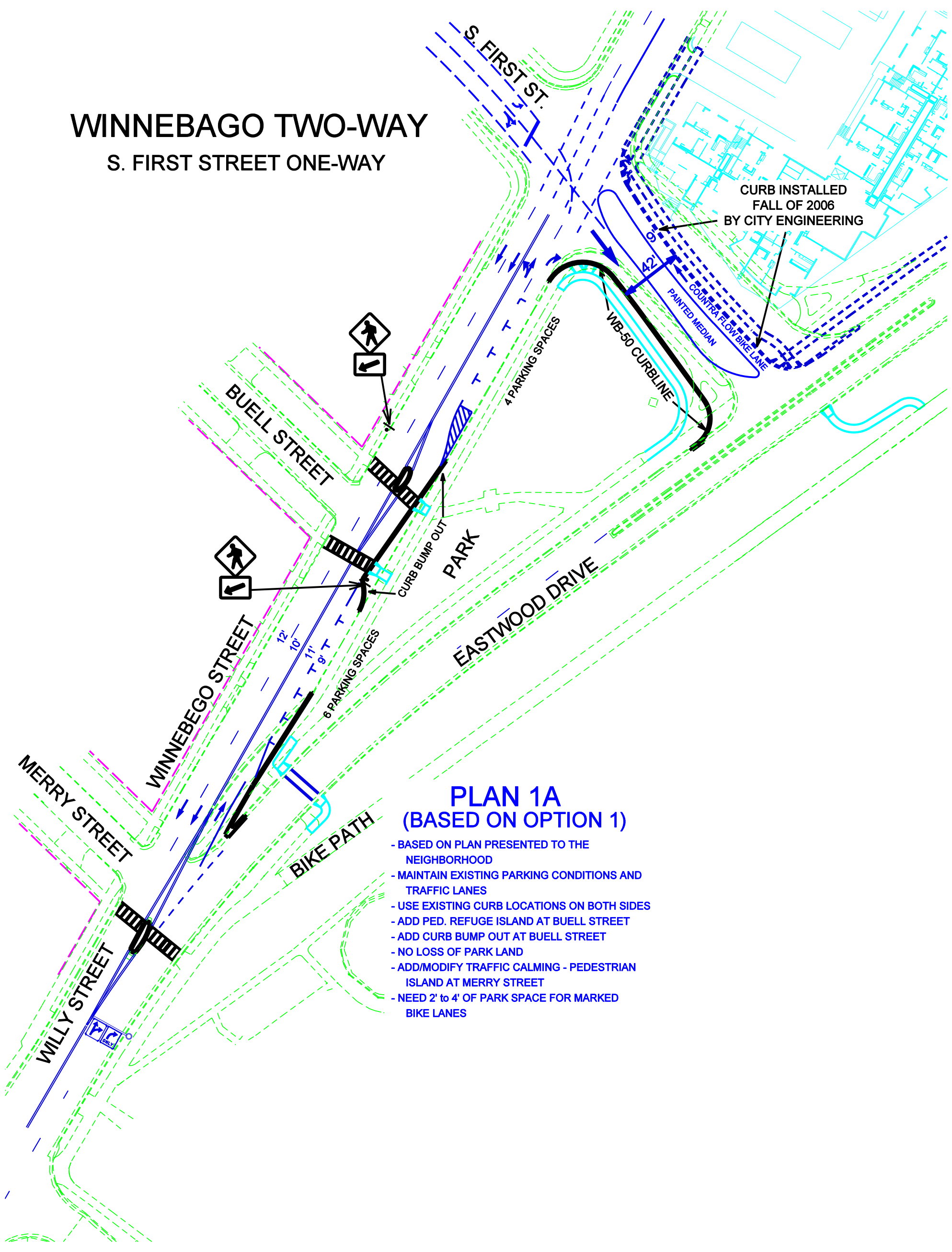

CURB INSTALLED
FALL OF 2006
BY CITY ENGINEERING

PLAN 1A (BASED ON OPTION 1)

- BASED ON PLAN PRESENTED TO THE NEIGHBORHOOD
- MAINTAIN EXISTING PARKING CONDITIONS AND TRAFFIC LANES
- USE EXISTING CURB LOCATIONS ON BOTH SIDES
- ADD PED. REFUGE ISLAND AT BUELL STREET
- ADD CURB BUMP OUT AT BUELL STREET
- NO LOSS OF PARK LAND
- ADD/MODIFY TRAFFIC CALMING - PEDESTRIAN ISLAND AT MERRY STREET
- NEED 2' to 4' OF PARK SPACE FOR MARKED BIKE LANES