

Drawing name: K:\CHILDEV\268072001-Trinitas-Madison-WI\2 Design\CAD\PlanSheets\Prelim Engineering\C2.0 - DEMOLITION PLAN.dwg C2.0 Sep 09, 2024 10:54am by: chris.annett
 This document, together with the concepts and designs presented herein, is intended only for the specific purpose and client for which it was prepared. Reuse of and improper reliance on this document without written authorization and adaptation by Kimley-Horn and Associates, Inc. shall be without liability to Kimley-Horn and Associates, Inc.

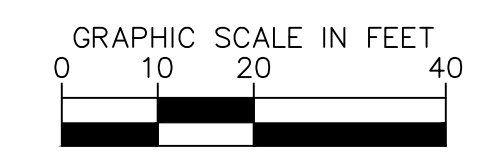
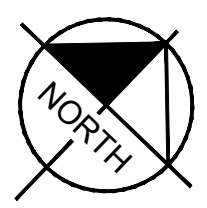
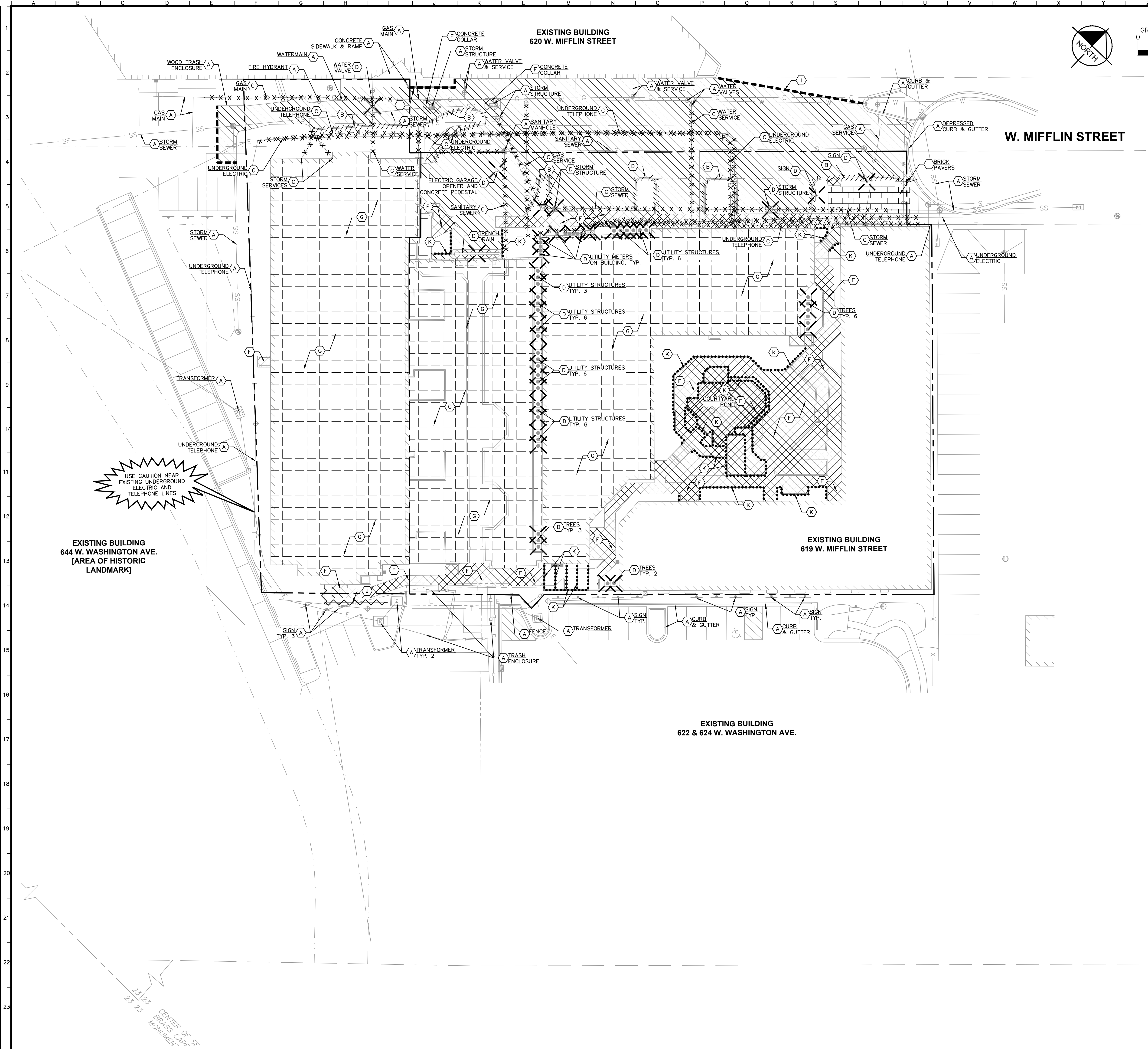

DEMOLITION NOTES

- CONTRACTOR SHALL BE RESPONSIBLE FOR REMOVAL OF THE EXISTING STRUCTURES, RELATED UTILITIES, PAVING, AND ANY OTHER EXISTING IMPROVEMENTS AS NOTED.
- CONTRACTOR IS TO REMOVE AND DISPOSE OF ALL DEBRIS, RUBBISH AND OTHER MATERIALS RESULTING FROM PREVIOUS AND CURRENT DEMOLITION OPERATIONS. DISPOSAL WILL BE IN ACCORDANCE WITH ALL LOCAL, STATE AND/OR FEDERAL REGULATIONS GOVERNING SUCH OPERATIONS.
- THE GENERAL CONTRACTOR SHALL TAKE ALL PRECAUTIONS NECESSARY TO AVOID PROPERTY DAMAGE TO ADJACENT PROPERTIES DURING THE CONSTRUCTION PHASES OF THIS PROJECT. THE CONTRACTOR WILL BE HELD SOLELY RESPONSIBLE FOR ANY DAMAGES TO THE ADJACENT PROPERTIES OCCURRING DURING THE CONSTRUCTION PHASES OF THIS PROJECT. CONTRACTOR SHALL NOT DEMOLISH ANYTHING OUTSIDE THE OWNERS LEASE/PROPERTY LINE UNLESS SPECIFICALLY MENTIONED ON THIS SHEET.
- THE CONTRACTOR IS SPECIFICALLY CAUTIONED THAT THE LOCATION AND/OR ELEVATION OF EXISTING UTILITIES AS SHOWN ON THESE PLANS IS BASED ON RECORDS OF THE VARIOUS UTILITY COMPANIES, AND WHERE POSSIBLE, MEASUREMENTS TAKEN IN THE FIELD. THE INFORMATION IS NOT TO BE RELIED UPON AS BEING EXACT OR COMPLETE. THE CONTRACTOR MUST CALL THE APPROPRIATE UTILITY COMPANY AT LEAST 72 HOURS BEFORE ANY EXCAVATION TO REQUEST EXACT FIELD LOCATION OF UTILITIES.
- IF DEMOLITION OR CONSTRUCTION ON SITE WILL INTERFERE WITH THE ADJACENT PROPERTY OWNER'S TRAFFIC FLOW, THE CONTRACTOR SHALL COORDINATE WITH ADJACENT PROPERTY OWNER, TO MINIMIZE THE IMPACT ON TRAFFIC FLOW. TEMPORARY RE-ROUTING OF TRAFFIC IS TO BE ACCOMPLISHED BY USING IDOT APPROVED TRAFFIC BARRICADES, BARRELS, AND/OR CONES. TEMPORARY SIGNAGE AND FLAGMEN MAY BE ALSO NECESSARY.
- QUANTITIES DEPICTED ON THIS SHEET SHALL SERVE AS A GUIDE ONLY. CONTRACTOR TO VERIFY ALL DEMOLITION QUANTITIES.
- REFER TO GEOTECHNICAL REPORT PROVIDED BY OTHERS FOR ALL SUBSURFACE INFORMATION.
- CONTRACTOR SHALL BEGIN CONSTRUCTION OF ANY LIGHT POLE BASES FOR RELOCATED LIGHT FIXTURES AND RELOCATION OF ELECTRICAL SYSTEM AS SOON AS DEMOLITION BEGINS. CONTRACTOR SHALL BE AWARE THAT INTERRUPTION OF POWER TO ANY LIGHT POLES OR SIGNS SHALL NOT EXCEED 24 HOURS.
- EROSION CONTROL MUST BE ESTABLISHED PRIOR TO ANY WORK ON SITE INCLUDING DEMOLITION.
- THE EXTENT OF SITE DEMOLITION WORK IS AS SHOWN ON THE CONTRACT DOCUMENTS AND AS SPECIFIED HEREIN.
- CONTRACTOR MUST RECEIVE APPROVAL FROM CIVIL ENGINEER AND GEOTECHNICAL ENGINEER FOR THE MATERIAL TYPE AND USE IF CONTRACTOR DESIRES TO REUSE DEMOLISHED SITE PAVEMENT AS STRUCTURAL FILL.
- EXISTING UTILITIES, WHICH DO NOT SERVICE STRUCTURES BEING DEMOLISHED, ARE TO BE KEPT IN SERVICE AND PROTECTED AGAINST DAMAGE DURING DEMOLITION OPERATIONS. CONTRACTOR SHALL ARRANGE FOR SHUT-OFF OF UTILITIES SERVING STRUCTURES TO BE DEMOLISHED. CONTRACTOR SHALL BE RESPONSIBLE FOR TURNING OFF, DISCONNECTING, AND SEALING INDICATED UTILITIES BEFORE STARTING DEMOLITION OPERATIONS. EXISTING UTILITIES TO BE ABANDONED ARE TO BE CAPPED AT BOTH ENDS AND FILLED WITH FA-1 OR APPROVED EQUAL. ALL UNDERGROUND UTILITIES TO BE REMOVED ARE TO BE BACKFILLED WITH ENGINEERED FILL OR SELECT EXCAVATED MATERIAL, AS APPROVED BY THE GEOTECHNICAL ENGINEER, TO 95% OF MODIFIED PROCTOR DENSITY WITHIN PAVED AREAS AND TO 90% OF MODIFIED PROCTOR DENSITY FOR GREEN SPACE AREAS, IN ACCORDANCE WITH THE EARTHWORK SPECIFICATIONS. ALL PRIVATE UTILITIES (ELECTRIC, CABLE, TELEPHONE, FIBER OPTIC, GAS) SHALL BE REMOVED AND RELOCATED PER THE UTILITY OWNER AND THE LOCAL MUNICIPALITY'S REQUIREMENTS.
- UNDERGROUND UTILITIES SHOWN ARE BASED ON ATLASES AND AVAILABLE INFORMATION PRESENTED AT THE TIME OF SURVEY. CONTRACTOR SHOULD CALL DIGGERS (1-800-242-8511) TO CORROBORATE FIELD LOCATIONS OF EXISTING UNDERGROUND UTILITIES BEFORE ORDERING MATERIALS OR COMMENCING CONSTRUCTION. NOTIFY ENGINEER OF ANY DISCREPANCIES IMMEDIATELY. CONTRACTOR SHALL LOCATE AND PROTECT EXISTING UNDERGROUND AND OVERHEAD UTILITIES DURING CONSTRUCTION. UTILITY PROTECTION SHALL BE COORDINATED WITH THE RESPECTIVE UTILITY OWNER AND AS DIRECTED BY THE GOVERNING MUNICIPALITY. DAMAGED CABLES/CONDUITS SHALL BE REPLACED IMMEDIATELY. ALL EXISTING STRUCTURES TO REMAIN SHALL BE PROTECTED THROUGHOUT THE CONSTRUCTION PROCESS. ALL DAMAGED STRUCTURES SHALL BE REPLACED IN-KIND AND THEIR REPLACEMENT COST SHALL BE CONSIDERED INCIDENTAL TO THE CONTRACT. PROPER NOTIFICATION TO THE OWNERS OF THE EXISTING UTILITIES SHALL BE MADE AT LEAST 48 HOURS BEFORE CONSTRUCTION COMMENCES.
- USE WATER SPRINKLING, TEMPORARY ENCLOSURES, AND OTHER SUITABLE METHODS TO LIMIT DUST AND DIRT RISING AND SCATTERING IN THE AIR TO THE LOWEST LEVEL. COMPLY WITH ALL GOVERNING REGULATIONS PERTAINING TO ENVIRONMENTAL PROTECTION. SEE EROSION CONTROL SHEETS FOR FURTHER EROSION CONTROL REQUIREMENTS.
- COMPLETELY FILL BELOW-GRADE AREAS AND VOIDS RESULTING FROM DEMOLITION OF STRUCTURES TO THE FINAL LINES AND GRADES SHOWN ON THE CONTRACT DOCUMENTS. BACKFILL MATERIAL SHALL BE DOT APPROVED CRUSHED LIMESTONE (CA-6) OR APPROVED EQUAL. USE SATISFACTORY SOIL MATERIALS CONSISTING OF STONE, GRAVEL AND SAND, FREE FROM DEBRIS, TRASH, FROZEN MATERIALS, ROOTS AND OTHER ORGANIC MATTER. PRIOR TO PLACEMENT OF FILL MATERIALS, ENSURE THAT AREAS TO BE FILLED ARE FREE OF STANDING WATER, FROST, FROZEN MATERIAL, TRASH AND DEBRIS. PLACE FILL MATERIALS IN HORIZONTAL LAYERS NOT EXCEEDING 9" IN LOOSE DEPTH. COMPACT EACH LAYER AT OPTIMUM MOISTURE CONTENT OF FILL MATERIAL TO 95% OF MODIFIED PROCTOR DENSITY UNLESS SUBSEQUENT EXCAVATION FOR NEW WORK IS REQUIRED.

DEMOLITION LEGEND

(A)	ITEM TO REMAIN, PROTECT DURING CONSTRUCTION
(B)	CURB REMOVAL
(C)	X-X UTILITY REMOVAL
(D)	ITEM TO BE REMOVED
(E)	FULL-DEPTH ASPHALT PAVEMENT REMOVAL
(F)	CONCRETE REMOVAL
(G)	BUILDING REMOVAL
(H)	ASPHALT 1.5" MILL
(I)	SAWCUT LINE
(J)	FENCE REMOVAL
(K)	WALL REMOVAL
(L)	BRICK PAVEMENT REMOVAL

WARNING: CONTRACTOR TO VERIFY PRESENCE AND EXACT LOCATION OF ALL UTILITIES PRIOR TO CONSTRUCTION.

<p>© 2024 KIMLEY-HORN AND ASSOCIATES, INC. 4201 WINDFELD ROAD, SUITE 600 MADISON, WI 53704 PHONE: 608-487-2500 WWW.KIMLEY-HORN.COM</p>	DATE: _____ BY: _____ NO. _____ REVISIONS: _____
DEMOLITION PLAN	
TRINITAS 619/699 WEST MIFFLIN STREET MADISON, WISCONSIN 53703	
	ORIGINAL ISSUE: 08/27/2024 KHA PROJECT NO. 268072001 SHEET NUMBER C2.0