

ID # 00239

RECEIVED - OFFICE OF THE SECRETARY OF STATE
CLERK'S OFFICE

04 AUG 16 PM 1:07

MEMORANDUM

OFFICE OF THE SECRETARY OF STATE STATE OF WISCONSIN

Date: August 13, 2004

From: Government Records Division
Contact Person: Tineisha Scott
30 West Mifflin St , 10th Floor
P O. Box 7848
Madison, WI 53707-7848

(608) 266-8888 7:45 – 1:30

To: Kelly Schieldt
Department of Transportation
Room 901, Hill Farm State Office Bldg.

Re: Municipal Filing Distribution

Enclosed please find municipal filings submitted to the Office of the Secretary of State pursuant to Chapter 66, Wis. Stats.

Cc: Eugene Miller, DOR/Bureau of Equalization
George Hall, DOA/Energy & Intergovernmental Relations
Bob Naylor, DOA
Keith Foye, DATCP
Carmen Wagner, DNR
Clerk (2)

C-205

CITY OF FITCHBURG

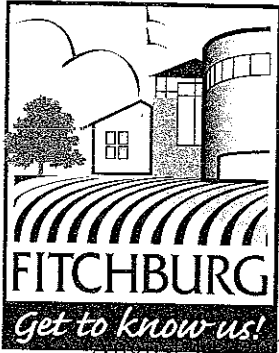

August 11, 2004

Office of the Mayor

5520 Lacy Road
Fitchburg, WI 53711-5318

Phone: (608) 270-4200 ■ Fax: (608) 270-4212

www.cityfitchburg.wi.us

Annexations and Railroads
 Division of Government Records
 Office of the Secretary of State
 P. O. Box 7848
 Madison, WI 53707-7848

Dear Mr. LaFollette:

Ordinance #2004-O-19
 Seminole Highway Area Detachment

RECEIVED CITY OF MADISON
 CLERK'S OFFICE
 04 AUG 16 PM 1:07

I, Karen A. Peters, City Clerk of the City of Fitchburg, County of Dane, State of Wisconsin, pursuant to the City of Madison, City of Fitchburg, and Town of Madison Cooperative Plan, DO HEREBY CERTIFY adoption of detachment Ordinance #2004-O-19 on August 10, 2004; thereby detaching territory from the City of Fitchburg and annexing same to the City of Madison.

A certified copy of Ordinance #2004-O-19, which contains an accurate metes and bounds description of the territory so affected is attached and the population identified in the detached territory is zero (0).

Sincerely,

Karen A. Peters, MMC
 City Clerk

STATE OF WISCONSIN
 RECEIVED & FILED
 AUG 12 2004
 DOUGLAS L. FOLLETTE
 COUNTY CLERK OF THE STATE

Page 2
Secretary of State

cc: Dane County Register of Deeds for recording
Clerk, City of Madison
SBC
Madison Metropolitan School District
M G & E
Bill Roberts, Planning & Development Unit
Dane County Clerk
Dane County Regional Planning Commission
Dane County Land Reg. & Records
Dane County Public Safety Communications
Dane County EMS
Charter Communications
Madison Metropolitan Sewer District
Madison Area Metropolitan Planning Organization
Fitchburg City Planner - Tom Hovel
Fitchburg City Engineer - Paul Woodard
Fitchburg Assessor - Mike Procknow
Fitchburg Administrator - Tony roach
Fitchburg Fire Chief - Randy Pickering
Fitchburg Police Chief - Tom Blatter
Fitchburg City Clerk file
FitchRona EMS

Mayor Thomas Clauder
Introduced By

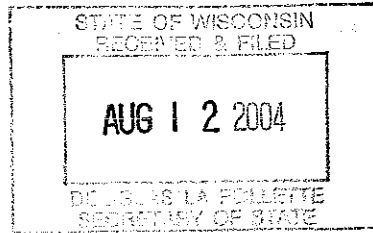

Attorney Sewell
Drafted By

Plan Commission
Referred to

July 13, 2004
Date

ORDINANCE 2004-O-19

**AN ORDINANCE TO AMEND CHAPTER 31,
"CITY BOUNDARIES, WARDS, ALDERMANIC DISTRICTS AND
ELECTIONS"
TO CREATE SUBSECTIONS 31.01(1)(D) AND 31.06(4)(A)**

WHEREAS, Sec. 66.0307, Wis. Stats. authorizes municipalities to determine the boundary lines between themselves upon approval of a cooperative boundary plan by the State Department of Administration; and

WHEREAS, on October 20, 2002, November 4, 2002 and November 5, 2002, the City of Fitchburg, Town of Madison, and City of Madison, respectively, adopted resolutions authorizing participation in the preparation of a cooperative plan pursuant to said statute and approved an intergovernmental agreement pursuant to Sec. 66.0301, Wis. Stats. to provide the basic foundation of the proposed cooperative plan; and

WHEREAS, the City of Madison, City of Fitchburg, and Town of Madison Cooperative Plan has been proposed and specifies that upon approval of the Plan by the State Department of Administration, the Seminole Highway Right of Way, as described below, shall be detached from the City of Fitchburg and attached to the City of Madison

NOW, THEREFORE, the Common Council of the City of Fitchburg do hereby ordain as follows:

1 Subsection (1)(D) of Section 31.01 of the Fitchburg General Ordinances is created to read as follows:

31.01(1)(D) There is hereby detached from the City of Fitchburg, Dane County, Wisconsin, the following described property:

Part of the Northeast $\frac{1}{4}$ of the Northeast $\frac{1}{4}$ of Section 5, T6N, R9E, City of Fitchburg, Dane County, Wisconsin, more particularly described as follows:

Commencing at the Northeast Corner of Section 5, T6N, R9E, Dane County, Wisconsin; thence Westerly along the North line of Section 5 to the East right-of-way line of Seminole Highway and the point of beginning; thence Southwesterly along the East right-of-way line of Seminole Highway to the North plat line extended of the East Hill Addition to Belmar; thence Westerly along said North plat line to the centerline of

Seminole Highway Detachment

Ordinance No.: 2004-0-19

Date Published:

Date Adopted:

Ald. Dist. Detached from: 2nd

Area (Sq. Ft.): 49,336

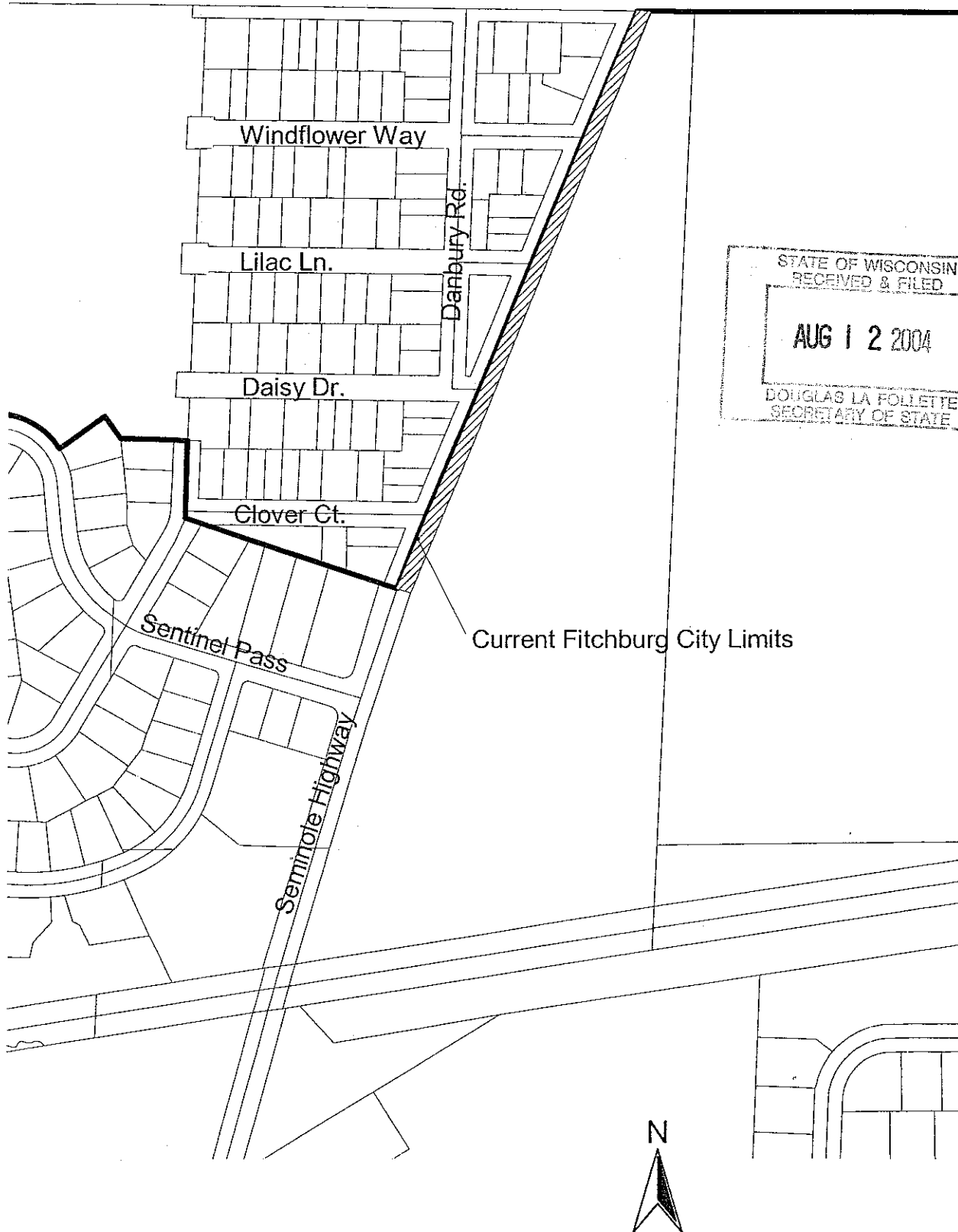

STATE OF WISCONSIN
RECEIVED & FILED
AUG 12 2004
DOUGLAS LA FOLLETTE
SECRETARY OF STATE