

1. CONTRACTOR TO REMOVE ALL EXISTING ASPHALT AND/OR CONCRETE PARKING AREAS, STOOPS, WALKWAYS AND STAIRS WITHIN THE PROPERTY BOUNDARY LINES UNLESS OTHERWISE INDICATED.
2. CONTRACTOR TO REMOVE BOULDER PLANTING BEDS, WALLS AND PLANTINGS.
3. ALL DISTURBED AREA TO BE GRADED AND REPLACED WITH TOPSOIL, SEED AND MULCH PER CITY OF MADISON PUBLIC WORKS STANDARD SPECIFICATIONS. PROPOSED AREA OF DISTURBANCE IS APPROX 66,585 SQ FT
3. CONTRACTOR IS RESPONSIBLE FOR DELEGATED DESIGN BY A CERTIFIED ENGINEER FOR SOIL RETAINAGE STRUCTURE IF REQUIRED.

1. REMOVE EXISTING BUILDING IN ITS ENTIRETY, INCLUDING FOUNDATION, FOOTINGS AND SLAB ON GRADE.
2. HAZARDOUS MATERIALS TESTING INCLUDING ASBESTOS AND LEAD IS THE RESPONSIBILITY OF THE CONTRACTOR. ALL IDENTIFIED ITEMS TO BE REMOVED AND DISPOSED OF BY A CERTIFIED ABATEMENT CONTRACTOR ACCORDING TO CODE.
3. ITEMS DESIGNATED FOR RECYCLING TO BE REMOVED PRIOR TO FINAL DEMOLITION

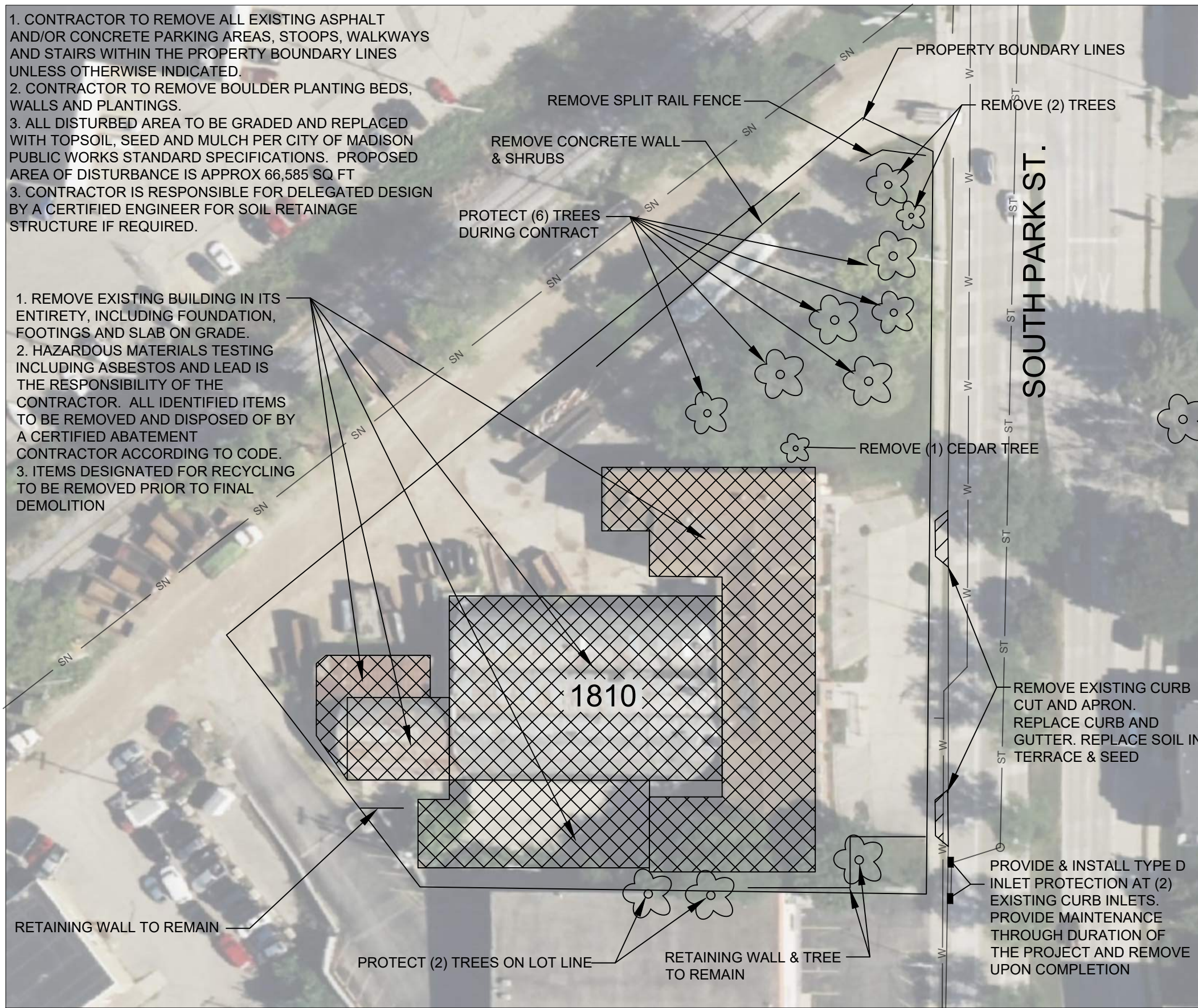

NORTH  
DEMOLITION PLAN  
PLAN SCALE 11X17: 1"=50"

GENERAL NOTES:

1. SEE SPECIAL PROVISIONS AND CONTRACT EXHIBITS FOR ADDITIONAL INFORMATION.
2. REMOVAL OF TREES (ONLY IF INDICATED) INCLUDES ALL TRUNKS, STUMPS AND ROOTS TO MINIMUM OF 2'-0" BELOW FINISHED GRADE.
3. CONTRACTOR SHALL RESTORE TERRACE AND SIDEWALK AT THE CONSTRUCTION ENTRANCE DURING FINAL GRADING AND SEEDING PER CITY OF MADISON PUBLIC WORKS STANDARD SPECIFICATIONS.
4. CONTRACTOR SHALL PROVIDE PROJECT MANAGER WITH ALL SHIPPING MANIFESTS FOR MATERIALS IN AND OUT OF THE PROJECT SITE.
5. CONTRACTOR TO COORDINATE FINAL REMOVAL OF ALL UTILITY LATERALS.
6. THE CONTRACTOR IS RESPONSIBLE FOR COMPLYING WITH AND OBTAINING PERMITS FROM ALL AGENCIES AND AUTHORITIES HAVING JURISDICTION.
7. ALL SITE AND RIGHT OF WAY TO BE RESTORED BY THE CONTRACTOR PER CITY OF MADISON PUBLIC WORKS SPECIFICATIONS.

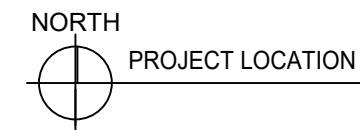
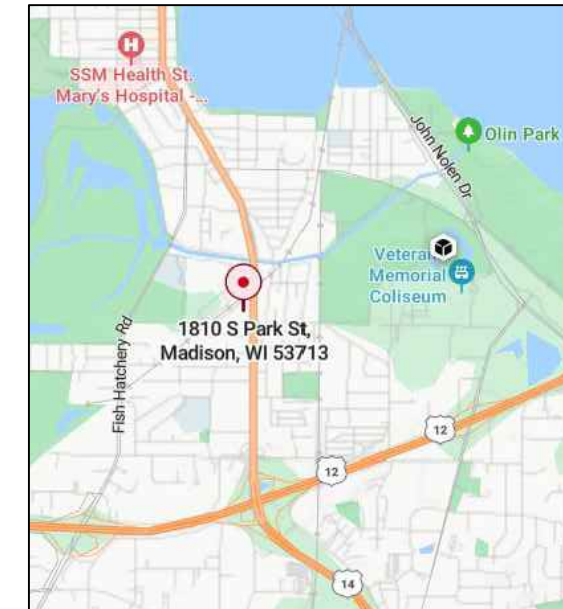

SHEET INDEX:

D1	DEMOLITION PLAN
A1	EXTERIOR PHOTOS
A2	EXTERIOR PHOTOS
A3	INTERIOR PHOTOS
A4	INTERIOR PHOTOS



DRAWN BY: LA  
DATE: 10/21/2024  
REVISED:

1810 S. PARK ST. DEMOLITION

MADISON, WIS  
CONTRACT#:

SHT  
D1