



**City of Madison
Class B Combination
License No. 14779-3295**



**PROSIT TO YOU INC
ESSEN HAUS
LIQUOR/BEER AGENT: ROBERT L WORM
514 E WILSON ST
MADISON, WI 53703**

Expiration Date 06/30/2026
Date Issued 06/11/2025

Mayor

City Clerk

PURSUANT TO SECTION 38 OF THE MADISON GENERAL ORDINANCES AND CHAPTE OF THE WISCONSIN STATE STATUTES.

Premise - main floor two rooms, second floor banquet room, outdoor cafe, kitchens and basement storage, beer garden for special events, also outdoor volleyball court.

License granted by Common Council 6/3/86. Change in licensed premise 9-17-96 with the following condition:

- 1) Outdoor cafe to be open as long as food is available but not later than 12:00 midnight.

Common Council granted a Change in Licensed Premises 3-19-2013 adding outside seating the conditions:

- 1) Total capacity remains 240.
- 2) Service outdoors to cease at 12:00 midnight.
- 3) Granting contingent on approval of Major Alteration by Common Council and with condition attached to the Major Alteration approval.

Expiration Date 06/30/2026

Not Transferable. Post entire license in a conspicuous place.



**City of Madison
Entertainment
License No. 14779-71717**



**PROSIT TO YOU INC
ESSEN HAUS
514 E WILSON ST
MADISON, WI 53703**

Expiration Date 06/30/2026
Date Issued 06/26/2025

Mayor

City Clerk

PURSUANT TO SECTION 38.06 OF THE MADISON GENERAL ORDINANCES.

Expiration Date 06/30/2026

Not Transferable. Post entire license in a conspicuous place.

June 30, 2026

PROSIT TO YOU INC
514 E WILSON ST
MADISON WI 53703-3431



**City of Madison
Class B Combination
License No. 75376-85526**



**PROSIT TO YOU INC
UP NORTH
LIQUOR/BEER AGENT: ROBERT WORM
524 E WILSON ST
MADISON, WI 53703**

Expiration Date 06/30/2026
Date Issued 06/11/2025

Mayor

City Clerk

PURSUANT TO SECTION 38 OF THE MADISON GENERAL ORDINANCES AND CHAPTER 125 OF THE WISCONSIN STATE STATUTES.

Tavern Premise - First floor, three rooms and patio (4356 square feet), outside deck (900 square feet), basement two coolers and four rooms (3500 square feet).

Common Council granted on 11-17-98 with the following conditions:

- 1) Outdoor areas must close one-half hour after sunset, subject to existing exceptions for special events on the license for Essen Haus.
- 2) No amplified sound (live or recorded) allowed in the outdoor area, subject to special event permits (daytime hours only).
- 3) Bakery area closed to alcohol at 9:00 p.m.
- 4) No wait staff service in retail and bakery areas.
- 5) Staff responsible for outside area being kept noise free until closing time.

Expiration Date 06/30/2026

Not Transferable. Post entire license in a conspicuous place.



knothe • bruce
ARCHITECTS

Phone: 7601 University Ave., Ste 201
608.836.3690 Middleton, WI 53562

S. FRANKLIN STREET

E. WILSON STREET

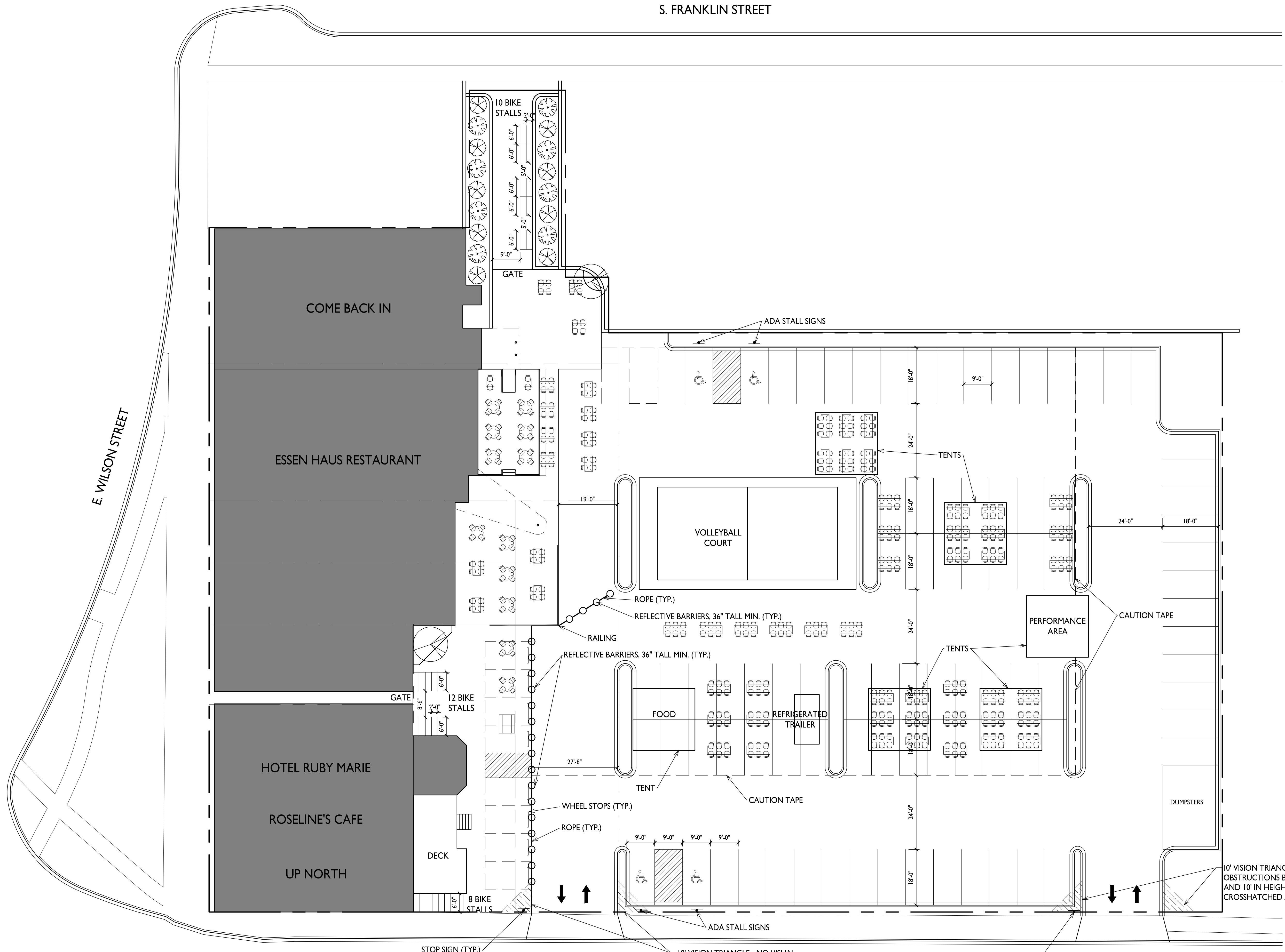

ISSUED
Issued for Review - December 8, 2022

PROJECT TITLE
ESSEN HAUS
Redevelopment

508 E Wilson St
Madison, Wisconsin
SHEET TITLE
Event Plan Layout

SHEET NUMBER

C-1.1

PROJECT NO. **2028**
© Knothe & Bruce Architects, LLC

I EVENT PLAN LAYOUT
C-1.1 1/16" = 1'-0"

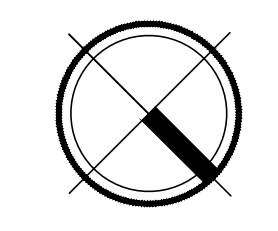

10' VISION TRIANGLE - NO VISUAL OBSTRUCTIONS BETWEEN 30" AND 10' IN HEIGHT WITHIN CROSSHATCHED AREAS.

10' VISION TRIANGLE - NO VISUAL OBSTRUCTIONS BETWEEN 30" AND 10' IN HEIGHT WITHIN CROSSHATCHED AREAS.

S. BLAIR STREET

STOP SIGN (TYP.)

STOP SIGN (TYP.)

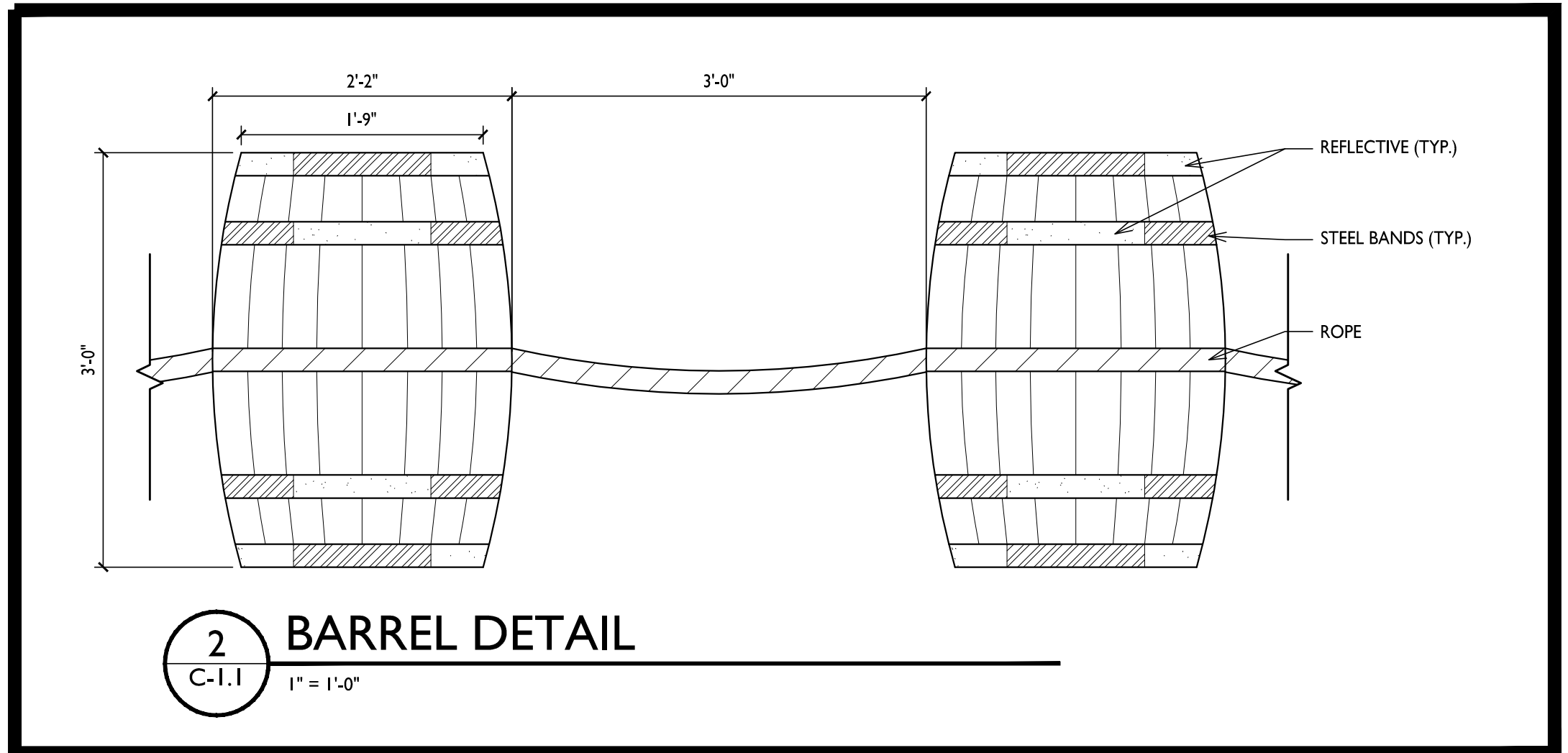
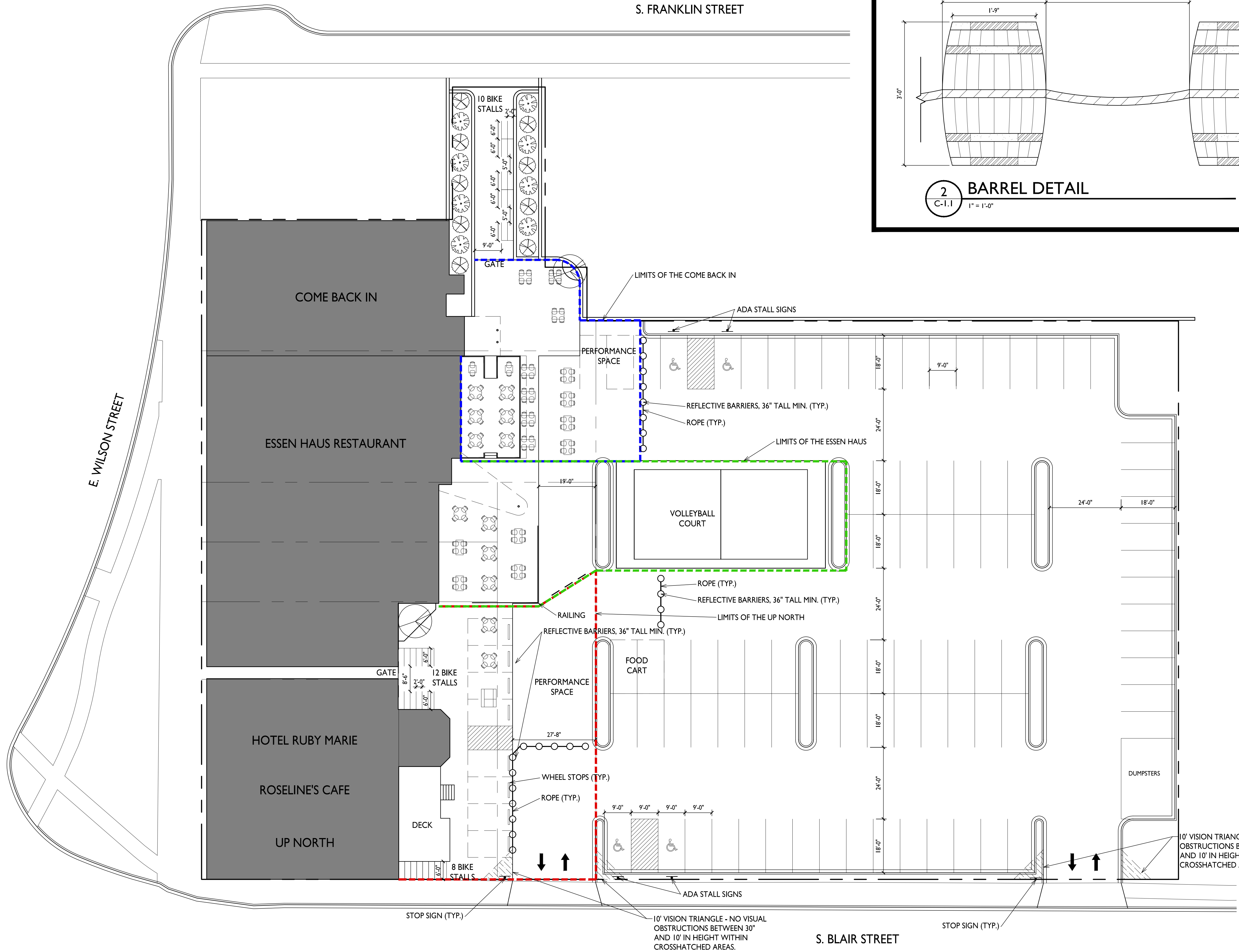

ISSUED
 Issued for Review - November 8, 2022

PROJECT TITLE
ESSEN HAUS
 Redevelopment

508 E Wilson St
 Madison, Wisconsin
 SHEET TITLE
Seasonal Summer
 Layout

SHEET NUMBER

C-1.1

PROJECT NO. **2028**
 © Knothe & Bruce Architects, LLC

1 SEASONAL SUMMER LAYOUT
 C-1.1 1/16" = 1'-0"

