

Schedule A

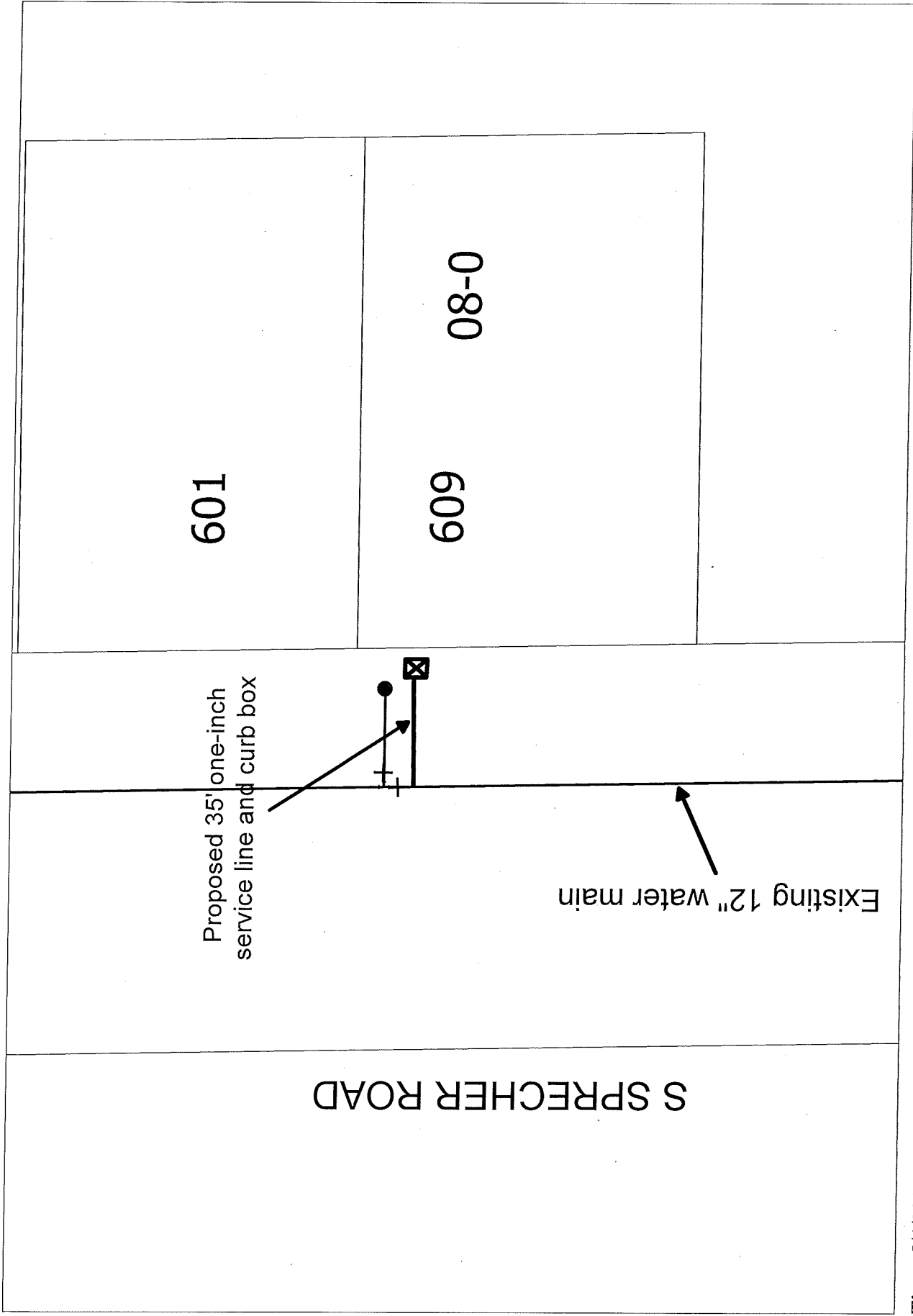

Time: 5/4/2017 12:00:29 PM

Note: 609 S Sprecher Road Assessment District

City of Madison, WI - GIS/Mapping data

Printed By: wujdg

Disclaimer: The City makes no representation about the accuracy of these records and shall not be liable for any damages

Schedule A – Plans and Specifications

Proposed: Install complete water service lateral including corporation stop, thirty-five (35) feet of 1” copper tubing, curb stop, and complete curb box.

<b>Material/Equipment</b>	<b>Amount</b>	<b>Rate</b>	<b>Cost</b>	<b>Material/Equipment</b>	<b>Amount</b>	<b>Rate</b>	<b>Cost</b>
Field Supervisor	2 hr	62.10	124.20	1” corporation stop	1	33.00	33.00
Lead Worker	8 hr	55.36	442.88	1” 45 degree bend	1	27.50	27.50
Equip Operator 3	8 hr	50.28	402.24	1” curb box complete	1	100.19	100.19
Equip Operator 1	3 x 8 hr	43.59	1046.16	1” copper	35 ft	2.85	99.75
Air Compressor	2 hr	25.00	50.00	Sand	15 ton	6.20	93.00
Backhoe	8 hr	30.00	240.00	Gravel	20 ton	8.45	169.00
Street Opening Permit	1	175.40	175.40	Dump fee	25 cu yd	1.76	44.00
1” curb stop	1	81.50	81.50	Cold patch	0.5 ton	99.95	49.98

Total - \$ 3178.80

Asphalt repairs to include 5” x 8’ x 6’ base patch and 2” x 50’ x 28’ mill & overlay.

<b>Material/Equipment</b>	<b>Amount</b>	<b>Rate</b>	<b>Cost</b>
5” base patch (8’ x 6’)	5.33 SY	45.00	240.00
2” mill & overlay (50’ x 28’)	150.27 SY	29.00	4357.83

Total - \$4597.83