

**Madison, Wisconsin**

RELOCATION ORDER APPROVED  
BY THE COMMON COUNCIL

CITY CLERK \_\_\_\_\_ DATE \_\_\_\_\_

RELOCATION ORDER APPROVED  
BY THE BOARD OF PUBLIC WORKS:

EXECUTIVE SECRETARY \_\_\_\_\_ DATE \_\_\_\_\_

RELOCATION ORDER APPROVED  
BY THE PLAN COMMISSION:

EXECUTIVE SECRETARY \_\_\_\_\_ DATE \_\_\_\_\_

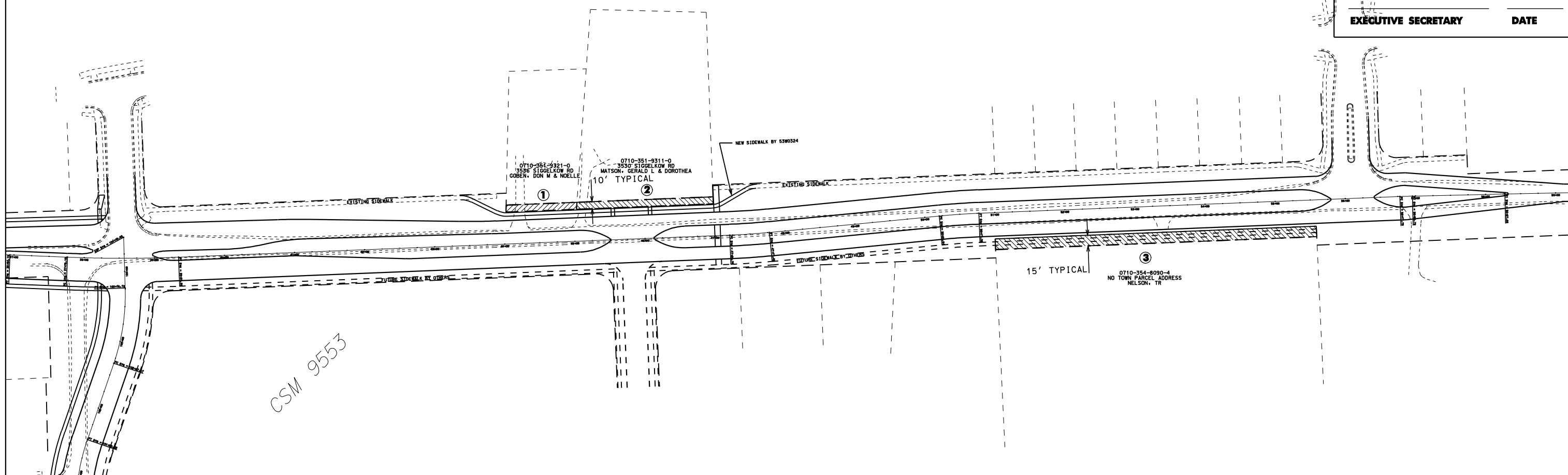

**SCHEDULE OF INTERESTS REQUIRED**

PARCEL #	OWNER NAME	FEE AREA REQUIRED	EASEMENT AREA REQUIRED	RECORDED DOCUMENT NO.
①	GOBEN, DON M. & NOELLE B.	_____	1,008 SQ FT (TLE)	
②	MATSON, GERALD L. & DOROTHEA S.	_____	1,945 SQ FT (TLE)	
③	NELSON TRUST NELSON, JEROME M. & CAROL L.	_____	6,872 SQ FT (TLE)	

REVISIONS

**CITY OF MADISON  
RELOCATION ORDER**

"PLAT OF LAND INTERESTS REQUIRED FOR THE CONSTRUCTION AND MAINTENANCE OF IMPROVEMENTS FOR PUBLIC SANITARY SEWER AND PUBLIC STORMWATER DRAINAGE", LOCATED IN THE SOUTHEAST 1/4 OF SECTION 34, TOWN 7 NORTH, RANGE 8 EAST, TOWN OF MIDDLETON, DANE COUNTY, WISCONSIN.

CITY ENGINEERING DIVISION  
PROJECT NO. 53W0324  
REAL ESTATE PROJECT NO. 8862

OCTOBER 16, 2007 ETP

PLOT SCALE: \_\_\_\_\_

PLOT NAME: \_\_\_\_\_

REV. DATE: \_\_\_\_\_

ORIGINATOR: \_\_\_\_\_