



City of Madison

Conditional Use

Location
711 State Street

Project Name
Coffee Cart Alteration

Applicant
SWD Lutheran Church, Missouri Synod /
Bill Montelbano

Existing Use
Multi-tenant Commercial

Proposed Use
Construct walk-up service window for
coffeehouse within ten feet of right-of-way

Public Hearing Date
Plan Commission
July 29 2019

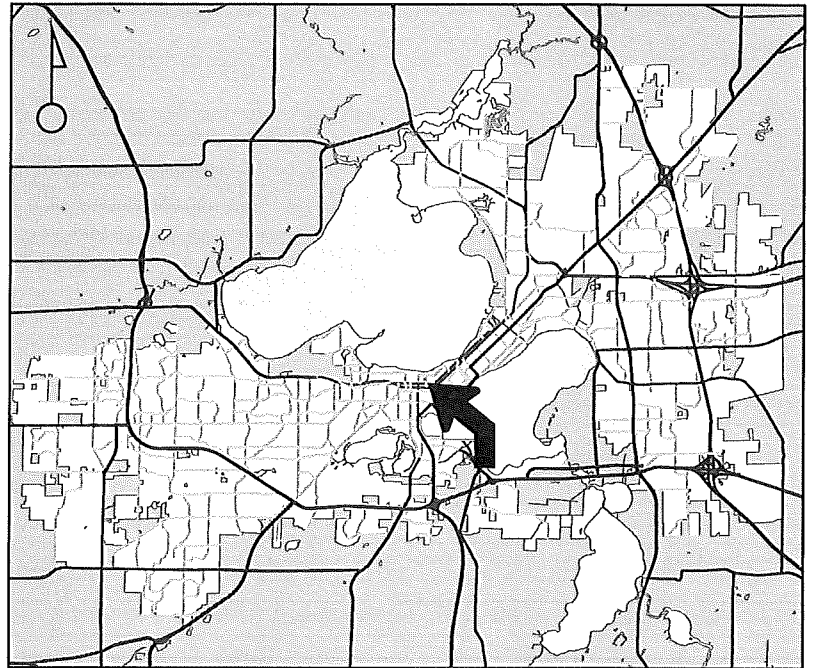

For Questions Contact: Chris Wells at: 261-9135 or cwells@cityofmadison.com or City Planning at 266-4635

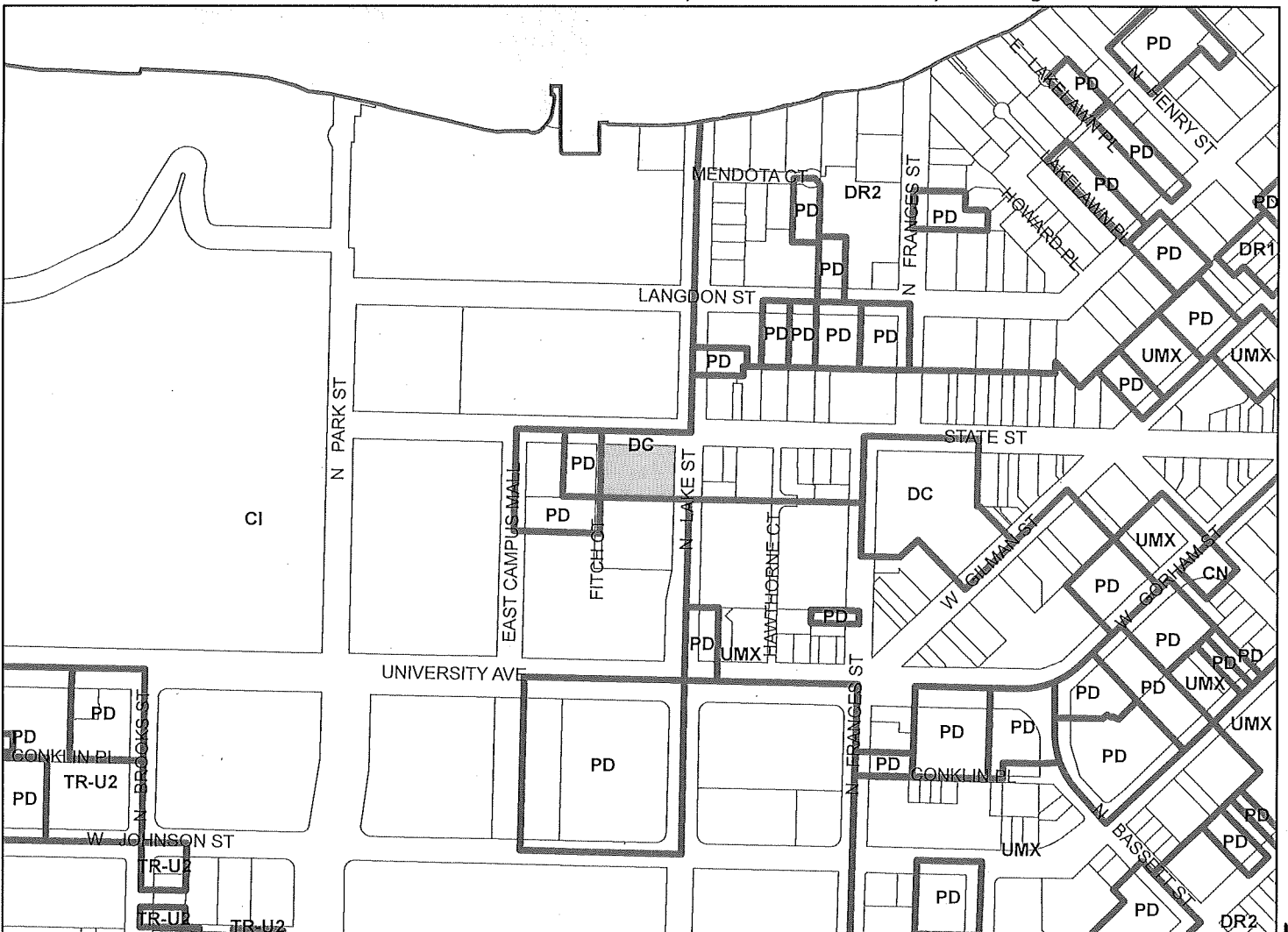

Scale : 1" = 400'

City of Madison, Planning Division : PPE : Date : 16 July 2019

13

