

212 S. Baldwin St.
 Madison, WI. 53703

Phone: 608.241.4297
 Fax: 608.661.3612
 E-mail:
 thaver@haverdesign.com
 www.haverdesign.com

CLIENT

Reed Jones
 211 N Spooner St
 Madison, WI 53726

TITLE

Garage-
 Studio
 1/4" = 1'0"

REV. DATE	SHEET
11-30-2015	1

Construction:
 Walls: 2 x 6 24" OC, 1/2" OSB
 Sheathing, 1" Styrofoam, Shingle Siding
 Roof: 2 x 6 rafters, 24" OC 1 1/2"
 Styrofoam, 7/16" OSB Sheathing

Section
 through roof
 1/4" = 1'0"

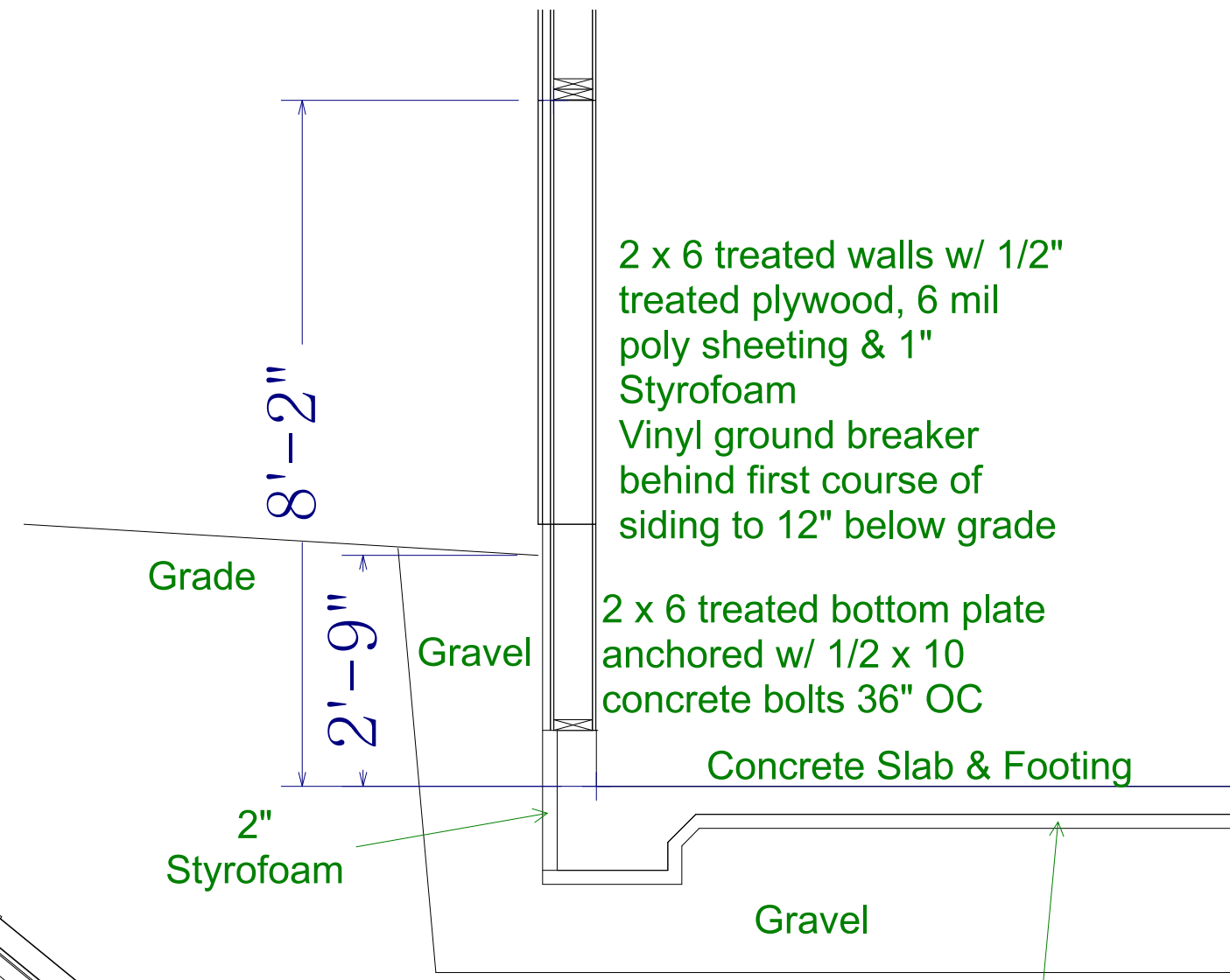
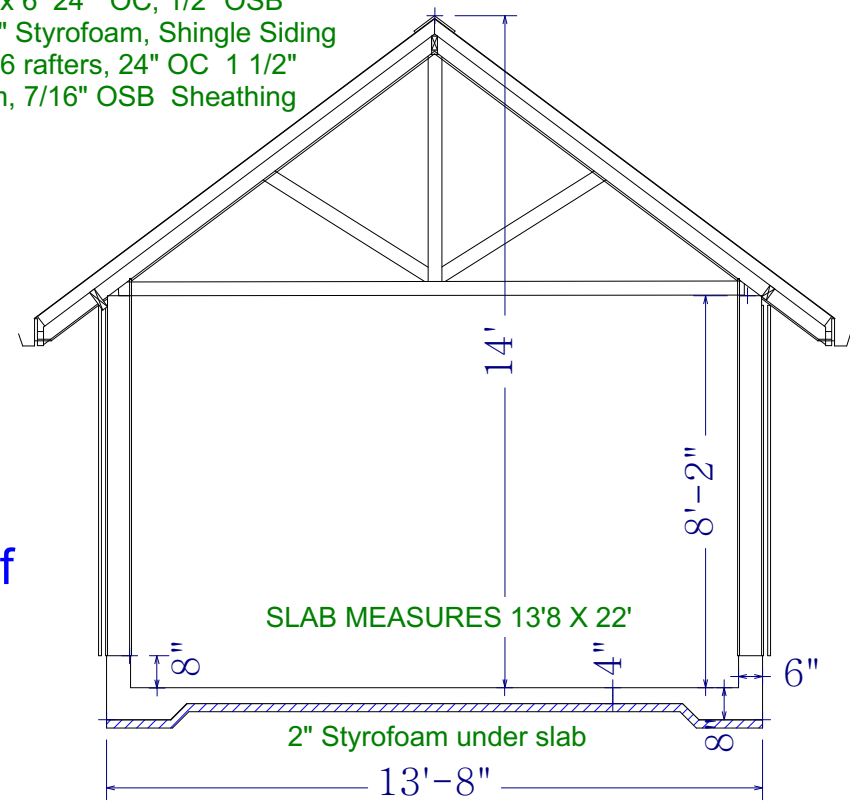

Wall/floor
 section
 1/2" = 1'0"



212 S. Baldwin St.
 Madison, WI. 53703

Phone: 608.241.4297
 Fax: 608.661.3612
 E-mail:
 thaver@haverdesign.com
 www.haverdesign.com

CLIENT

Reed Jones
 211 N Spooner St
 Madison, WI 53726

TITLE

Garage
 construction
 details

REV. DATE
 11-30-2015

SHEET
 2

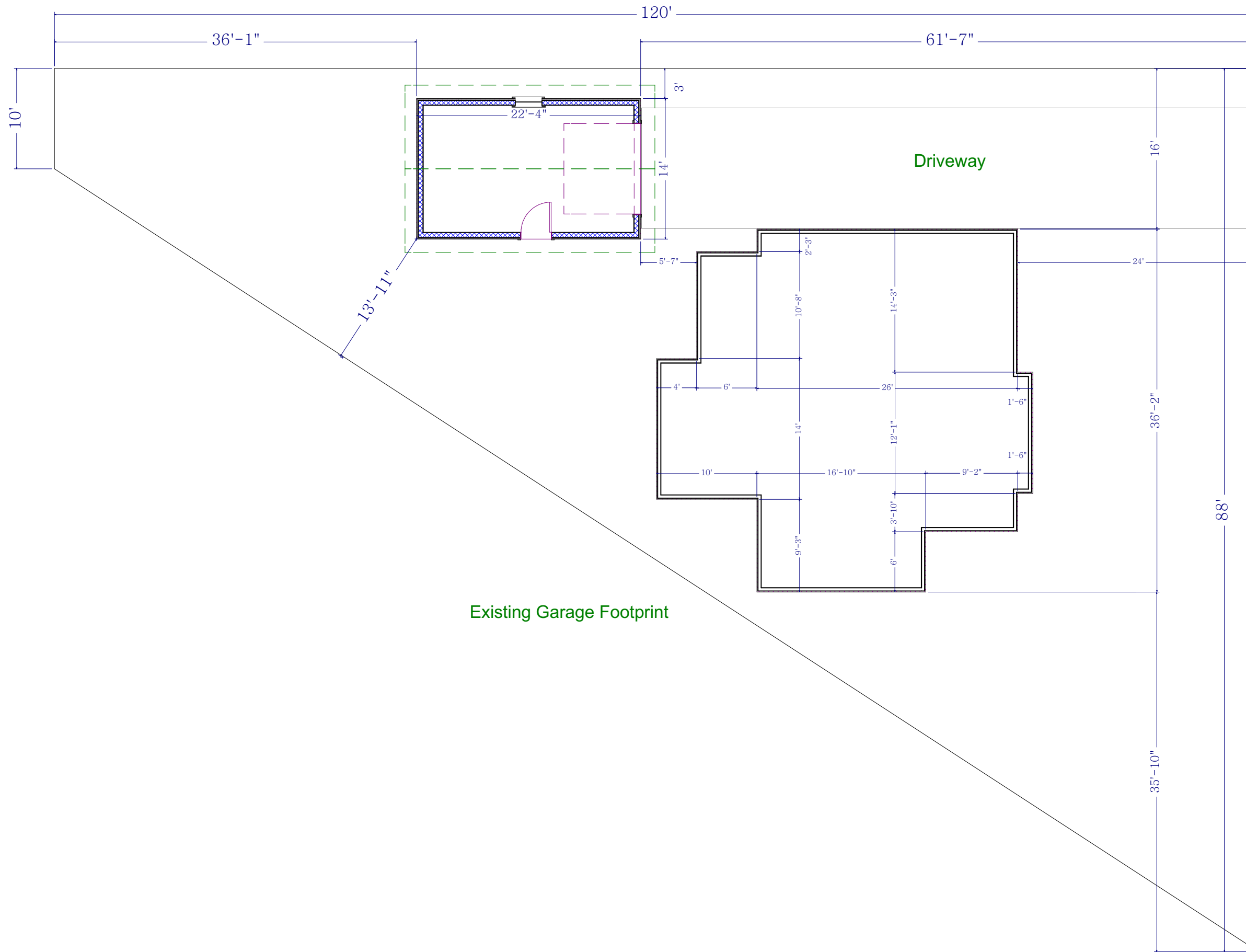

Spooner Street



212 S. Baldwin St.
Madison, WI. 53703

Phone: 608.241.4297
Fax: 608.661.3612
E-mail:
thaver@haverdesign.com
www.haverdesign.com

CLIENT

Reed Jones
211 N Spooner St
Madison, WI 53726

TITLE

Site Plan
1" = 10'

REV. DATE
11-30-2015

SHEET
3