

STREET USE PERMIT APPLICATION

FOR OFFICE USE ONLY: Permit # _____ Date Submitted _____

EVENT INFORMATION

Name of Event Susan G. Komen South Central Wisconsin Race for the Cure

Event Organizer/Sponsor South Central Wisconsin Affiliate of Susan G. Komen for the Cure

Is Organizer/Sponsor a 501(c)3 non-profit agency?

Yes No

If Yes, provide State of Wisconsin Tax Exempt Number ES 41226

Address 8030 Excelsior Drive, Suite 306

City/State/Zip Madison, WI, 53717

Primary Contact Allyson Crowley

FAX _____

Work Phone 608-836-1083

Phone During Event (608) 220-7135 or (608) 335-8018

E-mail racecoor@komensouthcentralwi.org

Website www.komensouthcentralwi.org

Secondary Contact Michelle Heitzinger

Work Phone (608) 836-1083

Phone During Event (608) 332-5778

E-mail michelle@komensouthcentralwi.org

Annual Event?

Yes No

Charitable Event?

Yes No

If Yes, name of charity to receive donations: South Central Wisconsin Affiliate of Susan G. Komen for the Cure

Estimated Attendance 11,500

(CERTIFICATE OF INSURANCE MAY BE REQUIRED)

Public Amplification (not allowed after 11 p.m.) Hours 7am to 11am

Yes No

EVENT CATEGORY

Run/Walk

Music/Concert

Festival

Rally

Parking (i.e., bagging meters)

Other _____

LOCATION REQUESTED

Capitol Square (note specific blocks below)

Podium/700-800 State Street

30 on the Square (a.k.a. top of 100 block of State Street)

Other (specific blocks/streets requested below)

Street Names and Block Numbers: Please see attached map

EVENT DATE(S)/SCHEDULE

Date(s) of Event (including set-up and take-down) 6/1/13

Rain Date(s) None

Event Start Date(s)/Time(s) 6/1/13 6:00am

Set-Up Date(s)/Time for Event 6/1/13 6:00 am

Event End Date(s)/Time(s) 6/1/13 2:00 pm

Take-Down Time 12:00 pm

Take-Down Time: start to streets reopened

APPLICATION SIGNATURE

I/We waive the 21-day decision requirement.

AC (PLEASE INITIAL)

Your signature below indicates that you have read and understand the instructions and guidelines for a community event. Further, the person/group named in this application will be responsible for the conduct of the group and for the condition of the reserved area. Falsification of information on the application will result in forfeiture of up to \$200 per falsified item.

In addition to the rules and regulations detailed in the permit application instructions and guidelines, Street Use Permits are subject to all applicable ordinances, statues and laws.

Signature Allyson Crowley

Date 11/8/12

RACE DAY SCHEDULE

Saturday, June 2, 2012 on Willow Island at the Alliant Energy Center

6:00 a.m.	Registration
7:45 a.m.	Survivor Photo
8:00 a.m.	Welcome Remarks & Aerobic Warm-up
8:20 a.m.	Chipped Timed 5K Run Starts
8:30 a.m.	5K Run Starts
8:45 a.m.	5K Walk Starts
9:15 a.m.	1.25 Mile Walk Starts
10:15 a.m.	Awards Program

Participants without a timing chip are not eligible for prizes

Race Day Safety

Safety is our first priority. Please pin your bib number on the front of your t-shirt. For the safety of all participants, rollerblades and pets are discouraged from participating in this event. Thank you for your cooperation. **Participants with strollers are invited to participate in the 5K Walk and 1.25 Mile Walk. Strollers are not allowed in the 5K Run.** There are no exceptions.

Cancellation Policy

This event will occur rain or shine. We reserve the right to cancel in extreme circumstances. In that event, there will be no refund, rather your entry fee will be used as a donation to the Susan G. Komen South Central Wisconsin Race for the Cure®.

FREE Shuttle Service

Avoid traffic delays by enjoying one of our two free shuttle services. Badger Bus Lines busses will be running continuously from WPS located at 1717 W. Broadway, Madison and from Arbor Gate Towers located directly off of Todd Drive at 2501 W. Beltline Hwy. The shuttles will begin at 6 am and run until noon on Race day.

Parking

Parking is FREE for this event. Please use the two entrances off Rimrock Road. You may access these from John Nolen Drive and Rimrock Road. Visit komensouthcentralwi.org to view and download a map. Carpooling is encouraged, and bike racks will be available. **Please arrive early.**

Race Course Map

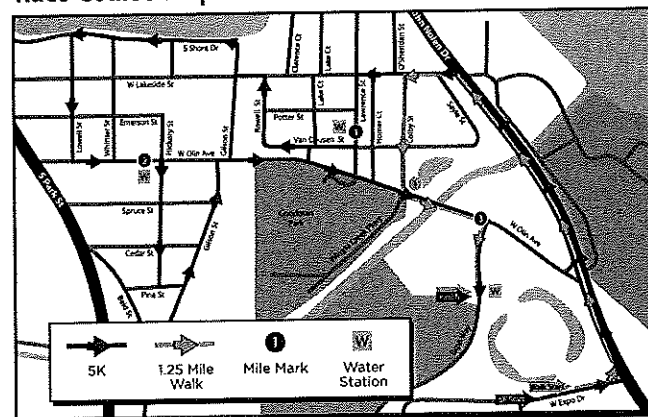

Brochure will be up- →
dated with June 1, 2013
event date.

Note: All roads →
will be open for
normal use ~10:30am

SUSAN G. KOMEN SOUTH CENTRAL WISCONSIN RACE FOR THE CURE®

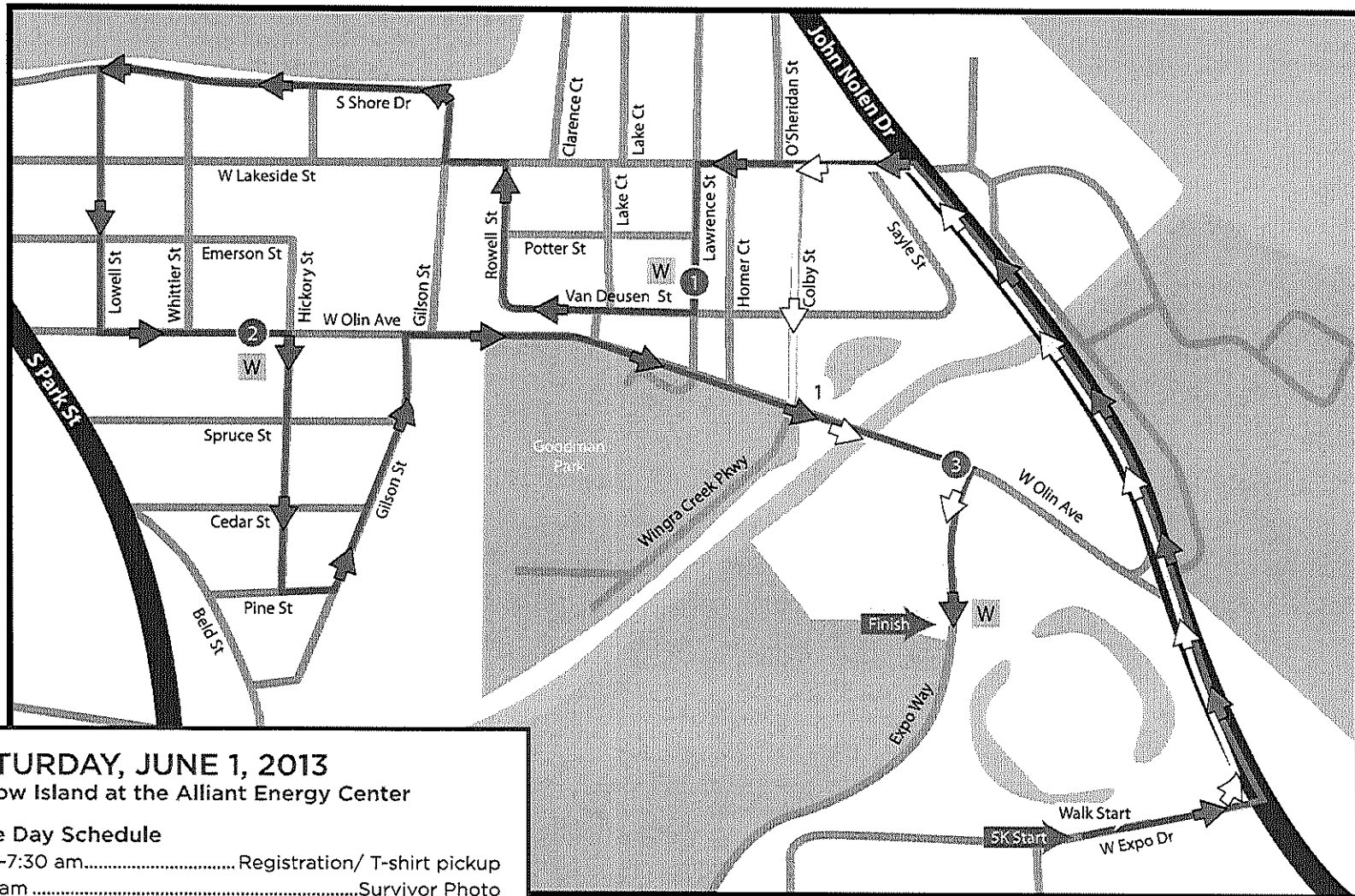

SATURDAY, JUNE 1, 2013
 Willow Island at the Alliant Energy Center

Race Day Schedule

6:00-7:30 am	Registration/ T-shirt pickup
7:45 am	Survivor Photo
8:00 am	Welcome Remarks, Aerobic Warm-up
8:20 am	Chipped Timed 5K Run Starts
8:30 am	5K Run Starts
8:45 am	5K Walk Starts
9:15 am	1.25 Mile Walk Starts

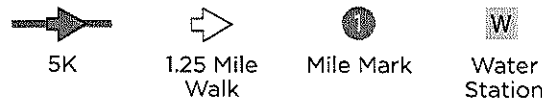

KOMEN SOUTH CENTRAL WISCONSIN RACE FOR THE CURE VILLAGE

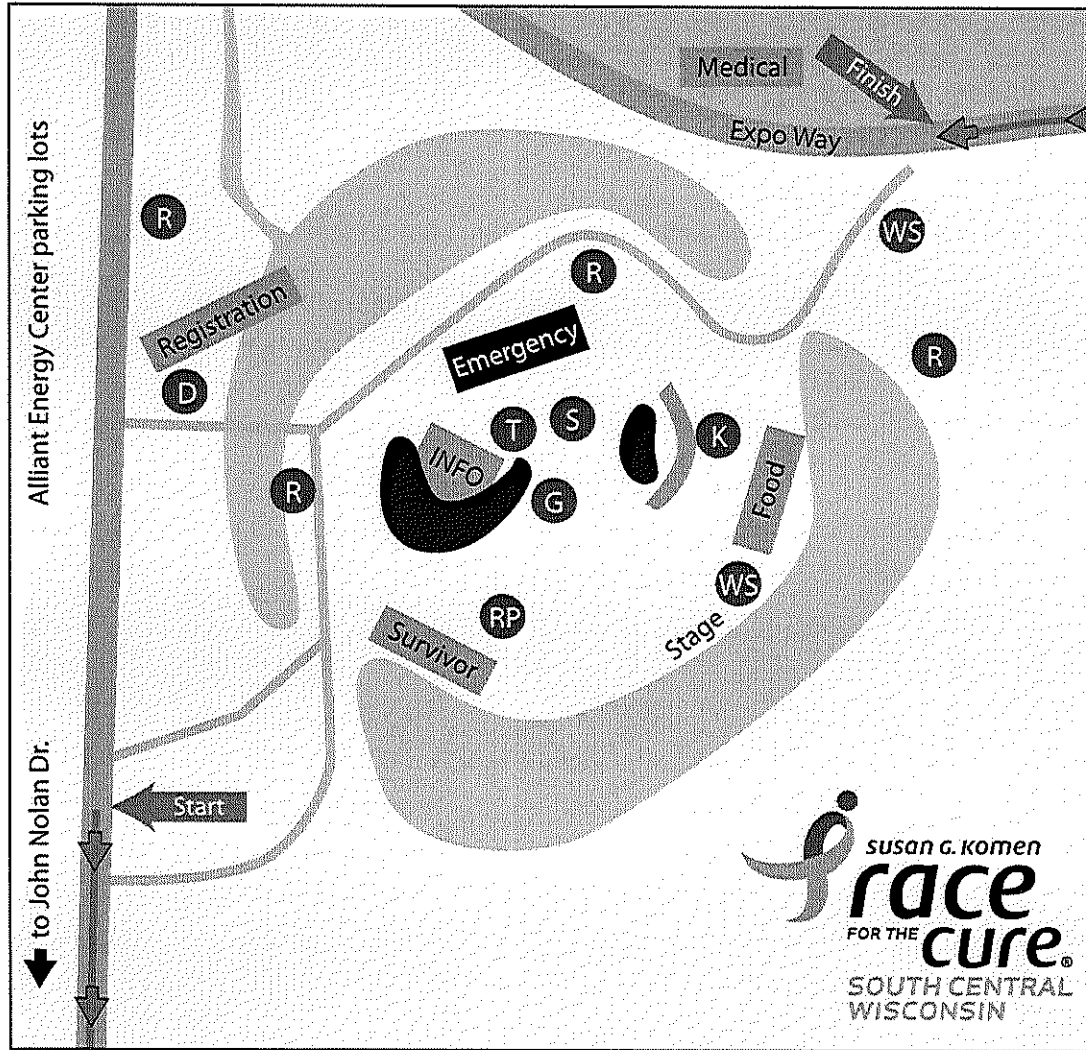

- | | | |
|----------------------------|--------------------------------------|--|
| S Sponsor Expo | RP Ribbon Project | R Restroom |
| WS Water Station | T Teams | K I AM THE CURE
Promise Shop
Women Rock |
| D Donation Drop Off | G Community Grant
Partners | |

Susan G. Komen South Central Wisconsin Race for the Cure

Willow Island at the Alliant Energy Center and Surrounding Streets

June 1, 2013

Safety and Security Plan

Traffic Control: Coverage will be provided at major intersections by both the Dane County Sheriff's office and the City of Madison police. Traffic will be assisted by barricades and electronic signs assembled and managed by a local barricade contractor.

At all other intersections, volunteers will direct runners. Additionally, a volunteer Course Marshal will be on the course to supervise and will have radio communication available should any emergencies arise.

Safety: A central command post will be located on Willow Island at the Alliant Energy Center, and will be staffed by law enforcement personnel. All volunteer captains and Komen staff will be trained on use and protocols for radio communication so participants have a safe event. Additionally, a Medical Tent staffed with medical personnel, and an ambulance, will be stationed near the finish line of the race for any participants who need attention. Finally, we plan to have additional vehicles on site to assist our ambulance on the race course if needed.

Recycling Plan

All refuse will be cleaned up by race day volunteers and staff and brought to the Alliant Energy Center, where it will be recycled or disposed of by Alliant Energy Center staff. Any recyclable items used on the Alliant Energy Center premises will be deposited in recycling bins placed on Willow Island and surrounding areas.



Komen South Central WI Affiliate
8030 Excelsior Drive, Suite 306
Madison, WI 53717
608.836.1083 800.435.3405
www.komensouthcentralwi.org

Memorandum of Understanding – 2013

In preparation for our 16th Annual Race for the Cure, Susan G. Komen for the Cure South Central Wisconsin, we offer the following assurances:

- We will notify Bay Creek residents about the June 1, 2013 Race for the Cure by:
 - Placing reminders in the Bay Creek Bulletin year-round
 - Working cooperatively with Alderperson Ellingson’s office to mail an informative postcard to Bay Creek Neighbors one month prior to the Race
 - Hand delivering door hangers with detailed Race information, course map, and contact information to Bay Creek residents two weeks prior to the Race
 - Distributing Race information, course map, and contact information via the Bay Creek yahoo group to which we currently subscribe
- We will work with the appropriate City of Madison departments to ensure smooth road closure where necessary and reopen those streets as quickly as possible on Race day
- We will ensure trash from participants is picked up along the course
- We will post “No Parking” signs along the course the week of the Race
- We will coordinate with volunteers on the race course so that they can appropriately respond to Bay Creek neighbors as to the when, where and how they can exit out of the neighborhood during the event.
- We will ensure that police and race marshals know they can and should stop Komen participants occasionally to allow residents to drive to and from their homes during the event.

In Agreement:

District 13 Alder
Susan Ellingson _____ Date: _____

Susan G. Komen for the Cure
Race Coordinator
Allyson Crowley _____ Date: _____

Susan G. Komen for the Cure South Central Wisconsin
8030 Excelsior Drive, Suite 306, Madison, WI 53717
608-836-1083 www.komensouthcentralwi.org
Race Coordinator: Allyson Crowley racecoor@komensouthcentralwi.org