

Mailed 3/28/08

## NOTICE OF PUBLIC HEARING

The Common Council of the City of Madison having before it for consideration a proposed ordinance relating to zoning and city planning.

NOTICE IS HEREBY GIVEN, that a public hearing will be held in the Council Chambers, Room 201, in the City-County Building on Monday, April 7, 2008 before the Plan Commission, where opportunity will be afforded to all interested in being heard; and on Tuesday, April 22, 2008 at 6:45 p.m. before the regular meeting of the Common Council, at which time action on the ordinance will be considered.

**Public Hearing items may be called at any time after the beginning of the Plan Commission public hearings – 6:00 pm. Anyone wishing to speak on an item must fill out a registration slip and give it to the person running the meeting. The registration slips are on a table near the front of the meeting room, just inside the doors to the room.**

**The Plan Commission uses a "consent agenda", which means that the Commission can consider any item at 6:00 pm, if there are no registrants wishing to speak in opposition regardless of where the item is listed on the agenda".**

THE PROPERTY TO BE REZONED IS LOCATED AT 9305-9347 Elderberry Road

1. Ordinance ID#: 09342  
Sponsor: Common Council By Petition

The Common Council of the City of Madison do hereby ordain as follows:

1. Paragraph 3343. of Subdivision (a) of Subsection (2) of Section 28.06 of the Madison General Ordinances is hereby created to read as follows:

"28.06(2)(a)3343. The following described property is hereby omitted from the Temp A Temporary Agriculture District and added to the R2T Single-Family Residence District: Being a part of the NW ¼ of the SE ¼ and the NE ¼ of the SW ¼ of Section 21, T7N, R8E, City of Madison, Dane County, Wisconsin, described as follows:

Commencing at the east quarter corner of said Section 21; thence S89°42'40"W along the north line of the SE ¼ of said Section 21, 2,570.26 feet to the center quarter corner of said Section 21; thence S89°42'50"W along the north line of the SW ¼ of said Section 21, 32.53 feet; thence S01°14'47"W along the west line of Lot 1, Certified Survey Map, No. 3232 and the northerly extension thereof, 411.83 feet to the southwest corner of said Lot 1 and the point of beginning; thence N01°14'47"E along the west line of said Lot 1, 58.84 feet; thence N89°42'40"E, 120.56 feet; thence southeasterly along a 15.00 foot radius curve to the right having a central angle of 91°54'20" and whose long chord bears S44°20'10"E, 21.56 feet; thence S01°37'00"W, 207.83 feet; thence S00°05'50"E, 346.52 feet; thence southwesterly along a 15.00 radius curve to the right having a central angle of 80°07'30" and whose long chord bears S39°57'55"W, 19.31 feet; thence S80°01'40"W, 107.14 feet; thence southwesterly along a 25.00 foot radius curve to the right having a central angle of 09°46'50" and whose long chord bears S84°55'05"W, 4.26 feet to a point in the west line of the SE ¼ of said Section 21; thence N01°55'07"E along the west line of the SE ¼ of said Section 21, 543.70 feet to a point in the south line of Lot 1, Certified Survey Map, No. 3232; thence N88°45'47"W along the south line of said Lot 1, 27.67 feet to the point of beginning;

Along with lands commencing at the east quarter corner of said Section 21; thence S89°42'40"W along the north line of the SE ¼ of said Section 21, 1,285.13 feet to the northeast corner of the NW ¼ of the SE ¼ of said Section 21; thence S01°23'29"W along the east line of

Certified Survey Map, No. 3232; thence N01°14'47"E along the west line of said Lot 1, 252.96 feet to the point of beginning;

Along with lands commencing at the east quarter corner of said Section 21; thence S89°42'40"W along the north line of the SE ¼ of said Section 21, 1,285.13 feet to the northeast corner of the NW ¼ of the SE ¼ of said Section 21; thence S01°23'29"W along the east line of the NW ¼ of the SE ¼ of said Section 21, 40.01 feet; thence S89°42'40"W, 387.35 feet to the point of beginning; thence S01°37'00"W, 428.10 feet; thence S89°42'40"W, 90.04 feet; thence N01°37'00"E, 100.55 feet; thence northeasterly along a 15.00 foot radius curve to the right having a central angle of 88°05'40" and whose long chord bears N45°39'50"E, 20.86 feet; thence N89°42'40"E, 75.54 feet; thence N01°37'00"E, 60.04 feet; thence S89°42'40"W, 74.55 feet; thence northwesterly along a 15.00 foot radius curve to the right having a central angle of 91°54'20" and whose long chord bears N44°20'10"W, 21.56 feet; thence N01°37'00"E, 213.32 feet; thence northeasterly along a 25.00 foot radius curve to the right having a central angle of 88°05'40" and whose long chord bears N45°39'50"E, 34.76 feet; thence S89°42'40"W, 110.06 feet; thence southeasterly along a 25.00 foot radius curve to the right having a central angle of 91°54'20" and whose long chord bears S44°20'10"E, 35.94 feet; thence S01°37'00"W, 212.65 feet; thence southwesterly along a 15.00 foot radius curve to the right having a central angle of 88°05'40" and whose long chord bears S45°39'50"W, 20.86 feet; thence S89°42'40"W, 75.49 feet; thence N01°37'00"E, 253.00 feet; thence N89°42'40"E, 240.08 feet to the point of beginning.

Along with lands commencing at the east quarter corner of said Section 21; thence S89°42'40"W along the north line of the SE ¼ of said Section 21, 1,285.13 feet to the northeast corner of the NW ¼ of the SE ¼ of said Section 21; thence S01°23'29"W along the east line of the NW ¼ of the SE ¼ of said Section 21, 995.06 feet to the point of beginning; thence continuing S01°23'29"W along the east line of the NW ¼ of the SE ¼ of said Section 21, 285.12 feet; thence S89°47'24"W, 1,172.27 feet; thence northwesterly along a 100.00 foot radius curve to the right having a central angle of 90°12'36" and whose long chord bears N45°06'18"W, 141.68 feet; thence North, 34.34 feet; thence northwesterly along a 580.00 foot radius curve to the left having a central angle of 10°04'30" and whose long chord bears N05°02'15"W, 101.86 feet; thence northeasterly along a 25.00 foot radius curve to the right having a central angle of 90°06'10" and whose long chord bears N34°58'35"E, 35.39 feet; thence N80°01'40"E, 113.91 feet; thence northeasterly along a 39.00 foot radius curve to the right having a central angle of 09°45'44" and whose long chord bears N84°54'32"E, 6.64 feet; thence N89°47'24"E, 604.74 feet; thence southeasterly along a 15.00 foot radius curve to the right having a central angle of 90°12'36" and whose long chord bears S45°06'18"E, 21.25 feet; thence South 240.06 feet; thence southwesterly along a 30.00 foot radius curve to the right having a central angle of 89°47'24" and whose long chord bears S44°53'42"W, 42.35 feet; thence N89°47'24"E, 120.00 feet; thence northwesterly along a 30.00 foot radius curve to the right having a central angle of 90°12'36" and whose long chord bears N45°06'18"W, 42.50 feet; thence North 429.90 feet; thence N89°47'24"E, 90.00 feet; thence South 115.00 feet; thence S89°47'24"W, 74.94 feet; thence northwesterly along a 15.00 foot radius curve to the right having a central angle of 90°12'36" and whose long chord bears N45°06'18"W, 21.25 feet; thence South 90.00 feet; thence northeasterly along a 15.00 foot radius curve to the right having a central angle of 89°47'24" and whose long chord bears N44°53'42"E, 21.17 feet; thence N89°47'24"E, 454.68 feet to the point of beginning. This parcel contains 10.69 acres, more or less."

TCT: PUB DATES: March 24 & 31, 2008

MARIBETH WITZEL-BEHL, CITY CLERK



Plat Name  
**Woodstone**

Location  
9305-9437 Elderberry Road

Applicant  
Don Heffron - Pheasant Ridge Lots/  
Jason Valerius - MSA

Preliminary       Final

From: Temp A      To: R2T & PUD(GDP)

Proposed Use  
90 Single-Family Lots, 10 Two-Family Lots  
5 Multi-Family Lots & 2 Outlots

Public Hearing Date

Plan Commission  
**07 April 2008**

Common Council  
**22 April 2008**

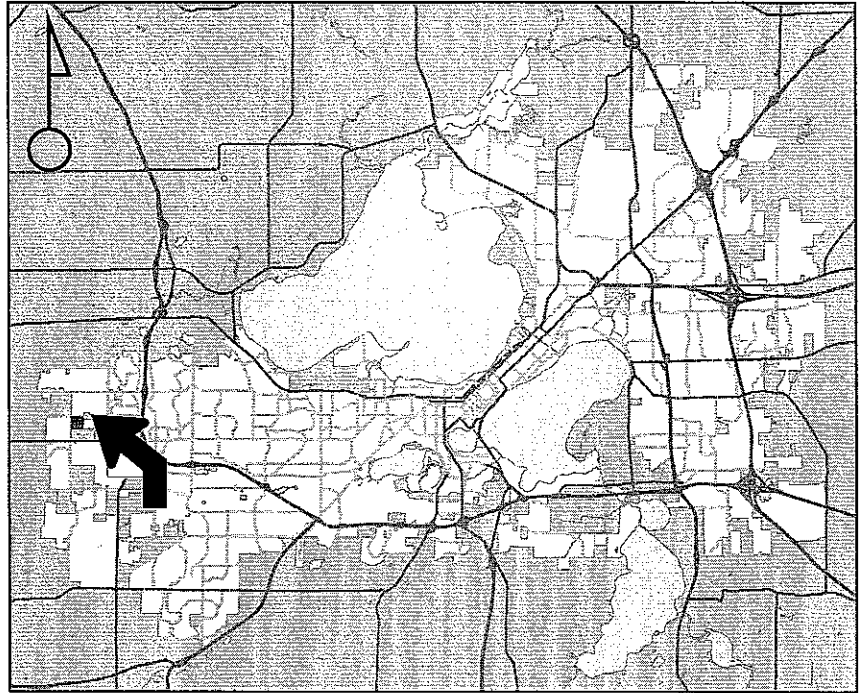

For Questions Contact: Tim Parks at: 261-9632 or [tparks@cityofmadison.com](mailto:tparks@cityofmadison.com) or City Planning at 266-4635

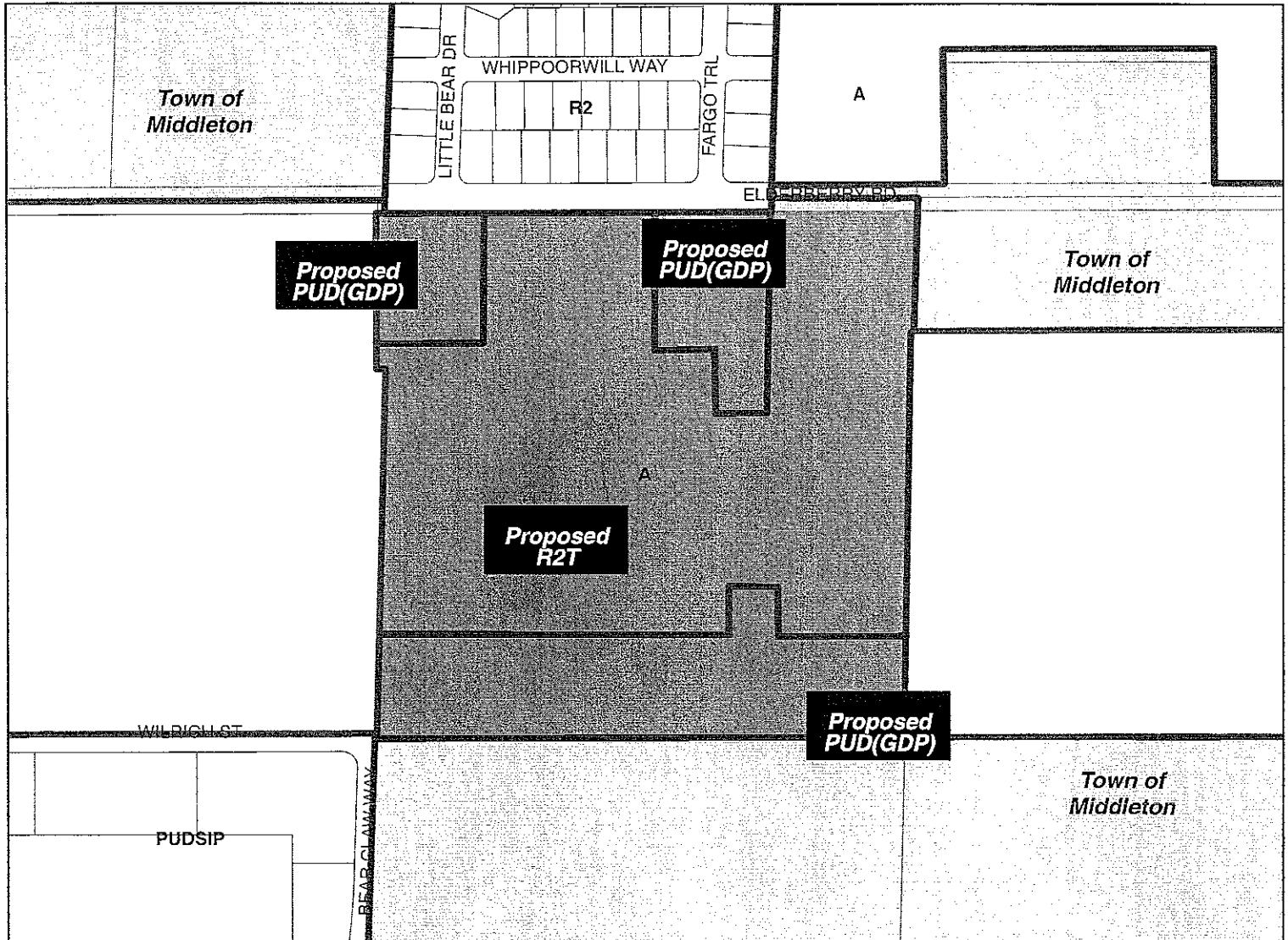

Scale : 1" = 400'

Easy Peel Labels  
Use Avery® TEMPLATE 5960™



Feed Paper

See Instruction Sheet  
for Easy Peel Feature



2/22/38  
D-9



AVERY® 5960™

163

UNIV OF WIS REGENTS  
VAN HISE HALL # 1860  
1220 LINDEN DR  
MADISON WI 53706

9305 Elderberry  
BORAS, LEONARD MICHAEL  
& JAMIE F BORAS  
9401 WHIPPOORWILL WAY  
MIDDLETON WI 53562

DEAN THOMAS HOMES INC  
1233 W MILWAUKEE ST  
STOUGHTON WI 53589

CARLSON, COBY B  
& MARGARET A CARLSON  
9409 WHIPPOORWILL WAY  
MIDDLETON WI 53562

TVEDT, ROLY  
& TRACY TVEDT  
300 WEST RIDGE PARKWAY  
VERONA WI 53593

WEBER DEVELOPMENT LTD  
6442 NORMANDY LN  
MADISON WI 53719

WIRTH, PATRICK M  
& CINDY S WIRTH  
408 LITTLE BEAR DR  
MIDDLETON WI 53562

BILL WEBER JR HOMES INC  
PO BOX 10  
COTTAGE GROVE WI 53572

SUTTLE, JASON J  
& KRISTEN M SUTTLE  
9406 ELDERBERRY RD  
MIDDLETON WI 53562

PARAGON CONSTRUCTION CORP  
579 D'ONOFRIO DR  
MADISON WI 53719

MCATEER, EVAN J & LINDA J  
6534 SHOWER RD  
MAZOMANIE WI 53560

BROWN, JAYSON C  
& DEBRA J WOOD BROWN  
9422 ELDERBERRY RD  
MIDDLETON WI 53562

GADALLA, HANI  
9430 ELDERBERRY RD  
MIDDLETON WI 53562

WEBER, JAMES R & SUSAN K  
6442 NORMANDY LN  
MADISON WI 53719

EDWARDS, EARLE R & JOY A  
613 WOODWARD DR  
MADISON WI 53704

ZIEGLER, LEO A & CAROL K  
5031 CHURCH RD  
MIDDLETON WI 53562

BLACKHAWK EVANGELICAL  
FREE CHURCH INC  
110 N WHITNEY WAY  
MADISON WI 53705

9305 ELDERBERRY RD  
CITY OF MADISON LABELS

Easy Peel Labels  
Use Avery® TEMPLATE 5960™



Feed Paper

See Instruction Sheet  
for Easy Peel Feature



AVERY® 5960™

LAVERNE & RANDALL THEIS  
7093 MINERAL POINT RD  
VERONA WI 53593

JOHN T & GLORIA J ETTER  
7146 ELDERBERRY RD  
MIDDLETON WI 53562

GARFOOT LIVING TR  
7231 W MINERAL POINT RD  
VERONA WI 53593

DAVID SHAW  
TOWN OF MIDDLETON CLERK  
7555 WEST OLD SAUK RD  
VERONA WI 53593

9305 Elderberry Rd  
Town of Middleton  
LABELS



COMMON COUNCIL OFFICE (21)  
LISA VELDRAN  
417 CCB

CITY TRAFFIC ENGINEER  
DAN MCCORMICK  
MMB

DANE COUNTY ZONING ADMIN  
116 CCB

CITY PLANNING & DEVELOPMENT  
MARK OLINGER  
MMB

CITY ENGINEER  
JANET DAILEY  
115 CCB

WATER UTILITY  
AL LARSON  
119 E OLIN AVENUE

BOARD OF EDUCATION  
545 W DAYTON ST  
MADISON WI 53703

AIRPORT DIRECTOR  
DANE COUNTY REGIONAL AIRPORT  
4000 INTERNATIONAL LN  
MADISON WI 53704