

BUSINESS OVERVIEW

Lallande by Bloom
1859 Monroe Street
Madison Wi 53711

Wednesday-Saturday 9am-3pm, 5pm-8pm
Sundays 9am-2pm

Lallande is a quaint cafe brought to you from the creators of Bloom Bake Shop. It is an extension of the 13 year old bakery serving lunch with a little brunch. The space will reopen in the evening offering fromage, charcuterie and lighter fare. The cafe is located next door to the bakery. It is the intent to offer beer, wine, and a curated cocktail menu with NA offerings as well. And of course, there will be dessert, reminiscent of the bakery, but elevated to pair with the charming cafe environment and offerings.

Dishes will include Belgian style waffles; both sweet and savory, steam scrambled eggs with chevre and tomato confit, pain perdu and variety of croques both with meat as well as vegetarian. Smoked fish, hardboiled eggs, pate's with pasture raised meats. Baskets of fresh pastries and breads with jams and spreads. Our menu will reflect the regions bountiful food offerings in a warm environment with the focus on time shared over a delicious meal.

Our lunch program will invite friends and colleagues alike to come in and have a meaningful mid day lunch experience, perhaps a glass of wine and amuse bouche. Roasted chicken, seared salmon, thoughtfully prepared salads and soups. Drawing from our favorite moments spent traveling through Europe we see lunch as an often overlooked opportunity to inhale from a busy morning and exhale into the rest of the day. We want to serve fresh food, prepared in an open kitchen that leaves our diners ready for the day and feeling connected and present.

As the day transitions from early afternoon to evening, after a brief pause in service, Lallande will reopen for evening service of carefully chosen wines and fresh charcuterie highlighting hand selected meats and cheeses both from the region as well as international favorites; pickled vegetables, and fresh breads will round out the fare. The goal is to be a landing pad for diners who may have a dinner reservation at one of our neighboring restaurants, a small bite before heading to a concert or Forward match, or just a light dinner and conversation with a friend or loved one recapping the days events. Small desserts of fresh ice cream, pot de creme, espresso and cake will also be available at that time.

On occasion, perhaps starting on a monthly basis, we will look forward to hosting themed dinners celebrating regional produce, cuisines from different parts of the world or highlighting local farmers. This will be a chance for us to further open our creativity for a night of culinary celebration and flowing customer service.

Staffing : This expansion gives tenured staff the opportunity to grow and expand their resume and skill set. It will also provide opportunity to hire 3-5 additional staff for the company, creating new job opportunities for the community.

Monroe Street : Our intentionality around Lallande was not just to take more space for the bakery, but to create another different, meaningful gathering space for our neighborhood and draw for the Monroe Street community.

Menu

Lallande by Bloom

part bar, part restaurant, part cafe

Wednesday-Saturday

9am-3pm

5pm-8pm

Sunday 9am-2pm

Sample Menu

Breakfast

Viennoiserie :: Croissants, Pain au
Chocolat, Almond Croissant, Morning Bun

Belgium Waffles

sweet

savory

Croques

Monsieur

Madame

Forestier

Forestier Madame

Avocado Toast

Pain Perdu

Eggs

Prosciutto & Parmesan

Smoked Salmon

Chevre & Cherry Tomatoes

Granola. Berries. Yogurt.

Seasonal Vegetables

Two Big Salads

Dessert

Lunch

Seasonal Vegetables

Four Big Salads

Croques

Monsieur

Madame

Forestier

Forestier Madame

Belgium Waffles

sweet

savory

Eggs

Prosciutto & Parmesan

Smoked Salmon

Chevre & Cherry Tomatoes

Dessert

5pm-8pm

Fromage

Charcuterie

Light Fare

Three - Four Desserts

Signature Cocktail Menu

Select Wine

Bottled Beer

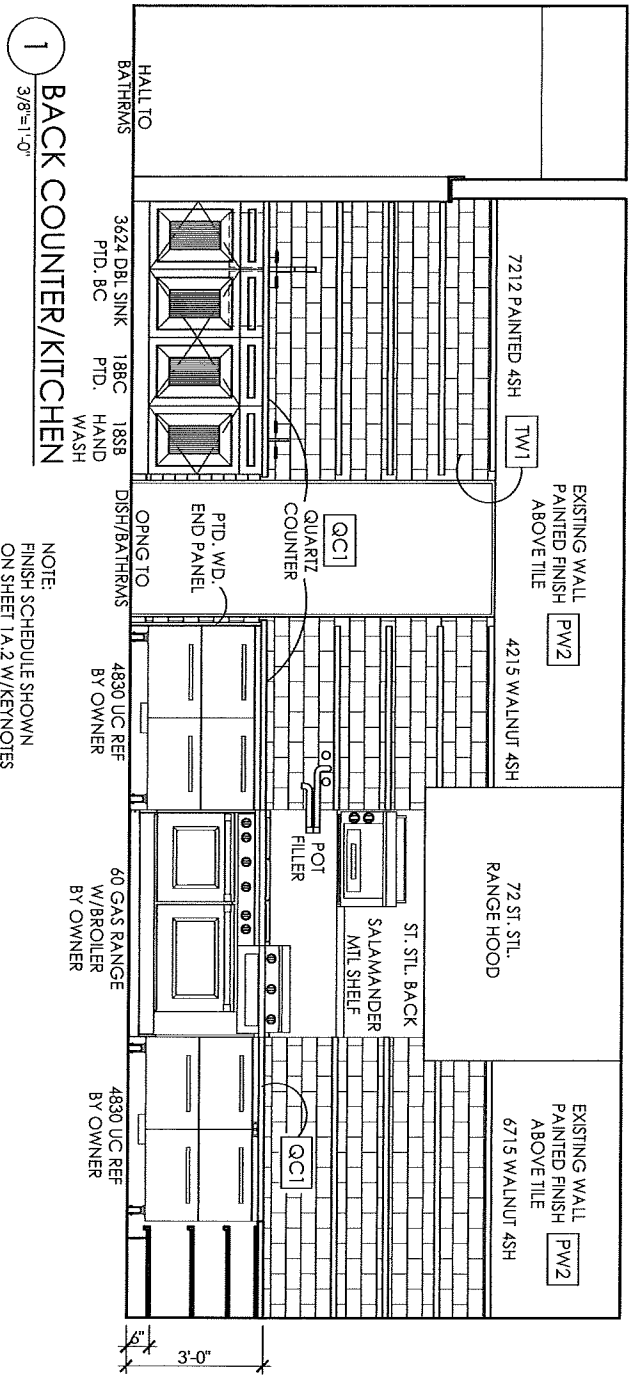

1
3/8"=1'-0"
BACK COUNTER/KITCHEN

NOTE:
FINISH SCHEDULE SHOWN
ON SHEET 1A.2 W/KEYNOTES

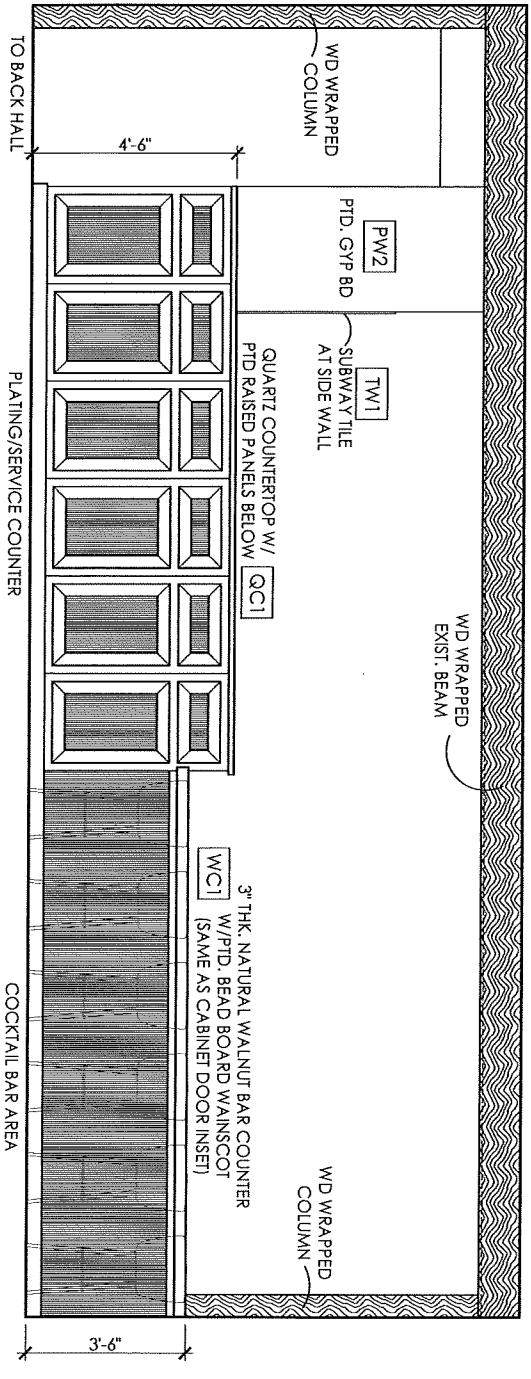

2
3/8"=1'-0"
CUSTOMER SIDE @ BAR SEATING



REVISIONS:

PROJECT:
BLOOM RESTAURANT
1859 MONROE STREET
MADISON, WI

DATE: 11.19.2022
SCALE: AS NOTED
PROJECT NO.: BLO022
SHEET: **3A.1**
INTERIOR ELEVATIONS

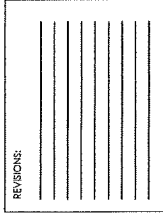
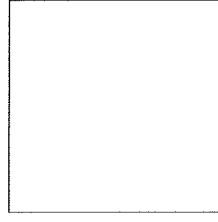

**BLOOM
RESTAURANT**
1859 MONROE STREET
MADISON, WI

PROJECT:

DATE:	11.19.2022
SCALE:	AS NOTED
PROJECT NO.:	BLOO22
SHEET:	2A.1 EQUIPMENT/ FURNITURE PLAN

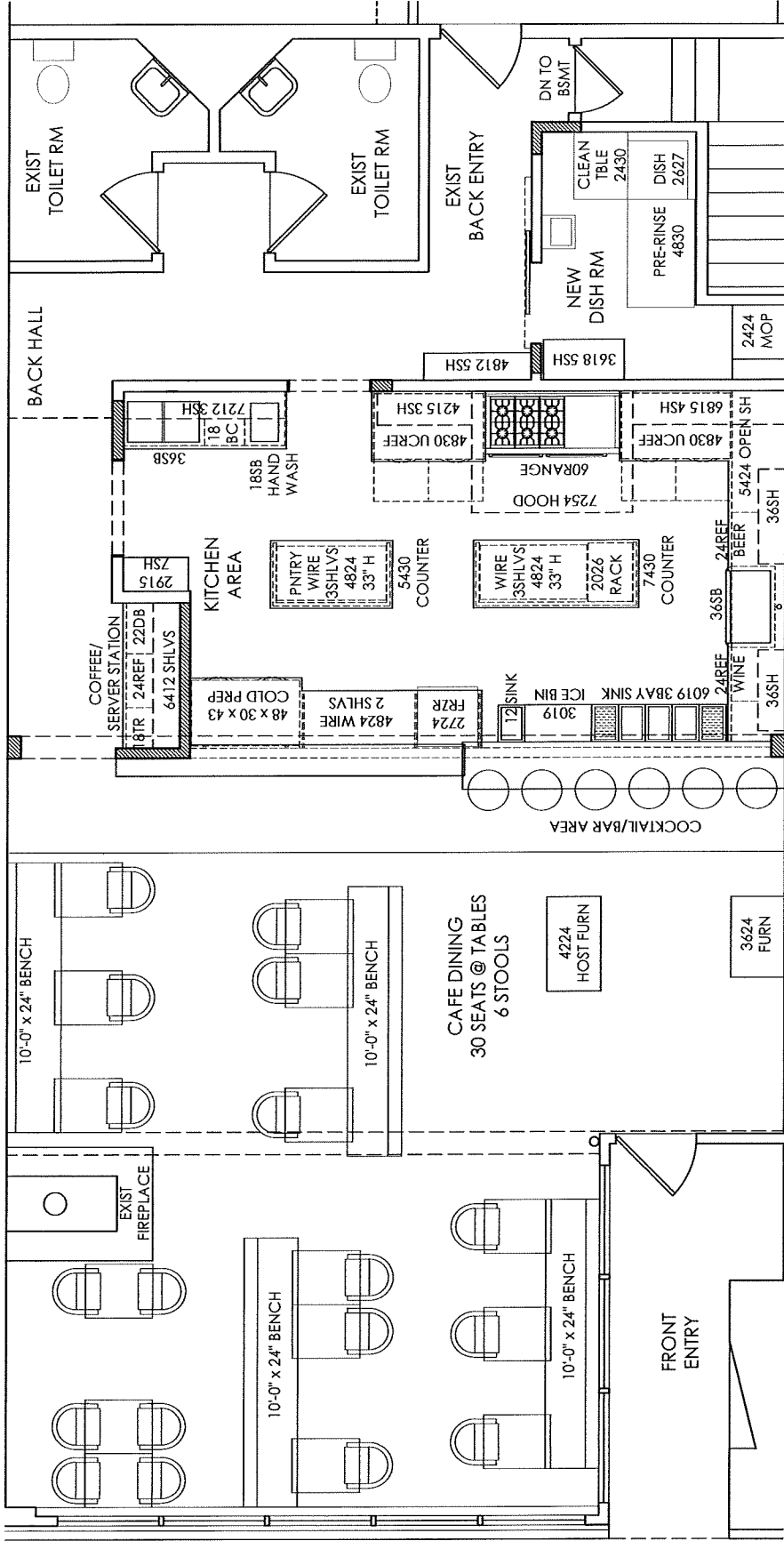

1 FURNITURE/EQUIPMENT PLAN
1/4"=1'-0"

CABINETRY LEGEND

- DB DRAWER BASE
 - BC BASE CABINET (W/DOORS)
 - SB SINK BASE
 - TR TRASH/RECYCLING
 - TC TALL CABINET
 - WC WALL CABINET
 - REF REFRIGERATOR
 - SH SHELF/ADJUSTABLE
- NUMBER BEFORE KEY CODE IS WIDTH IN INCHES FOLLOWED BY DEPTH IF NOT TYP.
WALL CABINET = 12" D.
BASE CABINET = 24" D.

FLOOR PLAN LEGEND:

- NEW PARTITION: 1/2" GWB on 2 x 4 wd. stud interior
- EXISTING WALLS TO REMAIN
- DOOR SCHEDULE KEY
See sheet 1A.1 for door schedule
- INTERIOR ELEVATION REFERENCE
Drawing number/Sheet number
- DIMENSION LINE
Hatch line refers to interior finished face typical
- PLAN KEYNOTE
See sheet 1A.2 for keynotes
- FINISH LEGEND SYMBOL
See sheet 1A.2 for finish schedule

- ###
- 1.#
- TF1