

©2013 Vierblicher Associates, Inc.

11 Mar 2015 - 4:41p M:\T\Wall Enterprises LLC\140245-Wingra Point Phase 2\CADD\140245_Base_eng.dwg by: cguay

GRADING LEGEND

- - - 820 - - - EXISTING MAJOR CONTOURS
- - - 818 - - - EXISTING MINOR CONTOURS
- - - - - SILT FENCE
- - - - - DISTURBED LIMITS
- ⇒ DRAINAGE DIRECTION
- ⊕1048.61 EXISTING SPOT ELEVATIONS
- 1048.61 PROPOSED SPOT ELEVATIONS
- ⊙ INLET PROTECTION
- ▨ TRACKING PAD

SITE PLAN LEGEND

- ▭ PROPERTY BOUNDARY
- ▨ CURB AND GUTTER (REVERSE CURB HATCHED)
- ▨ PROPOSED CONCRETE
- ▨ PROPOSED ASPHALT
- - - - - ADA ACCESSIBLE ROUTE

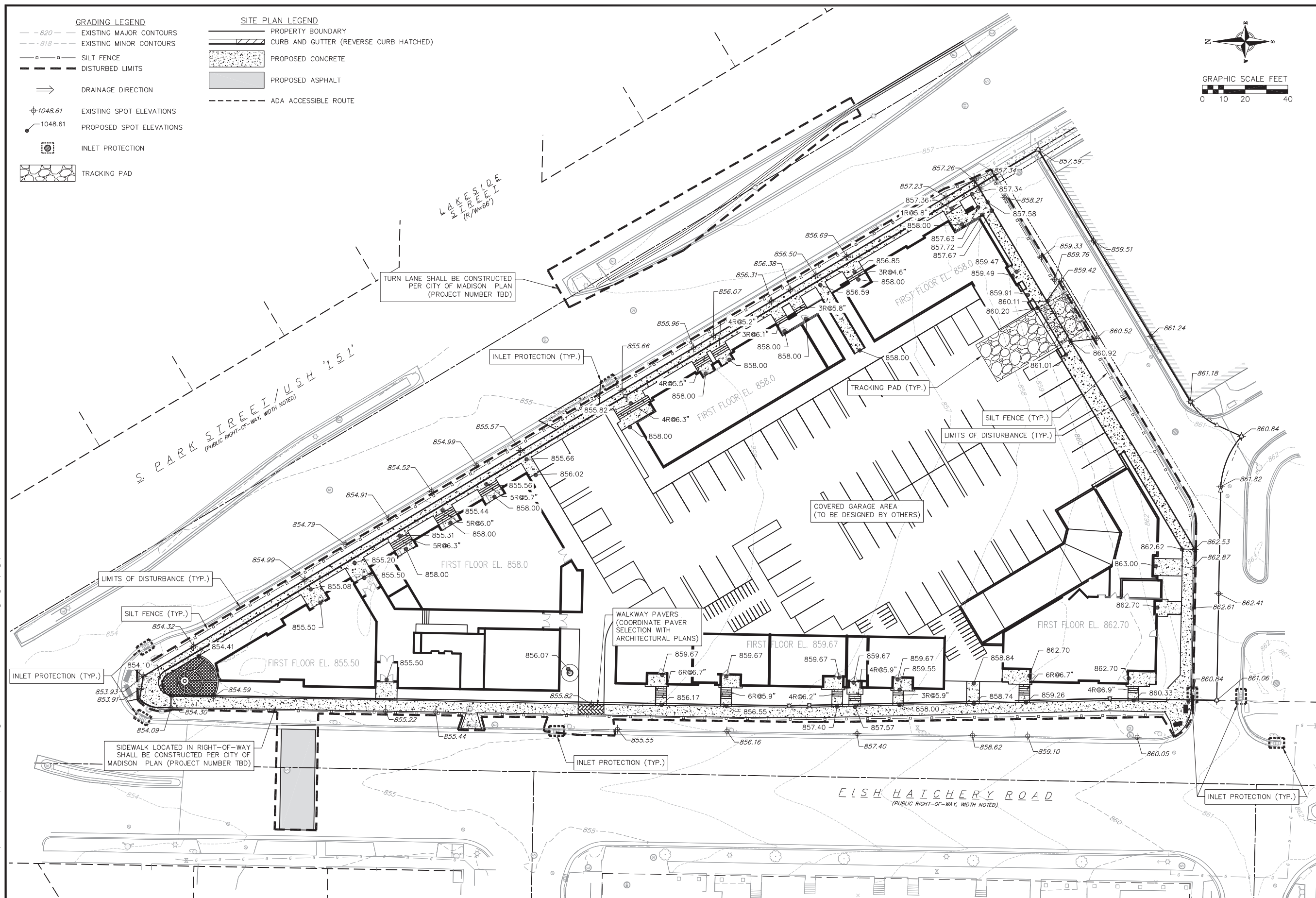
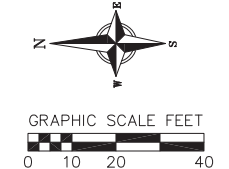

vierblicher
 planners | engineers | advisors
 REEDSBURG - MADISON - PRAIRIE DU CHIEN
 997 Fourth Ave., Suite 200, Madison, Wisconsin, 53717
 Phone: (608) 255-6562 Fax: (608) 255-6560

Grading and Erosion Control Plan
 Wingra Point Phase 2
 City of Madison
 Dane County, Wisconsin

REVISIONS	NO.	DATE	REMARKS
REVISIONS	NO.	DATE	REMARKS
1	3/12/15		SUBMITTAL TO CITY

SCALE AS SHOWN
 DATE 3/12/2015
 DRAFTER CGUY
 CHECKED JFEL
 PROJECT NO. 140245
 SHEET 2 OF 4
 DWG. NO. C-2.0