

ATTACHMENT TO THE CITY OF MADISON

ORDINANCE No. _____
 FILE No. _____
 DATE ADOPTED _____

DATE PUBLISHED _____
 ALD. DISTRICT ATTACHED TO 1st
 AREA 16.6 ACRES OR 0.0259 SQ. MI.

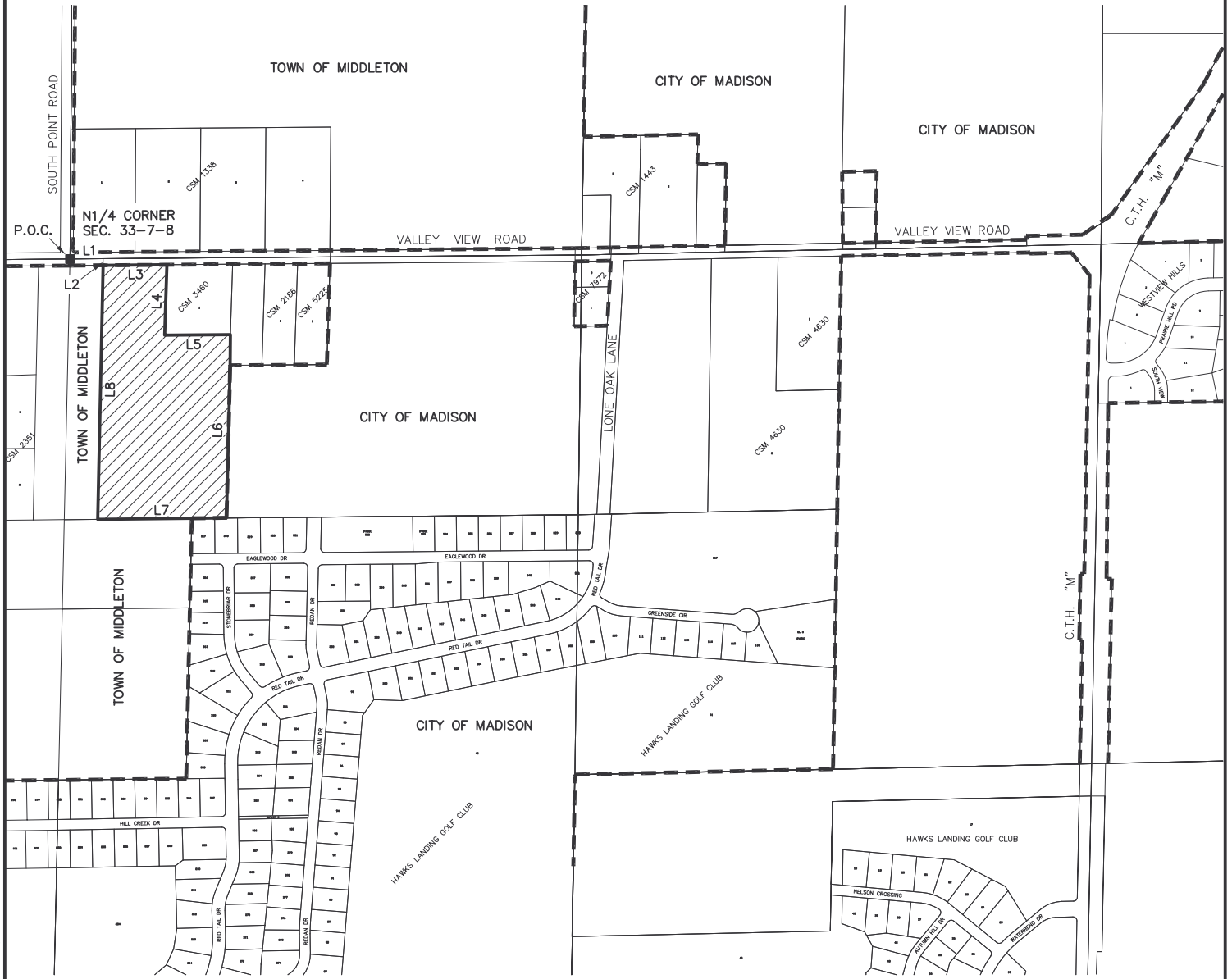

LINE TABLE

NUMBER	DIRECTION	DISTANCE
L1	N 90°00'00" E	172.36'
L2	S 01°49'54" W	33.02'
L3	N 90°00'00" E	320.43'
L4	S 01°49'00" W	358.44'
L5	N 90°00'00" E	334.00'
L6	S 01°49'00" W	931.84'
L7	S 89°55'27" W	654.80'
L8	N 01°49'54" E	1291.16'



SCALE: ONE INCH = EIGHT HUNDRED FEET

KEY

- CITY OF MADISON LIMITS LINE
- ATTACHMENT AREA AND BOUNDARY



BEARINGS REFERENCED TO THE
 NORTH LINE OF THE NE 1/4 OF
 SECTION 33-7-8 RECORDED
 AS N90°00'00"E.