

DANE COUNTY DEPARTMENT OF HIGHWAY AND TRANSPORTATION

CTH BW

(USH 12/18 - FRAZIER AVE)
CITY OF MADISON AND MONONA (SEC. 30)

DANE COUNTY

COUNTY PROJECT NUMBER
68147-2200

END PROJECT
 STA. 13+45.13 "EB"
 N: 472752.726
 E: 829891.700
 STA. 13+55.40 "WB"
 N: 472768.198
 E: 829872.174

PROJECT ID: **68147-2200**

COUNTY: **DANE**

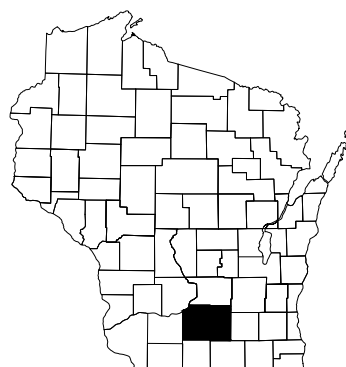

BEGIN PROJECT
 STA. 1+06.73 "EB"
 N: 471820.961
 E: 829208.538
 STA. 1+07.70 "WB"
 N: 471824.340
 E: 829178.822



LAYOUT
 SCALE 0 1 MI
 TOTAL NET LENGTH OF CENTERLINE = 0.235 MI

HORIZONTAL POSITIONS SHOWN ON THIS PLAN ARE WISCONSIN COUNTY COORDINATES, DANE COUNTY, NAD83 (2011), IN U.S. SURVEY FEET. VALUES ARE GRID COORDINATES, GRID BEARINGS, AND GRID DISTANCES. GRID DISTANCES MAY BE USED AS GROUND DISTANCES.

DANE COUNTY HIGHWAY DEPARTMENT



Date: 03/17/2022
 Surveyor: MSA PROFESSIONAL SERVICES INC.
 Designer: DANE CO.

RECOMMENDED FOR APPROVAL:

 Deputy Highway Commissioner

Date: _____
 APPROVED BY:

 County Highway Commissioner

Date: _____
 REVISION DATE:

CONVENTIONAL SYMBOLS		PROFILE	
PLAN		GRADE LINE	
CORPORATE LIMITS		ORIGINAL GROUND	
PROPERTY LINE		MARSH OR ROCK PROFILE (To be noted as such)	
LOT LINE		SPECIAL DITCH	
LIMITED HIGHWAY EASEMENT		GRADE ELEVATION	
EXISTING RIGHT OF WAY		CULVERT (Profile View)	
PROPOSED OR NEW R/W LINE		UTILITIES	
SLOPE INTERCEPT		ELECTRIC	
REFERENCE LINE		FIBER OPTIC	
EXISTING CULVERT		GAS	
PROPOSED CULVERT (Box or Pipe)		SANITARY SEWER	
COMBUSTIBLE FLUIDS		STORM SEWER	
MARSH AREA		TELEPHONE	
WOODED OR SHRUB AREA		WATER	
		UTILITY PEDESTAL	
		POWER POLE	
		TELEPHONE POLE	

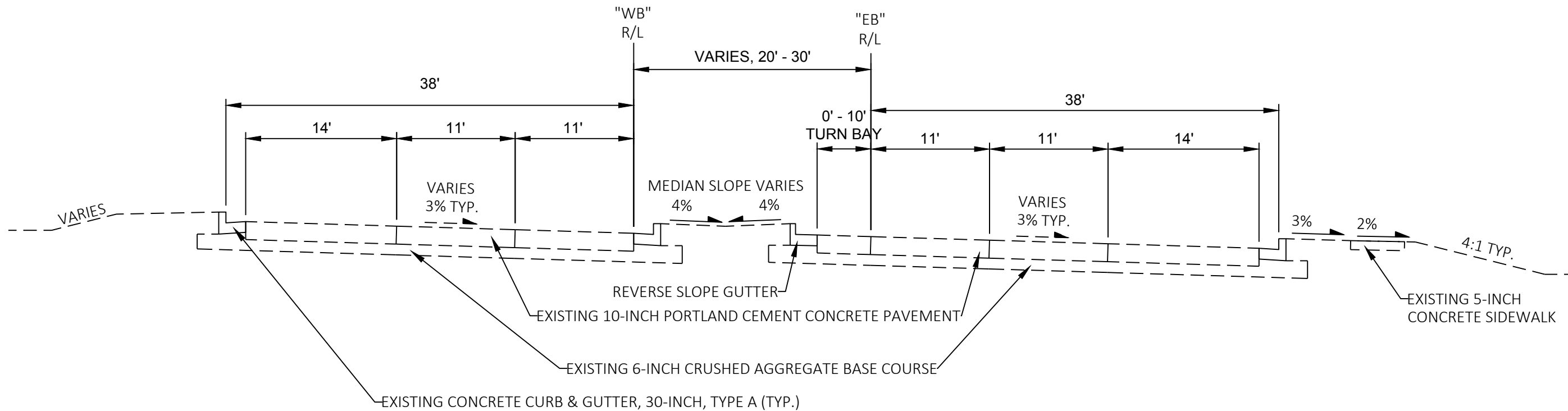

EXISTING TYPICAL SECTION CTH BW, "EB" AND "WB"
STA. 1+00 TO 14+00

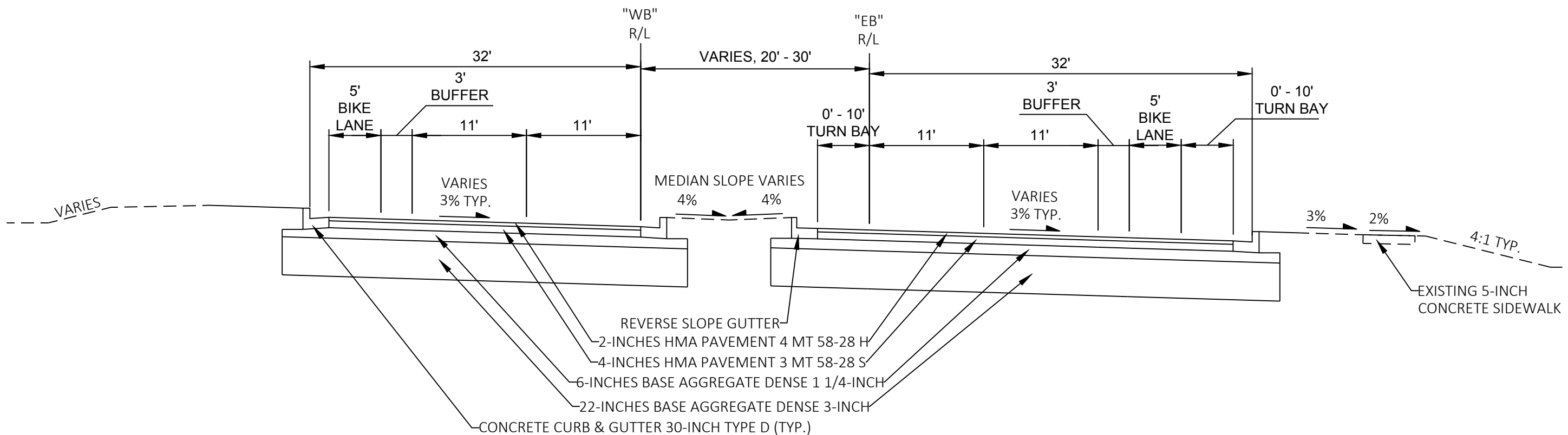

PROPOSED TYPICAL SECTION CTH BW, "EB" AND "WB"
STA. 1+00 TO 14+00

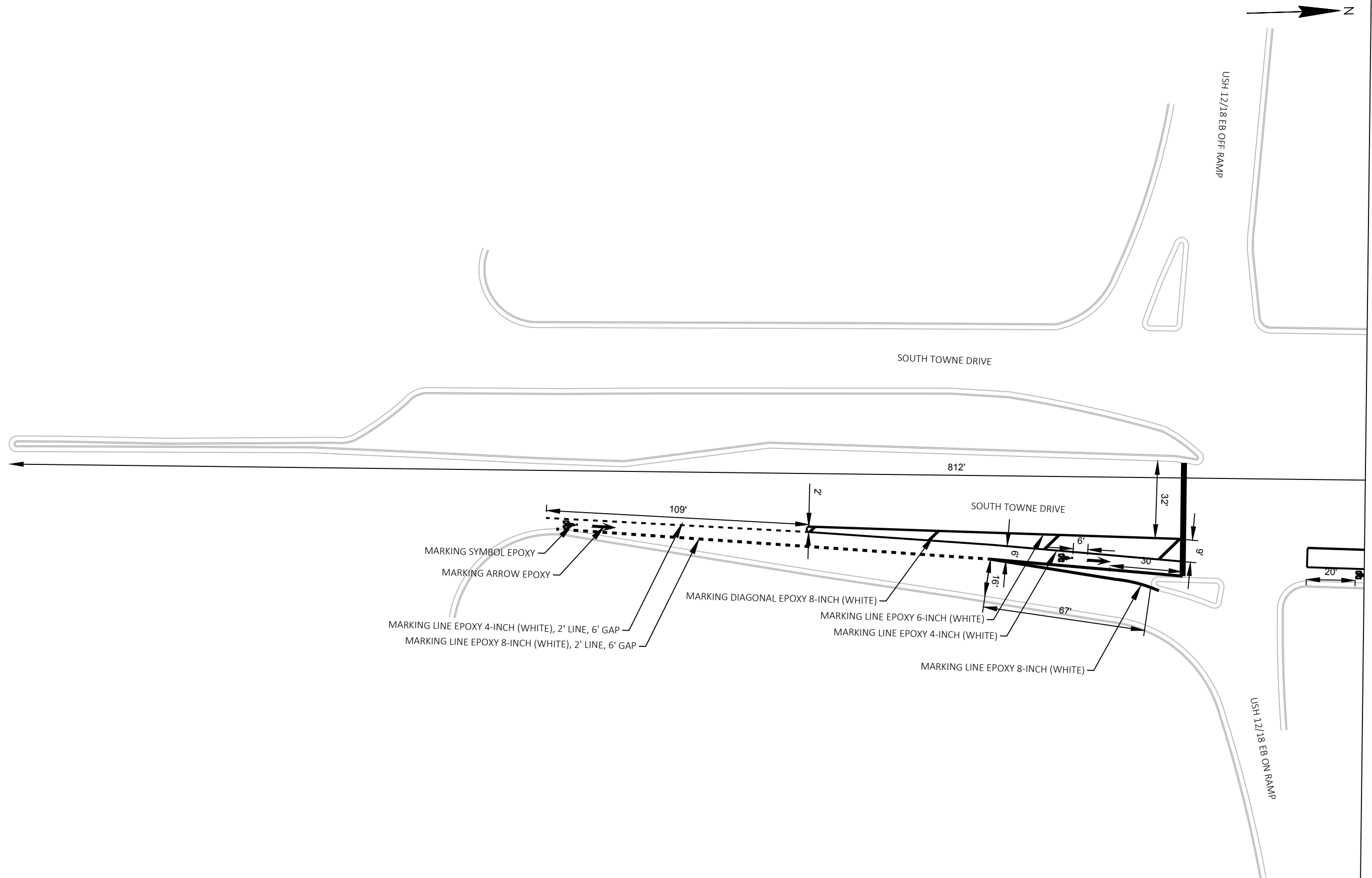

PROJECT NO: 68147-2200

HWY: CTH BW

COUNTY: DANE

PAVEMENT MARKINGS

SHEET

E

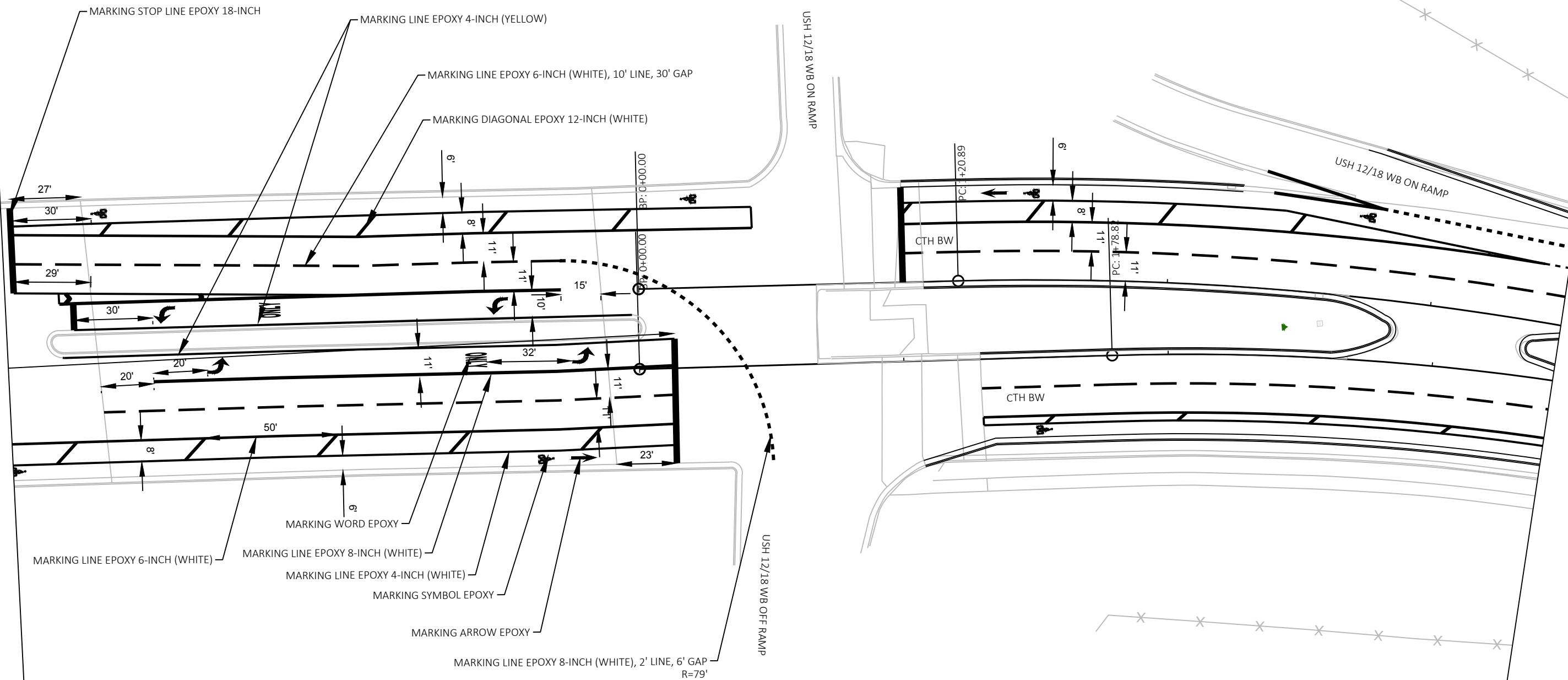

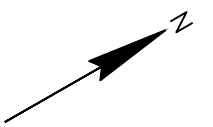

MARKING LINE EPOXY 6-INCH (WHITE)
MARKING LINE EPOXY 4-INCH (WHITE)

RAYWOOD ROAD

PT: 6+48.32

PT: 8+54.96
PT: 8+63.71

CTH BW

CTH BW

MARKING LINE EPOXY 4-INCH (WHITE), 2' LINE, 6' GAP

MARKING LINE EPOXY 8-INCH (WHITE), 2' LINE, 6' GAP

MARKING LINE EPOXY 6-INCH (WHITE), 10' LINE, 30' GAP

MARKING LINE EPOXY 8-INCH (WHITE)

MARKING SYMBOL EPOXY

MARKING ARROW EPOXY

MARKING LINE EPOXY 4-INCH (WHITE)

MARKING DIAGONAL EPOXY 8-INCH (WHITE)

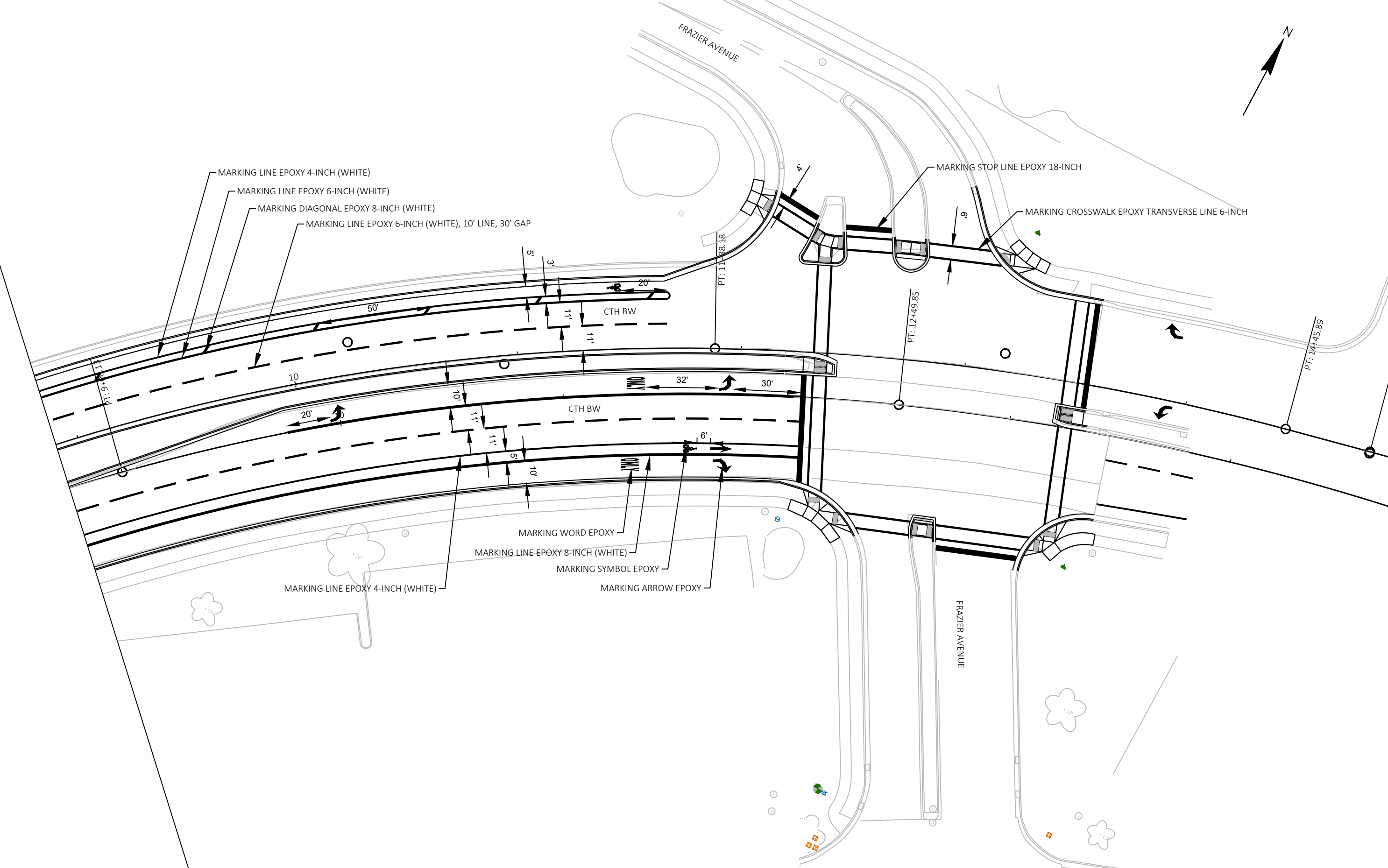
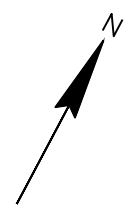

PROJECT NO: 68147-2200	HWY: CTH BW	COUNTY: DANE	PAVEMENT MARKINGS	SHEET	E
------------------------	-------------	--------------	-------------------	-------	---

EROSION CONTROL NOTE:
ALL EXISTING AND PROPOSED INLETS
REQUIRE FRAMED INLET PROTECTION

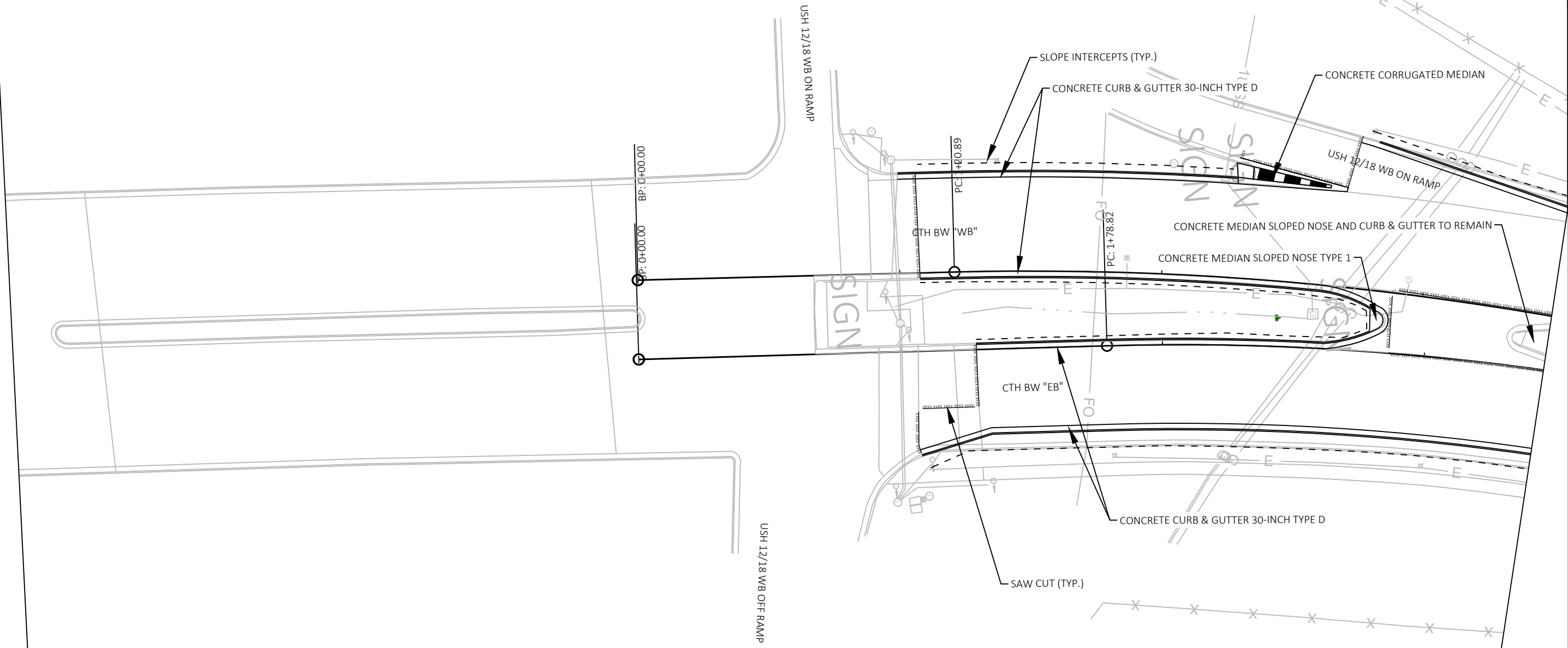

EROSION CONTROL NOTE:
ALL EXISTING AND PROPOSED INLETS
REQUIRE FRAMED INLET PROTECTION

2

2

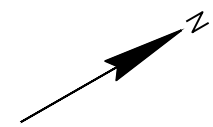

1 INLET 2' X 3'
1 INLET COVER TYPE H
INLET STA. 3+85.69 "WB", 36.44' LT (CURB FLOW LINE)
RIM ELEVATION 881.51
8' CULVERT PIPE REINFORCED CONCRETE CLASS III 12-INCH
INVERT ELEVATION: 880.44
POUR CONCRETE COLLAR AT CONNECTION TO EXISTING STORM SEWER

CONCRETE CURB & GUTTER 30-INCH TYPE D

CTH BW "WB"

CTH BW "EB"

STA. 8+52.19 "EB", 0' RT
END CONCRETE CURB & GUTTER 30-INCH TYPE D
BEGIN TRANSITION TO CONCRETE CURB & GUTTER 18-INCH TYPE D

STA. 6+39.06 "EB", 30' RT
END CONCRETE CURB & GUTTER 30-INCH TYPE D
BEGIN TRANSITION TO CONCRETE CURB & GUTTER 18-INCH TYPE D

STA. 8+34.00 "EB", 37' RT
BEGIN CONCRETE CURB & GUTTER 18-INCH TYPE D

1 INLET 2' X 3'
1 INLET COVER TYPE H
INLET STA. 3+81.31 "EB", 32' RT (CURB FLOW LINE)
RIM ELEVATION 884.261
8' CULVERT PIPE REINFORCED CONCRETE CLASS III 18-INCH
INVERT ELEVATION: 876.962
POUR CONCRETE COLLAR AT CONNECTION TO EXISTING STORM SEWER

1 INLET 2' X 3'
1 INLET COVER TYPE H
INLET STA. 6+27.45 "EB", 32' RT (CURB FLOW LINE)
RIM ELEVATION: 875.516
8' CULVERT PIPE REINFORCED CONCRETE CLASS III 18-INCH
INVERT ELEVATION: 871.804
POUR CONCRETE COLLAR AT CONNECTION TO EXISTING STORM SEWER

CONCRETE CURB & GUTTER 30-INCH TYPE D

EROSION CONTROL NOTE:
ALL EXISTING AND PROPOSED INLETS
REQUIRE FRAMED INLET PROTECTION

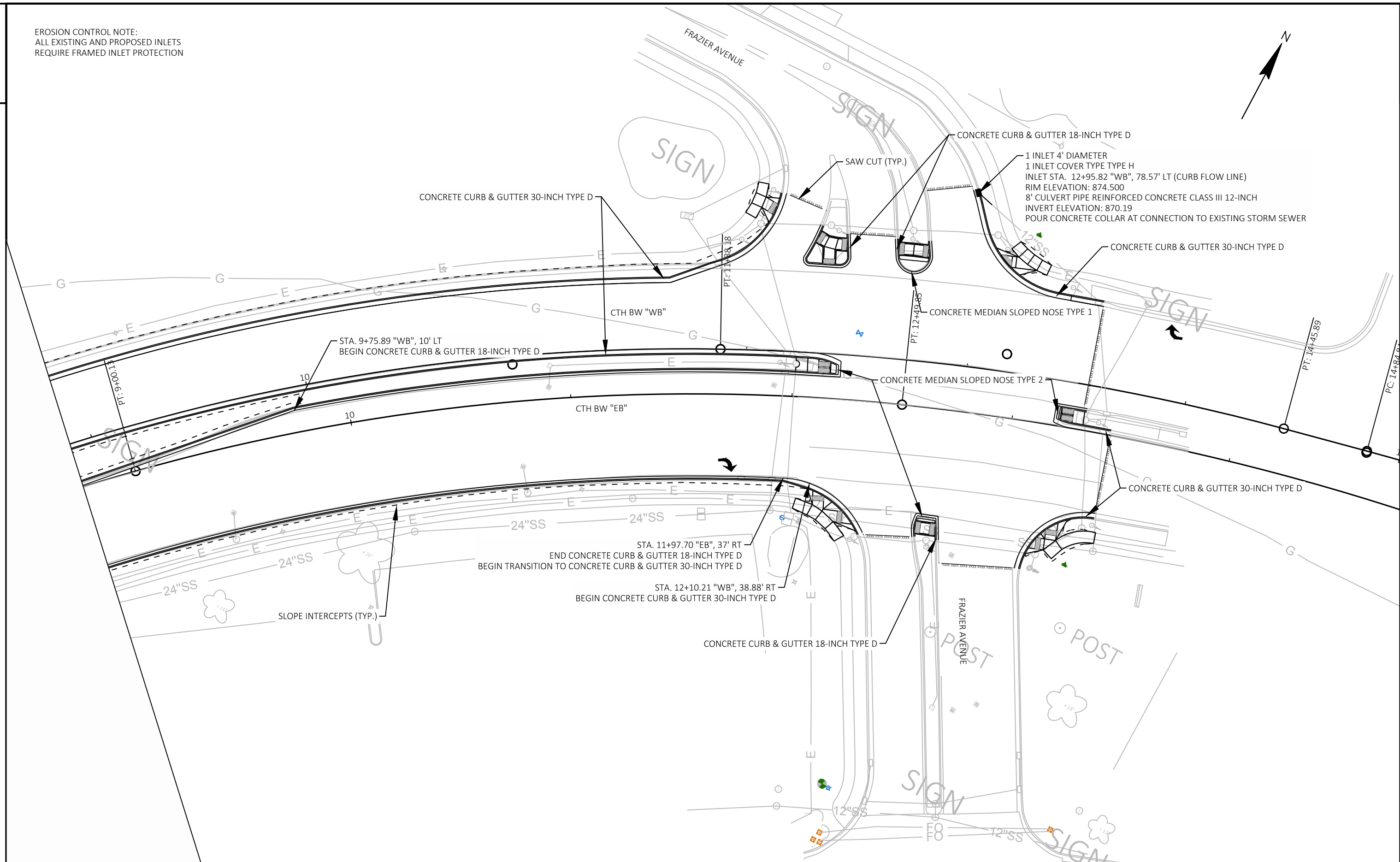
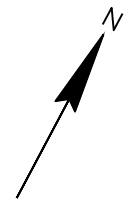

PROJECT NO: 68147-2200	HWY: CTH BW	COUNTY: DANE	PLAN DETAILS	SHEET	E
------------------------	-------------	--------------	--------------	-------	---