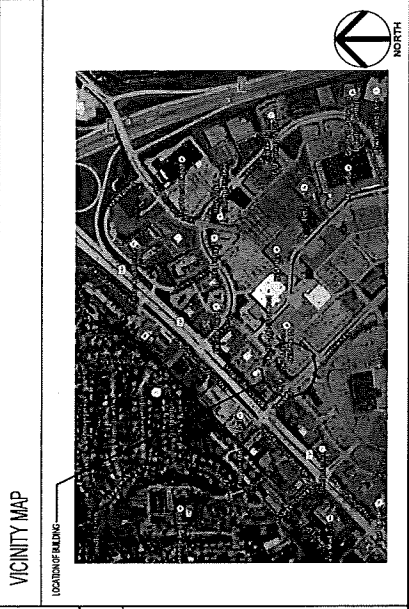
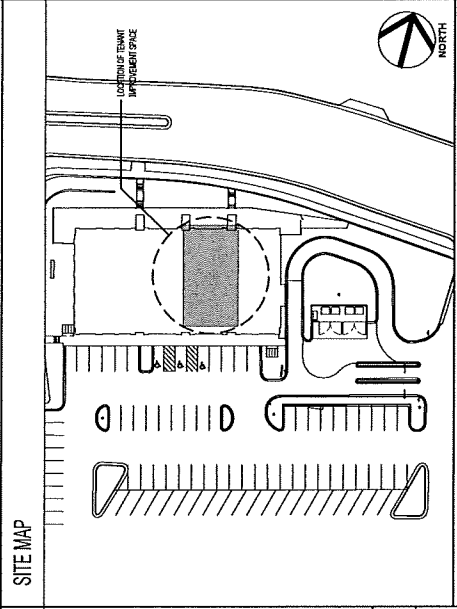

Table with columns for drawing index and drawing number. Row 1: GENERAL, 12.12.17

Table listing drawing titles and sheet numbers. Includes: MECHANICAL, PLUMBING, ELECTRICAL, etc.

PROJECT DIRECTORY table with columns for project name, location, dates, and contact information.



BUILDING CODE INFORMATION table with columns for various code sections like MECHANICAL, PLUMBING, etc.

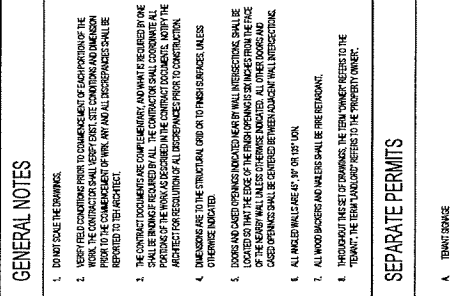

SEPARATE PERMITS table listing items like TEMPT SWIMME, FIRE SPRAWLER, etc.

RESPONSIBILITY LEGEND table with columns for LANDLORD, OWNER, and various trade descriptions.

SCOPE OF WORK table with columns for item description and status (X for included).

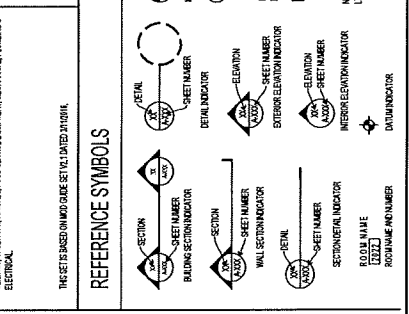

ABBREVIATIONS table with columns for symbol and trade name.

Table with columns for item description and status (X for included).

Table with columns for item description and status (X for included).



2249 ZEIER CT NE
 SUITE 200
 MADISON, VA 53704
DAVID BOTCH
 ARCHITECT

604 COMPANY STREET
 ORLANDO, FLORIDA 32834
 (407) 425-0124
 PROJECT # 2016-0242
 THE INFORMATION ON THIS PLAN IS BASED ON THE INFORMATION PROVIDED BY THE CLIENT AND THE ARCHITECT ASSUMES NO LIABILITY FOR THE ACCURACY OF THE INFORMATION PROVIDED BY THE CLIENT.

EAST TOWNE

2249 ZEIER ROAD
 MADISON, WI 53704

ISSUED / REVISED DATE

02.20.17 PERMIT SET

A-002
 SECTION

PREPARED BY: DEBRAH KYLE

SHEET NOTES

1. ACCESSIBLE ROUTE TO PUBLIC RIGHT OF WAY IS EXISTING.
2. ACCESSIBLE ROUTE BEYOND LEASE LINE TO ACCESSIBLE PARKING IS EXISTING.
3. REFER TO PLAN 11 FOR REMEDIATION SCOPE RELATED TO ASPHALT CONCRETE PAVEMENT AND SEWERLINE.

LEGAL DESCRIPTION

SHEET SYMBOLS

- ACCESSIBLE ROUTE
- ACCESSIBLE ROUTE TO PUBLIC RIGHT OF WAY



SCALE: 1/4" = 1'-0"

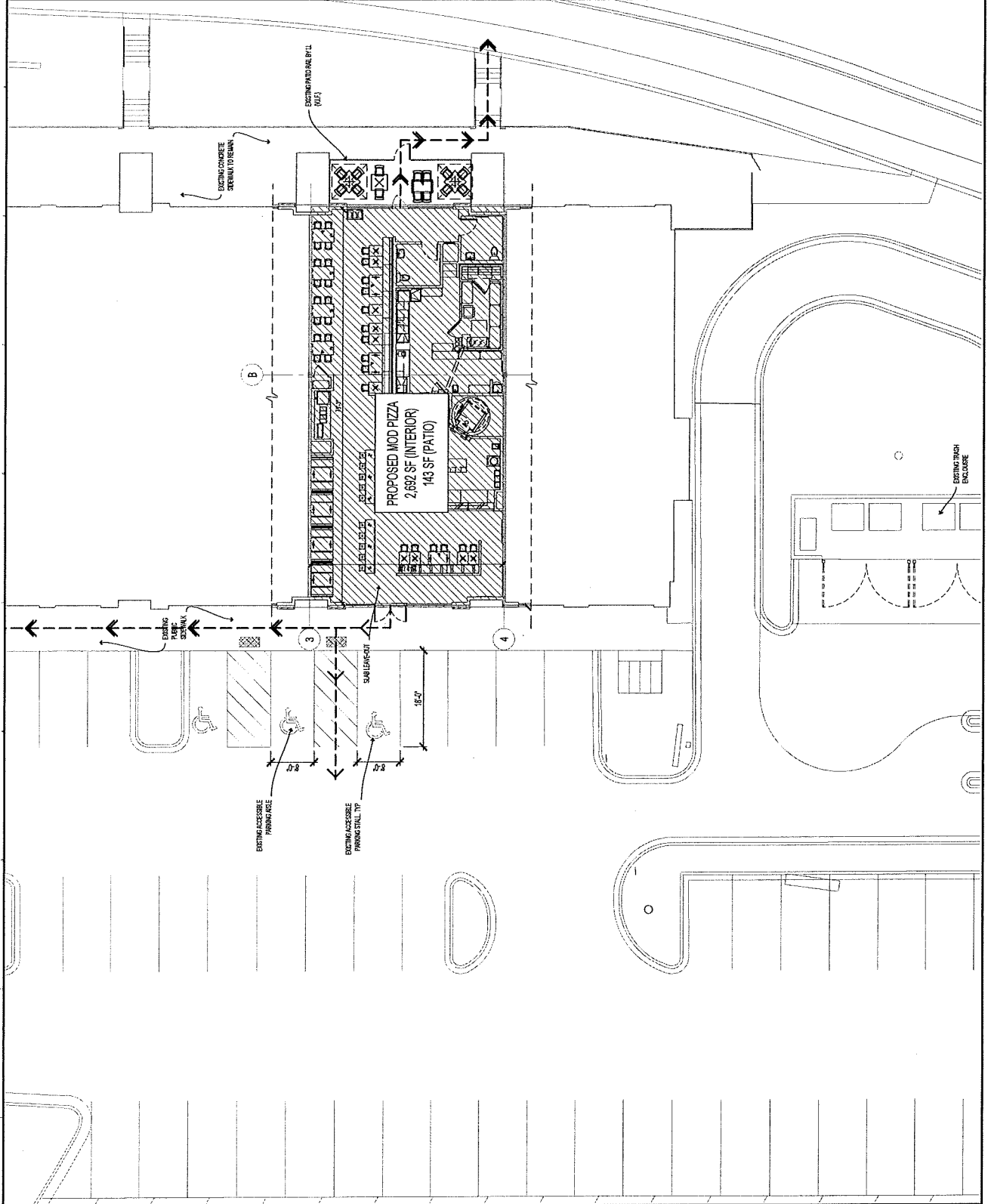



315 UNION
SAR 10
BIRMINGHAM, AL

INTERPLANE

ARCHITECTURE
ELECTRICAL
MECHANICAL
PROJECT MANAGEMENT

115 2ND DUNWOOD AVE
CAMBRIDGE TERRACE, AL 35611
TEL: 205.522.2239
PROJECT # 2016-0421

OWNER: INTERPLANE
DESIGNER: INTERPLANE

WILLOWBROOK
7135 KINGERY HIGHWAY
WILLOWBROOK, IL 60527

CALCULATIONS

OCCUPANT GROUP: ASSEMBLY (A) RESTAURANT
INTERIOR OCCUPANT LOAD (BP) (TABLE 104.2)

| AREA | NO. OF SEATING | NO. OF OCCUPANTS |
|---------------------|----------------|------------------|
| DINING PERCHES | 104 | 104 |
| CLEANING (STANDING) | 15 | 15 |
| KITCHEN | 10 | 10 |
| ACCESSORY | 10 | 10 |
| TOTAL | 139 | 139 |

EXTERIOR OCCUPANT LOAD (BP) (TABLE 104.2)

| AREA | NO. OF SEATING | NO. OF OCCUPANTS |
|-------|----------------|------------------|
| BAR | 10 | 10 |
| TOTAL | 10 | 10 |

INTERIOR SEATING (BP) (TABLE 104.2)

| SEAT TYPE | NO. OF SEATING | NO. OF OCCUPANTS |
|-----------|----------------|------------------|
| BAR | 10 | 10 |
| TOTAL | 10 | 10 |

EXTERIOR SEATING (BP) (TABLE 104.2)

| SEAT TYPE | NO. OF SEATING | NO. OF OCCUPANTS |
|-----------|----------------|------------------|
| BAR | 10 | 10 |
| TOTAL | 10 | 10 |

MOVABLE SEATING

| SEAT TYPE | NO. OF SEATING | NO. OF OCCUPANTS |
|-----------|----------------|------------------|
| BAR | 10 | 10 |
| TOTAL | 10 | 10 |

BOOTHING (BP) (TABLE 104.2)

| SEAT TYPE | NO. OF SEATING | NO. OF OCCUPANTS |
|-----------|----------------|------------------|
| BAR | 10 | 10 |
| TOTAL | 10 | 10 |

TOTAL

| SEAT TYPE | NO. OF SEATING | NO. OF OCCUPANTS |
|-----------|----------------|------------------|
| BAR | 10 | 10 |
| TOTAL | 10 | 10 |

EXTERIOR SEATING (BP) (TABLE 104.2)

| SEAT TYPE | NO. OF SEATING | NO. OF OCCUPANTS |
|-----------|----------------|------------------|
| BAR | 10 | 10 |
| TOTAL | 10 | 10 |

MOVABLE SEATING

| SEAT TYPE | NO. OF SEATING | NO. OF OCCUPANTS |
|-----------|----------------|------------------|
| BAR | 10 | 10 |
| TOTAL | 10 | 10 |

BOOTHING (BP) (TABLE 104.2)

| SEAT TYPE | NO. OF SEATING | NO. OF OCCUPANTS |
|-----------|----------------|------------------|
| BAR | 10 | 10 |
| TOTAL | 10 | 10 |

TOTAL

| SEAT TYPE | NO. OF SEATING | NO. OF OCCUPANTS |
|-----------|----------------|------------------|
| BAR | 10 | 10 |
| TOTAL | 10 | 10 |

EXTERIOR SEATING (BP) (TABLE 104.2)

| SEAT TYPE | NO. OF SEATING | NO. OF OCCUPANTS |
|-----------|----------------|------------------|
| BAR | 10 | 10 |
| TOTAL | 10 | 10 |

MOVABLE SEATING

| SEAT TYPE | NO. OF SEATING | NO. OF OCCUPANTS |
|-----------|----------------|------------------|
| BAR | 10 | 10 |
| TOTAL | 10 | 10 |

BOOTHING (BP) (TABLE 104.2)

| SEAT TYPE | NO. OF SEATING | NO. OF OCCUPANTS |
|-----------|----------------|------------------|
| BAR | 10 | 10 |
| TOTAL | 10 | 10 |

TOTAL

| SEAT TYPE | NO. OF SEATING | NO. OF OCCUPANTS |
|-----------|----------------|------------------|
| BAR | 10 | 10 |
| TOTAL | 10 | 10 |

EXTERIOR SEATING (BP) (TABLE 104.2)

| SEAT TYPE | NO. OF SEATING | NO. OF OCCUPANTS |
|-----------|----------------|------------------|
| BAR | 10 | 10 |
| TOTAL | 10 | 10 |

MOVABLE SEATING

| SEAT TYPE | NO. OF SEATING | NO. OF OCCUPANTS |
|-----------|----------------|------------------|
| BAR | 10 | 10 |
| TOTAL | 10 | 10 |

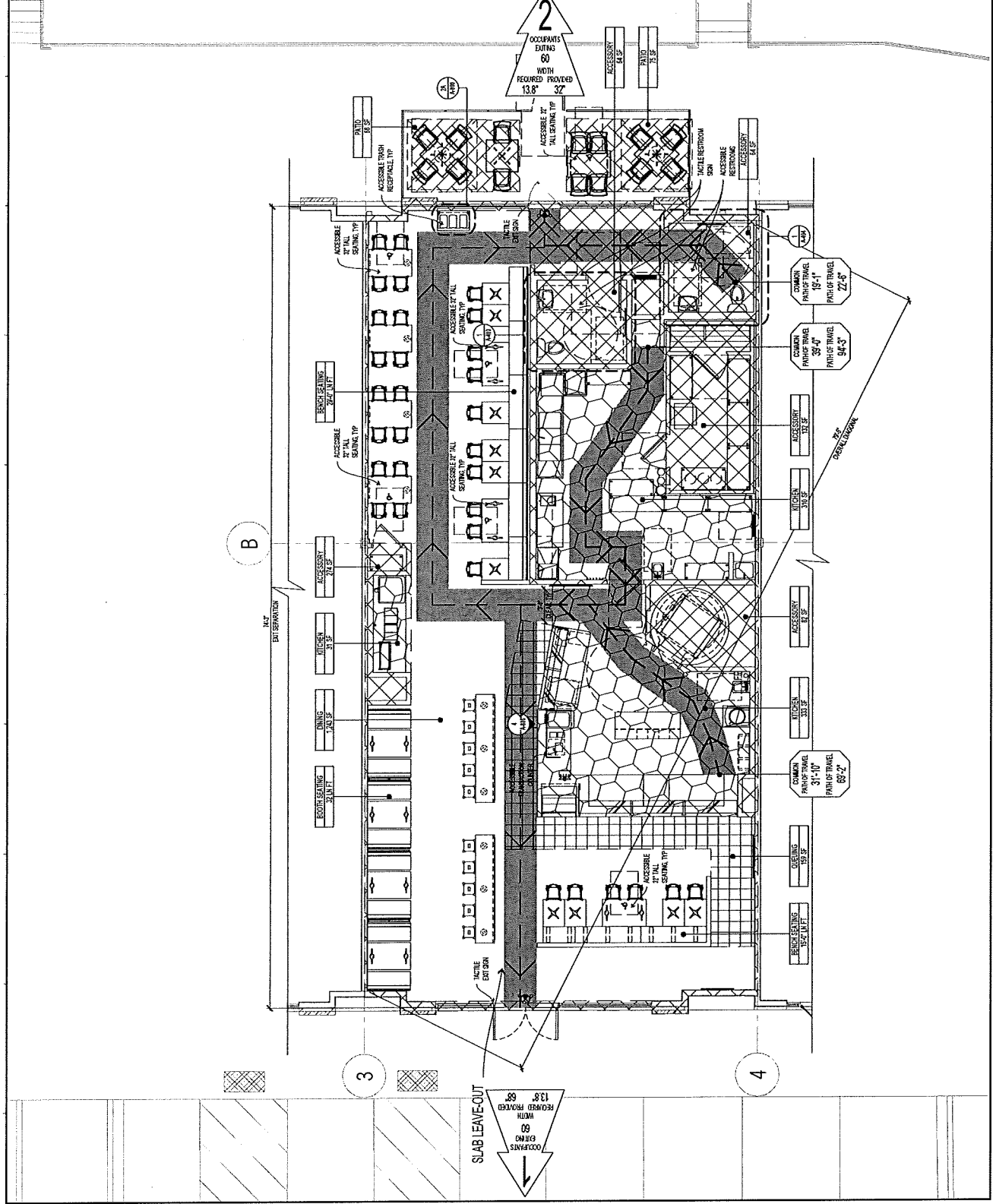

SHEET SYMBOLS

- COMPARISON OF TRASE
- PHOTOFIT TRASE
- WALL MOUNTED PRE-EXTINGUISHERS
- FIRE EXTINGUISHER
- TABLES/SEATING
- SEE DRAWING
- ELECTRICAL SYMBOLS

SCALE: 1/4" = 1'-0"
NORTH
A-003
LEGEND, OCCUPANCY, ACCESSIBILITY
DATE: 10/18/16

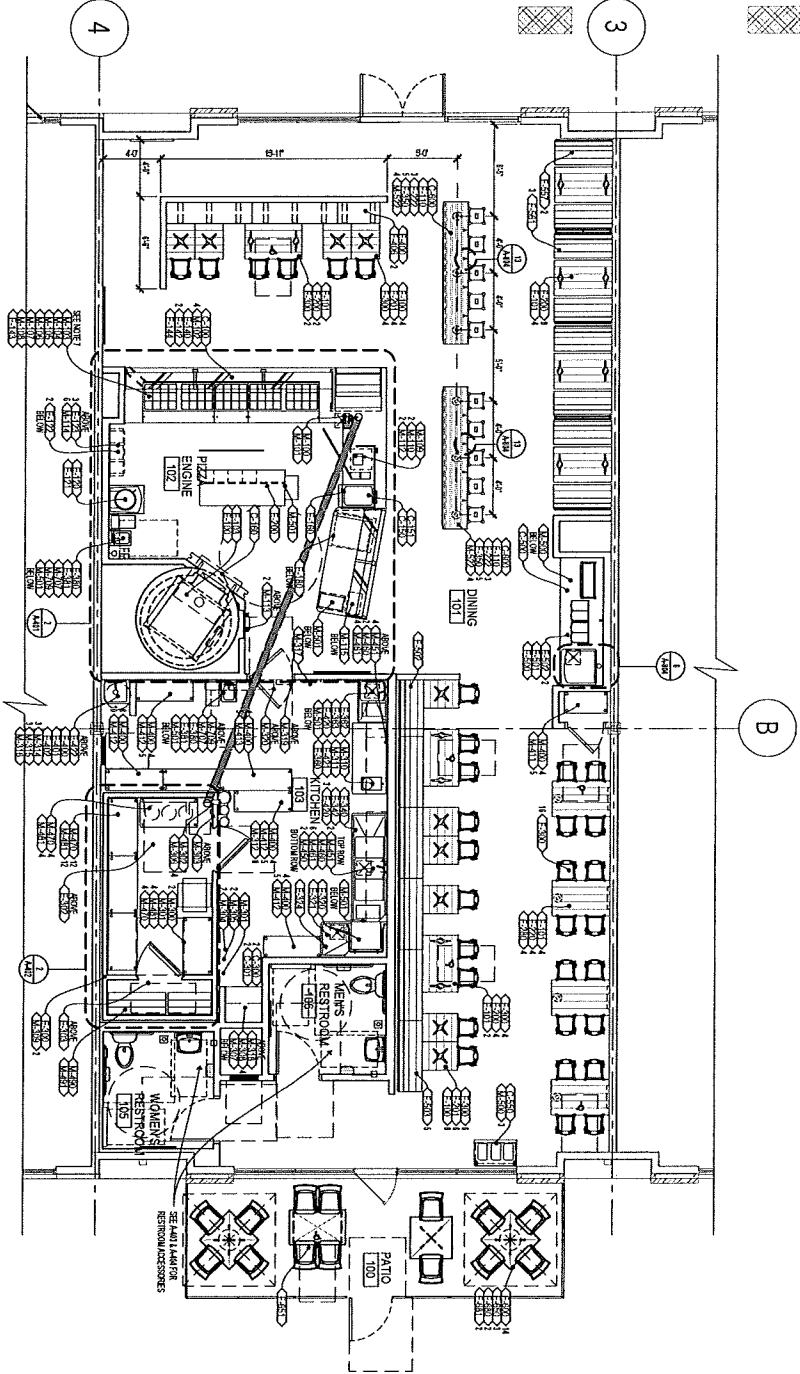

SHEET NOTES

1. REFER TO SCHEDULE ASSIGNMENT SCHEDULE FOR SCOPE OF WORK.
2. REFER TO RESTROOM PLUMBING AND ELECTRICAL SCHEDULES FOR SCHEDULES AND SPECIFICATIONS. SEE ELECTRICAL SCHEDULES FOR SCHEDULES AND SPECIFICATIONS.
3. CONSULT WITH CUSTOMER VENDORS FOR SCHEDULES AND SPECIFICATIONS.
4. CONSULT WITH CUSTOMER VENDORS FOR SCHEDULES AND SPECIFICATIONS.
5. CONSULT WITH CUSTOMER VENDORS FOR SCHEDULES AND SPECIFICATIONS.
6. CONSULT WITH CUSTOMER VENDORS FOR SCHEDULES AND SPECIFICATIONS.
7. REFER TO SHEET A-112 FOR RESTROOM SCHEDULES.
8. ALL ITEMS CONTAINED UNDER THE COMPANY'S RESPONSIBILITY ARE THE RESPONSIBILITY OF THE COMPANY. THE COMPANY SHALL BE RESPONSIBLE FOR THE DESIGN, CONSTRUCTION, AND MAINTENANCE OF ALL ITEMS CONTAINED UNDER THE COMPANY'S RESPONSIBILITY.
9. ITEMS INDICATED TO BE SHOWN AND NOT SHOWN SHALL BE SHOWN AS SHOWN UNLESS INDICATED OTHERWISE.

TABLE FINISH LEGEND

| | |
|--|------------------------|
| | WALNUT |
| | REDAWOOD WOOD, 1/4\"/> |
| | OAK, 1/4\"/> |
| | MAPLE |
| | WHITE |

SHEET SYMBOLS

| | |
|--|---------------------|
| | CABINET, 1/4\"/> |
| | EQUIPMENT, 1/4\"/> |
| | RANGING, 1/4\"/> |
| | APPLIANCES, 1/4\"/> |
| | RESTROOM, 1/4\"/> |
| | SHELVING, 1/4\"/> |



2249 ZIEGLER ROAD
MADISON, VA 22640

DW/D BORCE
ARCHITECT

AAA CONSULTING
10000 WOODBURN ROAD
MADISON, VA 22640
PHONE: 703.428.9124
FAX: 703.428.9124
WWW.AAACONSULTING.COM

EAST TOWNE
2249 ZIEGLER ROAD
MADISON, VA 53704

A-113

DATE: 02.26.17
DESIGNER: PERMITS SET
CHECKED BY: SHAWN KIM

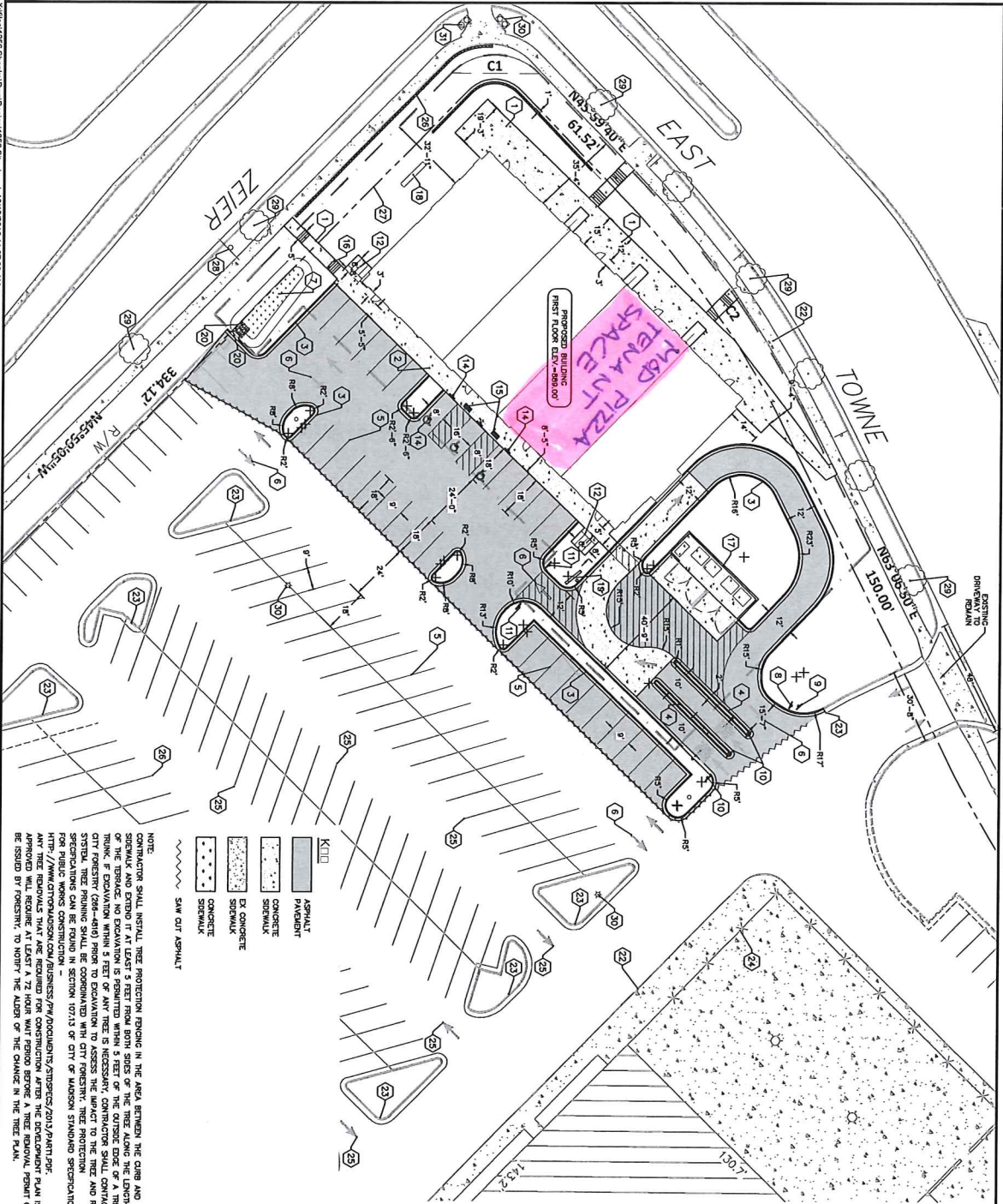

NOTE:
 CONTRACTOR SHALL INSTALL TREE PROTECTION FENCING IN THE AREA BETWEEN THE CURB AND SIDEWALK AND EXPOSE IT AT LEAST 3 FEET FROM BOTH SIDES OF THE TREE ALONG THE LENGTH AND WIDTH OF THE TREE. THE TREE PROTECTION FENCING SHALL BE THE OUTSIDE EDGE OF A TREE TRUNK. IF EXCAVATION WITHIN 5 FEET OF ANY TREE IS REQUIRED, THE CONTRACTOR SHALL NOTIFY THE CITY FORESTRY (564-4816) PRIOR TO EXCAVATION TO ASSESS THE IMPACT TO THE TREE AND ROOT SYSTEM. TREE REMOVAL SHALL BE COMPLETED WITH CITY FORESTRY. TREE PROTECTION SPECIFICATIONS CAN BE FOUND IN SECTION 107.13 OF CITY OF MADISON STANDARD SPECIFICATIONS [HTTP://WWW.MADISON.COM/BUSINESS/PW/DOCUMENTS/ATMOSPHERE/2013/PART09E](http://www.madison.com/business/pw/DOCUMENTS/ATMOSPHERE/2013/PART09E). ANY TREE REMOVALS THAT ARE REQUIRED FOR CONSTRUCTION AFTER THE DEVELOPMENT PLAN IS APPROVED WILL REQUIRE AT LEAST A 72 HOUR WAIT PERIOD BEFORE A TREE REMOVAL PERMIT CAN BE ISSUED BY FORESTRY. TO NOTIFY THE AGENCIES OF THE CHANGE IN THE TREE PLAN.

- KEY:**
- ASPHALT PAVEMENT
 - CONCRETE SIDEWALK
 - EX CONCRETE SIDEWALK
 - CONCRETE SIDEWALK
 - SMV CUT ASPHALT

- PLAN KEY:**
- 1 CONCRETE SIDEWALK
 - 2 RAISED CONCRETE SIDEWALK
 - 3 18" CURB AND GUTTER
 - 4 ROLLED CONCRETE CURB
 - 5 4" PARALLEL STRIPING WITH TWO COATS OF TRAFFIC GRADE LATEX PAINT, TYP
 - 6 TRAPEZOID SECTION STRIPING WITH TWO COATS OF TRAFFIC GRADE LATEX PAINT, TYP
 - 7 BO-ILLUMINATION AREA
 - 8 7' HIGH STOP SIGN
 - 9 DRIVE-IN/OUT ONLY
 - 10 DRIVE-IN/OUT DISTANCE ONLY
 - 11 DO NOT ENTER SIGN
 - 12 U-SHAPED SURFACE MOUNTED BRIDGE RACKS (UNIDEX U180-5'-6) ACCESSIBLE STALL, TYP.
 - 13 ACCESSIBLE PARKING STALL
 - 14 ACCESSIBLE PARKING SIGN, TYP.
 - 15 CURB RAMP, TYPE 1 WITH DETECTABLE WARNING FIELD, TYP.
 - 16 STAIRS
 - 17 DUMPSTER ENCLOSURE, SEE ARCHITECTURAL PLANS
 - 18 MONUMENT SIGN, BY OWNER
 - 19 DRIVE THRU MENU BOARD
 - 20 PRECASTOR REB-400
 - 21 CONCRETE FLUME
 - 22 EX CONCRETE
 - 23 EX CONCRETE CURB AND GUTTER
 - 24 EX FENCE
 - 25 EX STRIPING (PARALLEL), TYP.
 - 26 REMOVE EX CONCRETE BLOCK WALL & REPLACE WITH NEW SCANDIUM RETAINING WALL
 - 27 10" MASON EXPOSED IN DOC. 20020288
 - 28 EX SIDEWALK, TYP.
 - 29 EX TRAIL, TYP.
 - 30 EX LIGHT POLE, TYP.
 - 31 EX SIGNAL POLE

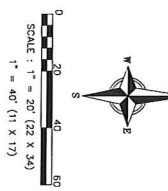

C200

**MULTI-TENANT RETAIL
 SITE PLAN**
 2201 ZEIER ROAD
 MADISON, WISCONSIN



818 N Meadowbrook Ln
 Waunakee, WI 53597
 phone (608) 849-9378
 fax (608) 237-2129

| ISSUANCE/REVISION | DATE |
|-------------------|----------|
| FOR CONSTRUCTION | 09-09-16 |
| ADDENDUM 001 | 09-16-16 |
| 100 #03 | 11-14-16 |

MOD

individual artisan-style pizzas & salads

choose a classic or make your own

CLASSIC PIZZAS

- | | | |
|--|--|--|
| <p>1 'maddy' red sauce mozzarella *670</p> | <p>2 'mad dog' red sauce mozzarella pepperoni mild sausage crumbled meatballs *900</p> | <p>3 'tristan' mozzarella mushroom roasted red peppers asiago pesto drizzle finish *820</p> |
| <p>4 'dominic' white sauce fresh chopped basil asiago mild sausage red onion tomato *740</p> | <p>5 'lucy sunshine' garlic mozzarella artichoke parmesan red sauce dollop finish *720</p> | <p>6 'jasper' red sauce mozzarella mushroom spicy sausage *810</p> |
| <p>7 'dillon james' red sauce garlic fresh chopped basil mozzarella tomato asiago *750</p> | <p>8 'calexico' <small>RV hot!</small> red sauce mozzarella grilled chicken jalapeños gorgonzola hot buffalo sauce finish *800</p> | <p>9 'caspian' bbq sauce mozzarella grilled chicken red onion gorgonzola bbq swirl finish *860</p> |

CLASSIC SALADS

- | | | |
|--|---|---|
| <p>simple mixed greens roasted red peppers asiago</p> | <p>deluxe grilled chicken salami green bell peppers black olives tomato garbanzo beans parmesan *440</p> | <p>caesar romaine tomato parmesan asiago croutons *290</p> |
|--|---|---|

*calorie count based on the MOD serving size and daily caloric intake of 2000 calories

PIZZA & SALAD

- | | | |
|--|---|---|
| <p>bases red sauce white sauce pesto bbq sauce garlic rub</p> <p>cheeses mozzarella parmesan feta asiago gorgonzola</p> <p>dressings ranch caesar italian balsamic blue cheese honey lime</p> | <p>veggies, herbs & good stuff mushrooms black olives tomatoes artichokes red onion pineapple sun-dried tomatoes green bell peppers roasted red peppers pepperoncini peppers garbanzo beans jalapeños spinach garlic fresh rosemary fresh chopped basil croutons</p> | <p>meats mild sausage spicy sausage pepperoni salami grilled chicken crumbled meatballs bacon anchovies canadian bacon</p> <p>finish it with... bbq swirl pesto drizzle hot buffalo sauce red sauce dollops ranch balsamic fig glaze sri-rancha</p> |
|--|---|---|

MOD PIZZA or SALAD

any toppings you want. same price.

mini
\$4.47

6" pizza
or side salad

mod
\$7.47

11" pizza
or entrée salad

mega
\$10.47

double 11" crust pizza
or family size salad

MOD pizza salad \$9.47 enjoy your salad on a warm asiago pizza crust

looking for a simple cheese pizza? ask for a 'maddy' \$5.97

gluten-free crust* • \$2.00

*as our gluten-free crust is exposed to the same ingredients as our standard pizzas and cooked on the same oven surface, we do not recommend it for those with serious gluten allergies.

MORE STUFF

strip & dip

- | | |
|--|---|
| <p>garlic strips dip into red sauce, pesto, ranch or spicy ranch *280</p> | <p>cinnamon strips dip into chocolate, strawberry or cinnamon glaze *280</p> |
|--|---|

\$2.97

DRINKS

- | | | |
|--|---|--|
| <p>draft beer & wine <i>locally brewed</i></p> <p>glass \$4.97</p> <p>pitcher or carafe \$11.27</p> | <p>milkshakes \$3.27 chocolate vanilla strawberry *820-930</p> <p>floats \$2.27 make it your own *400-600</p> | <p>fountain drinks \$1.97 sodas house-made iced teas & lemonades *0-300</p> |
|--|---|--|

*calorie count based upon daily caloric intake of 2000 calories.

visit MODPIZZA.COM to order online for takeout and to find the MOD nearest you.

WE ARE MOD

OUR PROMISE

if you are not completely happy with your pizza, let us make you a new one on the house.

MOD is what YOU make it.
We love feeding you. Please feed us back!
feedback@modpizza.com



ANY TOPPING YOU WANT.

FOR COMPLEX TIMES