

Grandview Commons Northeast Addition - Phase Map

Addendum 1: Surface Paving For Phases 1-4

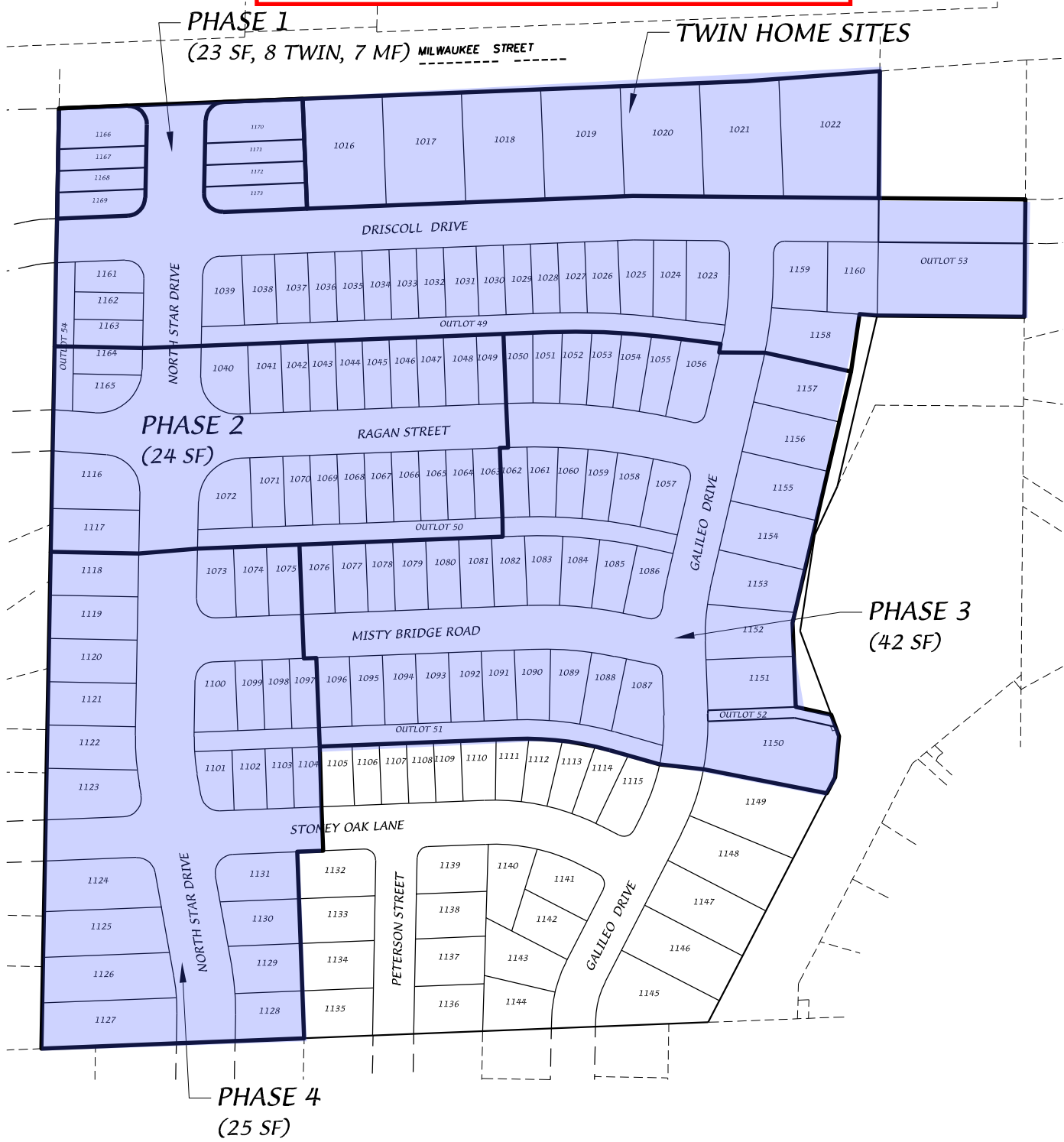

D'ONOFRIO KOTTKE AND ASSOCIATES, INC.
 7530 Westward Way, Madison, WI 53717
 Phone: 608.833.7530 • Fax: 608.833.1089
 YOUR NATURAL RESOURCE FOR LAND DEVELOPMENT

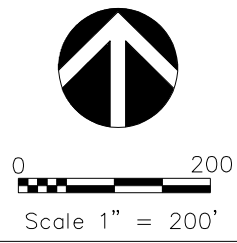

DATE: 08-31-20
 F.N.: 19-05-144
 REV.

DRAWN BY:
 U: /USER/1707115/DRAWINGS/PHASE MAP.DWG

Contract Name Northeast Addition to Grandview Commons Surface Paving
 Contract Number 8188
 Project Number 11925

PHASE	INITIAL SURETY	REDUCED AMT	RELEASE AMT	RUNNING TOTAL
Phase 1	\$49,900.00			
		\$4,990.00		
			\$0.00	\$4,990.00
Phase 2	\$28,400.00			
		\$2,840.00		
			\$2,840.00	\$4,990.00
Phase 3	\$30,000.00			
		\$3,000.00		
			\$3,000.00	\$4,990.00
Phase 4	\$39,500.00			
		\$3,950.00		
			\$0.00	\$8,940.00