



eppstein uhen : architects

milwaukee 333 East Chicago Street
Milwaukee, Wisconsin 53202
telephone 414.271.5350
madison 309 West Johnson Street, Suite 202
Madison, Wisconsin 53703
telephone 608.442.5350

PROJECT INFORMATION

**STONE HOUSE
MIXED USE EAST
WASHINGTON**

1000 E.
WASHINGTON
MADISON, WI 53703

ISSUANCE AND REVISIONS

LAND USE APPLICATION

#	DATE	DESCRIPTION
---	------	-------------

SHEET INFORMATION

**PROGRESS DOCUMENTS
NOT FOR CONSTRUCTION**

These documents reflect progress and intent and may be subject to change, including additional detail. These are not final construction documents and should not be used for final bidding or construction-related purposes.

PROJECT MANAGER	JP
PROJECT NUMBER	14339-01
DATE	10/21/2015

SITE LOCATION

G02



D
C
B
A

1 2 3 4 5 6

1 2 3 4 5 6

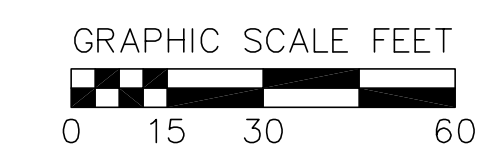
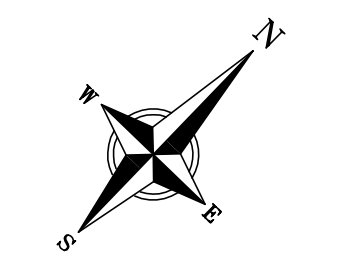
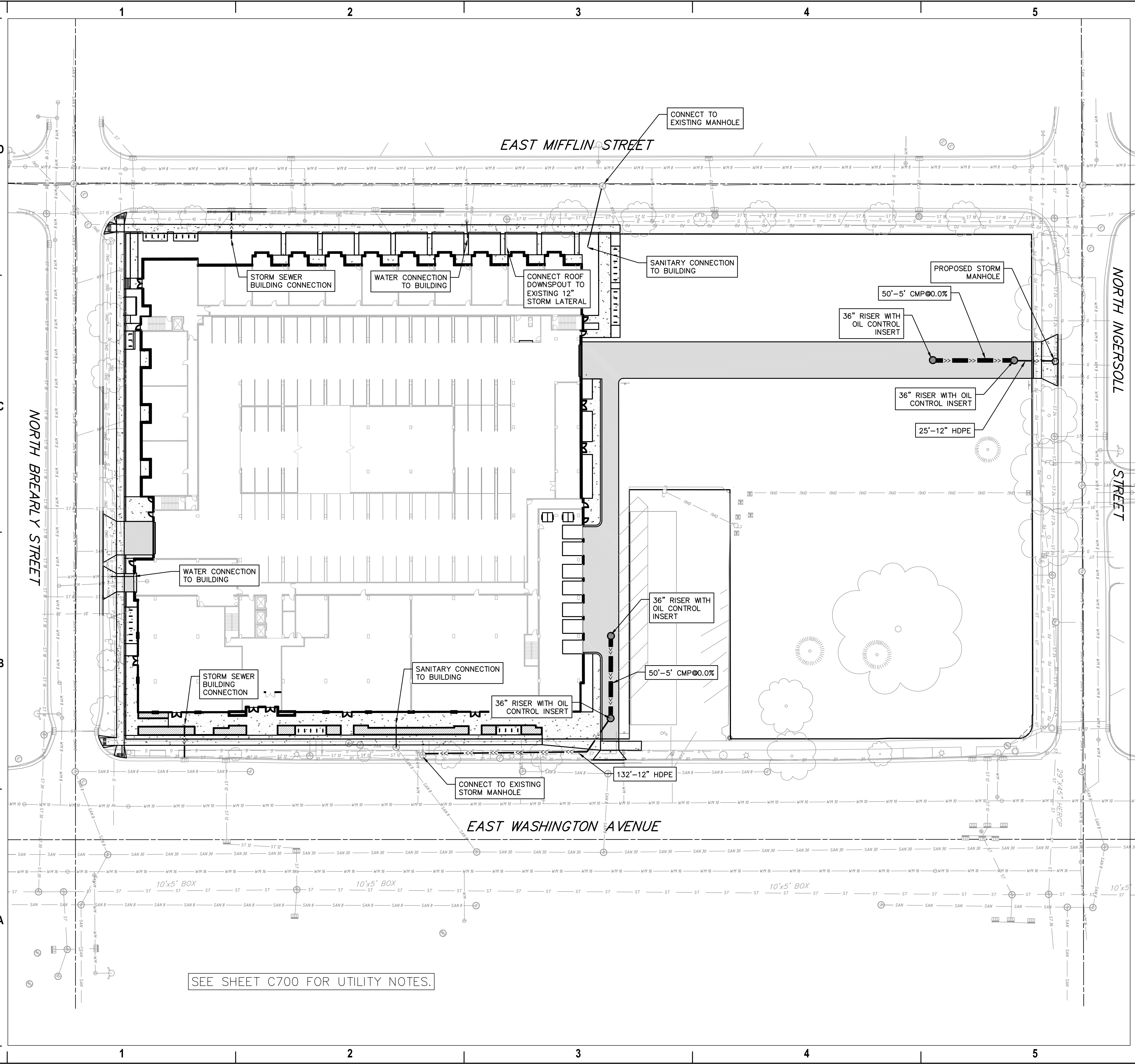

- PROPOSED UTILITY LEGEND**
- STORM SEWER PIPE
 - STORM SEWER MANHOLE
 - STORM SEWER ENDWALL
 - STORM SEWER CURB INLET
 - STORM SEWER CURB INLET W/MANHOLE
 - STORM SEWER FIELD INLET
 - ROOF DRAIN CLEANOUT
 - SANITARY SEWER PIPE (GRAVITY)
 - SANITARY SEWER LATERAL PIPE
 - SANITARY SEWER MANHOLE
 - SANITARY SEWER CLEANOUT
 - WATER MAIN
 - WATER SERVICE LATERAL PIPE
 - FIRE HYDRANT
 - WATER VALVE
 - CURB STOP
 - PROPOSED PIPE INSULATION

- ABBREVIATIONS**
- STMH - STORM MANHOLE
 - FI - FIELD INLET
 - CI - CURB INLET
 - CB - CATCH BASIN
 - EW - ENDWALL
 - SMH - SANITARY MANHOLE

SEE SHEET C700 FOR UTILITY NOTES.



eppstein uhen : architects

Milwaukee 333 East Chicago Street
Milwaukee, Wisconsin 53202
Telephone 414.271.5350
Madison 309 West Johnson Street, Suite 202
Madison, Wisconsin 53703
Telephone 608.442.5350



PROJECT INFORMATION

**STONE HOUSE
MIXED USE EAST
WASHINGTON**

1000 E.
WASHINGTON
MADISON, WI 53703

ISSUANCE AND REVISIONS

LAND USE APPLICATION

#	DATE	DESCRIPTION

SHEET INFORMATION

**PROGRESS DOCUMENTS
NOT FOR CONSTRUCTION**

These documents reflect progress and intent and may be subject to change, including additional detail. These are not final construction documents and should not be used for final bidding or construction-related purposes.

PROJECT MANAGER JP

PROJECT NUMBER 14339-01

DATE 10/21/2015

UTILITY PLAN

C600