

JH FINDORFF & SONS INC
Parcel 0709-234-0309-5
300 S Bedford St
Lot 2 CSM 12051

Owned by WI Dept of Trans
Operated by WI & Southern RR
Parcel 0709-234-1008-2
651W Wilson St

Urban Land Development
Parcel 0709-234-1019-9
727 LorNard Ct
Lot 1 CSM 13337

Brittingham Park
Parcel 0709-234-0710-4
201 Proudfit St

15' Public Storm Sewer Easement
Recorded 06/13/2004 Doc 395888

12' Street Easement
Recorded 02/25/1974 Doc 3886

approx location - need field-marked
approx location - need field-marked

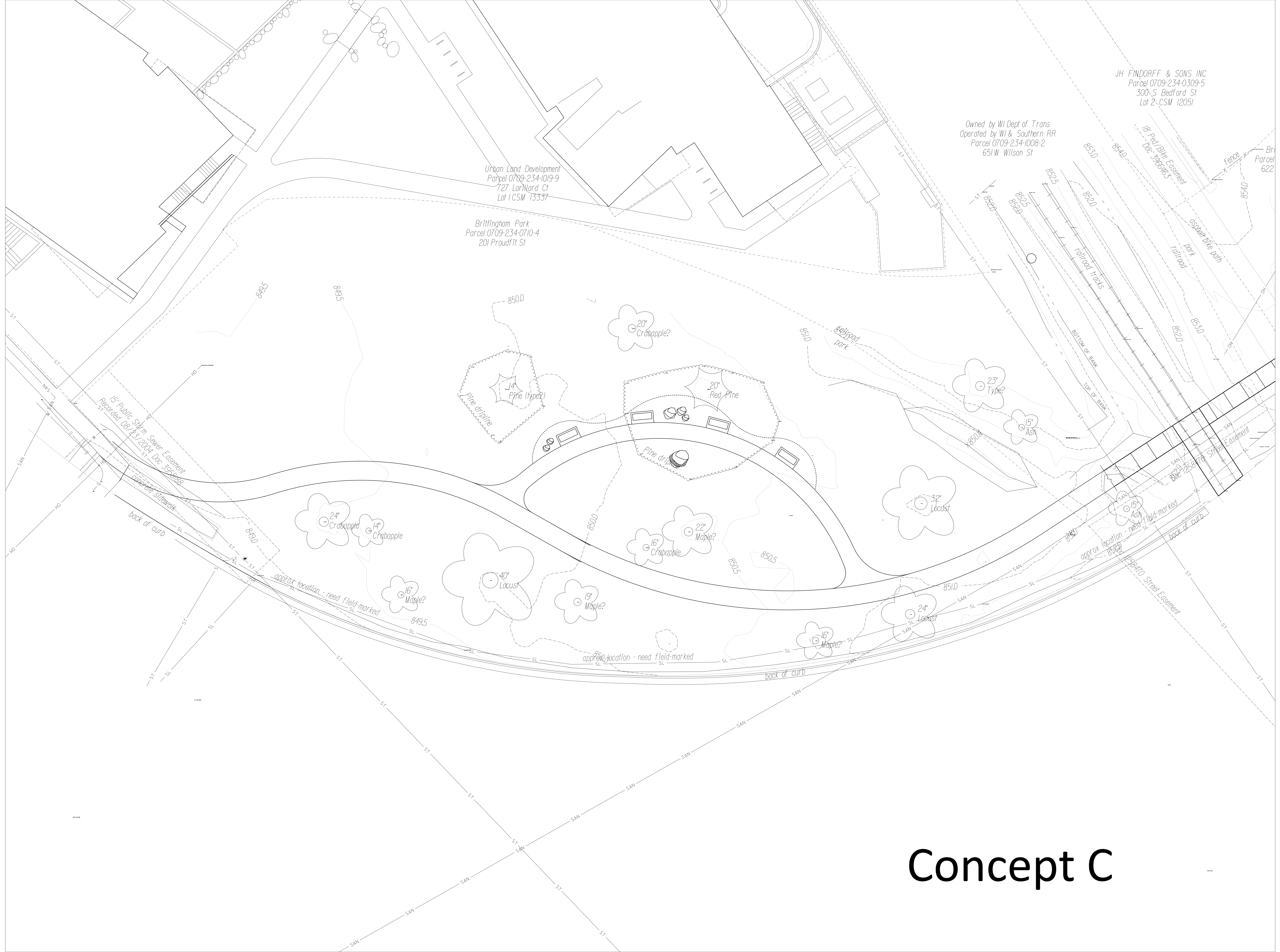

Concept C