

DRAWING SET	PRICING
COPYRIGHT	2010
STRANG, INC.	
FILE NAME	MILWAUKEE_TENANT_REMODELING
REVISIONS	
DRAWN	
CHECKED	
DATE	06-18-10
PROJECT NO.	2009037
PROJECT TITLE	

REMODELING AT
THE VILLAGER
TENANTS

2000 S. PARK ST.
MILWAUKEE, WI 53233

SHEET TITLE
PARTIAL FLOOR
PLANS

SHEET NO.
A201

FIRST FLOOR PUBLIC HEALTH GENERAL NOTES

1. EXISTING WALLS, CEILING, AND FLOOR FINISHES SHALL BE DEMOLISHED WITH THE EXCEPTION OF THE EXISTING PARTIAL FLOOR FINISHES.
2. FINISHES SHALL BE AS SHOWN ON THE FINISH SCHEDULE.
3. PROVIDE ALL NEW PARTITIONS TO 8'-0" HEIGHT.
4. PROVIDE ALL NEW PARTITIONS WITH 1/2" Gypsum Board Core AND 5/8" Gypsum Board Face.
5. PROVIDE ALL NEW PARTITIONS WITH 1/2" Gypsum Board Core AND 5/8" Gypsum Board Face.
6. PROVIDE ALL NEW PARTITIONS WITH 1/2" Gypsum Board Core AND 5/8" Gypsum Board Face.
7. PROVIDE ALL NEW PARTITIONS WITH 1/2" Gypsum Board Core AND 5/8" Gypsum Board Face.
8. PROVIDE ALL NEW PARTITIONS WITH 1/2" Gypsum Board Core AND 5/8" Gypsum Board Face.
9. PROVIDE ALL NEW PARTITIONS WITH 1/2" Gypsum Board Core AND 5/8" Gypsum Board Face.
10. PROVIDE ALL NEW PARTITIONS WITH 1/2" Gypsum Board Core AND 5/8" Gypsum Board Face.
11. PROVIDE ALL NEW PARTITIONS WITH 1/2" Gypsum Board Core AND 5/8" Gypsum Board Face.
12. PROVIDE ALL NEW PARTITIONS WITH 1/2" Gypsum Board Core AND 5/8" Gypsum Board Face.

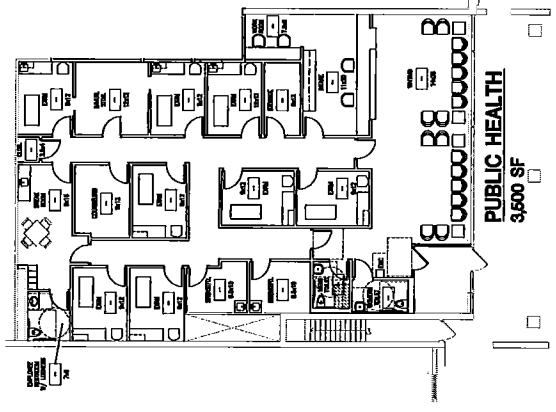

PARTIAL FIRST FLOOR PLAN
SCALE: 1/8" = 1'-0"

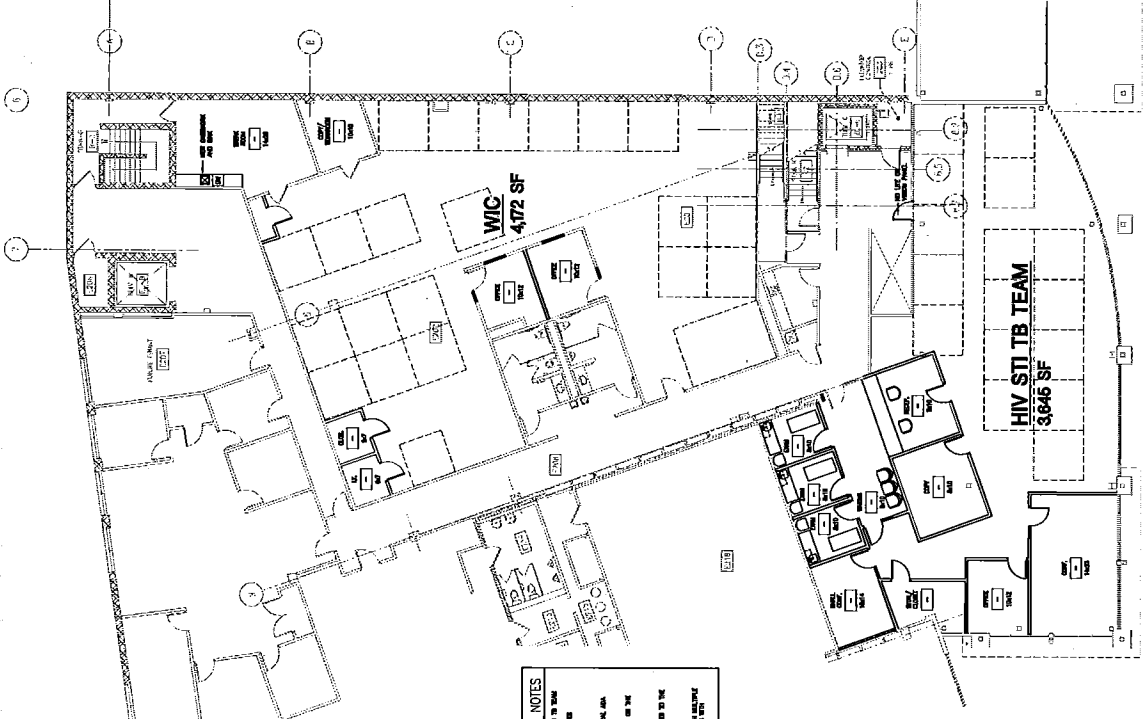

SECOND FLOOR MIC & HIV STI TB TEAM GENERAL NOTES

1. EXISTING WALLS, CEILING, AND FLOOR FINISHES SHALL BE DEMOLISHED WITH THE EXCEPTION OF THE EXISTING PARTIAL FLOOR FINISHES.
2. FINISHES SHALL BE AS SHOWN ON THE FINISH SCHEDULE.
3. PROVIDE ALL NEW PARTITIONS TO 8'-0" HEIGHT.
4. PROVIDE ALL NEW PARTITIONS WITH 1/2" Gypsum Board Core AND 5/8" Gypsum Board Face.
5. PROVIDE ALL NEW PARTITIONS WITH 1/2" Gypsum Board Core AND 5/8" Gypsum Board Face.
6. PROVIDE ALL NEW PARTITIONS WITH 1/2" Gypsum Board Core AND 5/8" Gypsum Board Face.
7. PROVIDE ALL NEW PARTITIONS WITH 1/2" Gypsum Board Core AND 5/8" Gypsum Board Face.
8. PROVIDE ALL NEW PARTITIONS WITH 1/2" Gypsum Board Core AND 5/8" Gypsum Board Face.
9. PROVIDE ALL NEW PARTITIONS WITH 1/2" Gypsum Board Core AND 5/8" Gypsum Board Face.
10. PROVIDE ALL NEW PARTITIONS WITH 1/2" Gypsum Board Core AND 5/8" Gypsum Board Face.
11. PROVIDE ALL NEW PARTITIONS WITH 1/2" Gypsum Board Core AND 5/8" Gypsum Board Face.
12. PROVIDE ALL NEW PARTITIONS WITH 1/2" Gypsum Board Core AND 5/8" Gypsum Board Face.

PARTIAL SECOND FLOOR PLAN
SCALE: 1/8" = 1'-0"