

AFFIDAVIT OF MAILING

STATE OF WISCONSIN)
) ss.
COUNTY OF DANE)

JOHANNA JOHNSON, being first duly sworn on oath, deposes and says that:

1. She is a Program Assistant 3 with the Office of the City Engineer, City of Madison, Dane County, Wisconsin, and did on the day of AUGUST 3, 2018 placed in envelopes addressed to each interested owner of respective addresses as indicated by attached assessment list, a true and correct copy of the notice of assessments for the project titled **DARWIN ROAD RESURFACING WITH UTILITIES ASSESSMENT DISTRICT - 2019** attached hereto.
2. She did and delivered the envelopes to the Mail Room of the Dane County Printing and Services Division, 210 Martin Luther King, Jr. Blvd., in the city of Madison, Dane County Wisconsin, for postage and depositing in the United States Mail.

Johanna L. Johnson

Johanna L. Johnson

Subscribed and sworn to before me
this 3 day of AUGUST, 2018

[Signature]

Notary Public, State of Wisconsin
My Commission expires: 3.27.2022

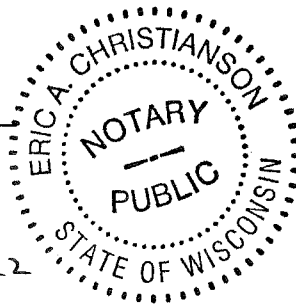



Department of Public Works
Engineering Division
Robert F. Phillips, P.E., City Engineer
City-County Building, Room 115
210 Martin Luther King, Jr. Boulevard
Madison, Wisconsin 53703
Phone: (608) 266-4751
Fax: (608) 264-9275
engineering@cityofmadison.com
www.cityofmadison.com/engineering

Parcel Number: 0810-304-0085-8
Situs Address: 2223 Darwin Rd
RICE ASSOCIATES
PO BOX 8685
MADISON, WI 53708-8685

Assistant City Engineer
Gregory T. Fries, P.E.
Kathleen M. Cryan
Principal Engineer 2
Christopher J. Petykowski, P.E.
John S. Fahrney, P.E.
Principal Engineer 1
Christina M. Bachmann, P.E..
Facilities & Sustainability
Jeanne E. Hoffman, Manager
Mapping Section Manager
Eric T. Pederson, P.S.
Financial Manager
Steven B. Danner-Rivers

August 3, 2018

To: Property Owners along Darwin Road

Re: Proposed Street Resurfacing Project & Public Hearing

The City of Madison is proposing to resurface Darwin Road in 2019. Enclosed with this letter is a fact sheet with some details on the proposed project, which includes a map of the proposed project limits. Also enclosed is a notification for the Public Hearing before the Board of Public Works. The date, time and location of the public hearing can be found on the notification.

This project will involve special assessments to the owners of property adjacent to the project. The property owners will be assessed for various items included with this proposed project, and the costs of some of those items are assessed entirely to the owner. A table detailing the City's standard assessment policy for the items of work is included on the fact sheet.

Also enclosed is a Schedule of Assessments, which shows the estimated costs for each property adjacent to the project. After the work is complete, a final assessment will be calculated based on bid prices and work actually performed. The final assessment, which will be billed after the completion of the project, is payable in one lump sum or over a period of 8 years, with 3% interest charged on the unpaid balance.

To request accommodations for special needs or disabilities or if you have any other questions regarding this project, please contact the Project Engineer. This includes requests relating to the Public Hearing and requests relating to the actual operations of construction. A list of contacts for this project can be found on the enclosed fact sheet.

Sincerely,

Robert F. Phillips, P.E.
City Engineer

RFP:sms

Cc by email:

Ald. Palm
Yang Tao, Traffic Engineering
Jerry Schippa, Traffic Engineering
Tim Sobota, Madison Metro Transit
Kyle Frank, City Engineering
Jason Fenske, Badger Bus Lines, jasonf@badgerbus.com
Mick Howan, School District Transportation, mjhowan@madison.k12.wi.us
Jeff Fedler, Madison School District Transportation Coordinator, jfedler@madison.k12.wi.us
Dane County 911
Charlie Romines, Streets Division
Christy Bachmann, City Engineering
Marla Eddy, City Forestry
Cindy Mierow, Police Department
Ed Ruckriegel, Fire Department

**NOTICE OF PUBLIC HEARING
BEFORE THE BOARD OF PUBLIC WORKS
FOR
PLANS, SPECIFICATIONS, AND SPECIAL ASSESSMENTS
FOR
PUBLIC WORKS IMPROVEMENTS
MADISON, WISCONSIN**

PART I

The Common Council of the City of Madison, Wisconsin, having heretofore decided that it is expedient and necessary that the improvements as listed in Part II hereof be improved at the expense of the property thereby on which would be conferred some special benefit.

NOW, THEREFORE, NOTICE IS HEREBY GIVEN:

That the City Engineer has prepared plans, specifications, a proposed schedule of assessments, and an estimate of the entire costs of the improvement for each of the districts listed in Part II hereof, and;

That the plans, specifications, a proposed schedule of assessments, and an estimate of the entire cost of the improvements listed hereto are available and open to inspection by all interested persons in the office of the City Engineer, Room 115, City-County Building, 210 Martin Luther King Jr. Blvd., between the hours of 7:30 a.m. and 4:00 p.m., Monday through Friday, and will so continue to be for ten (10) working days from the first published date of this notice, and;

That on **WEDNESDAY, AUGUST 15, 2018 AT 5:30 P.M.**, the Board of Public Works will hold a public hearing in **ROOM 108 (PARKS CONFERENCE ROOM) OF THE CITY COUNTY BUILDING** and will consider any objections that may be filed in writing or in person and hear all persons desiring to be heard, and;

That special assessments may be paid over an eight (8) year period, with the owner paying 1/8 of the principal each year plus three (3%) percent interest on the unpaid balance, as determined by the Board of Public Works.

That if the total assessment is paid in full before October 31st in the year that the billing is made, irrespective of project completion, then no interest shall be charged.

If you require an interpreter, materials in alternate formats, or other accommodations to access this public hearing, please contact the Engineering Division at phone (608) 266-4751 or email us at engineering@cityofmadison.com. Please make contact at least 24 hours prior to the date of this public hearing so that we can make proper accommodations.

PART II

DARWIN ROAD RESURFACING WITH UTILITIES ASSESSMENT DISTRICT – 2019

**ALLEYS: 1800 & 1900 ADAMS & JEFFERSON: 1800 ADAMS & VILAS: 1300
CHANDLER & VILAS**

By Order of the Board of Public Works
Madison, Wisconsin

Fact and Details Sheet

Proposed 2019 Darwin Road Utility Replacement with Resurfacing Project

Project Details – Proposed Work

Sanitary Sewer: The City will replace existing main (1953) and in most cases replace laterals from the main to the property line. In limited cases: where the existing lateral is cast iron, appears to be in good condition upon inspection, and runs under a tree the lateral will only be replaced to the back of curb. In those cases, the resident will not be assessed for the additional footage of replacement that is not completed. If you would like a full lateral replacement to the property line in cases such as this please, contact the Sanitary Sewer Contact listed at right.

Water Main: No work anticipated

Storm Sewer: spot repairs of existing storm sewer. Connections of private storm sewer will be completed per City standards (*assessable*).

Street: Replace the pavement and replace the existing curb, driveway aprons, and sidewalk (*assessable*) as needed.

Terrace Areas: All existing concrete terrace walkways will be replaced with the project (*assessable*), unless the property owner requests that they be removed. The terrace area and public right-of-way will likely be disturbed during the project. Owners must remove any plantings, structures or special landscaping features from the terrace area and public right-of-way, prior to the start of construction, including raised planting beds, stone landscaping, retaining walls, railings, pavers, planters, etc. If left in place, these items will be removed by the contractor. The contractor will not replace these items following completion of the project.

Trees: The trees within the project limits that will remain will be pruned by City Forestry prior to the start of construction.

Project Location

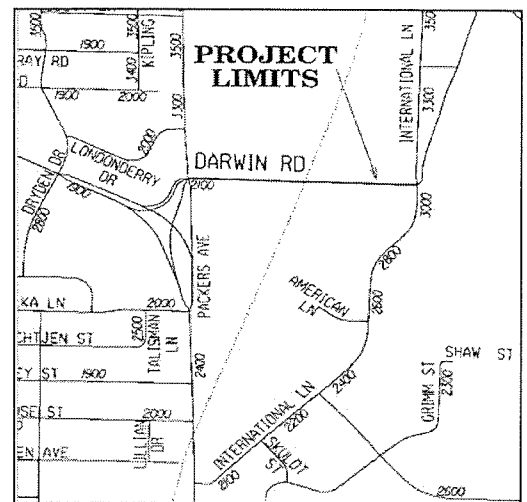

Project Contacts

Project Manager: Steve Sonntag 267-1997, ssonntag@cityofmadison.com

Traffic: Jerry Schippa – 267-1969, jschippa@cityofmadison.com

Storm & Sanitary Sewer: Kyle Frank– 266-4098, kfrank@cityofmadison.com

Construction: John Fahrney – 266-9091, jfahrney@cityofmadison.com

Business Resources: Ruth Rohlich – 267-4933, rrohlich@cityofmadison.com

Forestry: Marla Eddy – 266-4450, meddy@cityofmadison.com

Construction Schedule & Impacts

Tentative Schedule: 60 day construction contract length (summer of 2019).

Traffic Impacts: Streets will be closed to through traffic within the project limits. Access will be maintained to driveway unless work is directly in front of driveway.

Parking on the street will be allowed from 7:00pm to 7:00am during the weekday.

Water Shut-offs: No water shut offs anticipated. Emergency shut-offs may occur if the existing main is damaged during construction.

Refuse Collection: It will be the contractor's responsibility to allow for refuse collection during construction. Please mark your address on your cart to make sure it is returned if moved. Please contact private collection companies to inform them of the project.

Assessment Policy Breakdown

Item	City Share	Owner Share
Conc. curb, sidewalk, aprons	50%	50%
Sanitary Laterals	75%	25%
Pedestrian Lights	0%	100%
Private Storm Connection	0%	100%
Asphalt Pavement	100%	0%
Sanitary & Storm Mains	100%	0%
Water Main	100%	0%
Street Area Lights & Signals	100%	0%
Sidewalk Ramps	100%	0%

Supplemental Forestry Info

Tree pruning in advance of the project is required to reduce the risk of damage to the trees during construction. The City of Madison Forestry Section will perform the necessary work. For certain species, especially oak and elm trees, the pruning must be completed by April 1st to reduce the chance of disease. If additional trees need to be removed, City Forestry or City Engineering will notify the adjacent property owner prior to removal.

All ash street trees within the project limits have been or will be evaluated for potential chemical treatment for Emerald Ash Borer (EAB). Ash trees with trunks measuring less than 10" in diameter at 4.5 ft (DBH) from the ground, ash located under high voltage electric distribution lines, and ash that are structurally compromised or in poor condition will not be treated as outlined in the City's EAB Plan. Ash trees that do not meet the treatment criteria will be removed prior to construction, and will be removed regardless of the construction project schedule. Including ash removals as part of the project will allow for a faster replacement timeframe. For more information about EAB and the City of Madison EAB response plan, please see: <http://www.cityofmadison.com/parks/services/forestry/pests/EAB/index.cfm>.

Street trees provide many benefits to our city and are considered an important part of the city's infrastructure. Forestry Section staff will evaluate the terrace for new planting sites and potential replacement sites when the project is complete. There is no additional cost to the adjacent property owner for a tree planting. Street trees are typically planted in the spring of the year following the completion of the construction project. Per Madison General Ordinance 10.10, City Forestry determines tree species and planting locations. Residents cannot choose or plant their own tree in the terrace.

For any questions regarding street tree maintenance or planting, please contact Marla Eddy at 266-4550.

City of Madison Engineering Division - Schedule of Assessments

Project Name: Darwin Road Resurfacing with Utilities Assessment District - 2019

Project Limits: Darwin Road; Packers Avenue to International Lane

Frontages listed are for: Darwin Road

Project ID: 11746

Parcel No./ Zoning	Owner's Name/ Mailing Address	Site Address	Frontage (LF)	Street Reconstruction Items		Sanitary Sewer Items		TOTAL ASSESSMT						
				Remove and Replace Sidewalk @ \$7.50 per SF	Remove and Replace Drive Apron @ \$8.50 per SF	Remove and Replace Curb and Gutter @ \$20.00 per LF	Sanitary Sewer Recommendation @ \$1,250.00 each		Remove and Replace Sanitary Lateral @ \$21.00 per LF					
0810-304-0099-9 SE	TIEDEMAN'S LLC ATTN: JANET W GONZALEZ 9809 N VALLEY HILL DR MEOUION WI	2101 Darwin Rd	344.24 L.F.	0.00	0.00	30.00	0.00	\$600.00						
0810-301-0204-0 SE	B&G REAL ESTATE LLC C/O GREG RAEMISCH 4444 STATE RD 138 OREGON WI	2102 Darwin Rd	165.00 L.F.	0.00	0.00	0.00	0.00	\$0.00						
0810-304-0092-3 IL	RICE ASSOCIATES PO BOX 8885 MADISON WI	2201 Darwin Rd	211.49 L.F.	100.00	0.00	20.00	1.00	\$3,135.00						
0810-301-0203-2 P/MHP	OPTUNITIES LLC C/O GREG RAEMISCH 4444 STATE RD 138 OREGON WI	2202 Darwin Rd	206.08 L.F.	0.00	40.00	40.00	0.00	\$1,140.00						
0810-304-0085-8 IL	RICE ASSOCIATES PO BOX 8885 MADISON WI	2223 Darwin Rd	248.44 L.F.	100.00	0.00	20.00	1.00	\$3,135.00						
0810-301-0201-6 IL	REYNOLDS PROPERTIES INC PO BOX 1662 COLORADO SPRINGS CO	2310 Darwin Rd	65.65 L.F.	0.00	0.00	20.00	1.00	\$2,385.00						
0810-301-0202-4 IL	REYNOLDS TRANSFER AND STORAGE INC 725 E WIFFLIN ST MADISON WI	2320 Darwin Rd	216.79 L.F.	0.00	0.00	20.00	1.00	\$2,385.00						
0810-301-0092-9 IL	B&G REAL ESTATE LLC C/O GREG RAEMISCH 4444 STATE RD 138 OREGON WI	2402 Darwin Rd	381.36 L.F.	0.00	0.00	20.00	1.00	\$2,385.00						
0810-304-0088-2 SE	STATE OF WISCONSIN DEPT OF NATURAL RESOURCES 101 S WEBSTER ST FL 8 MADISON WI	2421 Darwin Rd	281.02 L.F.	0.00	0.00	40.00	1.00	\$2,785.00						
0810-304-0087-4 SE	DANE COUNTY AIRPORT 210 MLK JR BLVD #114 MADISON WI	2435 Darwin Rd	465.00 L.F.	75.00	270.00	80.00	2.00	\$8,427.50						
0810-304-0090-7 SE	CITY OF MADISON ENGINEER FUTURE TRANSPORTATION 535 210 MLK BLDG RM 115 MADISON WI	2798 International Ln	24.71 L.F.	0.00	0.00	0.00	0.00	\$0.00						
0810-304-0108-8 SE	DANE COUNTY TRUAX AIR PARK WEST 210 MLK JR BLVD #114 MADISON WI	2902 International Ln	388.40 L.F.	0.00	0.00	0.00	0.00	\$0.00						
0810-301-0101-8 AP	DANE COUNTY REGIONAL AIRPORT 210 MLK JR BLVD #114 MADISON WI	3108 International Ln	451.00 L.F.	0.00	0.00	60.00	1.00	\$3,185.00						
TOTALS:				275.00	\$2,062.50	310.00	\$2,635.00	350.00	\$1,600.00	9	\$11,250.00	315	\$6,615.00	\$29,562.50