

# THE UNIVERSITY OF WISCONSIN

JOINT CAMPUS AREA COMMITTEE - MADISON

22D5A CAMP RANDALL SPORTS CENTER REPLACEMENT

December 12, 2023  
INFORMATIONAL



# AGENDA

---

- PROJECT SCOPE
- LOCATING THE PROJECT SITE
- SITE CONTEXT & PHOTOS
- BLOCKING ADJACENCIES & MASSING

## PROJECT DESCRIPTION

- Replace the existing McClain & Shell buildings with a new athletics training facility & indoor practice field. This facility will be the home of the football, men's & women's soccer, and men's & women's track programs .
- The new facilities helps meet critical space needs for each athletic personnel department in the building.
- Increase available parking on site for building occupants and public to utilize.
- Designed to promote natural lighting and views to the outdoor.
- Includes opportunities for revenue generation and interaction with the public.
- Enables potential future expansion projects to build vertically.

**PROJECT BUDGET:  
\$285,163,000**

**PROJECT SQUARE FOOTAGE:  
440,000 - 450,000**

## PROJECT GOALS

- Design & construct an athletics training facility that allows the program to remain relevant with other program facilities.
- Consolidate all day-to-day operations for each team into a 3 level facility.
- Create direct adjacencies for key departments for efficiency of personnel.
- Deliver a full 100 yard indoor practice facility with adequate runoff space around the perimeter of the field.
- Incorporate sustainable building initiatives that align with University of Wisconsin's Campus Goals.
- Engage the public through the Hall of Fame and evolving story of Camp Randall.

# PROJECT SCOPE

## MAJOR PROGRAM SPACES:

## EST SQ. FT.

- INDOOR PRACTICE FACILITY 90,000
- PARKING 90,000
- WEIGHT ROOM 22,400
- ATHLETIC TRAINING 14,200
- PLAYER LOCKER ROOM 15,000
- EQUIPMENT ROOM 8,400
- DINING HALL 10,200
- MEETING ROOMS 12,100
- FOOTBALL OFFICES 29,100

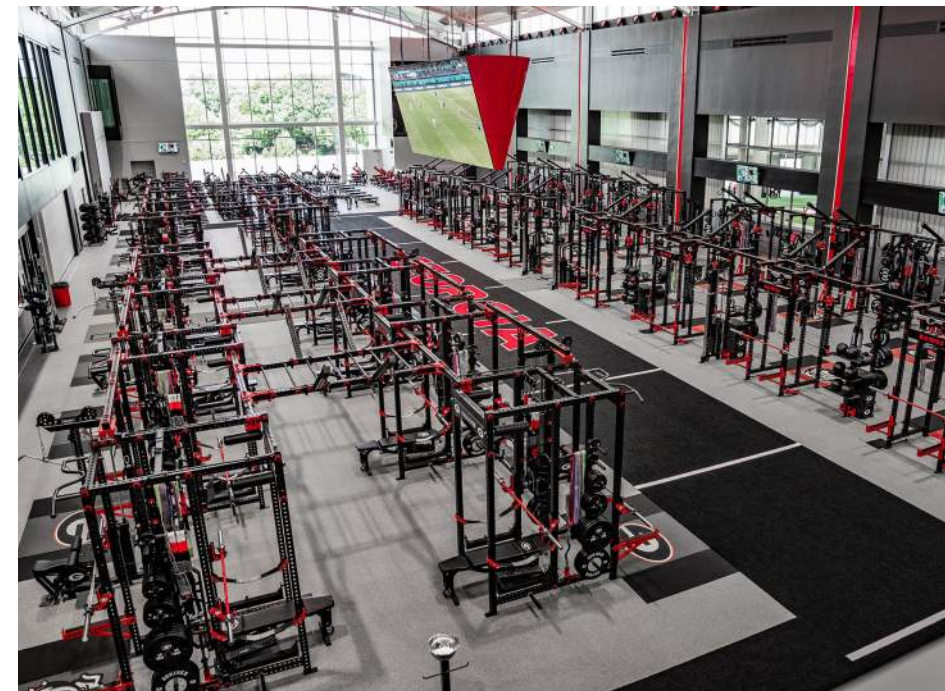

# CAMPUS MAP

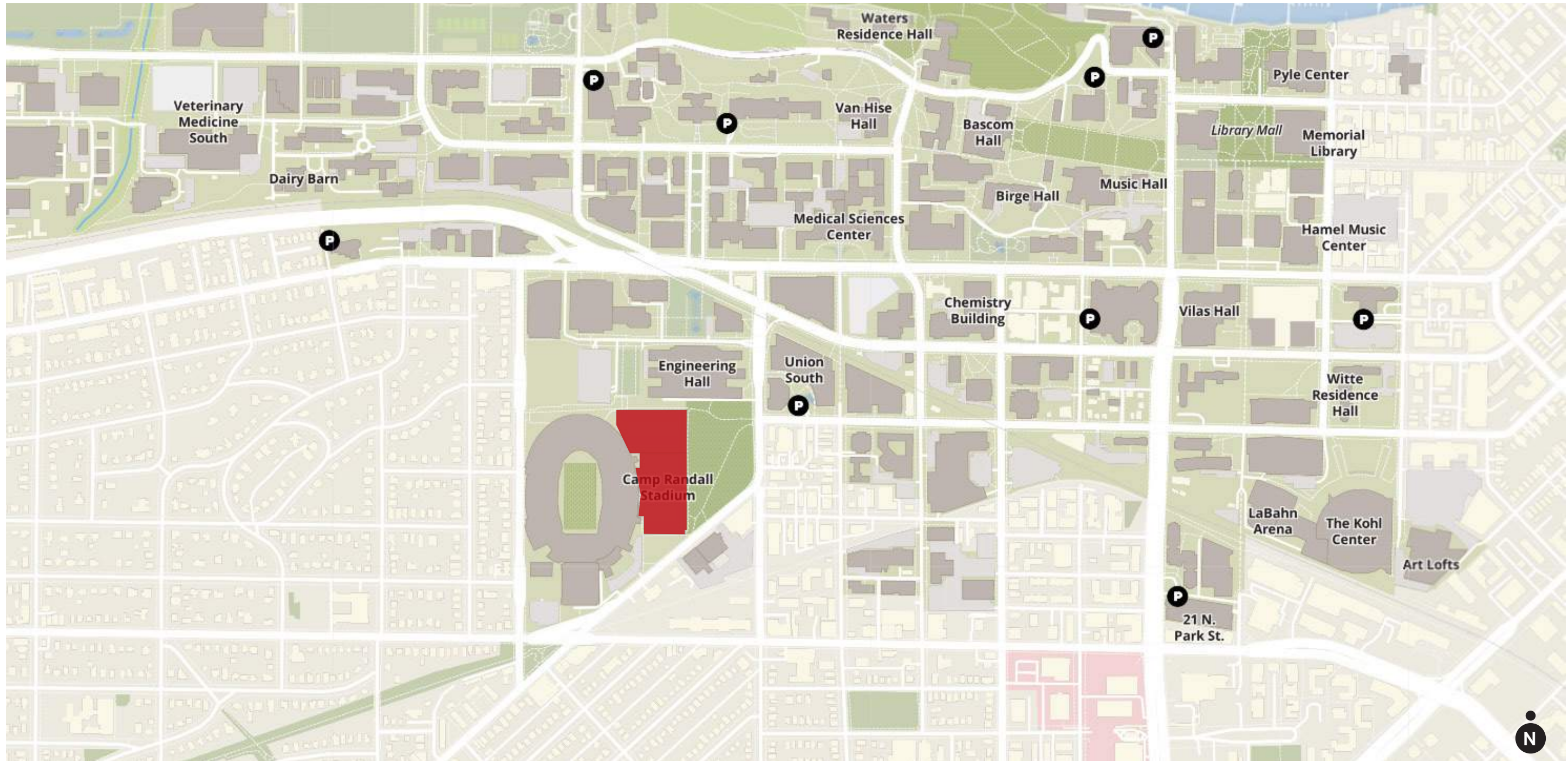

# CAMPUS MASTER PLAN



SITE AERIAL





SITE AERIAL



SITE AERIAL



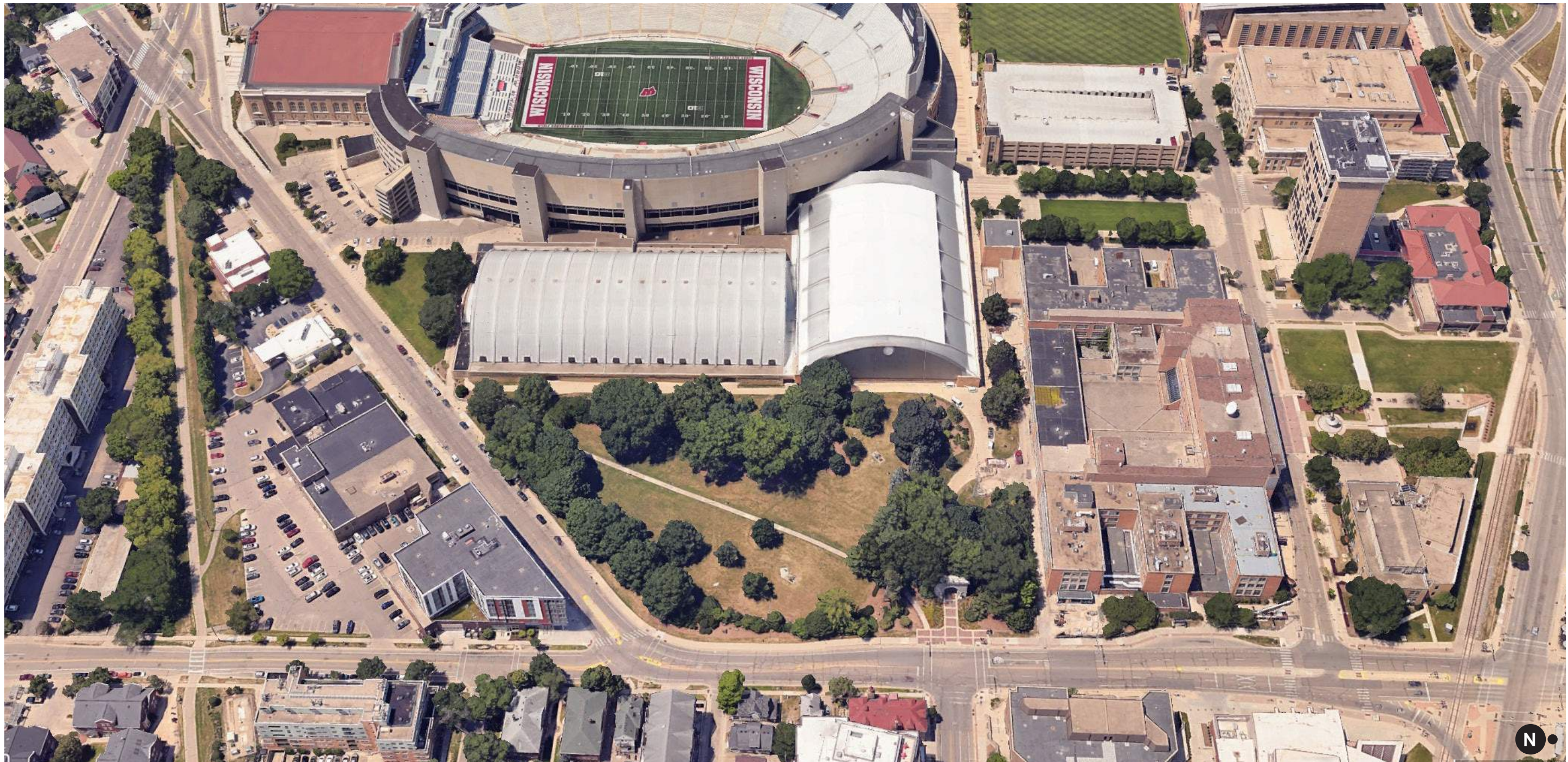

**SITE AERIAL**

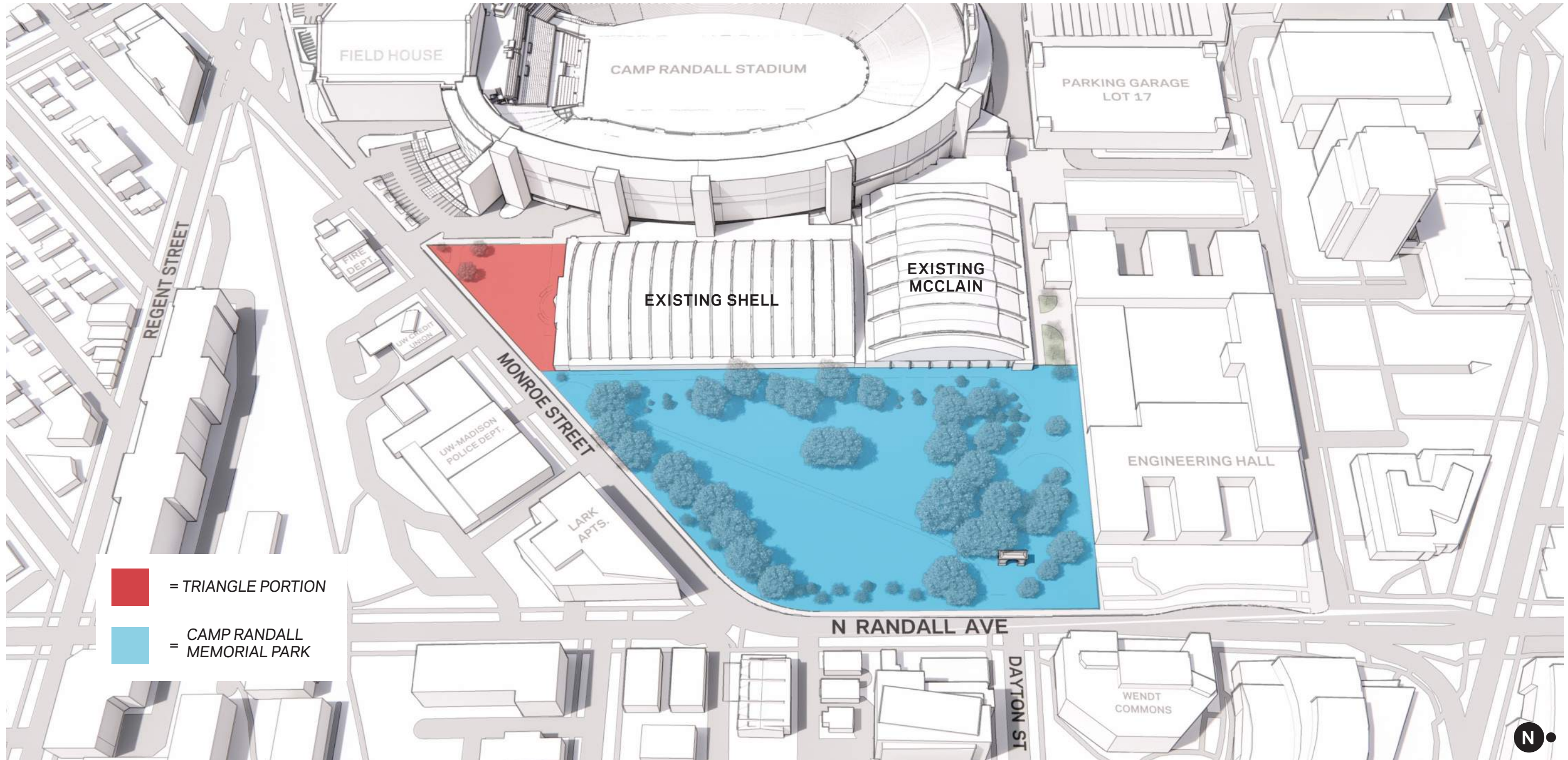

# CAMP RANDALL GROUNDS



-  = TRIANGLE PORTION
-  = CAMP RANDALL MEMORIAL PARK

CAMP RANDALL MEMORIAL PARK



**EXISTING CONDITIONS - DEMOLITION**

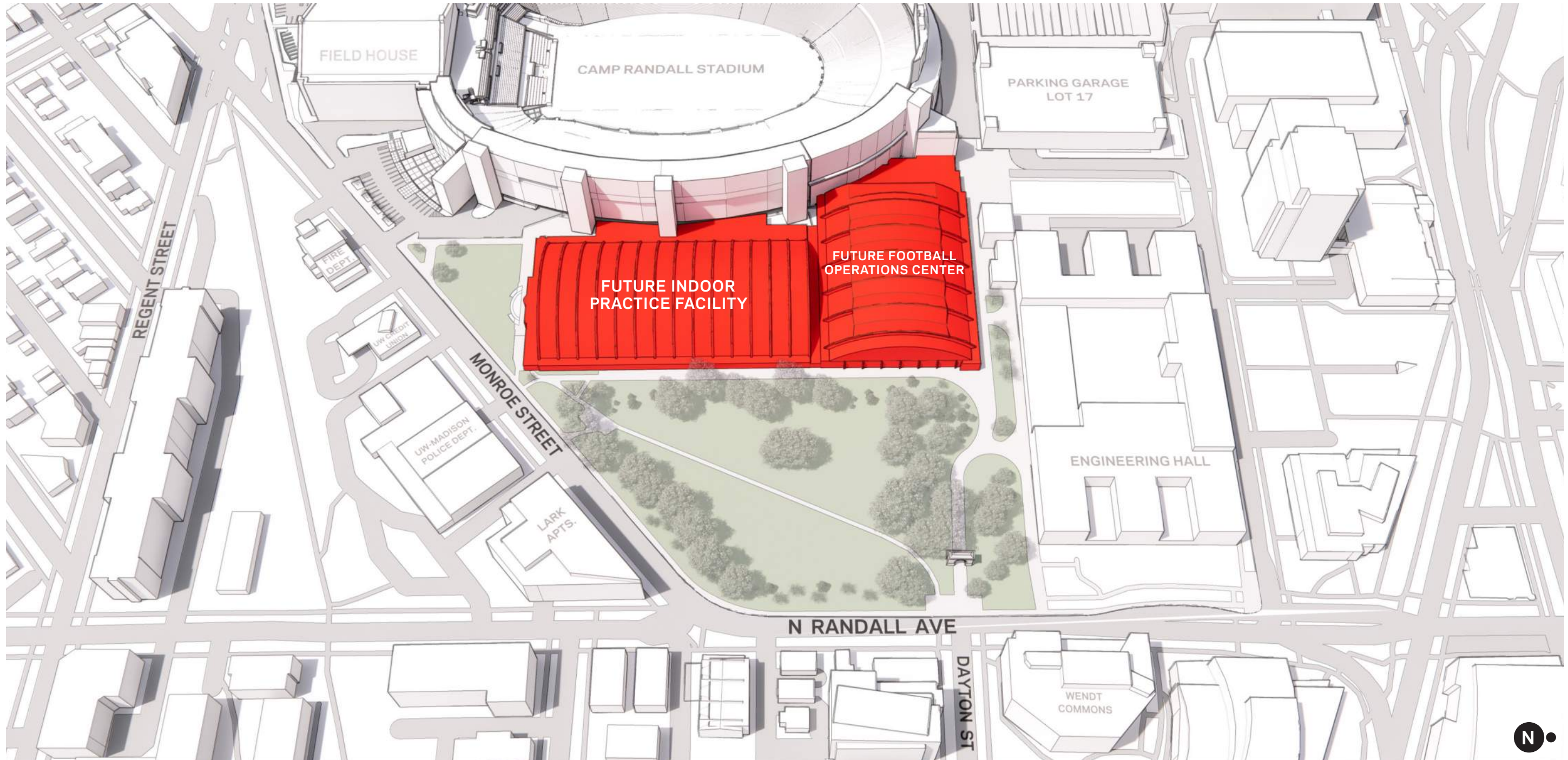

**SITE ACCESS**

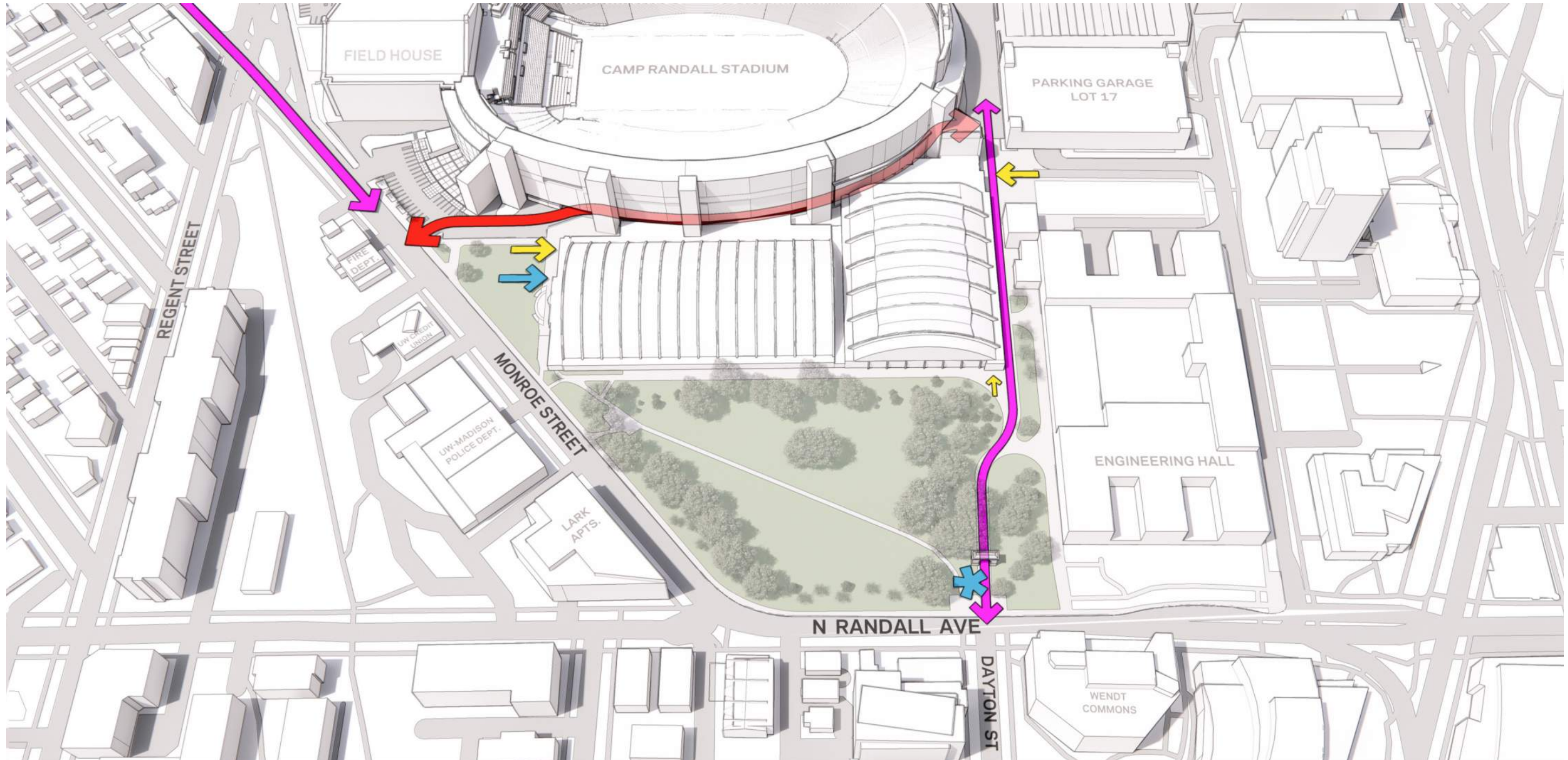

# SITE TOPOGRAPHY

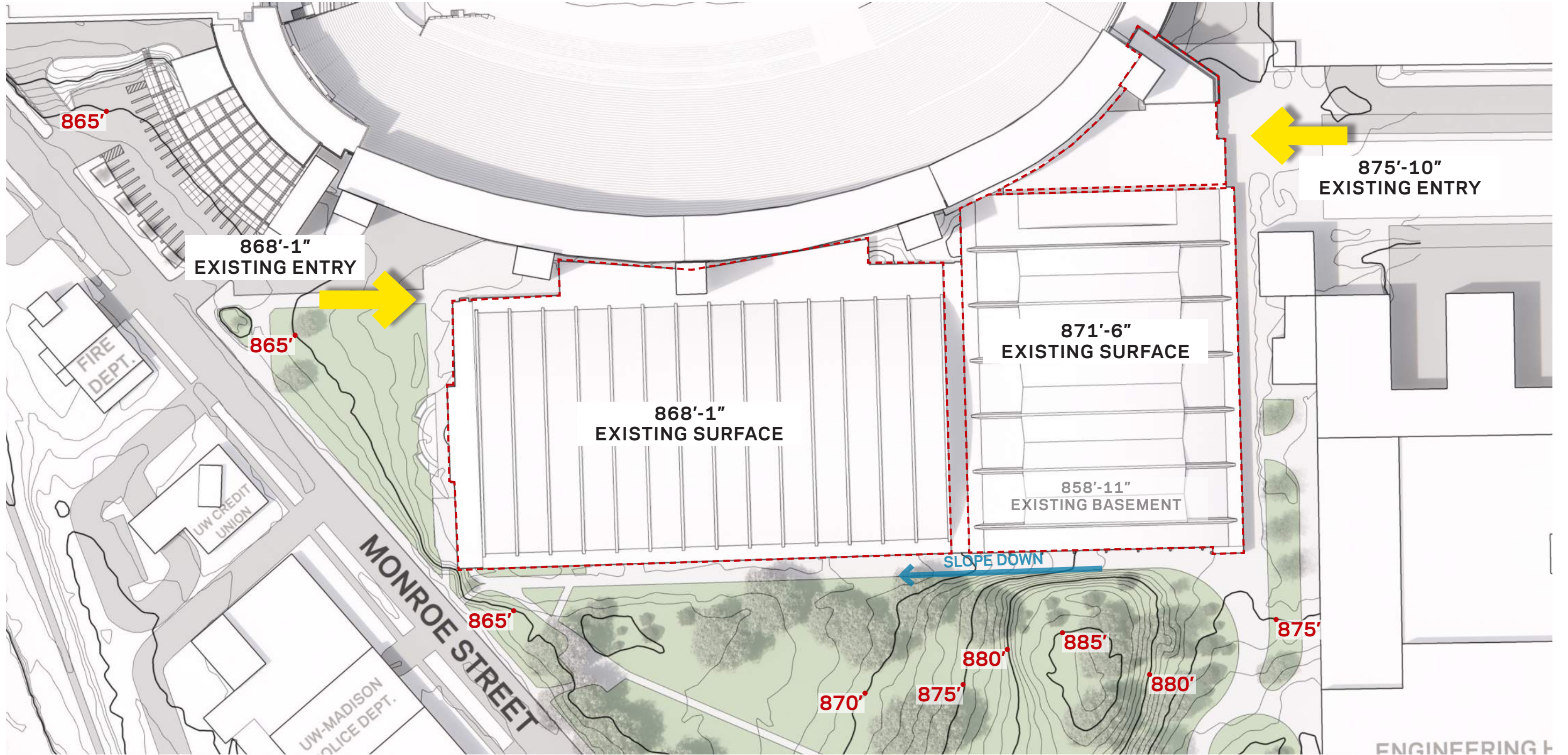



# BUILDING EDGES



EXISTING SHELL

EXISTING MCCLAIN

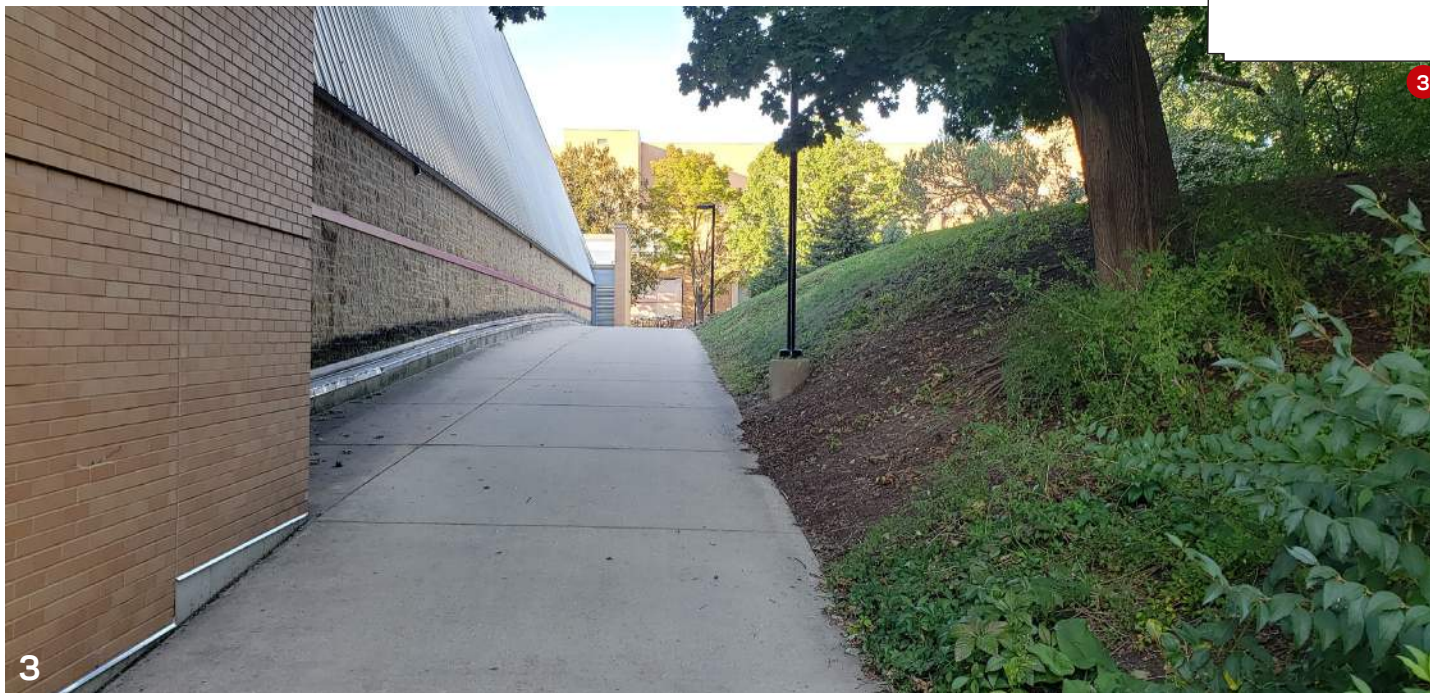

**NORTH SIDE OF CAMP RANDALL**



SAPC STEPHEN M. BENNETT ENTRANCE



**KELLNER HALL**



WISCONSIN FIELD HOUSE



**ENGINEERING HALL**



**PARKING LOT 17**



# BLOCKING ADJACENCIES

---



**PREFERRED CONCEPT MASSING**

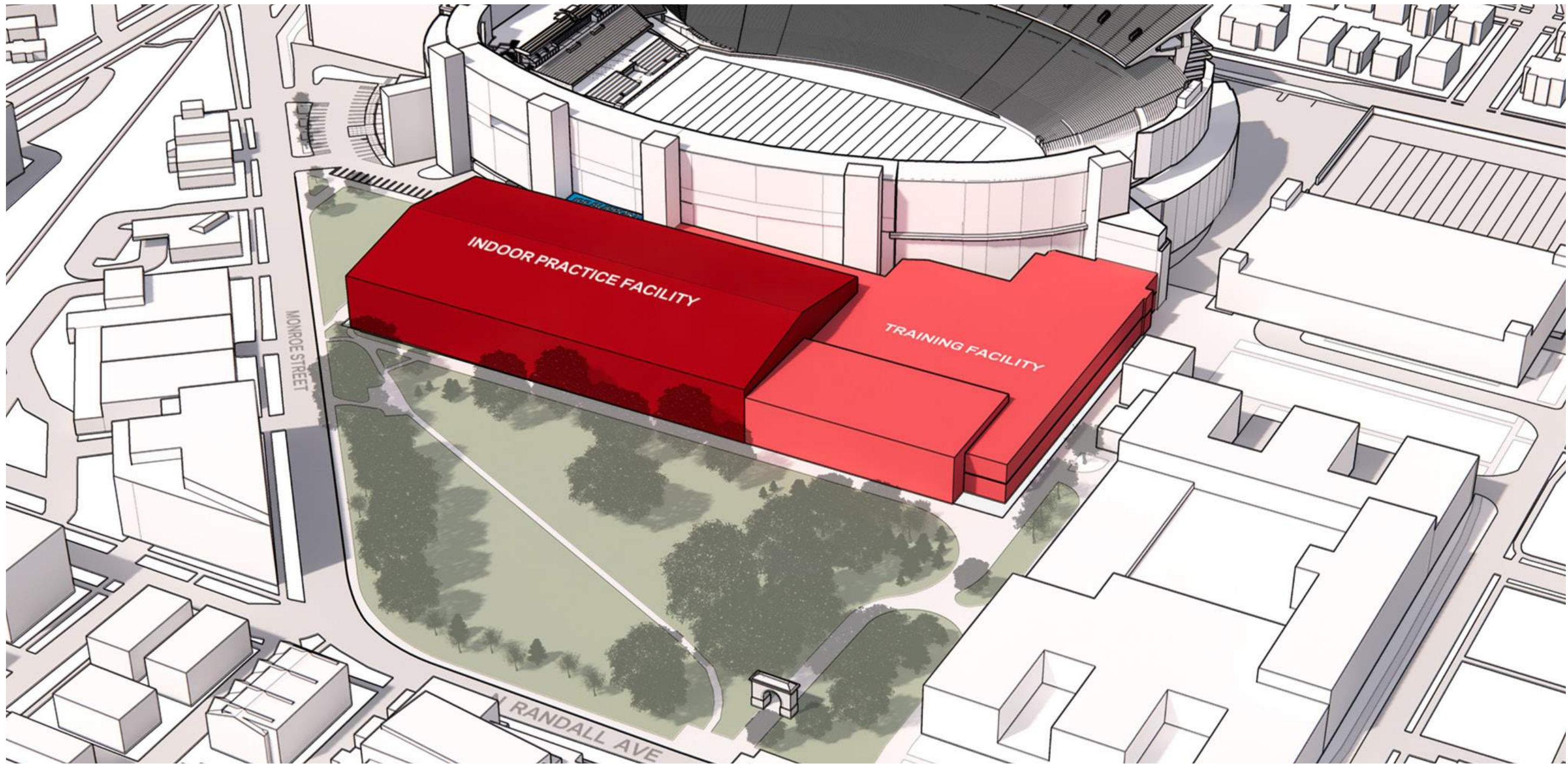

PREFERRED CONCEPT MASSING

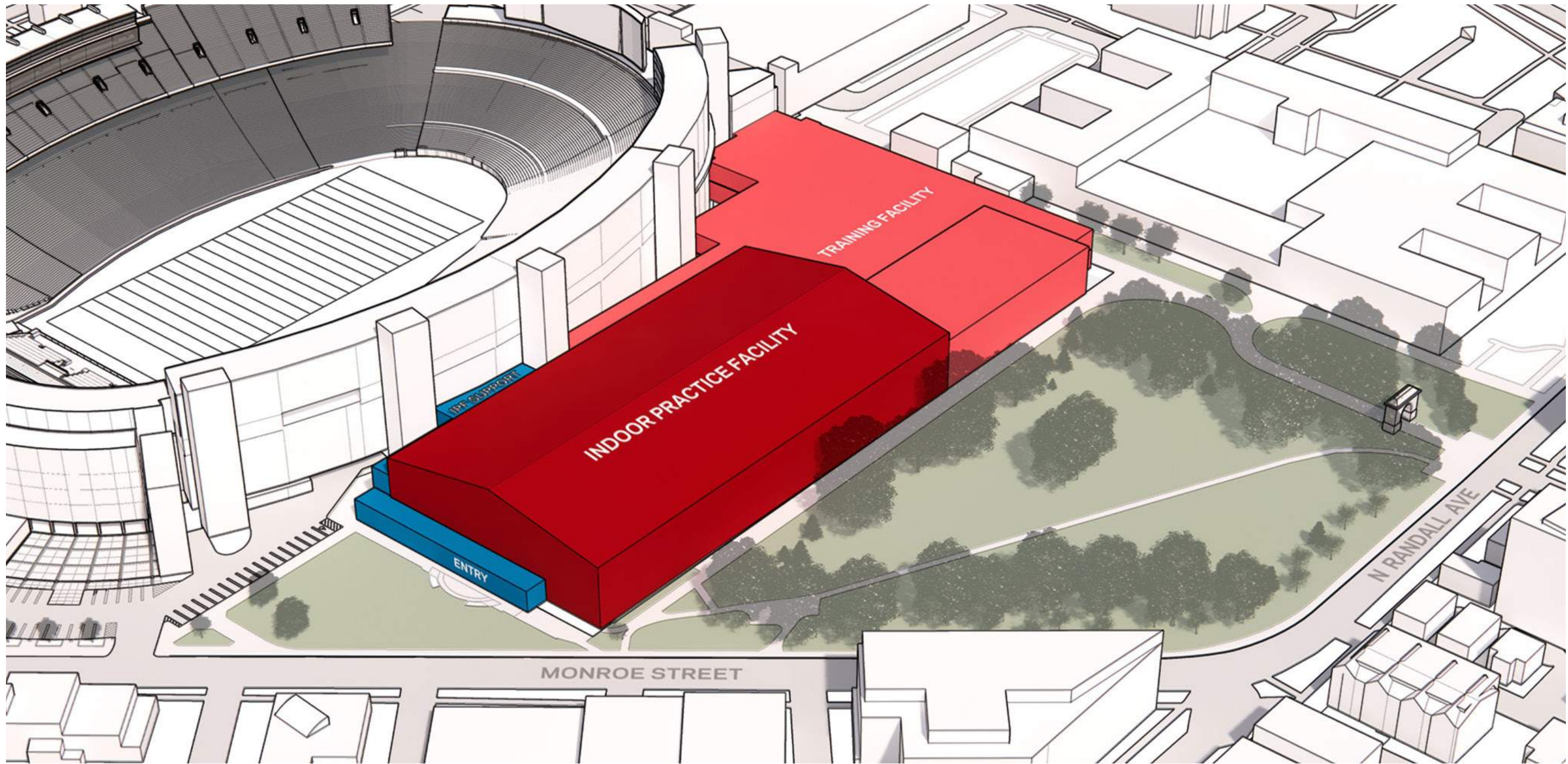

**PREFERRED CONCEPT - BASEMENT LEVEL**



PREFERRED CONCEPT - 1ST LEVEL

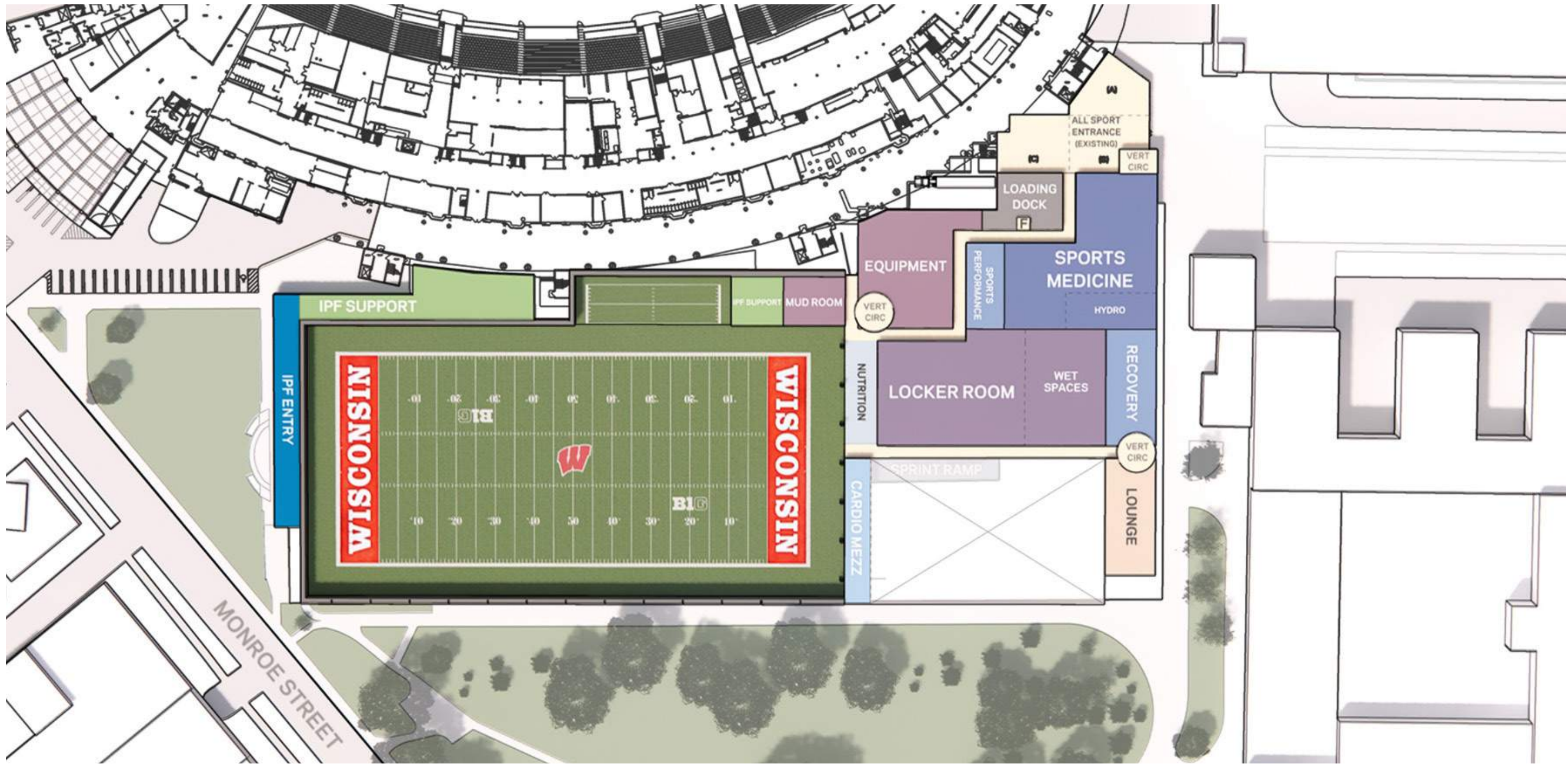

PREFERRED CONCEPT - 2ND LEVEL

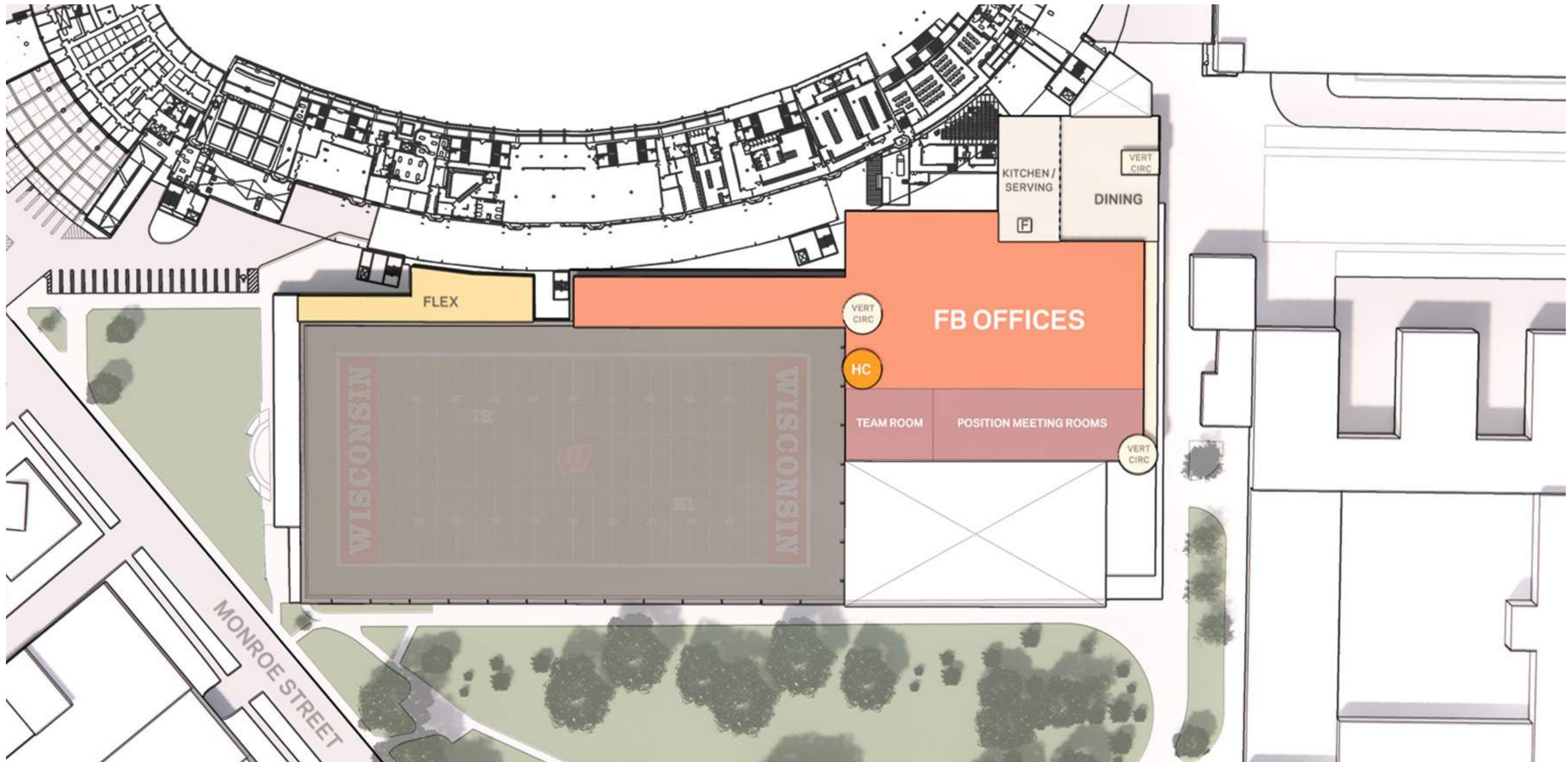



# EXISTING CAMP RANDALL MEMORIAL PARK

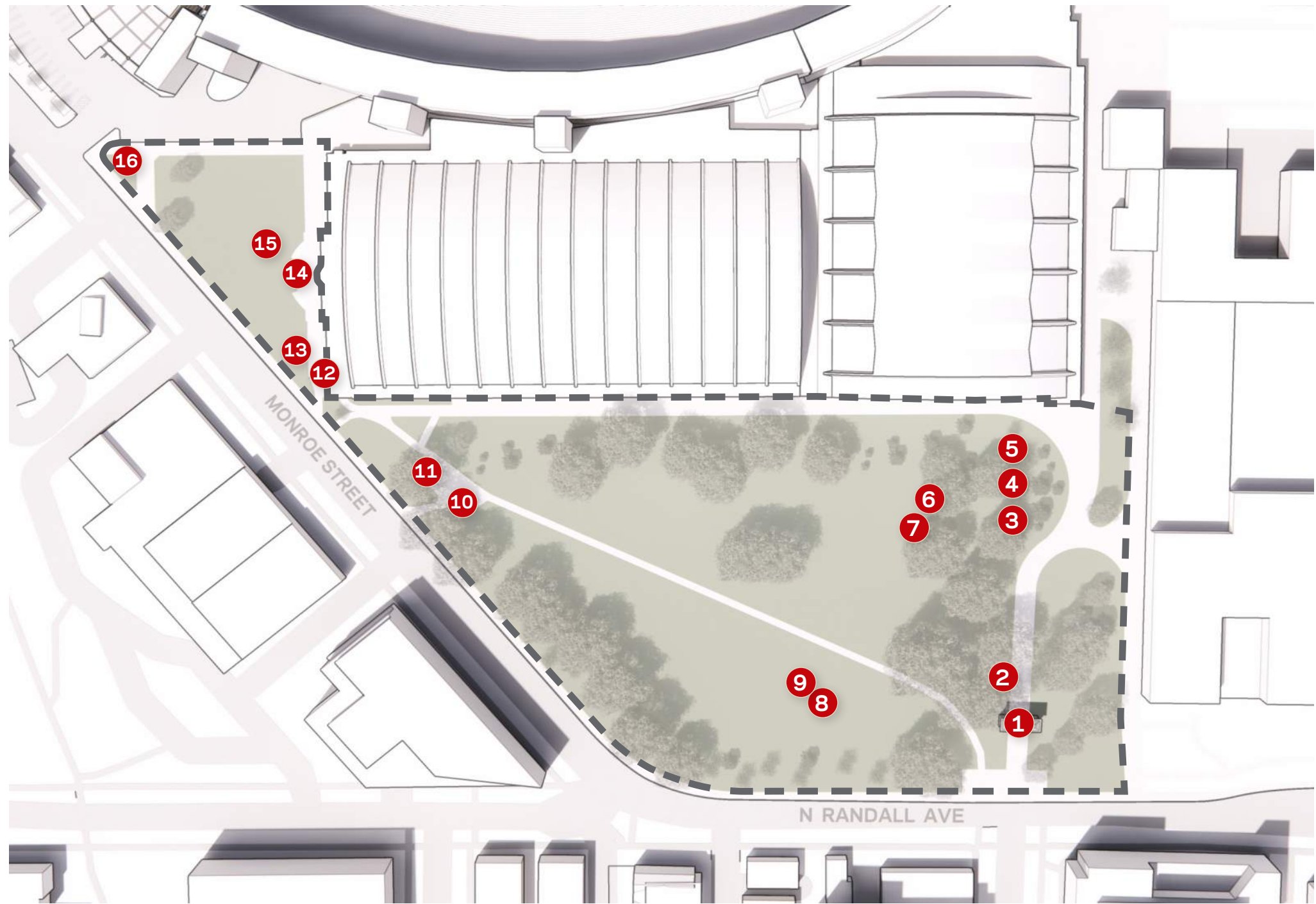

- 1. MEMORIAL ARCH
- 2. LINCOLN BICENTENNIAL SIGN
- 3. 14TH WISCONSIN VOLUNTEER INFANTRY PLAQUE
- 4. US NO. 332 CANNON
- 5. FLAG POLE
- 6. 23 WISCONSIN INFANTRY GRANITE MARKER  
GRAND ARMY OF THE REPUBLIC STONE BENCH BY
- 7. DAUGHTERS OF UNION VETERANS OF THE CIVIL WAR
- 8. MG GREENWOOD CANNON
- 9. WISCONSIN CIVIL WAR SESQUICENTENNIAL MEMORIAL
- 10. CAMP RANDALL HISTORICAL MARKER BY CIVIL WAR  
CENTENNIAL COMMISSION
- 11. GUARDHOUSE
- 12. CAMP RANDALL MEMORIAL PLAQUE
- 13. LOWE MEMORIAL STONE BENCH
- 14. ATHLETIC HALL OF FAME TERRACE PLAQUES AND  
PAVERS
- 15. MG & CO. CANNON
- 16. THE FIGHTING WISCONSIN BADGER