

VARIANCE FEES

MGO \$50.00
 COMM \$490.00
 Priority - Double above

PETITION FOR VARIANCE APPLICATION

City of Madison
 Building Inspection
 Division
 126 S. Hamilton St.
 Madison, WI 53703
 (608) 266-4568

Amount Paid
 11-6-18

Name of Owner LORENZ & CHRISTINE MULLER	Project Description TWO-STORY ADDITION	Agent, architect, or engineering firm CAPITAL BUILDERS INC.
Company (if applies)		No. & Street 6400 GISHOLT DR. 105 STE.
No. & Street 3937 REGENT ST.	Tenant name (if any)	City, State, Zip Code MADISON, WI 53713
City, State, Zip Code MADISON, WI 53705	Building Address 3937 REGENT ST.	Phone 608-222-9480
Phone 650-714-6605		Name of Contact Person DANIEL WANKE
e-mail casnuller1@gmail.com		e-mail capitalbuilders@tds.net

1. The rule being petitioned reads as follows: (Cite the specific rule number and language. Also, indicate the nonconforming conditions for your project.)
 MGO 29.99
 ADULTS ~~SPS 322.01 (1) THIS CHAPTER APPLIES TO ALL ONE AND TWO FAMILY DWELLINGS COVERED BY THIS CODE THAT USE ANY AMOUNT OF NON-RENEWABLE ENERGY FOR HEAT GENERATION. GAS FIREPLACE INSTALLED IN THREE SEASON PORCH.~~

2. The rule being petitioned cannot be entirely satisfied because:
~~ADDITION TO RESIDENCE IS COMPLETELY FINISHED AND BUILT IN GOOD FAITH PER PLANS THAT WERE REVIEWED AND APPROVED WHEN PERMIT WAS ISSUED. IT IS NOT FEASIBLE TO COMPLETELY REMOVE FIREPLACE AND VENTING FROM PORCH.~~

3. The following alternatives and supporting information are proposed as a means of providing an equivalent degree of health, safety, and welfare as addressed by the rule:

_____ The plans clearly stated that the three season porch had EZ Screen porch windows and the
 _____ fireplace was shown as a direct vent gas unit. Copies of those plan pages are attached. The
 _____ same building inspector reviewed and approved these plans before permit was issued, and also
 _____ did the subsequent on site inspections during construction. The fireplace in porch was never
 _____ brought up until the final inspection. The rule in question is part of the energy code and the
 _____ fireplace is not a safety issue. In addition, this porch has insulation in the walls, floor, and
 _____ ceiling. Fireside Hearth, who installed the gas fireplace, has installed 11 fireplaces in screen
 _____ porches within the past year in the area including in communities of Fitchburg, Sun Prairie,
 _____ Verona, and Waunakee, and all of these projects were approved by the building inspectors.

VERIFICATION BY OWNER - PETITION IS VALID ONLY IF NOTARIZED AND ACCOMPANIED BY A REVIEW FEE AND ANY REQUIRED POSITION STATEMENTS.

Note: Petitioner must be the owner of the building. Tenants, agents, contractors, attorneys, etc. may not sign the petition unless a Power of Attorney is submitted with the Petition for Variance Application.

Lorenz & Christine Muller, being duly sworn, I state as petitioner that I have read the foregoing petition, that I believe it to be true, and I have significant ownership rights in the subject building or project.

Signature of owner <i>Lorenz & Christine Muller</i>	Subscribed and sworn to before me this date:
Notary public	My commission expires:

NOTE: ONLY VARIANCES FOR COMMERCIAL CODES ARE REQUIRED TO BE NOTARIZED.

- 4 FIREPLACE SURROUND REQUIRED. SEE SPECIFICATIONS.
- 5 CABINETY AND COUNTERTOPS BY GENERAL CONTRACTOR.

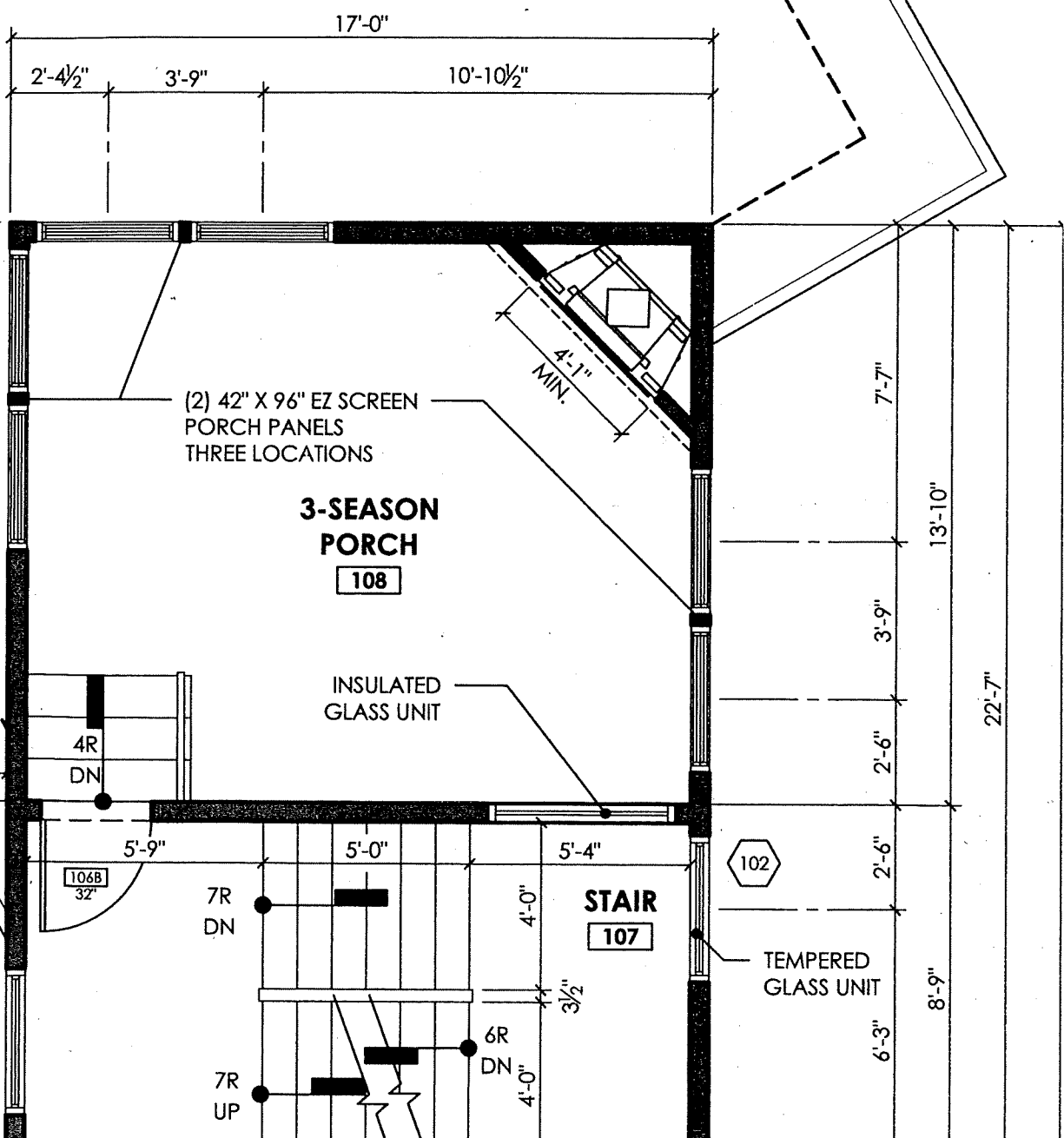

17'-0"
 2'-4½"
 3'-9"
 10'-10½"

(2) 42" X 96" EZ SCREEN PORCH PANELS
 THREE LOCATIONS

3-SEASON PORCH
 108

INSULATED GLASS UNIT

4R
 DN

106B
 32'

7R
 DN

STAIR
 107

7R
 UP

6R
 DN

TEMPERED GLASS UNIT

101

102

7'-7"
 13'-10"
 3'-9"
 2'-6"
 2'-6"
 6'-3"
 8'-9"
 22'-7"

4'-1"
 MIN.

5'-9"

5'-0"

5'-4"

4'-0"

3/2"

4'-0"

SHARD & BATTEN SIDING
MATCH EXISTING

SLOPED CEILING AT
SECOND FLOOR STAIR

3'-0"

E.I.F.S.

3'-0"

2'-6"

GENERAL CONTRACTOR
TO VERIFY LOCATION OF
FIREPLACE VENTILATION

3-SEASON PORCH
FLOOR LINE

E.I.F.S.

8'-6 1/2"

