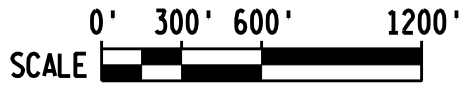
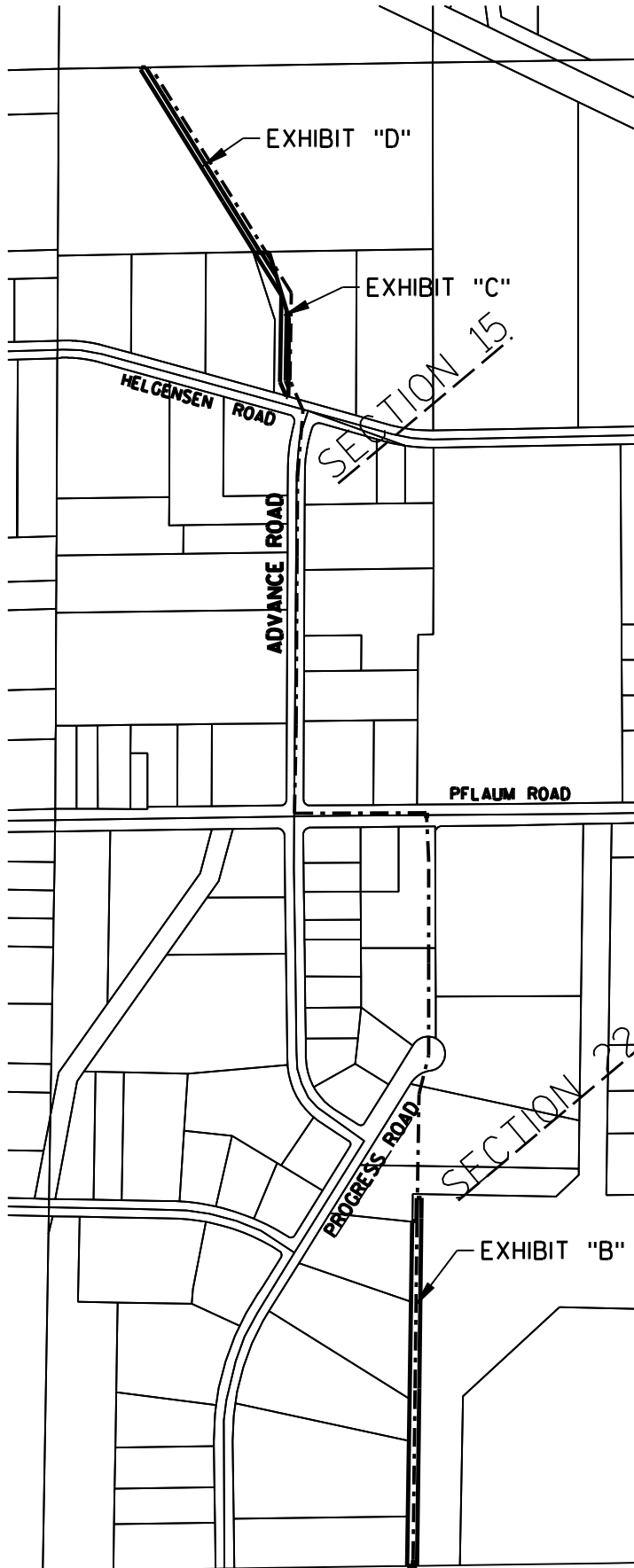

EXHIBIT "A"

LOCATION SKETCH FOR EXHIBITS "B", "C" AND "D"
LOCATED IN PART OF SW 1/4, SECTION 15 AND IN PART
OF THE SW1/4 OF THE NW 1/4, SECTION 22, ALL IN
TOWNSHIP 7 NORTH, RANGE 10 EAST, CITY OF MADISON,
DANE COUNTY, WISCONSIN



THIS INSTRUMENT WAS
DRAFTED BY EARTH TECH
EARTH TECH, INC.
MADISON, WI.

SHEET OF

OWNER:
CITY OF MADISON
215 MARTIN LUTHER KING JR. BLVD
MADISON, WI 53703