

SITE PLAN KEY: **Nob Hill Apartments**

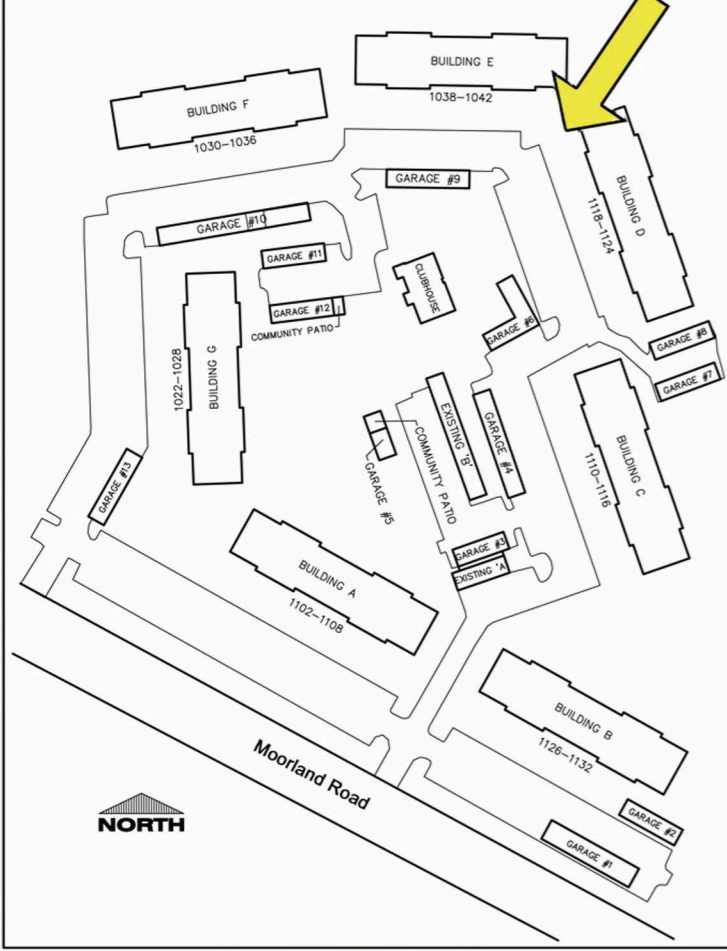

NOB HILL APARTMENTS

PROPOSED LIFE SAFETY IMPROVEMENTS

- **Lighting Plan**
- **Security Cameras**
- **Apartment Call System**
- **Upgraded Fire Alarm**

FEATURES & SPECIFICATIONS

INTENDED USE – Ideal for parking areas, street lighting, walkways and car lots.

CONSTRUCTION – Rugged, die-cast, soft corner aluminum housing with 0.12" nominal wall thickness. Die-cast door frame has impact-resistant, tempered, glass lens that is fully gasketed with one-piece tubular silicone.

Finish: Standard finish is dark bronze (DOB) polyester powder finish, with other architectural colors available.

OPTICS – Anodized, aluminum reflectors: IES full cutoff distributions R2 (asymmetric), R3 (asymmetric), R4 (forward throw) and R55 (square) are interchangeable. High-performance anodized, segmented aluminum reflectors IES full cutoff distributions SR2 (asymmetric), SR3 (asymmetric) and SR4SC (forward throw, sharp cutoff). High-performance reflectors attach with tool-less fasteners and are rotatable and interchangeable.

ELECTRICAL – Ballast: High pressure sodium: 70-150W is high reactance, high power factor. Constant wattage autotransformer for 200-400W. Metal halide: 70-150W is high reactance, high power factor and is standard with pulse-start ignitor technology. "SCWA" not required. Constant wattage autotransformer for 175-400W. Super CWA (pulse start ballast), 88% efficient and EISA legislation compliant, is required for metal halide 151-400W (SCWA option) for US shipments only. CSA, NOM or INTL required for probe start shipments outside of the US. Pulse-start ballast (SCWA) required for 200W, 320W, or 350W. Ballast is 100% factory-tested.

Socket: Porcelain, horizontally oriented medium base socket for 70-150M. Mogul base socket for 175M and above, and 70-400S, with copper alloy, nickel-plated screw shell and center contact. UL listed 1500W, 600V.

LISTINGS – UL Listed (standard). CSA Certified (see Options). UL listed for 25°C ambient and wet locations. IP65 rated in accordance with standard IEC 529.

Specifications subject to change without notice.

| |
|----------------|
| Catalog Number |
| Notes |
| Type |

CONTOUR
SERIES

Soft Square Lighting

KAD



Specifications

EPA: 1.2 ft.²
 *Weight: 35.9 lbs (16.28 kg)
 Length: 17-1/2 (44.5)
 Width: 17-1/2" (44.5)
 Depth: 7-1/8 (18.1)
 All dimensions are inches (centimeters) unless otherwise specified.
 *Weight as configured in example below.

METAL HALIDE: 70-400W
 HIGH PRESSURE SODIUM: 70-400W
 20" TO 35" MOUNTING

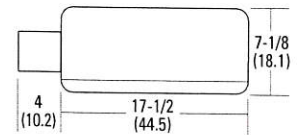

ORDERING INFORMATION

For shortest lead times, configure product using **bolded options**.

Example: KAD 400M R3 TB SCWA SPD04 LPI

| KAD | Wattage | | | Distribution | | Voltage | Ballast | Mounting ¹² | |
|-----|---|--|---|--|--|--|---|--|---|
| KAD | Metal halide 70M ^{1,2} 250M⁵ 100M ¹ 320M ⁴ 150M 350M ^{1,4} 175M ³ 400M^{5,6} 200M ⁴ | High pressure sodium ¹ 70S 100S 150S 250S 400S | Ceramic metal halide 70MHC ^{1,2} 100MHC ¹ 150MHC | Standard reflectors R2 IES type II asymmetric ⁷ R3 IES type III asymmetric ⁷ R4 IES type IV forward throw ⁷ R55 IES type V square | High performance reflectors ⁸ SR2 IES type II asymmetric ⁷ SR3 IES type III asymmetric ⁷ SR4SC IES type IV forward throw | 120 208 ⁹ 240 ⁹ 277 347 480 ⁹ TB¹⁰ 23050HZ ¹¹ | (blank) Magnetic ballast CWI Contant wattage isolated ¹¹ Pulse Start SCWA Super CWA pulse-start ballast NOTE: For shipments to U.S. territories, SCWA must be specified to comply with EISA. | Ships in fixture carton SPD___ Square pole RPD___ Round pole WBD___ Wall bracket WWD___ Wood or pole wall Ships separately ^{13,14} DAD12P Degree arm (pole) DAD12WB Degree arm (wall) WBA Decorative wall bracket ¹⁵ KMA Mast arm external fitter KTMB Twin mounting bar | Arm length 04 4" arm 06 6" arm 09 9" arm 12 12" arm |

| Options | Finish ²⁰ | Lamp ²¹ |
|---|--|---|
| Shipped installed in fixture SF Single fuse (120, 277, 347V) ¹⁶ DF Double fuse (208, 240, 480V) ¹⁶ PD Power tray ¹⁷ PER NEMA twist-lock receptacle only (no photocontrol) QRS Quartz restrrike system ¹⁸ | (blank) Dark bronze DWH White DBL Black DMB Medium bronze DNA Natural aluminum | LPI Lamp included L/LP Less lamp Consistent with LEED® goals & Green Globes™ criteria for light pollution reduction |
| QRSTD QRS time delay ¹⁸ WTB Terminal wiring block ¹⁷ CSA CSA Certified INTL Available MH for probe start shipping outside the U.S. REGC1 California Title 20, effective 1/1/2010 | Shipped separately ¹³ HS House side shield PE1 NEMA twist-lock PE (120, 208, 240V) PE3 NEMA twist-lock PE (347V) PE4 NEMA twist-lock PE (480V) PE7 NEMA twist-lock PE (277V) SC Shorting cap for PER option VG Vandal guard ¹⁹ WG Wire guard ¹⁹ | |

Notes

- Not available with SCWA.
- Not available with 480V.
- These wattages do not comply with California Title 20 regulations.
- Must be ordered with SCWA.
- These wattages require the REGC1 option to be chosen for shipments into California for Title 20 compliance. 250M REGC1 is not available in 347 or 480V.
- Reduced jacket ED28 required for SR2, SR3 and SR4SC optics.
- House-side shield available.
- High performance reflectors not available with QRSTD.
- Must specify CWI for use in Canada.
- Optional multi-tap ballast (120, 208, 240, 277V; in Canada: 120, 277, 347V).
- Consult factory for available wattages.
- 9" arm is required when two or more luminaires are oriented on a 90° drilling pattern.
- May be ordered as an accessory.
- Must specify finish when ordered as an accessory.
- Available with SPD04 and SPD09.
- Must specify voltage. N/A with TB.
- Only available with SR2, SR3 and SR4SC optics.
- Max allowable wattage lamp included.
- Prefix with KAD when ordered as an accessory.
- See www.lithonia.com/archcolors for additional color options.
- Must be specified. L/LP not available with MHC.
- Must use RPD09.

Accessories: Tenon Mounting Slipfitter (RPxx required.)
 Order as separate catalog number. Must be used with pole mounting.

| Number of fixtures | | | | | | |
|--------------------|---------|----------|-----------------------|-----------------------|-----------------------|-----------------------|
| Tenon O.D. | One | Two@180° | Two@90° | Three@120° | Three@90° | Four@90° |
| 2-3/8" | T20-190 | T20-280 | T20-290 ²² | T20-320 ²² | T20-390 ²² | T20-490 ²² |
| 2-7/8" | T25-190 | T25-280 | T25-290 ²² | T25-320 | T25-390 ²² | T25-490 ²² |
| 4" | T35-190 | T35-280 | T35-290 ²² | T35-320 | T35-390 ²² | T35-490 ²² |

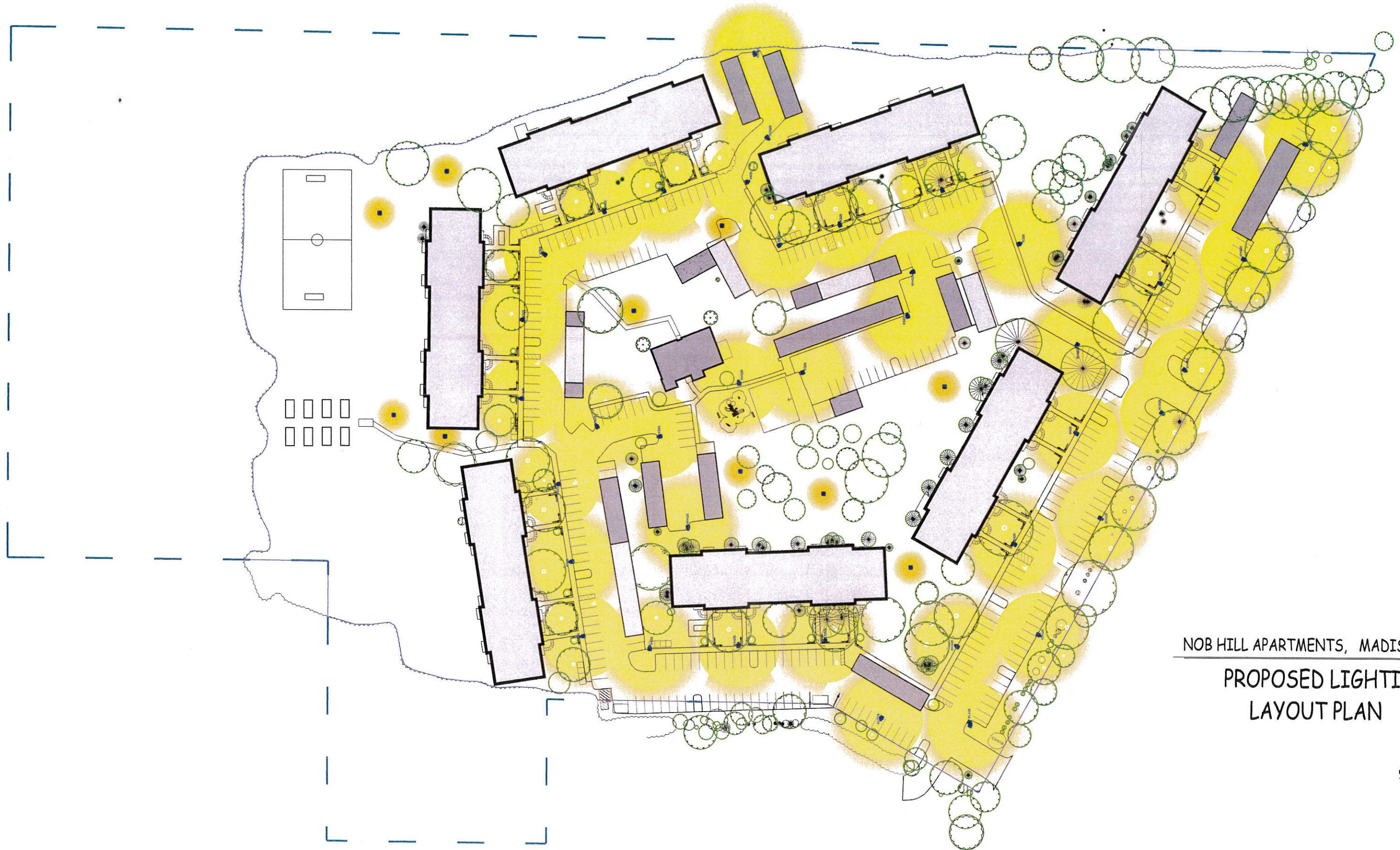

NOB HILL APARTMENTS, MADISON, WI

PROPOSED LIGHTING
LAYOUT PLAN

9/24/2012

KAD Metal Halide, Arm-mounted Soft Square Cutoff

Coefficient of Utilization _____
 Initial Footcandles _____

KAD 400M R2 Test no. 1193083101P
ISOILLUMINANCE PLOT (Footcandle)

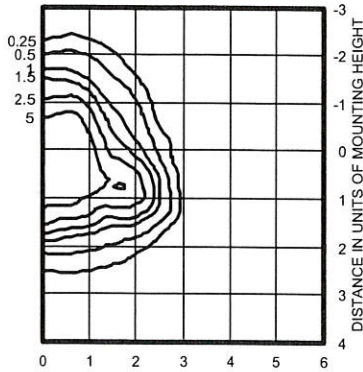

400W pulse start metal halide lamp, rated 38000 lumens. Footcandle values based on 20' mounting height.
 Classification: Type II, Short, Full Cutoff

KAD 400M R3 Test no. 1192040902P
ISOILLUMINANCE PLOT (Footcandle)

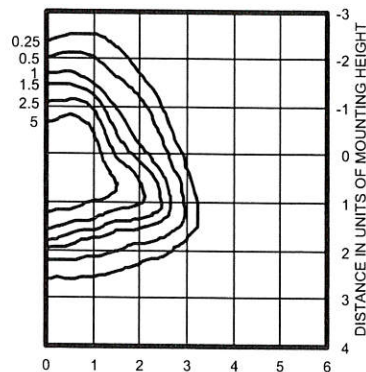

400W pulse start metal halide lamp, rated 38,000 lumens. Footcandle values based on 20' mounting height.
 Classification: Type II, Short, Full Cutoff

KAD 400M R4 Test no. 1191110101P
ISOILLUMINANCE PLOT (Footcandle)

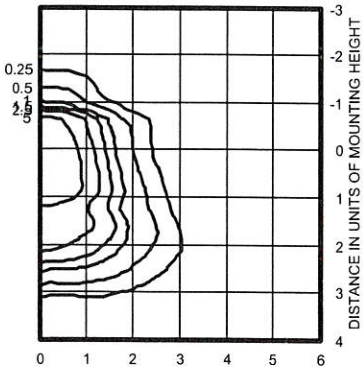

400W pulse start metal halide lamp, rated 38,000 lumens. Footcandle values based on 20' mounting height.
 Classification: Unclassified (Type III, Very Short), Full Cutoff

KAD 400M R4HS Test no. 1192061101P
ISOILLUMINANCE PLOT (Footcandle)

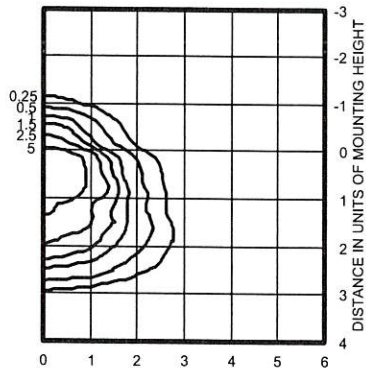

400W pulse start metal halide lamp, rated 38,000 lumens. Footcandle values based on 20' mounting height.
 Classification: Unclassified (Type III, Very Short), Full

KAD 400M R5S Test no. 1194040801P
ISOILLUMINANCE PLOT (Footcandle)

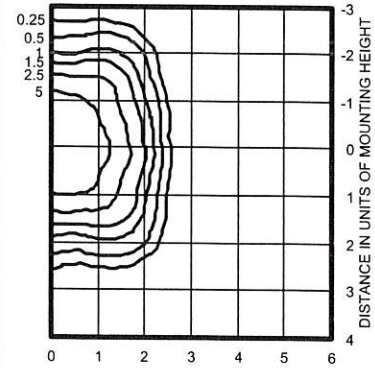

400W pulse start metal halide lamp, rated 38000 lumens. Footcandle values based on 20' mounting height.
 Classification: Unclassified (Type NC, Very Short), Full Cutoff

Notes

- 1 Photometric data for other distributions can be accessed at www.lithonia.com.
- 2 Tested to current IES and NEMA standards under stabilized laboratory conditions. Various operating factors can cause differences between laboratory data and actual field measurements. Dimensions and specifications on this sheet are based on the most current available data and are subject to change without notice.
- 3 For electrical characteristics, consult outdoor technical data specification sheets on www.lithonia.com.

Mounting Height Correction Factor

(Multiply the fc level by the correction factor)
 25 ft. = 0.64
 35 ft. = 0.32
 40 ft. = 0.25

$$\left(\frac{\text{Existing Mounting Height}}{\text{New Mounting Height}} \right)^2 = \text{Correction Factor}$$

SECURITY / SURVEILLANCE CAMERAS

Digital security and surveillance cameras will be added to the proposed improvements of the property. These digital images will be accessible through the internet for management and law enforcement personnel. Video will be stored for a maximum of three to seven days.

- (28) Interior Lobby Cameras. There are four entry lobbies in each building with an unlocked exterior door opening to the sidewalk and a locked security door to gain access to the common area. A motion censored security/surveillance indoor mini-dome type camera will be provided in each entry lobby recording all persons entering or exiting through this common area.
- (11) Exterior pole mounted 360 degree security cameras will be installed on the light poles for exterior monitoring.
- (2) High Definition fixed focus camera will be designated at the automobile lanes with the capability to photograph the license plates of each vehicle entering or exiting the complex.



NOB HILL APARTMENTS, MADISON, WI
PROPOSED SECURITY CAMERA
LAYOUT PLAN

9/24/2012

IS20/IS21 Series Camclosure® 2 Camera System

INDOOR MINI DOME, SURFACE AND FLUSH MOUNT

Product Features

- Fully Integrated Indoor Enclosure with Camera and Lens
- 3 Camera Options
 - Super Dynamic 5 (SD5)™ Day/Night Wide Dynamic Range (WDR)
 - Day/Night High Resolution
 - High Resolution Color
- Varifocal Lens
- Shipped Completely Assembled, Easy to Install
- 24 VAC or 12 VDC Operation, Autosensing
- Manual, 3-Axis (Pan/Tilt/Rotation) Positioning Allows Adjustment for Optimum Camera Rotation and Placement
- Service Connector for Video Output
- Available in Surface or Flush Mount Models with Smoked or Clear Domes
- Auto Image Stabilizer to Compensate for External Vibration

The **IS20/IS21 Series Camclosure® 2 Camera System** integrates a camera and lens package into a small, versatile indoor enclosure that can be mounted directly to, or recessed into, a ceiling or wall. The **IS20/IS21 Series** features a three-axis camera and lens positioning system that is capable of a wide variety of pan and tilt angles.

The **IS20/IS21 Series** offers three high resolution camera options suitable for a variety of indoor environments:

- **Super Dynamic 5 (SD5)™ day/night wide dynamic range (WDR):** Features a high resolution (650 TVL) color camera with auto iris, varifocal lens, and auto back focus. Application examples include environments with difficult lighting that require extremely high sensitivity and dynamic range.
- **True day/night:** Features a high resolution (540 TVL) color camera with auto iris and varifocal lens. Application examples include environments that require color images during the day but use monochrome images at night with or without supplemental IR lighting.
- **Color:** Features a high resolution (540 TVL) color camera with auto iris, simple day/night functions, and varifocal lens. For use in all general-purpose environments.

All cameras in the **IS20/IS21 Series** offer adaptive black stretch (ABS) to provide optimal image quality in dark areas by increasing the visibility in those areas without sacrificing the image quality in brighter areas. In addition, in some cameras the **IS20/IS21 Series**



IS20-DNV10S MODEL

features SuperDynamic 5 (SD5) technology, ensuring the best picture quality even in challenging environments. The Super Dynamic 5 (SD5) day/night WDR camera is equipped with auto back focus (ABF) and intelligent motion detection (i-VMD). The ABF feature automatically adjusts the camera's CCD position when installing or changing from color to black-white mode, saving time during setup and optimizing focus. The i-VMD feature is an intelligent built-in video motion detector that provides more efficient and reliable surveillance, while eliminating the loss of notification in vital scenes. Using advanced motion analytics provides the ability to accurately detect motion within a targeted area. The i-VMD analytics include three behaviors: motion detection, object abandonment/removal, and scene change detection.

The **IS20/IS21 Series** is shipped completely assembled, making installation fast and easy. To surface-mount the unit, remove it from the box, attach it to the mounting surface, and connect video and power. For recessed installations, use the supplied mounting bracket to install the unit inside a ceiling or wall.

The **IS20/IS21 Series** also features a complete line of optional mounting accessories. Optional pendant and wall mounts are available for all models, which allow the cameras to be adapted for a variety of installations. In addition, the flush mount kits allow surface mount cameras to be installed in a ceiling if the installation type should change after the original deployment.



by Schneider Electric



C3472 / REVISED 1-3-12

Spectra® HD Series IP Dome System

S5220 MODELS, HIGH DEFINITION PAN/TILT/ZOOM HIGH-SPEED DOME

Product Features

- Up to 1920 x 1080 Resolution
- 16:9 Aspect Ratio; 1080p at 30 Images per Second (ips)
- 2.0 Megapixel (MPx), 20X Optical Zoom, 12X Digital Zoom, Wide Dynamic Range (WDR) Camera
- Ability to Control and Monitor Video Over IP Networks
- Built-in Analytics Including AutoTracker and Adaptive Motion Detection
- 2 Simultaneous Video Streams: Dual H.264 and Scalable MJPEG
- 360° Continuous Pan Rotation at 280° per Second
- Supported Protocols: TCP/IP, UDP/IP (Unicast, Multicast IGMP), UPnP, DNS, DHCP, RTP, NTP, and More
- Power over Ethernet (PoE) IEEE 802.3af
- USB Expansion Slots for Alarms and Audio Accessories

Network Dome System

Pelco takes its industry-leading Spectra® Series dome into the world of high definition. **Spectra HD** delivers crystal-clear, live streaming images over the Internet using a standard Web browser (Microsoft® Internet Explorer® or Mozilla® Firefox®). With nine times the resolution of standard definition domes, **Spectra HD** is an ideal solution to view details such as faces, license plates, tattoos, playing cards (in casinos), or other specific features.

Spectra HD supports High-Profile H.264 compression, a vast improvement in quality over MPEG-4 and 20 times more efficient than M-JPEG. The dome system features open architecture connectivity for third-party software recording solutions allowing integration into virtually any IP-based HD system. It is also compatible with Digital Sentry® video management systems. As with all Pelco IP camera solutions, **Spectra HD** is Endura Enabled™ to record, manage, configure, and view multiple live streams. When connected to an Endura® HD network-based video security system, the dome system has access to EnduraStor™ and EnduraView™ for optimized image quality and bandwidth efficiency.

Spectra HD features the same ease of installation and ease of maintenance that you have come to expect from Spectra. Each dome system consists of a back box, a dome drive, and a lower dome.

Spectra HD includes a choice of four back box models: in-ceiling, environmental in-ceiling, pendant, and environmental pendant. All environmental models meet NEMA Type 4X, IP66 when properly installed.



- 16 Preset Tours, 255 Dome Presets, 32 Window Blanks
- Open IP Standards
- ONVIF v1.02 Conformant

Built-In Analytics

Pelco Analytics enhance the flexibility and performance of Spectra HD. Nine Pelco behaviors are preloaded and included as standard features. Pelco behaviors can be configured and enabled using a standard Web browser, and they are compatible with Endura or a third-party system that supports alarms using Pelco's API.

Web Interface

Spectra HD uses a standard Web browser for powerful remote setup and administration.

Window Blanking

Window blanking is used to conceal user-defined privacy areas that cannot be viewed by an operator. **Spectra HD** supports up to 32 blanked windows. A blanked area will appear on the screen as a solid gray window.

Video Systemization

Spectra HD easily connects to Pelco IP and hybrid systems such as Endura version 2.0 (or later) and Digital Sentry version 7.3 (or later). The camera is also compatible with Digital Sentry NVs (DS NVs), a full-featured video management software, which is available as a free download at www.pelco.com. DS NVs includes four free Pelco IP licenses and allows for the management of video from up to 64 cameras.

Spectra HD features open architecture connectivity to third-party software. Pelco offers an application programming interface (API) and software developer's kit (SDK) for interfacing with Pelco's IP cameras.



by Schneider Electric



C3940 / REVISED 8-28-12

APARTMENT CALL SYSTEM

A new apartment call system will be installed in each entry lobby. There are four entry lobbies in each building with an unlocked exterior door opening to the sidewalk and a locked security door to gain access to the common area hallways and then the respective individual units. Each lobby services 8-10 units depending upon the configuration.

In each entrance lobby there will be a call panel (similar to the one shown in the attached cut sheet) with a separate button to summon each individual apartment. **THERE WILL NOT BE AN ELECTRIC STRIKE ON THE SECURITY DOOR.** In the apartment unit a buzzer will sound if the call button is pushed (with the ability to be muted should the tenant desire) and a two way voice intercom between the entrance lobby and the apartment unit is activated. The tenant will need to physically leave their apartment and come to the security door to allow guest access to the building.

Five percent of the units will be ADA compatible with provisions for hearing and visually impaired.

Innovations in Communications™
since 1955



QUANTUM™

ROUND METAL BUTTON STYLE STAINLESS STEEL Vandal-Proof Intercom Lobby Panels

The **BEST** stainless steel panel, with
permanent engraving right on the faceplate.
FOR TOUGH TALK, NOTHING BEATS QUANTUM™

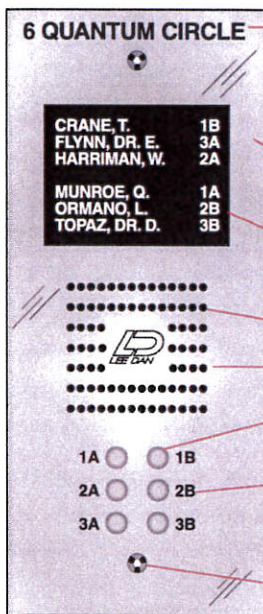

QS-006E

(Shown with optional Engraved building address and optional engraved 'LDDS' Lee Dan Directory Strips)

• Optional building address engraving foils theft (add suffix 'E' to model no.)

Standard Quantum™ Features:

- High grade 16 gauge (low carbon) Stainless Steel.
- Integral Stainless Steel/Lexan® sheet directory.
- Exclusive 3-layer metal speaker baffle.
- Mylar cone weatherproof loudspeaker.
- Heavy (6 amp rated) solid metal buttons with positive screw terminals.
- Permanent, custom engraving, directly on the panel surface.
- Custom sizing available.
- 'Tampruf' tamper-proof access screws.
- Available with any number of buttons.

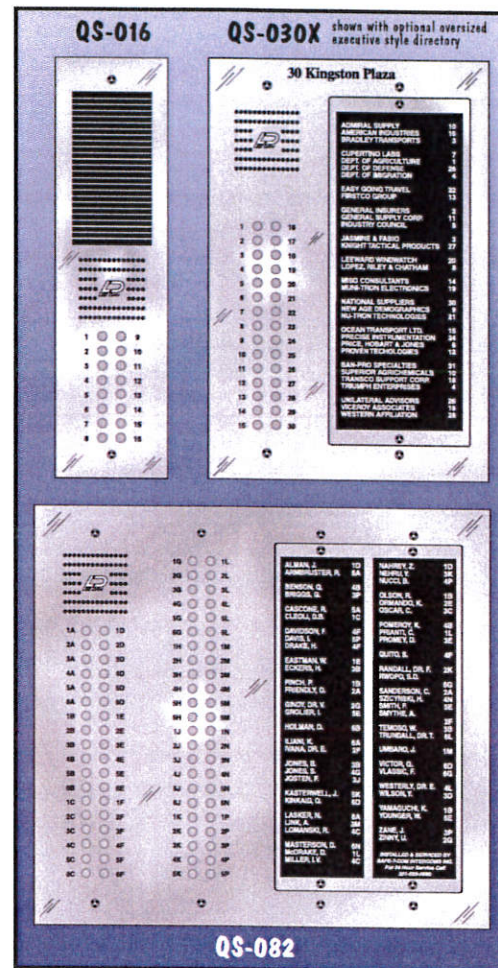

NOTE: Where shown, Directory Strips are optional.

QUANTUM™ Stainless Steel, Round Metal Button, Engraved Faceplate, Loudspeaker* (L/S) Lobby Panels

*Optional speaker equipment is available, including Bell/Buzzer, Speaker/Transmitter, Speaker/Microphone, Amplified Handset, and Speaker/Transmitter Handset. Please consult Lee Dan for wall dimensions of any Quantum™ panels other than 'QS' loudspeaker type. Contact Lee Dan for other styles including economy, vandal-resistant, oversized directory and solid polished brass.

| Number of Buttons | ALL PANELS OUTSIDE DIMENSIONS | | FLUSH PANELS | | | DIRECTORY INFO | |
|-------------------|----------------------------------|------|---------------|--------------|---------|----------------|----------------|
| | High | Wide | Flush Backbox | WALL OPENING | | Maximum Names | Strip Capacity |
| 2--6 | 11-1/2" | 5" | BB-101 | 10-1/8" | 4-1/8" | 10 | 12 |
| 7--16 | 18-3/4" | 5" | BB-201 | 16-1/8" | 4-1/8" | 24 | 26 |
| 17--36 | 18-3/4" | 10" | BB-202 | 16-1/8" | 8-1/8" | 52 | 56 |
| 37--46 | 18-3/4" | 14" | BB-203 | 16-1/8" | 12-1/8" | 52 | 56 |
| 47--82 | 18-3/4" | 18" | BB-204 | 16-1/8" | 16-1/8" | 104 | 112 |
| 83--96 | 18-3/4" | 22" | BB-205 | 16-1/8" | 20-1/8" | 104 | 112 |
| 97--128 | 18-3/4" | 26" | BB-206 | 16-1/8" | 24-1/8" | 156 | 168 |
| 129--144 | 18-3/4" | 30" | BB-207 | 16-1/8" | 28-1/8" | 156 | 168 |

For QUANTUM™ Panels Over 144 Buttons, Please Call LEE DAN®

800-231-1414 • 631-231-1414
155 Adams Avenue • Hauppauge, NY 11788-3699
www.LEEDAN.com • Fax 631-231-1498

INTERCOMS • CCTV • MAILBOXES • DIRECTORIES
ANNUNCIATORS • WIRE & CABLE • NURSE-CALL
With continuous product improvement, specifications are subject to change without notice.

LEF (Audio Only)



LE-DA*
Door Station, stainless steel faceplate, flush mount, 2-gang



EL-9S
Electric Door Strike, 12V AC, 350mA

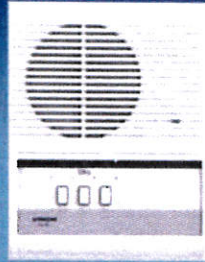

LE-A3*
3-Call Sub Station, surface mount

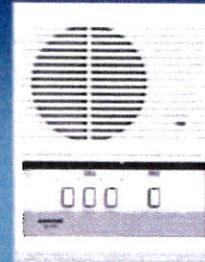

LE-AN3*
3-Call Privacy Sub Station, surface mount

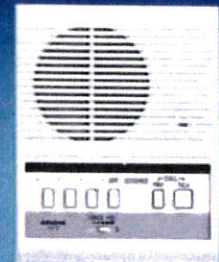

LEF-3
3-Call Master Station, surface mount

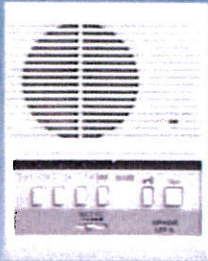

LEF-3L
3-Call Master Station with selective door release, surface mount



LEF-5
5-Call Master Station, surface mount

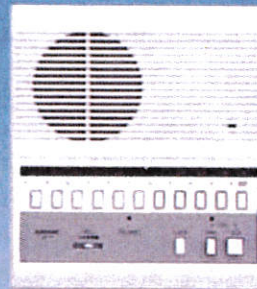

LEF-10
10-Call Master Station, surface mount

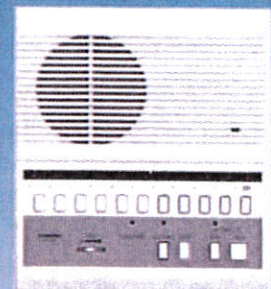

LEF-10S
10-Call Master Station with All Call, surface mount

*See back page for complete sub and door listing

Intermixable Open Voice System - Surface Mount Design

The LEF system can be designed with a variety of master and sub stations to create the communication system needed. With its design flexibility, the LEF can be used for virtually any application.

FEATURES:

- Intermix master stations, subs, and door stations up to maximum capacity
- Selective calling from a master station with hands-free reply
- Call-in from subs and doors activate tone and LED at master(s)
- Selective door release from LEF-5, 10, 10S
- Privacy feature prevents eavesdropping (all masters and "N" model subs)
- Variety of sub station models available
- Communication and call tone volume controls

OPTIONS:

- All Call, Chime, and Music input (w/LEF-10S, BG-10C and PS-1225UL)
- PanTilt black & white video door entry can be added (MK/MY series)

| Models | Capacity | Cable |
|---------|-------------|---------------|
| LEF-3 | 4 stations | 9 conductors |
| LEF-5 | 6 stations | 12 cond. (*1) |
| LEF-10 | 11 stations | 17 cond. (*2) |
| LEF-10S | 11 stations | 20 cond. (*2) |

(*1) +5 (K1 ~ K5),
(*2) +10 (K1 ~ K10)
for video and/or door release control

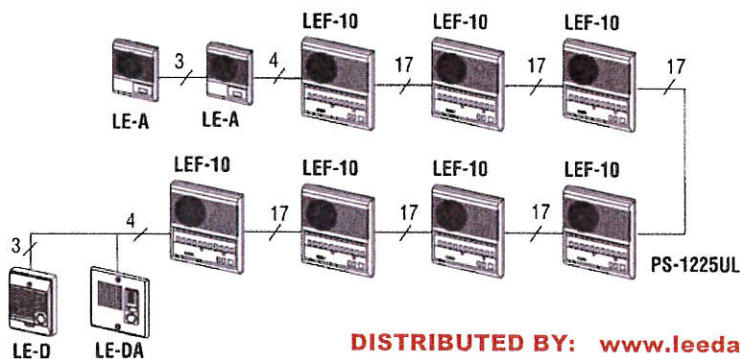

DISTRIBUTED BY: www.leedan.com
info@leedan.com Toll-Free: 800-231-1414

UPGRADES TO THE FIRE ALARM SYSTEM

A fire alarm system will be upgraded and installed in each building with an enunciator panel in a pre-designated entrance lobby of the lowest address number.

- Hard wired smoke alarms will be installed in each sleeping room and in the living area of each unit wired together with a CO detector.
- Common area corridors will have horns and strobe lights for the common area fire alarm system. Existing pull stations will remain.
- The Fire Alarm System will have battery backup.
- The Fire Alarm System will have the capacity to be monitored

Five percent of the units will be ADA compatible with provisions for hearing and visually impaired.