



Pennsylvania Avenue

UDC Initial/Final

EXISTING SITE
PHOTOS



View of South end of lot from Pennsylvania Ave.



View of North end of lot from Pennsylvania Ave.

EXISTING SITE

PHOTOS



Adjacent Site to North



Adjacent Site to South



Knabe Tool Works

Wisconsin Greenhouse Company

Pennsylvania Ave

Aerial View

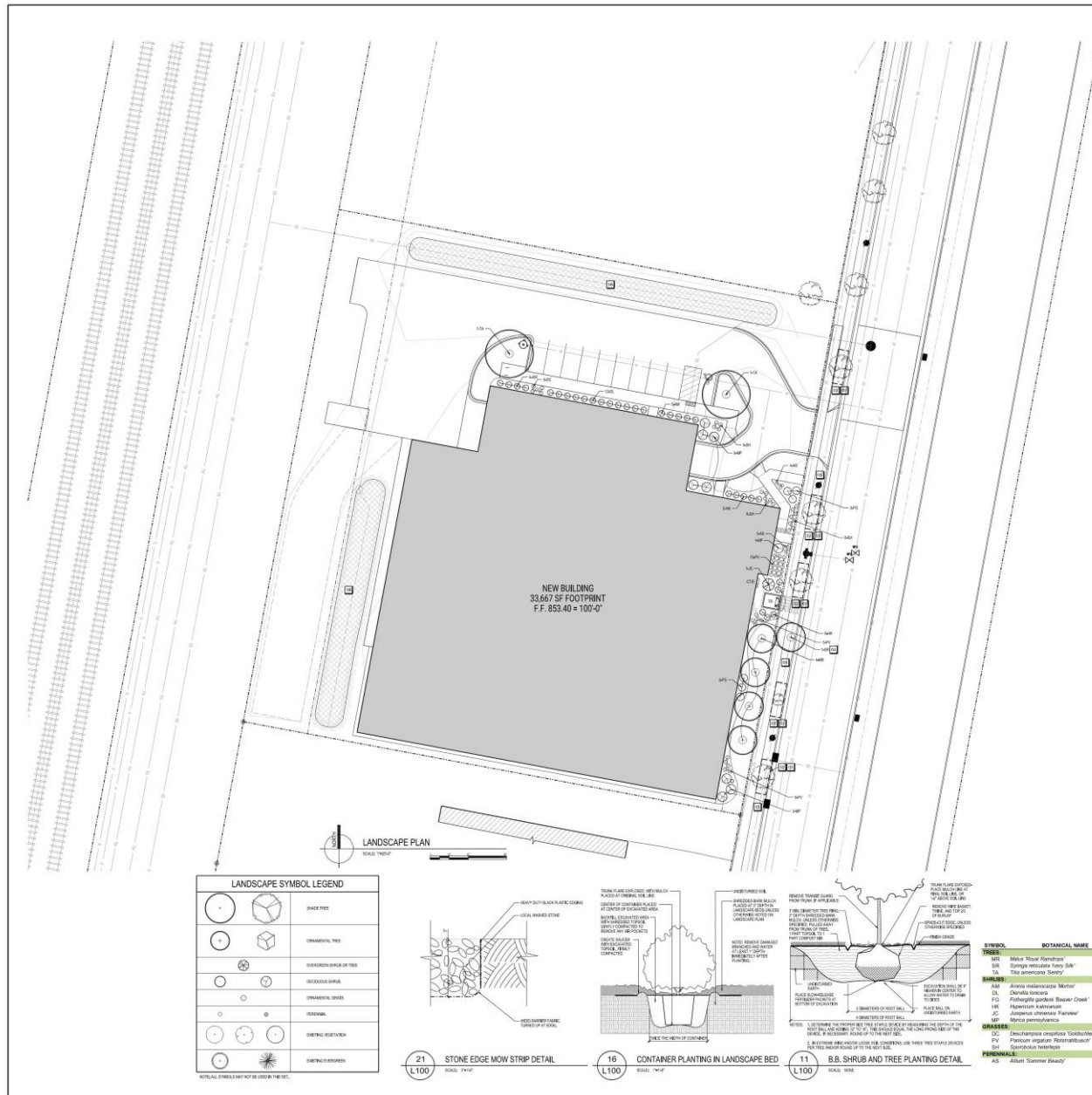

DIGGERS HOTLINE

CALL TOLL FREE 1-800-242-8511
MILWAUKEE AREA 414-258-1181
FAX A LOCATE 1-800-338-3860
TDD (HEARING IMPAIRED) 1-800-542-2289
ONLINE: www.DiggersHotline.com

- REMARKS:**
- NEW CONSTRUCTION PLANTING: SEE PLAN FOR SPECIFICATIONS AND NOTES. ALL PLANTING SHALL BE INSTALLED IN ACCORDANCE WITH THE CITY OF MADISON LANDSCAPE REQUIREMENTS. ALL PLANTING SHALL BE INSTALLED IN ACCORDANCE WITH THE CITY OF MADISON LANDSCAPE REQUIREMENTS. ALL PLANTING SHALL BE INSTALLED IN ACCORDANCE WITH THE CITY OF MADISON LANDSCAPE REQUIREMENTS.
 - NEW CONSTRUCTION PLANTING: SEE PLAN FOR SPECIFICATIONS AND NOTES. ALL PLANTING SHALL BE INSTALLED IN ACCORDANCE WITH THE CITY OF MADISON LANDSCAPE REQUIREMENTS. ALL PLANTING SHALL BE INSTALLED IN ACCORDANCE WITH THE CITY OF MADISON LANDSCAPE REQUIREMENTS. ALL PLANTING SHALL BE INSTALLED IN ACCORDANCE WITH THE CITY OF MADISON LANDSCAPE REQUIREMENTS.
 - ON THE PROJECT SITE, THE PROJECTING OWNER SHALL BE RESPONSIBLE FOR THE DESIGN AND INSTALLATION OF ALL PLANTING. THE PROJECTING OWNER SHALL BE RESPONSIBLE FOR THE DESIGN AND INSTALLATION OF ALL PLANTING. THE PROJECTING OWNER SHALL BE RESPONSIBLE FOR THE DESIGN AND INSTALLATION OF ALL PLANTING.
 - THE PROJECTING OWNER SHALL BE RESPONSIBLE FOR THE DESIGN AND INSTALLATION OF ALL PLANTING. THE PROJECTING OWNER SHALL BE RESPONSIBLE FOR THE DESIGN AND INSTALLATION OF ALL PLANTING. THE PROJECTING OWNER SHALL BE RESPONSIBLE FOR THE DESIGN AND INSTALLATION OF ALL PLANTING.
 - THE PROJECTING OWNER SHALL BE RESPONSIBLE FOR THE DESIGN AND INSTALLATION OF ALL PLANTING. THE PROJECTING OWNER SHALL BE RESPONSIBLE FOR THE DESIGN AND INSTALLATION OF ALL PLANTING. THE PROJECTING OWNER SHALL BE RESPONSIBLE FOR THE DESIGN AND INSTALLATION OF ALL PLANTING.
 - THE PROJECTING OWNER SHALL BE RESPONSIBLE FOR THE DESIGN AND INSTALLATION OF ALL PLANTING. THE PROJECTING OWNER SHALL BE RESPONSIBLE FOR THE DESIGN AND INSTALLATION OF ALL PLANTING. THE PROJECTING OWNER SHALL BE RESPONSIBLE FOR THE DESIGN AND INSTALLATION OF ALL PLANTING.
 - THE PROJECTING OWNER SHALL BE RESPONSIBLE FOR THE DESIGN AND INSTALLATION OF ALL PLANTING. THE PROJECTING OWNER SHALL BE RESPONSIBLE FOR THE DESIGN AND INSTALLATION OF ALL PLANTING. THE PROJECTING OWNER SHALL BE RESPONSIBLE FOR THE DESIGN AND INSTALLATION OF ALL PLANTING.
 - THE PROJECTING OWNER SHALL BE RESPONSIBLE FOR THE DESIGN AND INSTALLATION OF ALL PLANTING. THE PROJECTING OWNER SHALL BE RESPONSIBLE FOR THE DESIGN AND INSTALLATION OF ALL PLANTING. THE PROJECTING OWNER SHALL BE RESPONSIBLE FOR THE DESIGN AND INSTALLATION OF ALL PLANTING.
 - THE PROJECTING OWNER SHALL BE RESPONSIBLE FOR THE DESIGN AND INSTALLATION OF ALL PLANTING. THE PROJECTING OWNER SHALL BE RESPONSIBLE FOR THE DESIGN AND INSTALLATION OF ALL PLANTING. THE PROJECTING OWNER SHALL BE RESPONSIBLE FOR THE DESIGN AND INSTALLATION OF ALL PLANTING.
 - THE PROJECTING OWNER SHALL BE RESPONSIBLE FOR THE DESIGN AND INSTALLATION OF ALL PLANTING. THE PROJECTING OWNER SHALL BE RESPONSIBLE FOR THE DESIGN AND INSTALLATION OF ALL PLANTING. THE PROJECTING OWNER SHALL BE RESPONSIBLE FOR THE DESIGN AND INSTALLATION OF ALL PLANTING.

LANDSCAPE GENERAL NOTES:

- ALL PLANTING SHALL BE INSTALLED IN ACCORDANCE WITH THE CITY OF MADISON LANDSCAPE REQUIREMENTS. ALL PLANTING SHALL BE INSTALLED IN ACCORDANCE WITH THE CITY OF MADISON LANDSCAPE REQUIREMENTS. ALL PLANTING SHALL BE INSTALLED IN ACCORDANCE WITH THE CITY OF MADISON LANDSCAPE REQUIREMENTS.
- ALL PLANTING SHALL BE INSTALLED IN ACCORDANCE WITH THE CITY OF MADISON LANDSCAPE REQUIREMENTS. ALL PLANTING SHALL BE INSTALLED IN ACCORDANCE WITH THE CITY OF MADISON LANDSCAPE REQUIREMENTS. ALL PLANTING SHALL BE INSTALLED IN ACCORDANCE WITH THE CITY OF MADISON LANDSCAPE REQUIREMENTS.
- ALL PLANTING SHALL BE INSTALLED IN ACCORDANCE WITH THE CITY OF MADISON LANDSCAPE REQUIREMENTS. ALL PLANTING SHALL BE INSTALLED IN ACCORDANCE WITH THE CITY OF MADISON LANDSCAPE REQUIREMENTS. ALL PLANTING SHALL BE INSTALLED IN ACCORDANCE WITH THE CITY OF MADISON LANDSCAPE REQUIREMENTS.
- ALL PLANTING SHALL BE INSTALLED IN ACCORDANCE WITH THE CITY OF MADISON LANDSCAPE REQUIREMENTS. ALL PLANTING SHALL BE INSTALLED IN ACCORDANCE WITH THE CITY OF MADISON LANDSCAPE REQUIREMENTS. ALL PLANTING SHALL BE INSTALLED IN ACCORDANCE WITH THE CITY OF MADISON LANDSCAPE REQUIREMENTS.
- ALL PLANTING SHALL BE INSTALLED IN ACCORDANCE WITH THE CITY OF MADISON LANDSCAPE REQUIREMENTS. ALL PLANTING SHALL BE INSTALLED IN ACCORDANCE WITH THE CITY OF MADISON LANDSCAPE REQUIREMENTS. ALL PLANTING SHALL BE INSTALLED IN ACCORDANCE WITH THE CITY OF MADISON LANDSCAPE REQUIREMENTS.
- ALL PLANTING SHALL BE INSTALLED IN ACCORDANCE WITH THE CITY OF MADISON LANDSCAPE REQUIREMENTS. ALL PLANTING SHALL BE INSTALLED IN ACCORDANCE WITH THE CITY OF MADISON LANDSCAPE REQUIREMENTS. ALL PLANTING SHALL BE INSTALLED IN ACCORDANCE WITH THE CITY OF MADISON LANDSCAPE REQUIREMENTS.
- ALL PLANTING SHALL BE INSTALLED IN ACCORDANCE WITH THE CITY OF MADISON LANDSCAPE REQUIREMENTS. ALL PLANTING SHALL BE INSTALLED IN ACCORDANCE WITH THE CITY OF MADISON LANDSCAPE REQUIREMENTS. ALL PLANTING SHALL BE INSTALLED IN ACCORDANCE WITH THE CITY OF MADISON LANDSCAPE REQUIREMENTS.
- ALL PLANTING SHALL BE INSTALLED IN ACCORDANCE WITH THE CITY OF MADISON LANDSCAPE REQUIREMENTS. ALL PLANTING SHALL BE INSTALLED IN ACCORDANCE WITH THE CITY OF MADISON LANDSCAPE REQUIREMENTS. ALL PLANTING SHALL BE INSTALLED IN ACCORDANCE WITH THE CITY OF MADISON LANDSCAPE REQUIREMENTS.
- ALL PLANTING SHALL BE INSTALLED IN ACCORDANCE WITH THE CITY OF MADISON LANDSCAPE REQUIREMENTS. ALL PLANTING SHALL BE INSTALLED IN ACCORDANCE WITH THE CITY OF MADISON LANDSCAPE REQUIREMENTS. ALL PLANTING SHALL BE INSTALLED IN ACCORDANCE WITH THE CITY OF MADISON LANDSCAPE REQUIREMENTS.
- ALL PLANTING SHALL BE INSTALLED IN ACCORDANCE WITH THE CITY OF MADISON LANDSCAPE REQUIREMENTS. ALL PLANTING SHALL BE INSTALLED IN ACCORDANCE WITH THE CITY OF MADISON LANDSCAPE REQUIREMENTS. ALL PLANTING SHALL BE INSTALLED IN ACCORDANCE WITH THE CITY OF MADISON LANDSCAPE REQUIREMENTS.



City of Madison Landscape Requirements

Total SF Developed Area (Planned Area, Including Commercial and Industrial)	19,386
Site Zone 4, Possible 1 landscape point per 100 SF Developed Area	196
Minimum Points Required	196

Plant Type / Element	Points	Quantity	Points Addressed
Ornamental Tree 1.5" Cal.	35	2	70
Ornamental Tree 1.5" Cal.	15	4	60
Shrub 1.5" High, 3-4 H	10	1	10
Shrub 1.5" High, 3-4 H	3	65	195
Ornamental Grasses/Perennials 4" Cal.	2	49	98
Total Number of Points Provided			369

REVISIONS / COMMENTS

NO.	DESCRIPTION	DATE
1	ISSUE - LANDSCAPE SYMBOLS	01/25/2024

Due to electronic distribution, this drawing may not print as intended. It is the user's responsibility to verify that the drawing is printed as intended.

76850
JAD
BMA
KAU

L100







Signage



THANK YOU!