



Location

630 – 648 E Washington Avenue
& 12 N Blount Street

Project Name

Salvation Army Campus Redevelopment

Applicant

Maj. Andrew Shiels, Salvation Army

Existing Use

Existing Salvation Army shelter,
parking lot, and auto sales building

Proposed Use

Construct five-story building with a mission house, counseling and health services, and place of worship along E Washington Ave, and a separate three-story, 40-unit apartment building along E Mifflin St.

Public Hearing Dates

Plan Commission

November 11, 2019

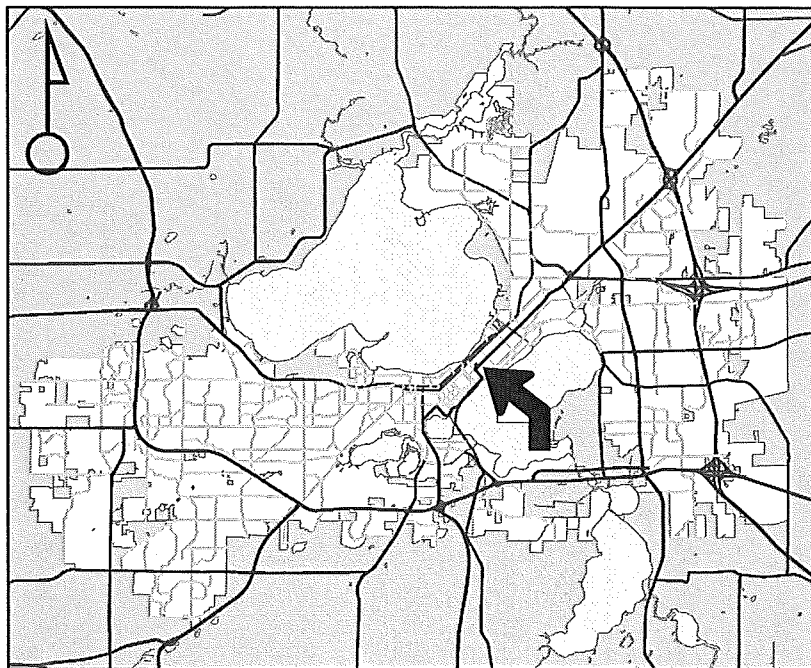

For Questions Contact: Tim Parks at: 261-9632 or tparks@cityofmadison.com or City Planning at 266-4635

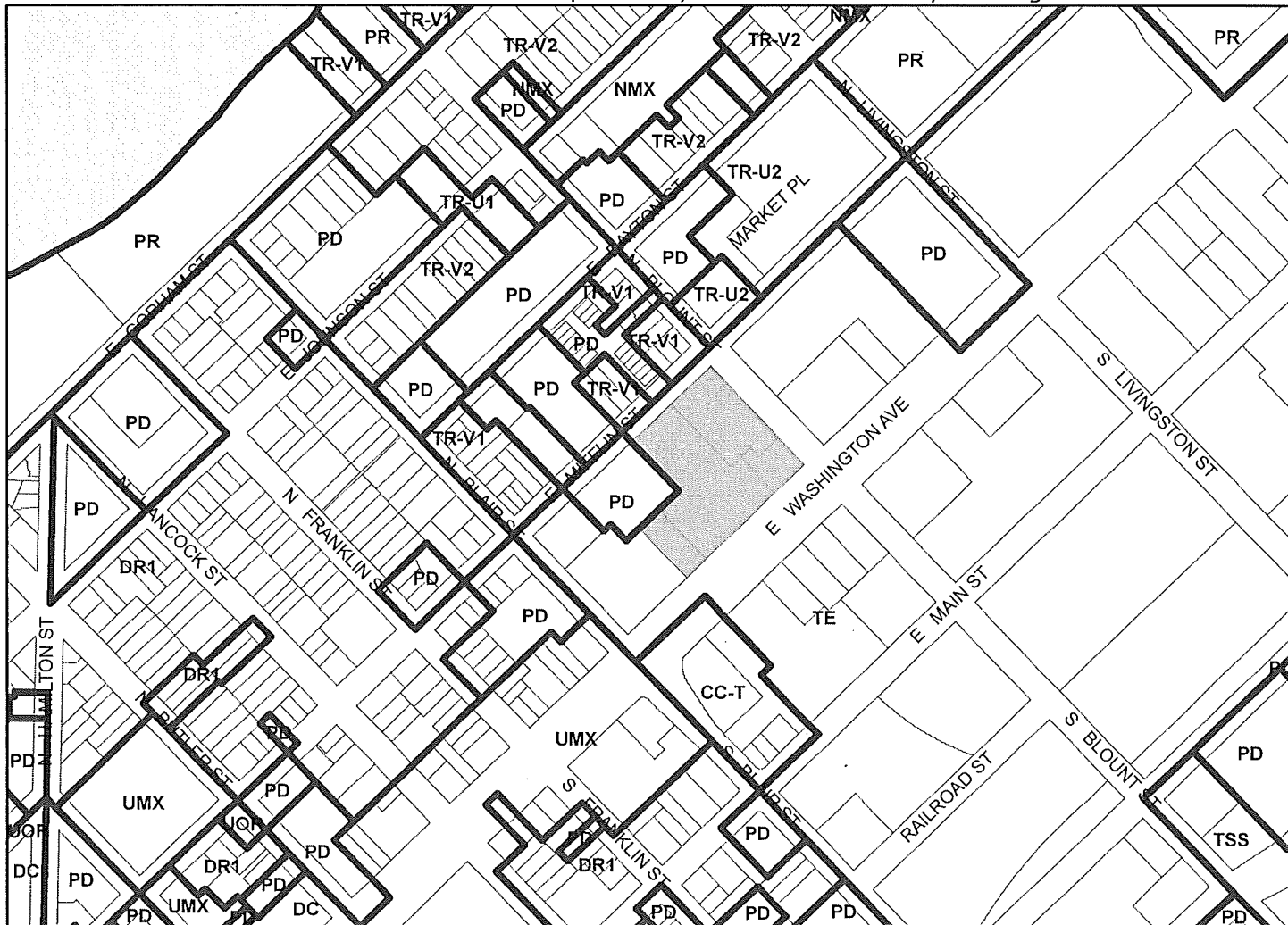

Scale : 1" = 400'

