

APPLICATION FOR
URBAN DESIGN COMMISSION
REVIEW AND APPROVAL

AGENDA ITEM # _____
Project # 23689

DATE SUBMITTED: <u>8/17/11</u>	Action Requested
UDC MEETING DATE: <u>9/7/11</u>	<input type="checkbox"/> Informational Presentation
	<input type="checkbox"/> Initial Approval and/or Recommendation
	<input checked="" type="checkbox"/> Final Approval and/or Recommendation

PROJECT ADDRESS: 1745 PARKSIDE DR.

ALDERMANIC DISTRICT: 17-CLAUSIUS

OWNER/DEVELOPER (Partners and/or Principals)

HOMETOWN BUFFET

1745 PARKSIDE DR

MADISON WI

ARCHITECT/DESIGNER/OR AGENT:

CAPITAL CITY NEON SIGN CO

2714 INDUSTRIAL DR

MADISON WI 53713 PH 6082221881

CONTACT PERSON: CHUCK ZIMMERMAN - AGENT

Address: SEE ABOVE

Phone: 608 222-1881

Fax: 608 222 1889

E-mail address: chuck.ccsigns@sbcglobal.net

TYPE OF PROJECT:

(See Section A for:)

- Planned Unit Development (PUD)
 - General Development Plan (GDP)
 - Specific Implementation Plan (SIP)
- Planned Community Development (PCD)
 - General Development Plan (GDP)
 - Specific Implementation Plan (SIP)
- Planned Residential Development (PRD)
- New Construction or Exterior Remodeling in an Urban Design District * (A public hearing is required as well as a fee)
- School, Public Building or Space (Fee may be required)
- New Construction or Addition to or Remodeling of a Retail, Hotel or Motel Building Exceeding 40,000 Sq. Ft.
- Planned Commercial Site

(See Section B for:)

- New Construction or Exterior Remodeling in C4 District (Fee required)

(See Section C for:)

- R.P.S.M. Parking Variance (Fee required)

(See Section D for:)

- Comprehensive Design Review* (Fee required)
- Street Graphics Variance* (Fee required)
- Other _____

*Public Hearing Required (Submission Deadline 3 Weeks in Advance of Meeting Date)

Where fees are required (as noted above) they apply with the first submittal for either initial or final approval of a project.

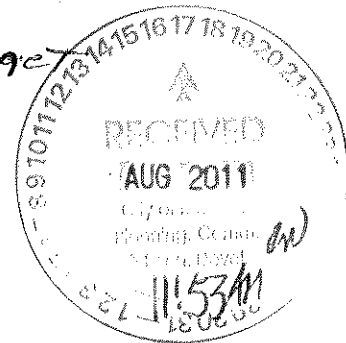







S1

Illuminated Letterset - (Qty. 1)

Remove existing letterset. Patch and paint as required. Install new illuminated letterset.

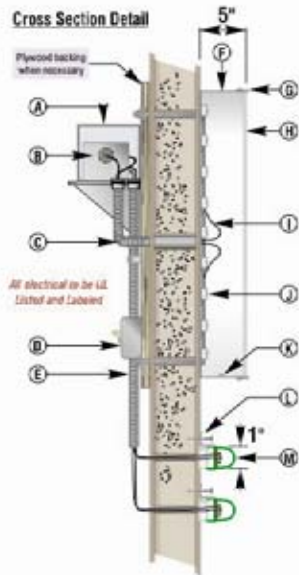

precoat Dark Bronze aluminum return

#2415 Red Acrylic faces

red LED modules

Gold trim cap

White acrylic disk with Arlon 2510 Red vinyl. Stud mount.

- A transformer housing
- B power supply
- C conduit
- D listed disconnect switch
- E primary electrical source
- F aluminum return
- G face retainer (trim cap or alum.)
- H acrylic face
- I supply wire
- J LED module
- K weep holes (2 per element)
- L mounting angle
- M 1" green LED strips

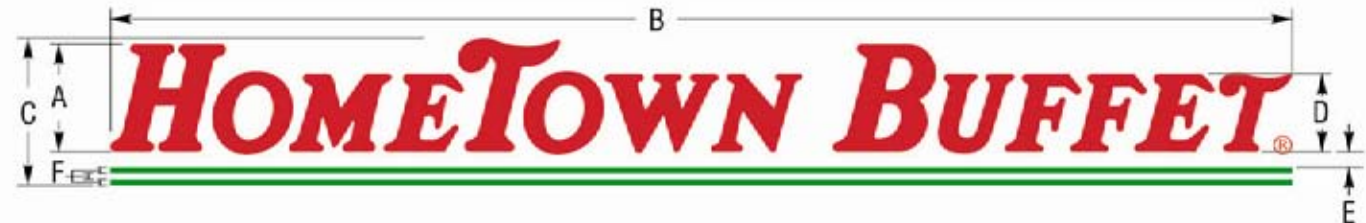

	A	B	C	D	E	F	Sf (BxC)
HTB-RMT-INLINE-R42	3'-6"	38'-3"	4'-3"	2'-6 5/16"	6"	1"	162.56

S10b Illuminated Letterset - (Qty. 1)

Remove existing letterset. Patch and paint as required. Install new illuminated letterset.

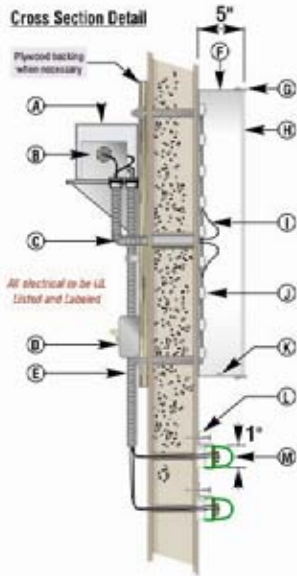

- A transformer housing
- B power supply
- C conduit
- D listed disconnect switch
- E primary electrical source
- F aluminum return
- G face retainer (trim cap or alum.)
- H acrylic face
- I supply wire
- J LED module
- K weep holes (2 per element)
- L mounting angle
- M 1" green LED strips

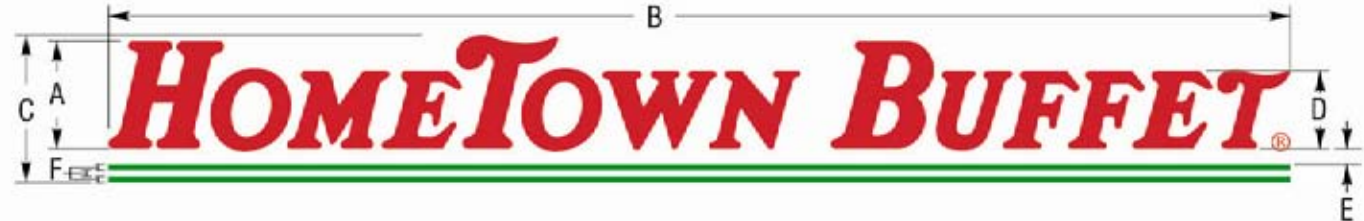

	A	B	C	D	E	F	Sf (BxC)
HTB-RMT-INLINE-R30	2'-6"	27'-3 7/8"	3'-1 5/16"	1'-9 11/16"	4 5/16"	1"	84.69

S2a

Illuminated Letterset - (Qty. 1)

Remove existing letterset. Patch and paint as required. Install new illuminated letterset.

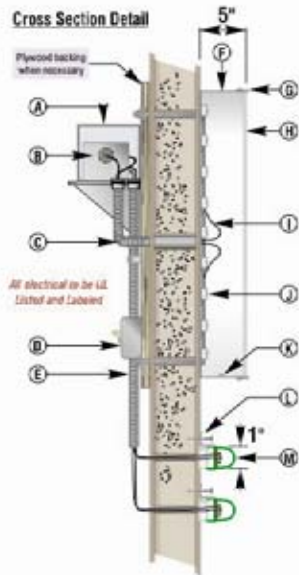

precoat Dark Bronze aluminum return

#2447 White Acrylic faces

white LED modules

Gold trim cap

White acrylic disk with Arlon 2510 Red vinyl. Stud mount.

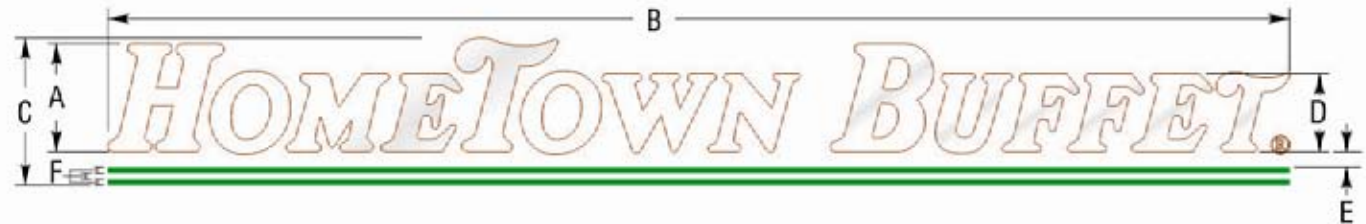

- A transformer housing
- B power supply
- C conduit
- D listed disconnect switch
- E primary electrical source
- F aluminum return
- G face retainer (trim cap or alum.)
- H acrylic face
- I supply wire
- J LED module
- K weep holes (2 per element)
- L mounting angle
- M 1" green LED strips

	A	B	C	D	E	F	Sf (BxC)
HTB-RMT-INLINE-W42	3'-6"	38'-3"	4'-3"	2'-6 5/16"	6"	1"	162.56

S3

Illuminated Letterset - (Qty. 1)

Remove existing letterset. Patch and paint as required. Install new illuminated letterset.

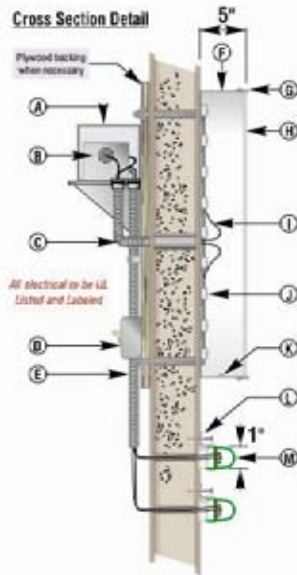

- precoat Dark Bronze aluminum return
- #2447 White Acrylic faces
- white LED modules
- Gold trim cap



White acrylic disk with Arlon 2510 Red vinyl. Stud mount.

- A transformer housing
- B power supply
- C conduit
- D listed disconnect switch
- E primary electrical source
- F aluminum return
- G face retainer (trim cap or alum.)
- H acrylic face
- I supply wire
- J LED module
- K weep holes (2 per element)
- L mounting angle
- M 1" green LED strips

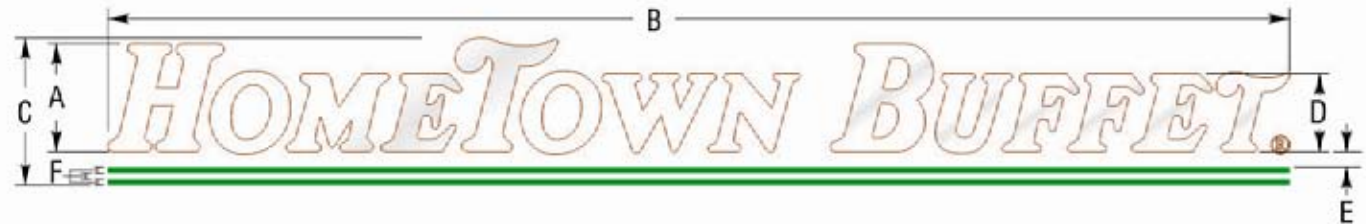

	A	B	C	D	E	F	Sf (BxC)
HTB-RMT-INLINE-W42	3'-6"	38'-3"	4'-3"	2'-6 5/16"	6"	1"	162.56

S4

Post and Panel Sign - (Qty. 1)

Remove existing Old Country Buffet post and panel sign from ground. Install new HomeTown Buffet post and panel sign. Panels to be painted red with white and Arlon 61 Kelly Green vinyl applied.

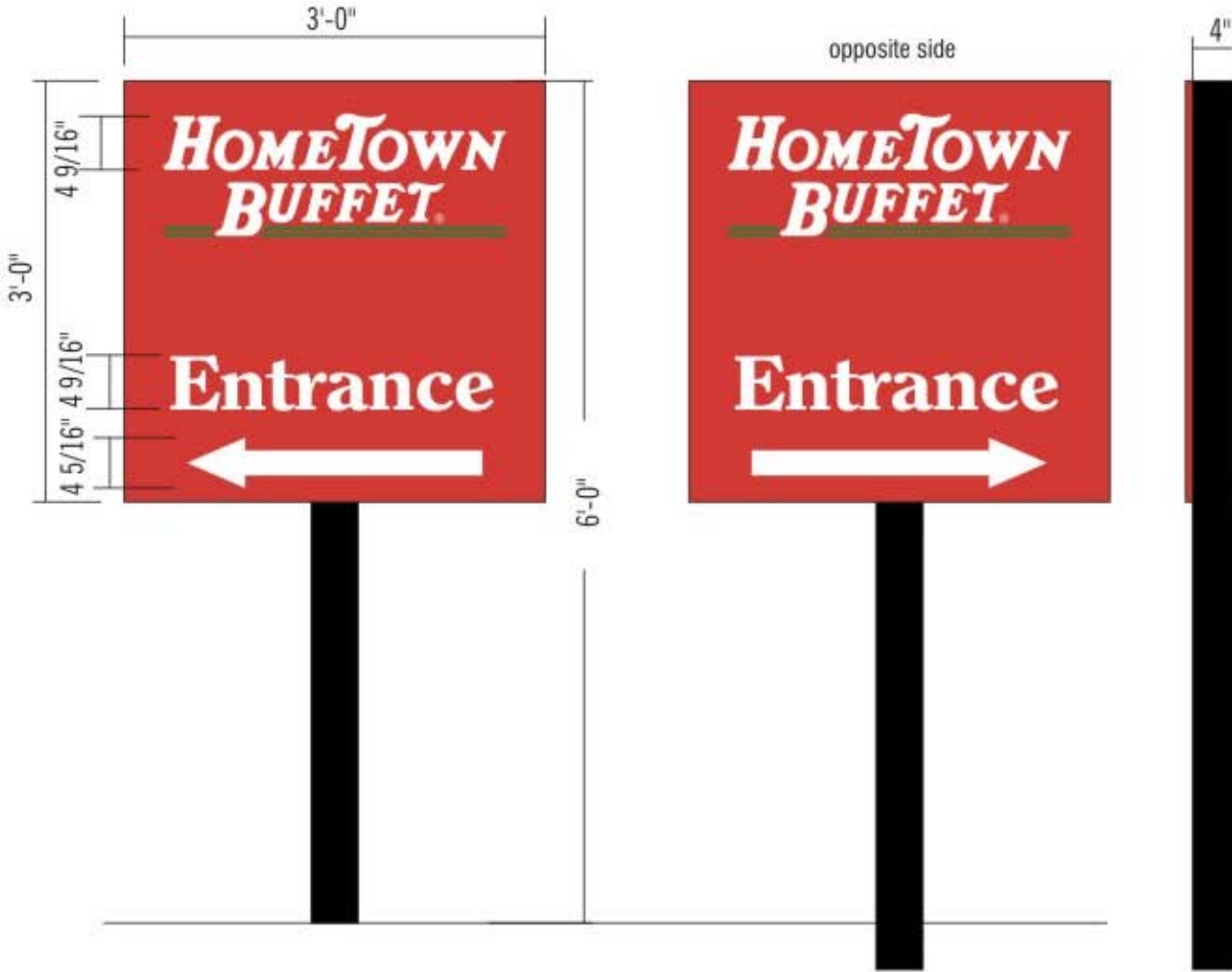

S6

Replacement & Reposition of Cabinet & Pylon

Cut pipe at grade and remove existing *Old Country Buffet* cabinet from pole. Weld new D/F illuminated *Hometown Buffet* cabinet flush to top of pole via steel saddle mount. Reposition existing readerboard cabinet directly under new *Hometown Buffet* cabinet. Readerboard cabinet to be refurbished to accept new MoonGlo changeable copy. Weld new steel baseplate to bottom of steel pipe (see details).

Relocate entire new refurbished structure to new position closer to main roadway as shown. Provide new foundation with anchor bolts as required (see notes).

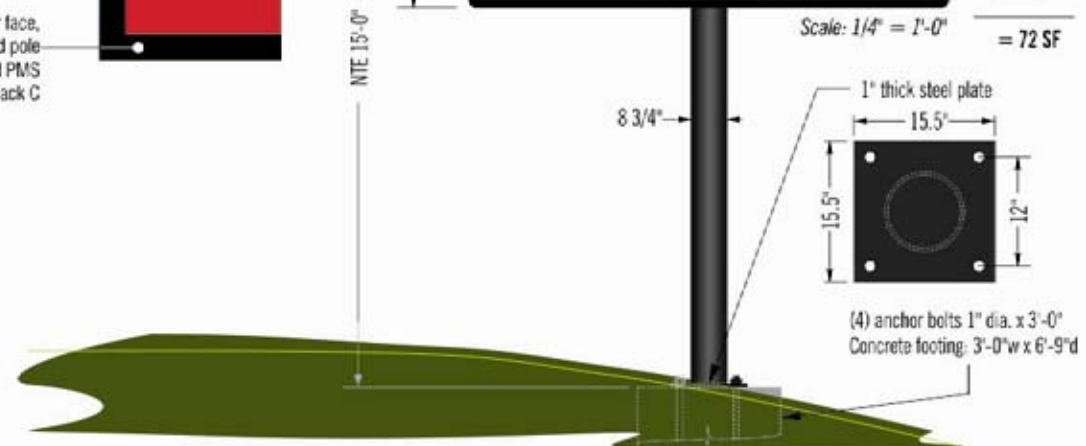
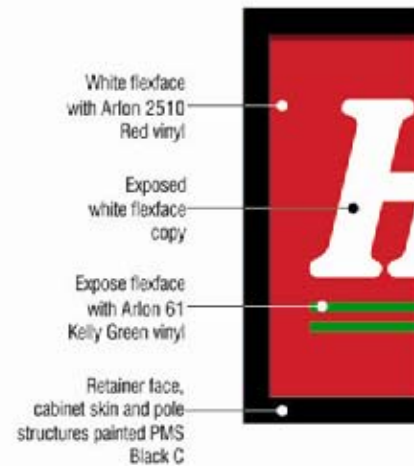
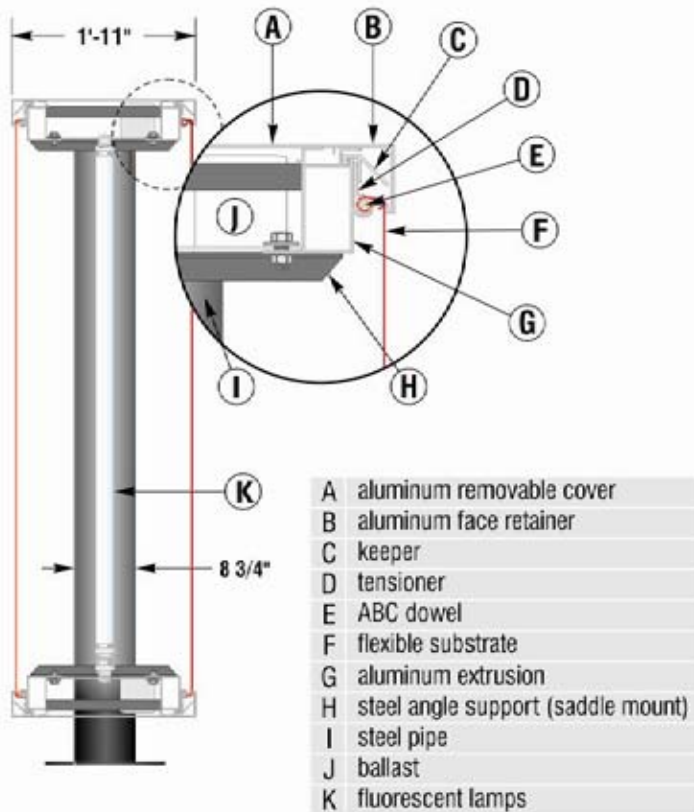

S7

Post and Panel Sign - (Qty. 1)

Remove existing Old Country Buffet post and panel sign from ground. Install new HomeTown Buffet post and panel sign. Panels to be painted red with white and Arlon 61 Kelly Green vinyl applied.

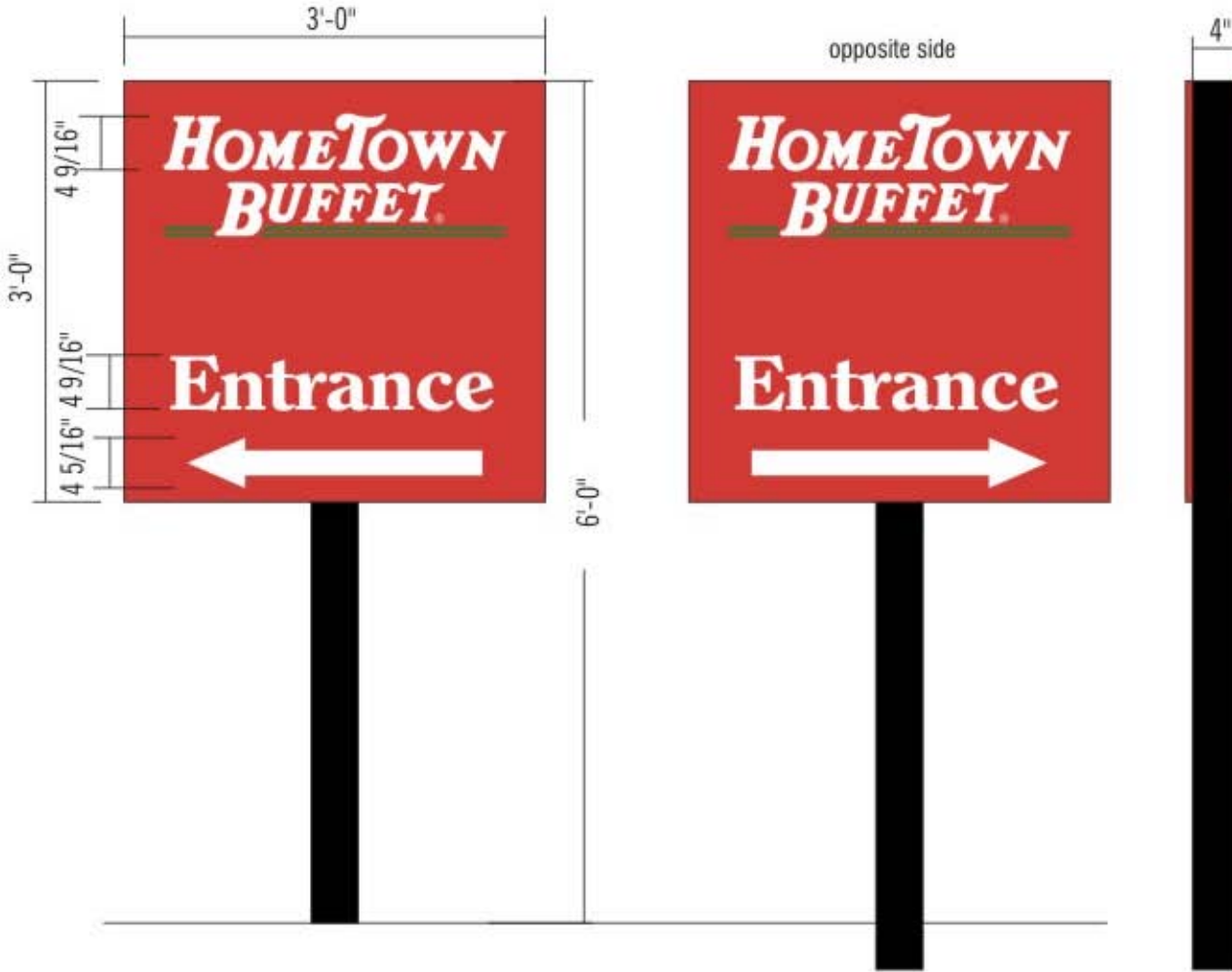



City of Madison Application for Non-Ground Sign Permit

INCOMPLETE OR INACCURATE SUBMITTALS MAY RESULT IN DELAYS TO THE APPROVAL PROCESS

Please check one:

- NEW SIGN
 CHANGE OF COPY
 (Requires Existing Tag # _____)

APPLICATION DATE: 5/20/11

ZONING DISTRICT: C2/C-3L

Return To:
 City of Madison, Zoning
 215 Martin Luther King, Jr Blvd
 P.O. Box 2984
 Madison, WI 53701-2984

200NGS-2011-00233

A 5-1

(OFFICE USE ONLY)

Date Received: 5/20/11 JFK
 SPECIAL CONDITIONS

- UDC District _____ RPS/MRBC
 Historic/Landmark _____ PUD/POD
 IF CHANGE OF USE, NEW C.O.# _____

Date Given to UDC:
 Permit Fee: 245 -

Zoning Approval/Date: 209P 4/1/11
 Tag # _____ Permit # _____

ADDRESS OF SIGN LOCATION: <u>1745 PARKSIDE</u>	
SIGN ERECTOR'S NAME, ADDRESS & E-MAIL: <u>Capital City Neon Sign Co Inc</u> <u>2914 Industrial Dr Madison WI 53713</u> <u>chuck.ccsignswebglobal.net</u>	SIGN OWNER'S NAME, ADDRESS, ZIP CODE & PHONE #: <u>HOMETOWN BUFFET</u>
CONTACT PERSON & PHONE #: <u>Chuck Zimmerman 222-1881</u>	PROPOSED INSTALLATION DATE (MM/DD/YYYY):
PROPOSED PROPERTY USE: <u>restaurant</u>	EXISTING PROPERTY USE: <u>restaurant</u>
TYPE OF SIGN (Check all that apply): <input type="checkbox"/> Above roof <input type="checkbox"/> Awning <input type="checkbox"/> Banner (wall only) <input type="checkbox"/> Business opening (30 days) <input type="checkbox"/> Projecting <input type="checkbox"/> Roof <input checked="" type="checkbox"/> Wall <input checked="" type="checkbox"/> Illuminated <input type="checkbox"/> Non-Illuminated <input type="checkbox"/> Electronic Message Center <input type="checkbox"/> Time & Temperature <input type="checkbox"/> Other	Submit one set of full-color plans including, but not limited to, the following information: A full-color photograph/graphical representation of the proposed sign(s) at the desired location(s) Design Sheet(s): <input type="checkbox"/> Net Area Calculation <input type="checkbox"/> Gross Area Calculation <input type="checkbox"/> Overall height & clearance to grade <input type="checkbox"/> Color(s) names & specification number(s) <input type="checkbox"/> Illustration of Net Area Measurement per MGD 3' Method of illumination (if ED, see MGD 3.1) & control (see MGD 3.2). <input type="checkbox"/> Illumination compliance statement <input type="checkbox"/> Construction material information <input type="checkbox"/> Wind loading control information <input type="checkbox"/> Daytime view <input type="checkbox"/> Nighttime view <input type="checkbox"/> Light fixture production sheet for externally illuminated signs
DESCRIPTION OF TEXT AND/OR GRAPHICS OF SIGN: <u>HOMETOWN BUFFET w/ UNDERSCORE</u>	
DIMENSION & TOTAL SQUARE FOOTAGE OF SIGNABLE AREA: <u>49.25 x C = 245 SQ.FT.</u>	TOTAL SQUARE FEET
SIGN DIMENSIONS (square feet): <u>3.5 x 38.25 + .06 x 38.25 + .06 x 38.25</u> <u>TOTAL = 139.9</u>	Notes:

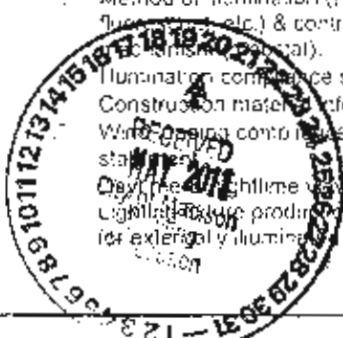

Section 31.04(3)(f)—Permits are revocable at any time by the Building Inspection Division Director.



City of Madison Application for Non-Ground Sign Permit

INCOMPLETE OR INACCURATE SUBMITTALS MAY RESULT IN DELAYS TO THE APPROVAL PROCESS

Please check one:

NEW SIGN

CHANGE OF COPY

(Requires Existing Tag # _____)

APPLICATION DATE: 5/20/11

ZONING DISTRICT: C2/C3

Return To:

City of Madison Zoning
215 Martin Luther King, Jr Blvd
P.O. Box 2984
Madison, WI 53701-2984

200 NGS-201-00234

B 5-2

(OFFICE USE ONLY)

Date Received: 5/20/11 JJK
SPECIAL CONDITIONS:

UDC District RPSM/RDC
 Historical Landmark PUD/PCD
IF CHANGE OF USE, NEW C.O.# _____

Date Given to UDC:

Permit Fee: 245-

Zoning Approval Date: 6/1/11

Tag # _____ Permit # _____

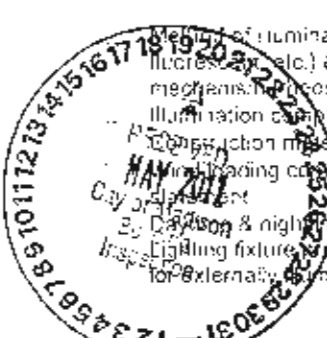
ADDRESS OF SIGN LOCATION: <u>745 PARKSIDE DR.</u>	
SIGN ERECTOR'S NAME, ADDRESS & E-MAIL: <u>Capital City Neon Sign Co Inc</u> <u>2714 Industrial Dr Madison WI 53713</u> <u>chuck.designs@cbglobal.net</u>	SIGN OWNER'S NAME, ADDRESS, ZIP CODE & PHONE #: <u>HOMETOWN BUFFET</u>
CONTACT PERSON & PHONE #: <u>Chuck Zimmerman 223-1861</u>	PROPOSED INSTALLATION DATE (MM/DD/YYYY):
PROPOSED PROPERTY USE: <u>restaurant</u>	EXISTING PROPERTY USE: <u>restaurant</u>
TYPE OF SIGN (Check all that apply): <input type="checkbox"/> Above roof <input type="checkbox"/> Awning <input type="checkbox"/> Banner (wall only) <input type="checkbox"/> Business opening (30 days) <input type="checkbox"/> Projecting <input type="checkbox"/> Roof <input type="checkbox"/> Wall <input checked="" type="checkbox"/> Illuminated <input checked="" type="checkbox"/> Internal <input type="checkbox"/> External <input type="checkbox"/> Non-Illuminated <input type="checkbox"/> Electronic Message Center <input type="checkbox"/> Time & Temperature <input type="checkbox"/> Other	Submit one set of full-color plans including, but not limited to, the following information: A full-color photograph/graphical representation of the proposed sign(s) at the desired location(s) Design Sheet(s): <ul style="list-style-type: none">Net Area CalculationGross Area CalculationOverall height & clearance to gradeColor(s), names & specification number(s)Illustration of Net AreaMeasurement per MCO 31 
DESCRIPTION OF TEXT AND/OR GRAPHICS OF SIGN: <u>"HOMETOWN BUFFET" w/ UNDERSCORE</u>	
DIMENSION & TOTAL SQUARE FOOTAGE OF SIGNABLE AREA: <u>43 x 8 = 344 SQ FT</u>	BUILDING WIDTH TOTAL SQUARE FEET
SIGN DIMENSIONS (square feet): <u>3.5 x 38.25 + .08 x 38.25 + .08 x 38.25</u> <u>TOTAL 139.9</u>	Notes:



City of Madison Application for Non-Ground Sign Permit

INCOMPLETE OR INACCURATE SUBMITTALS MAY RESULT IN DELAYS TO THE APPROVAL PROCESS

Please check one:

- NEW SIGN
- CHANGE OF COPY (Requires Existing Tag #)

APPLICATION DATE: 5/20/11

ZONING DISTRICT: C2/C3V

Return To:
 City of Madison Zoning
 215 Martin Luther King, Jr. Blvd
 P.O. Box 2984
 Madison, WI 53701-2984

200NGS-2011-00235 **C5-3**

(OFFICE USE ONLY)

Date Received: 5/20/11 JLK

SPECIAL CONDITIONS

- UDC District RPSM/RDC
- Historic Ordinance PUD/POD
- IF CHANGE OF USE, NEW C.O.#

Date Given to UDC:

Permit Fee: 245

Zoning Approval Date: 10/11/11

Tag # _____ Permit # _____

ADDRESS OF SIGN LOCATION: <u>1745 PARKSIDE DRIVE</u>	
SIGN ERECTOR'S NAME, ADDRESS & E-MAIL: <u>Capital City Neon Sign Co Inc</u> <u>2714 Industrial Dr Madison WI 53713</u> <u>chuck.ccsigns@shglobal.net</u>	SIGN OWNER'S NAME, ADDRESS, ZIP CODE & PHONE #: <u>HOMETOWN BUFFET</u>
CONTACT PERSON & PHONE #: <u>Chuck Zimmerman 322-1881</u>	PROPOSED INSTALLATION DATE (MM/DD/YYYY): <u>W</u>
PROPOSED PROPERTY USE: <u>restaurant</u>	EXISTING PROPERTY USE: <u>restaurant</u>
TYPE OF SIGN (Check all that apply): <input type="checkbox"/> Above roof <input type="checkbox"/> Awning <input type="checkbox"/> Banner (wall only) <input type="checkbox"/> Business covering (30 days) <input type="checkbox"/> Projecting <input type="checkbox"/> Roof <input checked="" type="checkbox"/> Wall <input checked="" type="checkbox"/> Illuminated <input checked="" type="checkbox"/> Internal <input type="checkbox"/> External <input type="checkbox"/> Non-Illuminated <input type="checkbox"/> Electronic Message Center <input type="checkbox"/> Tone & Temperature <input type="checkbox"/> Other	Submit one set of full-color plans including, but not limited to, the following information: A full-color photograph/graphical representation of the proposed sign(s) at the desired location(s) Design Sheet(s) <input type="checkbox"/> Net Area Calculation <input type="checkbox"/> Gross Area Calculation <input type="checkbox"/> Overall height & clearance grade <input type="checkbox"/> Color(s) names & specification number(s) <input type="checkbox"/> Illustration of Net Area <input type="checkbox"/> Measurement per MGO 31 <div style="text-align: center;"> </div>
DESCRIPTION OF TEXT AND/OR GRAPHICS OF SIGN: <u>"HOMETOWN BUFFET" w/ UNDERSCORE</u>	
DIMENSION & TOTAL SQUARE FOOTAGE OF SIGNABLE AREA: <u>43 x 8 = 344 Sq Ft</u>	BUILDING WIDTH: _____ TOTAL SQUARE FEET: _____
SIGN DIMENSIONS (square feet): <u>3.5 x 38.25 + .08 x 38.25 + .08 x 38.25</u> <u>TOTAL = 139.9</u>	Notes: _____

DS-6

ZONGSN-2011-0236



City of Madison Application for Ground Sign Permit

INCOMPLETE OR INACCURATE SUBMITTALS MAY RESULT IN DELAYS TO THE APPROVAL PROCESS

Please check one:

- NEW SIGN
- CHANGE OF COPY (Requires Existing Tag #)

APPLICATION DATE: 5/20/11

ZONING DISTRICT: C2/C3

Return To:
 City of Madison Zoning
 215 Martin Luther King, Jr Blvd.
 P.O. Box 2984
 Madison, WI 53701-2984

(OFFICE USE ONLY)

Date Received: 5/20/11 JLK

SPECIAL CONDITIONS

UDC District RPS/MRDC
 Historic Landmark PUD/PCD

IF CHANGE OF USE, NEW C.O.#

Date Given to UDC: _____
 Permit Fee: 305

Zoning Approval/Date: 6/30/11 roof
 Tag # _____ Permit # _____

ADDRESS OF SIGN LOCATION: <u>1745 PARKSIDE DR.</u>			
SIGN ERECTOR'S NAME, ADDRESS & E-MAIL: <u>Capital City Neon Sign Co Inc</u> <u>2714 Industrial Dr</u> <u>Madison WI 53713 ccsigns@sbcglobal.net</u>		SIGN OWNER'S NAME, ADDRESS, ZIP CODE & PHONE #: <u>HOMETOWN BUFFET</u>	
CONTACT PERSON & PHONE #: <u>Chuck 508-222-1881</u>		PROPOSED INSTALLATION DATE (MM/DD/YYYY):	
PROPOSED PROPERTY USE: <u>restaurant</u>	EXISTING PROPERTY USE: <u>restaurant</u>	TYPE OF SIGN (Check all that apply)	
<input type="checkbox"/> Ground <input type="checkbox"/> Monument <input checked="" type="checkbox"/> Pole <input checked="" type="checkbox"/> Illuminated <input checked="" type="checkbox"/> Internal <input type="checkbox"/> External <input type="checkbox"/> Non-Illuminated <input type="checkbox"/> Electronic Message Center <input type="checkbox"/> Time & Temperature <input type="checkbox"/> Off-Premise Directional <input type="checkbox"/> Other:		Submit one set of full-color plans including but not limited to, the following information: A full-color photograph/graphical representation of the proposed sign(s) at the desired location(s)	
SIDES: <input type="checkbox"/> Single <input checked="" type="checkbox"/> Double <input type="checkbox"/> Other		Design Sheet(s): <ul style="list-style-type: none"> - Net Area Calculation - Gross Area Calculation - Overall height & clearance to grade - Pole size(s) & separation - Color(s) names & specifications number(s) - Method of illumination (LED, fluorescent, etc) & control mechanism (rheostat) - Illumination compliance statement - Construction material information - Wind loading compliance statement - Daytime & nighttime views - Lighting fixture product cut sheet for externally illuminated signs 	Site Plan: <ul style="list-style-type: none"> - Setback from property lines - Other structures & features of the property - Over signs - existing and proposed - 25' vision triangle at intersections of property lines having street frontage - 10' vision triangle at intersection of driveway and street property
DESCRIPTION OF TEXT AND/OR GRAPHICS OF SIGN: <u>HOMETOWN BUFFET NEW CABINET</u>			
LANES OF TRAFFIC <u>6</u>	SPEED LIMIT (Posted) <u>40</u>	MAXIMUM GROUND SIGN AREA	MAXIMUM GROUND SIGN HEIGHT
SIGN DIMENSIONS (ft./in.) <u>8' 2" x 10' x 2'</u>	Net <u>160 sq ft</u>	Gross <u>165.25</u>	TOTAL SQUARE FEET
SIGN DIMENSIONS (ft./in.)	Net	Gross	<u>165.25</u>
SIGN DIMENSIONS (ft./in.)	Net	Gross	



Setting for this Site Information Sheet	
Project Name	Old Country Buffet
Project No.	1000000000
Client	Old Country Buffet
Site No.	1000000000
Site Name	Old Country Buffet
Site Address	1000000000
City	Madison, WI
State	WI
County	Dane
Zip	53705
Scale	1" = 100'
Date	10/10/11
Drawn by	...
Checked by	...

MOVE SIGN
CLOSER TO
E. WASHINGTON

1. ALL DIMENSIONS ARE TO FACE UNLESS OTHERWISE NOTED.
2. ALL DIMENSIONS ARE TO FACE UNLESS OTHERWISE NOTED.
3. ALL DIMENSIONS ARE TO FACE UNLESS OTHERWISE NOTED.
4. ALL DIMENSIONS ARE TO FACE UNLESS OTHERWISE NOTED.
5. ALL DIMENSIONS ARE TO FACE UNLESS OTHERWISE NOTED.
6. ALL DIMENSIONS ARE TO FACE UNLESS OTHERWISE NOTED.
7. ALL DIMENSIONS ARE TO FACE UNLESS OTHERWISE NOTED.
8. ALL DIMENSIONS ARE TO FACE UNLESS OTHERWISE NOTED.

EAST WASHINGTON AVENUE
(US HIGHWAY 151)

1000000000
1000000000
1000000000

1000000000
1000000000
1000000000

Old Country Buffet

THAYER ROAD

1000000000

OLD COUNTRY BUFFET
1170 EAST WISCONSIN
MADISON, WISCONSIN

1000000000	1000000000
1000000000	1000000000
1000000000	1000000000
1000000000	1000000000
1000000000	1000000000
1000000000	1000000000
1000000000	1000000000
1000000000	1000000000
1000000000	1000000000
1000000000	1000000000

THIS SIGN IS NOT ELIGIBLE FOR ANY RELOCATION FUNDS IN THE EVENT THE R.O.W IS WIDENED. RELOCATION WILL BE COMPLETELY AT SIGN OWNERS EXPENSE, IF R.O.W IS WIDENED.

SITE PLAN



Buffet's, Inc.

B R W

Old Country Buffet

MADISON, WISCONSIN

C2